

FILE

CASE NO.:

96-473-E1-PEB

DATE: April 1, 1996

TO
THE PUBLIC UTILITIES COMMISSION OF OHIO
CONSUMER SERVICES DEPARTMENT
ELECTRIC SECTION
COMPLIANCE DIVISION

RECEIVED
MAY 15 1996
DOCKETING DIVISION
Public Utilities Commission of Ohio

PETITION FOR A REALLOCATION OF TERRITORY

Submit four (4) copies of petition and associated boundary maps and/or overlap sheets indicating proposed reallocation.

Electric Supplier: COLUMBUS SOUTHERN POWER COMPANY

Address: 215 North Front Street, Columbus, OH 43215-2291

Location of Reallocation:

PUCO Map No.: X-22 Gallipolis Effective Dates: May 6, 1981 (BEC)

County: Gallia and June 3, 1981 (CSP)

Township: Addison

Reason for Reallocation: A customer in Buckeye Rural Electric Cooperative, Inc. certified territory was being served by Buckeye with approximately 1000 feet of primary underground cable. The cable has failed and attempts to locate the fault and make repairs have been unsuccessful. Columbus Southern Power has facilities located approximately 100 feet from the customer. The customer has requested that Columbus Southern Power serve him and all parties are in agreement.

Description of Reallocation: Relocate the boundary line in Sections 8 and 14 beginning at a point on the existing boundary line where it crosses the centerline of George Creek Road; thence West along the centerline of George Creek Road a distance of 275 feet to the centerline of the former Penn Central Railroad; thence Northeast along the centerline of the former Penn Central Railroad a distance of 1100 feet to where it meets the existing boundary line, as shown on the attached map.

Are affected customers aware of an in agreement with the proposed reallocation? Yes

If no, explain:



Signature

OHIO RATES DIRECTOR

Title

COLUMBUS SOUTHERN POWER COMPANY

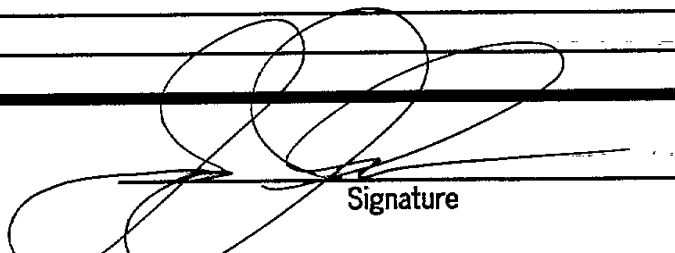
Supplier

Signature

GENERAL MANAGER

Title

BUCKEYE RURAL ELECTRIC COOPERATIVE, INC.

Supplier

This is to certify that the images appearing are an accurate and complete reproduction of a case file document delivered in the regular course of business.
Technician S. Whelan Date Processed 5-16-96

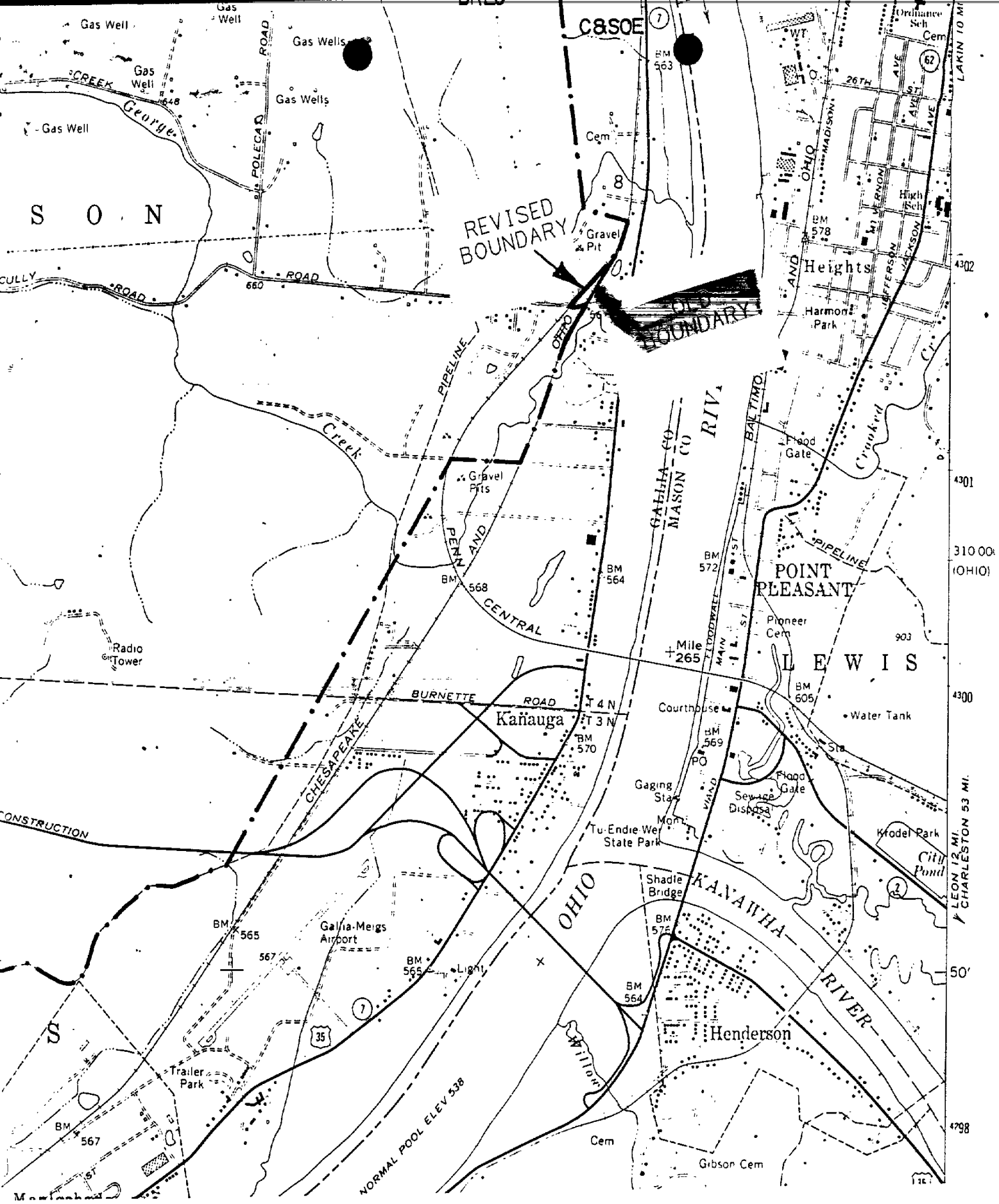

X22

REVISED BOUNDARY

4-1-96