

CASE NO.: _____

DATE: August 16, 1996 96-891-El-PEB

TO
THE PUBLIC UTILITIES COMMISSION OF OHIO
CONSUMER SERVICES DEPARTMENT
ELECTRIC SECTION
COMPLIANCE DIVISION

RECEIVED
AUG 28 1996
DOCKETING DIVISION
Public Utilities Commission of Ohio

2

PETITION FOR A REALLOCATION OF TERRITORY

Submit four (4) copies of petition and associated boundary maps and/or overlap sheets indicating proposed reallocation.

Electric Supplier: COLUMBUS SOUTHERN POWER COMPANY

Address: 215 North Front Street, Columbus, OH 43215-2291

Location of Reallocation: _____

PUCO Map No.: L-16 Kilbourne Effective Dates: April 22, 1981 (DRE)

County: Delaware & June 3, 1981 (CSP)

Township: Brown

Reason for Reallocation: A new customer in Columbus Southern Power territory has requested service. Due to the distance from Columbus Southern Power Company facilities, it is not practical for the company to serve them. Consolidated Electric is currently serving the adjacent customer and is able and willing to serve this new customer.

Description of Reallocation: Relocate the boundary line in Quarter Township 3 of Township 5 North, Range 18 West of the United States Military lands beginning at a point on the existing boundary line where it crosses State Route Number 521; thence North 925 feet to where it meets the existing boundary line, as shown on the attached map.

Are affected customers aware of an in agreement with the proposed reallocation? Yes
If no, explain: _____

Signature

OHIO RATES DIRECTOR
Title

COLUMBUS SOUTHERN POWER COMPANY
Supplier

Signature
PRESIDENT

~~GENERAL MANAGER~~
Title

CONSOLIDATED ELECTRIC COOPERATIVE, INC. *
Supplier

This is to certify that the images appearing are an accurate and complete reproduction of a case file document delivered in the regular course of business.
Technician J. Watson Date Processed 8-29-96

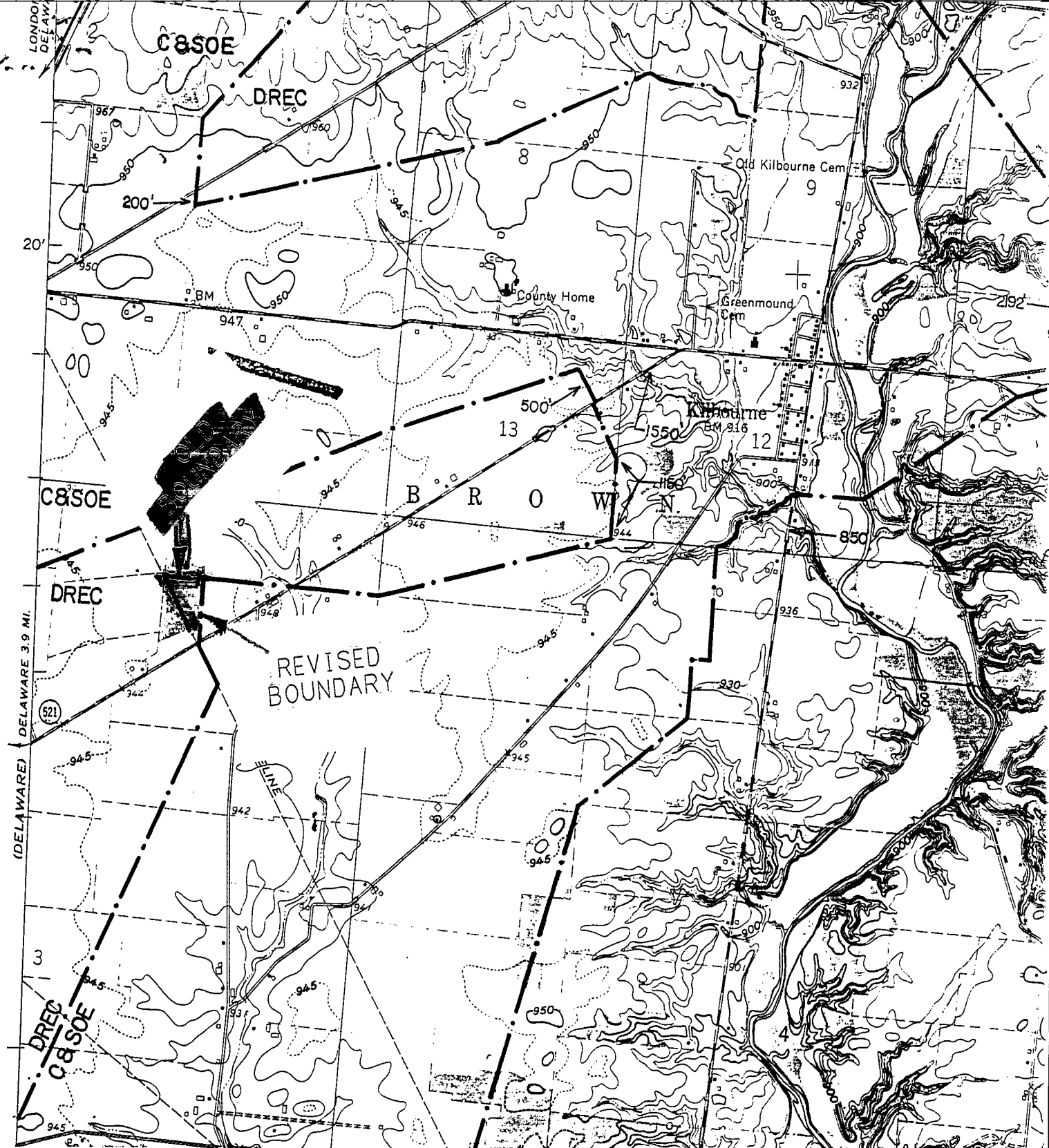

L16

AUGUST 13, 1996
REVISED BOUNDARY