

- LEGEND**
- PROJECT BOUNDARY
 - EXISTING RIGHT OF WAY
 - EXISTING PROPERTY BOUNDARY
 - EXISTING EASEMENT
 - EXISTING VMS LINE
 - EXISTING STREAM
 - EXISTING TREE LINE
 - EXISTING DELINEATED STREAMS
 - EXISTING CONTOUR - MAJOR
 - EXISTING CONTOUR - MINOR
 - EXISTING FEMA FLOODPLAIN
 - EXISTING DELINEATED WETLAND
 - EXISTING CULVERT
 - PV NON-BUILDABLE AREAS
 - FENCE NON-BUILDABLE BOUNDARY
 - PROPOSED 16' SITE ACCESS ROAD
 - PROPOSED LAYDOWN/TRUCK ACCESS ROAD
 - PROPOSED GAME WIRE FENCE
 - PROPOSED P/V ARRAY
 - PROPOSED LAYDOWN YARD AND TRUCK STAGING AREA
 - PROPOSED CONTOUR - MAJOR
 - PROPOSED CONTOUR - MINOR
 - SILT FENCE

QUANTITIES		
ITEM	UNITS	QUANTITY
CUT - EG TO FG*	CY	4,080
FILL - EG TO FG*	CY	3,787
TOPSOIL STRIPPING	CY	7,297
SILT FENCE***	FT	3,263
5" AGGREGATE BASE (DRIVEWAY)	CY	1,796
4" AGGREGATE BASE* (LAYDOWN YARD)	CY	5,250

* CUT/FILL QUANTITIES ARE BASED ON EG SURFACE TO FG SURFACE COMPARISON. NO ADJUSTMENTS HAVE BEEN MADE FOR SHRINKAGE AND SWELLING. TOPSOIL QUANTITIES ARE BASED OFF AN ASSUMPTION OF 4 INCH DEPTH.

** DOES NOT INCLUDE EXPANSION AREAS.

*** INCLUDES EXPANSION AREAS.

FOX SQUIRREL SOLAR, LLC.
Madison County, Ohio

Rev.	Date	Description	By
0	07/26/2022	ISSUED FOR CONSTRUCTION	TLB

edf
renewables
15445 Innovation Dr
San Diego, CA 92128

BLATTNER ENERGY
392 Co. Rd. 50,
Avon, MN 56310

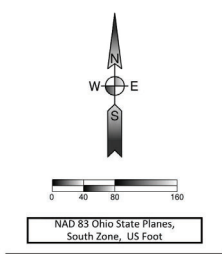

Ulteig
3350 38th Avenue South
Fargo, North Dakota 58104
Phone: 701.280.8500
Fax: 701.237.3191
www.ulteig.com
Project Number: 21.00649
Design By: C. SMAALADEN
Drawn By: J. JOHNSON
Approved By: L. JORDAHL

LAYDOWN YARD AND TRUCK STAGING AREA PLAN

REVISION:
0
DRAWING:
FSSP-SG0-C-GRD6-P001

FOX SQUIRREL
SOLAR, LLC.
Madison County, Ohio

Rev.	Date	Description	By
0	07/26/2022	ISSUED FOR CONSTRUCTION	TLB

edf
renewables
15445 Innovation Dr
San Diego, CA 92128

BLATTNER
ENERGY
392 Co. Rd. 50,
Avon, MN 56310

OHIO811
Before You Dig

NAD 83 Ohio State Planes,
South Zone, US Feet



Ulteig
3350 38th Avenue South
Fargo, North Dakota 58104
Phone: 701.280.8500
Fax: 701.237.3191
www.ulteig.com
Project Number: 21.00649
Design By: C. SMAALADEN
Drawn By: K. GUNDERSON
Approved By: L. JORDAHL

CONSTRUCTION
DETAILS

REVISION:
0
DRAWING:
FSSP-SG0-C-GRD0-D001

G:\2021\21.00649\Drawings\PV Plant\3D Civil\01 - Drawings\01 - Plan Set Drawings\21.00649_Fox Squirrel_DTL.dwg GRD0-D001

DETAIL #
SSR-101

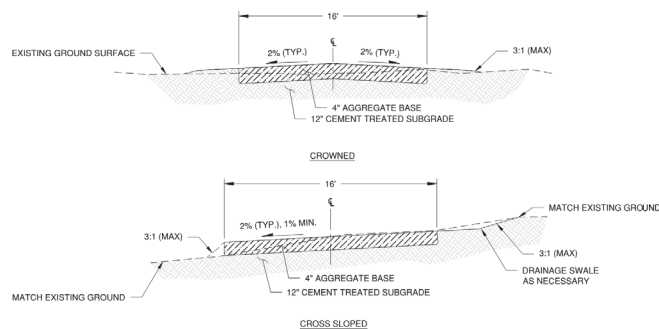

- NOTES:
- ROADS SHALL BE CONSTRUCTED WITH THE SLOPES SHOWN IN THE TYPICAL SECTIONS, OR AS SHOWN ON THE PLANS IN ORDER TO MAINTAIN SITE DRAINAGE.
 - TYPICAL ROAD SECTIONS SHOWN ARE BASED ON NORMAL FIELD CONDITIONS. ACTUAL FIELD CONDITIONS MAY REQUIRE ADDITIONAL AGGREGATE OR CHANGES TO THE SUBGRADE.
 - THE TYPICAL CROSS SLOPE FOR THE SITE ROADS IS 2%, BUT THIS MAY BE ADJUSTED DOWN AS NECESSARY TO MATCH EXISTING GRADE WHILE STILL PROVIDING PROPER SHEET DRAINAGE.
 - UNLESS SHOWN ON THE PLANS, THE CONTRACTOR SHALL MAKE THE DETERMINATION AS TO WHICH TYPICAL SECTION SHALL BE USED FOR CONSTRUCTION.
 - SLOPES SHOWN ARE IN HORIZONTAL TO VERTICAL (H:V) FORMAT.
 - SLOPES SHOWN ARE TYPICAL. SOME ROAD LOCATIONS MAY REQUIRE VARIATIONS IN SLOPE. SEE PLANS.
 - REFER TO CIVIL DESIGN PLANS FOR ROAD WIDTHS.
 - COMPACTED SHOULDER MAY BE INSTALLED AS REQUIRED FOR CONSTRUCTION AND THEN RETURNED TO ORIGINAL CONDITION FOLLOWING CONSTRUCTION.

TYPICAL SOLAR SITE ROAD

DETAIL #
SSR-101A

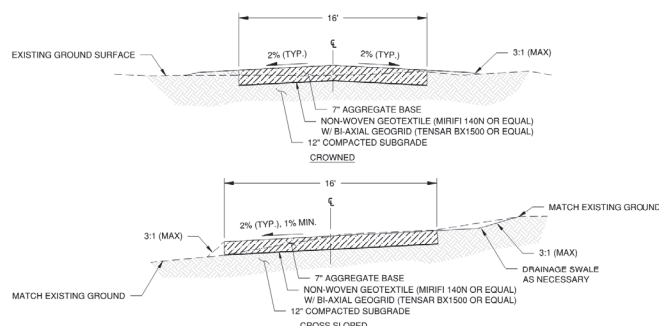

- NOTES:
- ROADS SHALL BE CONSTRUCTED WITH THE SLOPES SHOWN IN THE TYPICAL SECTIONS, OR AS SHOWN ON THE PLANS IN ORDER TO MAINTAIN SITE DRAINAGE.
 - TYPICAL ROAD SECTIONS SHOWN ARE BASED ON NORMAL FIELD CONDITIONS. ACTUAL FIELD CONDITIONS MAY REQUIRE ADDITIONAL AGGREGATE OR CHANGES TO THE SUBGRADE.
 - THE TYPICAL CROSS SLOPE FOR THE SITE ROADS IS 2%, BUT THIS MAY BE ADJUSTED DOWN AS NECESSARY TO MATCH EXISTING GRADE WHILE STILL PROVIDING PROPER SHEET DRAINAGE.
 - UNLESS SHOWN ON THE PLANS, THE CONTRACTOR SHALL MAKE THE DETERMINATION AS TO WHICH TYPICAL SECTION SHALL BE USED FOR CONSTRUCTION.
 - SLOPES SHOWN ARE IN HORIZONTAL TO VERTICAL (H:V) FORMAT.
 - SLOPES SHOWN ARE TYPICAL. SOME ROAD LOCATIONS MAY REQUIRE VARIATIONS IN SLOPE. SEE PLANS.
 - REFER TO CIVIL DESIGN PLANS FOR ROAD WIDTHS.
 - COMPACTED SHOULDER MAY BE INSTALLED AS REQUIRED FOR CONSTRUCTION AND THEN RETURNED TO ORIGINAL CONDITION FOLLOWING CONSTRUCTION.

TYPICAL SOLAR SITE ROAD (ALTERNATE ROAD CROSS SECTION)

DETAIL #
SSR-102

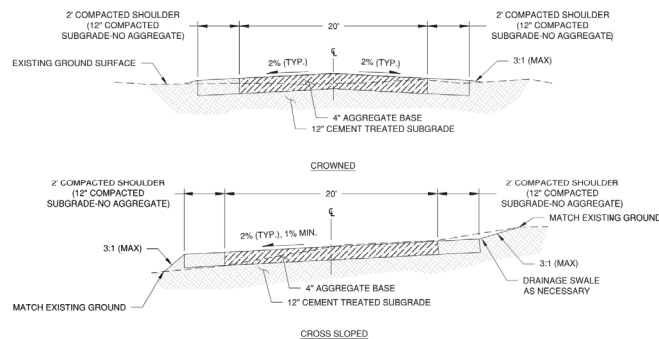

- NOTES:
- ROADS SHALL BE CONSTRUCTED WITH THE SLOPES SHOWN IN THE TYPICAL SECTIONS, OR AS SHOWN ON THE PLANS IN ORDER TO MAINTAIN SITE DRAINAGE.
 - TYPICAL ROAD SECTIONS SHOWN ARE BASED ON NORMAL FIELD CONDITIONS. ACTUAL FIELD CONDITIONS MAY REQUIRE ADDITIONAL AGGREGATE OR CHANGES TO THE SUBGRADE.
 - THE TYPICAL CROSS SLOPE FOR THE SITE ROADS IS 2%, BUT THIS MAY BE ADJUSTED DOWN AS NECESSARY TO MATCH EXISTING GRADE WHILE STILL PROVIDING PROPER SHEET DRAINAGE.
 - UNLESS SHOWN ON THE PLANS, THE CONTRACTOR SHALL MAKE THE DETERMINATION AS TO WHICH TYPICAL SECTION SHALL BE USED FOR CONSTRUCTION.
 - SLOPES SHOWN ARE IN HORIZONTAL TO VERTICAL (H:V) FORMAT.
 - SLOPES SHOWN ARE TYPICAL. SOME ROAD LOCATIONS MAY REQUIRE VARIATIONS IN SLOPE. SEE PLANS.
 - REFER TO CIVIL DESIGN PLANS FOR ROAD WIDTHS.
 - COMPACTED SHOULDER MAY BE INSTALLED AS REQUIRED FOR CONSTRUCTION AND THEN RETURNED TO ORIGINAL CONDITION FOLLOWING CONSTRUCTION.

TYPICAL SUBSTATION/SWITCHYARD ROAD

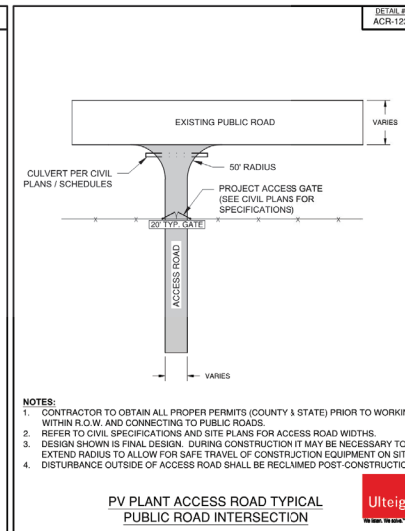
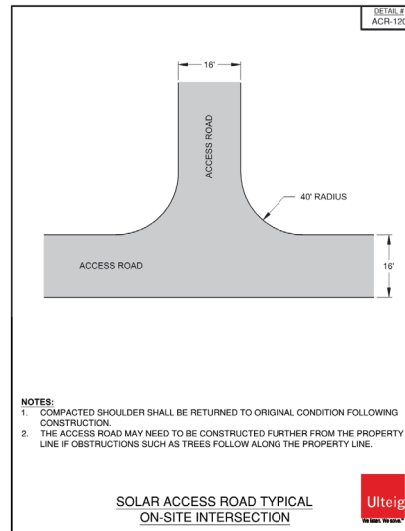
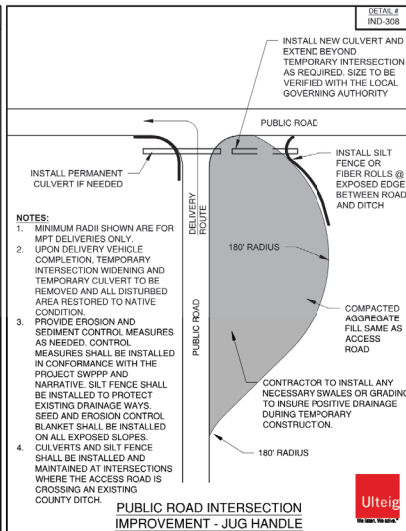
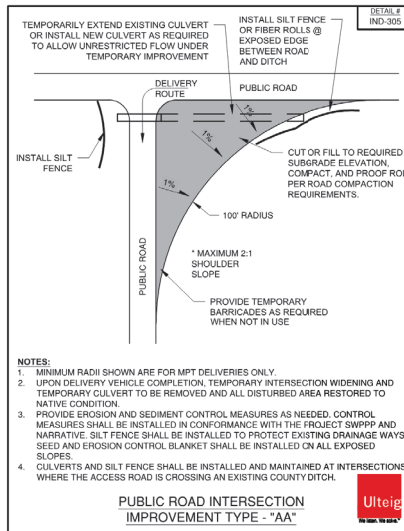
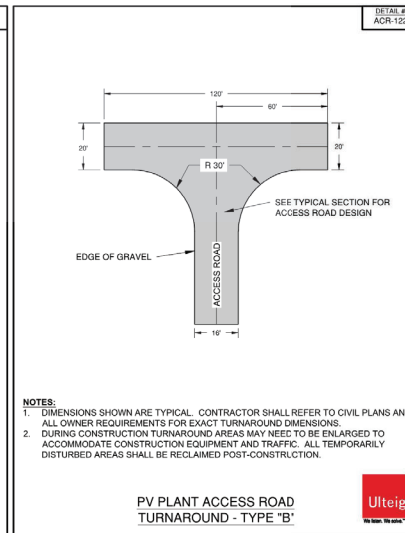
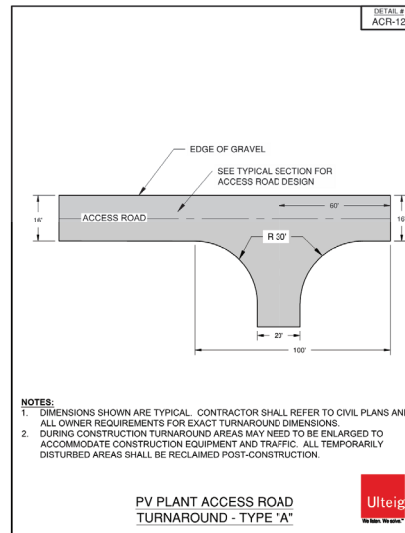
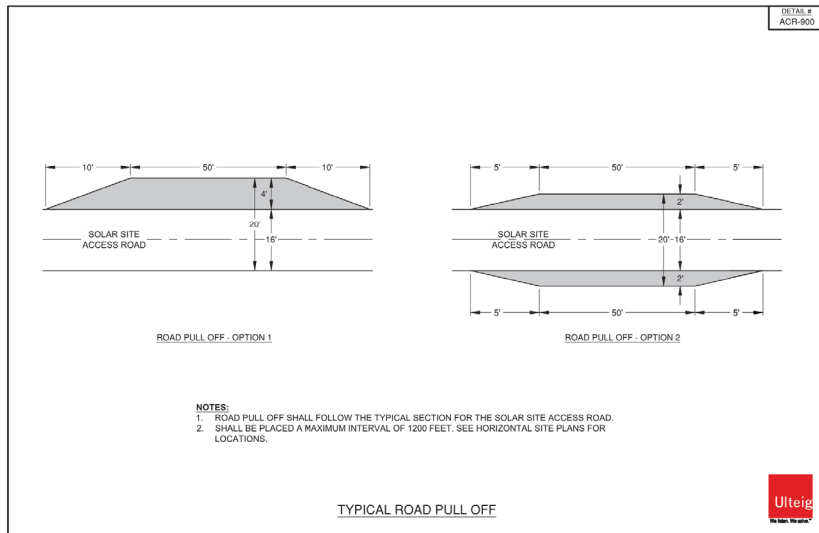

FOX SQUIRREL SOLAR, LLC.

Madison County, Ohio

Rev.	Date	Description	By
0	07/26/2022	ISSUED FOR CONSTRUCTION	TLB

edf
renewables
15445 Innovation Dr
San Diego, CA 92128

BLATTNER
ENERGY
392 Co. Rd. 50,
Avon, MN 56310

OHIO811
Before You Dig

NAD 83 Ohio State Planes,
South Zone, US Feet



Ulteig
3350 38th Avenue South
Fargo, North Dakota 58104
Phone: 701.280.8500
Fax: 701.237.3191
www.ulteig.com
Project Number: 21.00648
Design By: C. SMAALADEN
Drawn By: K. GUNDERSON
Approved By: L. JORDAHL

CONSTRUCTION DETAILS

REVISION:
0
DRAWING:
FSSP-SG0-C-GRD0-D002

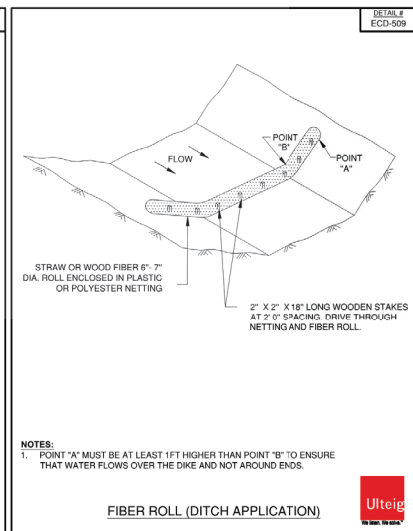
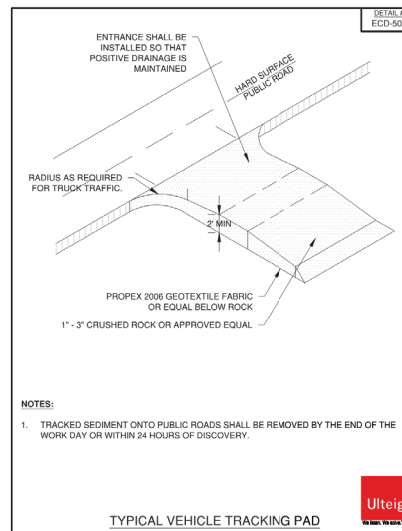
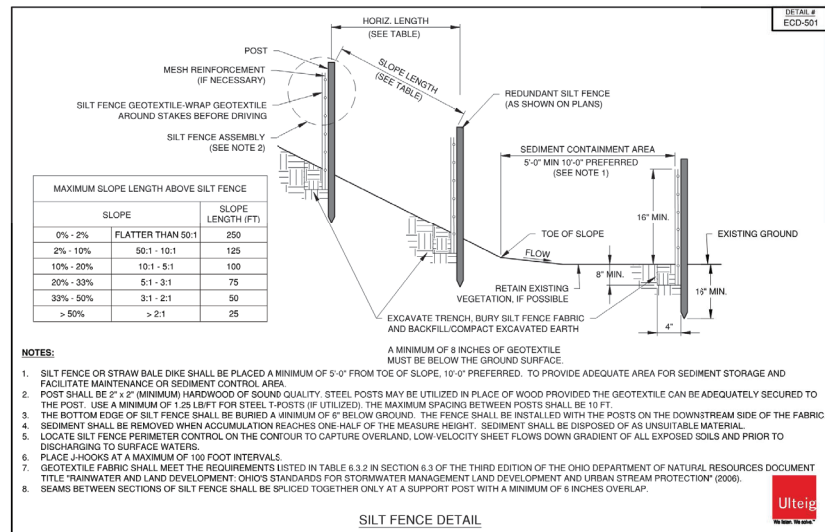
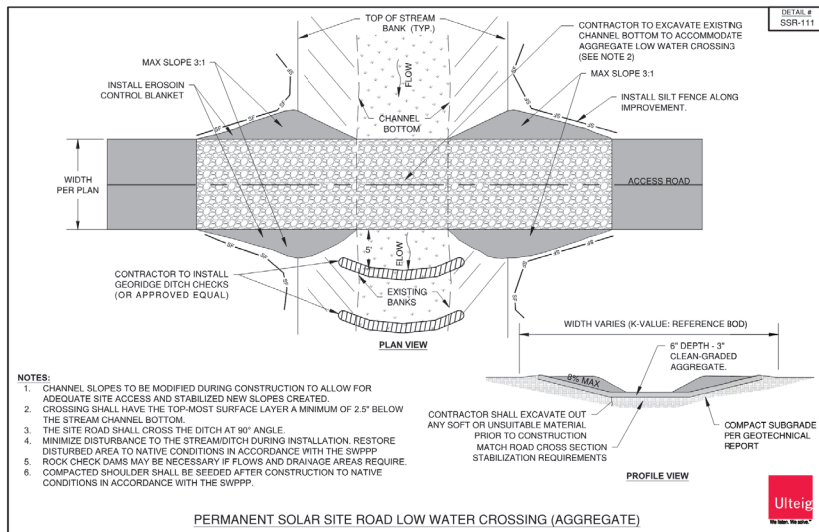

**FOX SQUIRREL
SOLAR, LLC.**
Madison County, Ohio

Rev. Date Description By
0 07/26/2022 ISSUED FOR CONSTRUCTION TLB

edf
renewables
15445 Innovation Dr
San Diego, CA 92128

**BLATTNER
ENERGY**
392 Co. Rd. 50,
Avon, MN 56310

OHIO811
Before You Dig

NAD 83 Ohio State Planes,
South Zone, US Feet



Ulteig
3350 38th Avenue South
Fargo, North Dakota 58104
Phone: 701.280.8500
Fax: 701.237.3191
www.ulteig.com
Project Number: 21.00649
Design By: C. SMAALADEN
Drawn By: K. GUNDERSON
Approved By: L. JORDAHL

**CONSTRUCTION
DETAILS**

REVISION:
0
DRAWING:
FSSP-SG0-C-GRD0-D003

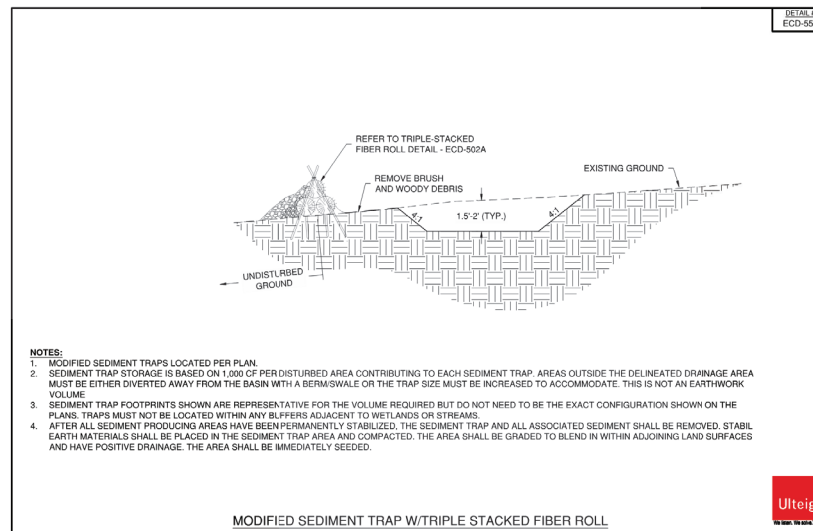
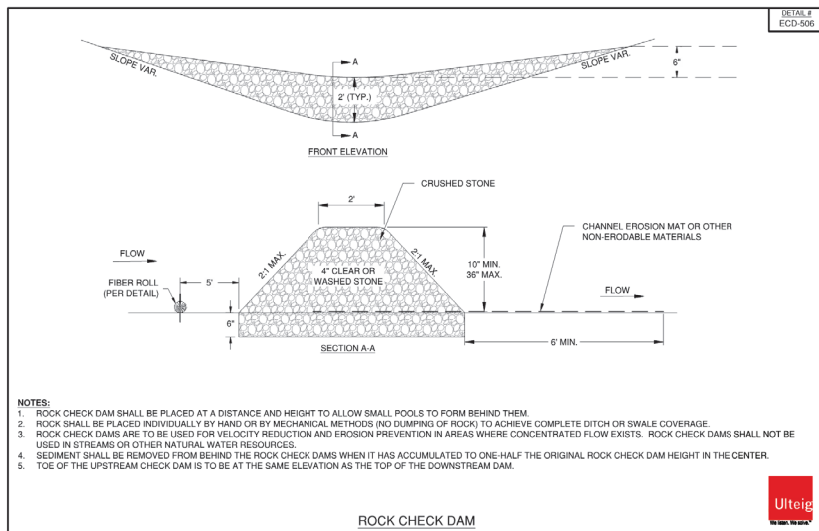
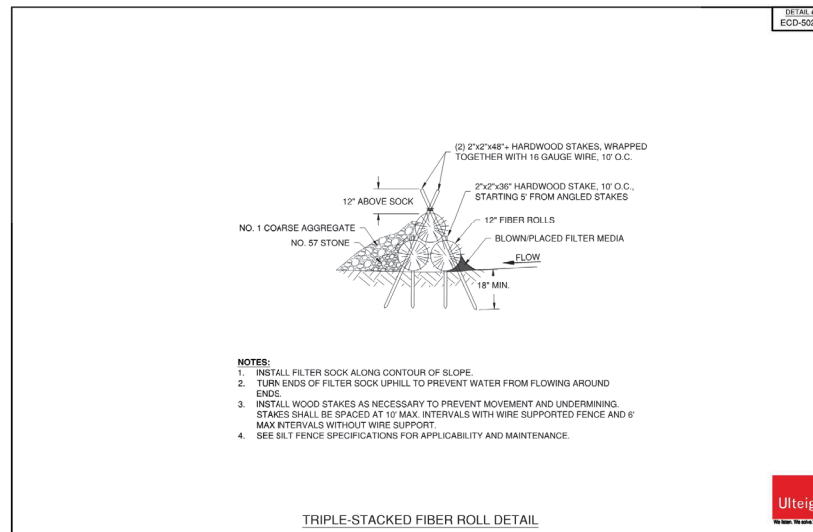
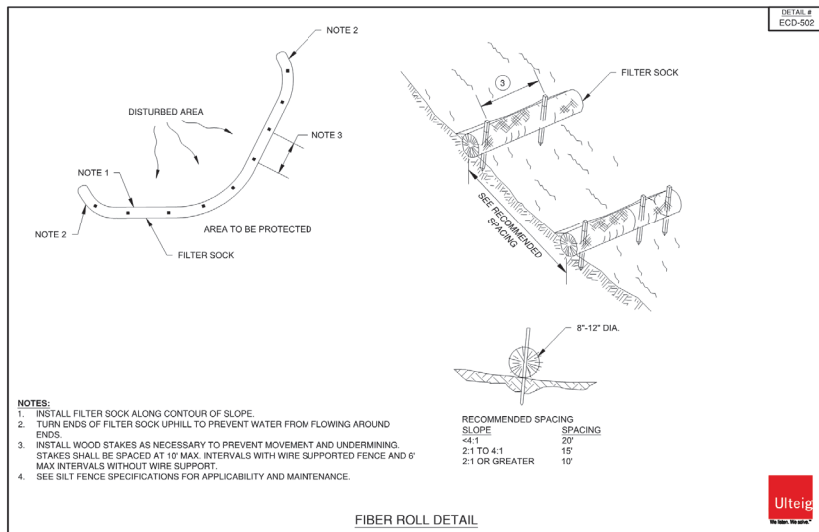

FOX SQUIRREL SOLAR, LLC. Madison County, Ohio

Rev. Date Description By
0 07/26/2022 ISSUED FOR CONSTRUCTION TLB

edf
renewables
15445 Innovation Dr
San Diego, CA 92128

BLATTNER
ENERGY
392 Co. Rd. 50,
Avon, MN 56310

OHIO811
Before You Dig

NAD 83 Ohio State Planes,
South Zone, US Feet



Date: July 26, 2022

Ulteig
3350 38th Avenue South
Fargo, North Dakota 58104
Phone: 701.280.8500
Fax: 701.237.3191
www.ulteig.com
Project Number: 21.00649
Design By: C. SMAALADEN
Drawn By: K. GUNDERSON
Approved By: L. JORDAHL

CONSTRUCTION DETAILS

REVISION:
0
DRAWING:
FSSP-SG0-C-GRD0-D004

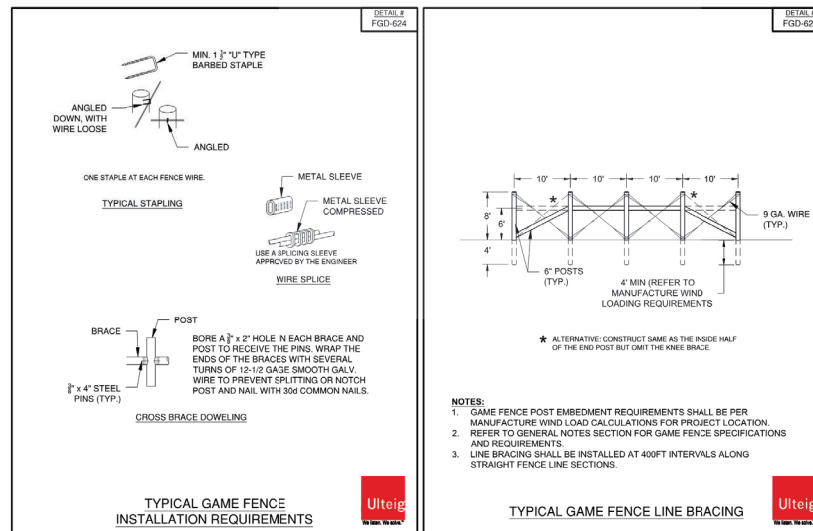
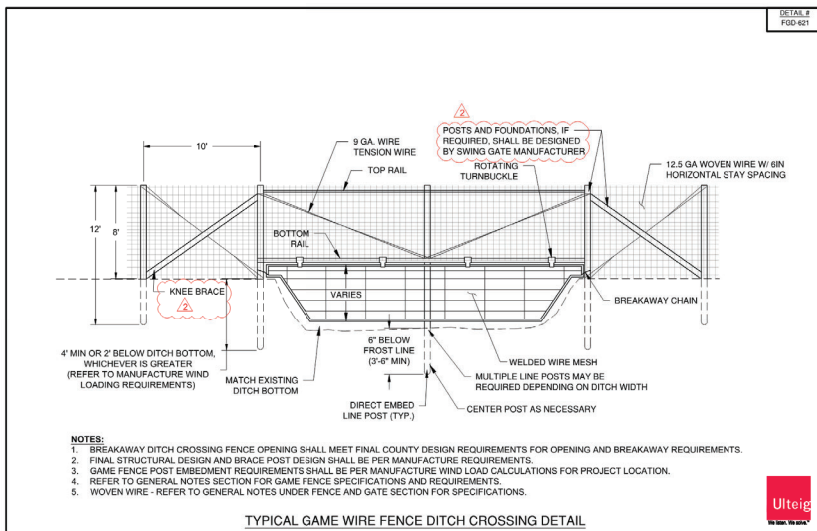
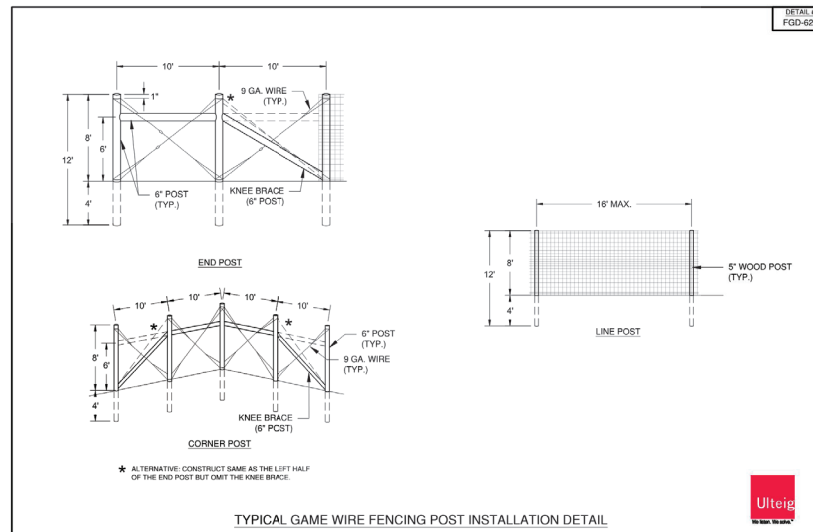
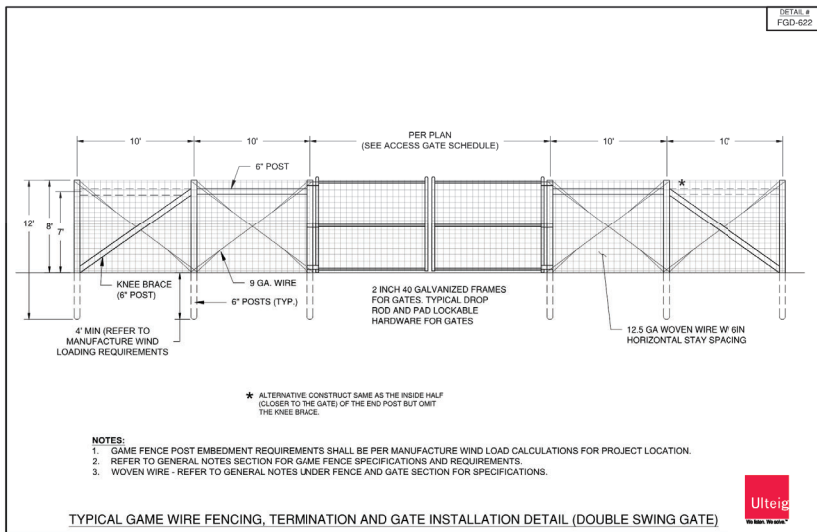

FOX SQUIRREL SOLAR, LLC. Madison County, Ohio

Rev.	Date	Description	By
0	07/29/2022	ISSUED FOR CONSTRUCTION	TLB
2	09/22/2022	DETAIL UPDATE	TLB

edf
renewables
15445 Innovation Dr
San Diego, CA 92128

BLATTNER
ENERGY
392 Co. Rd. 50,
Avon, MN 56310

OHIO811
Before You Dig

NAD 83 Ohio State Planes,
South Zone, US Feet



Ulteig
3350 38th Avenue South
Fargo, North Dakota 58104
Phone: 701.280.8500
Fax: 701.237.3191
www.ulteig.com
Project Number: 21.00649
Design By: C. SMAALADEN
Drawn By: K. GUNDERSON
Approved By: L. JORDAHL

CONSTRUCTION DETAILS

REVISION:
2
DRAWING:
FSSP-SG0-C-GRD0-D005

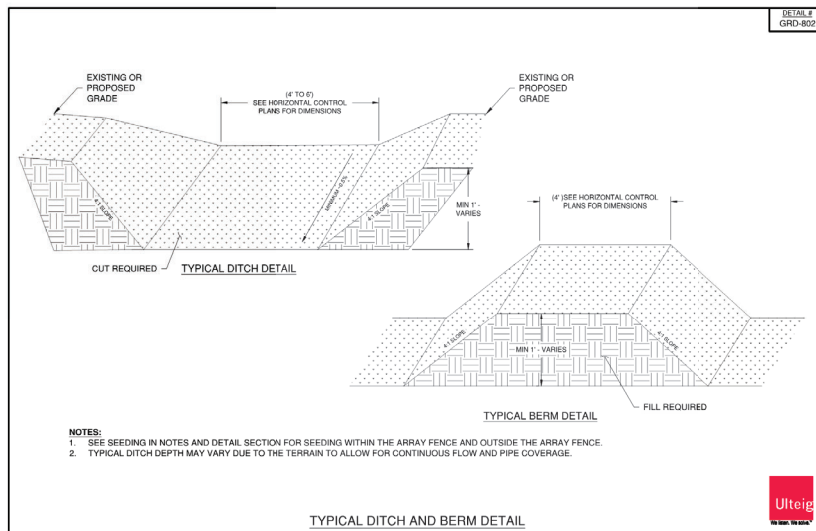
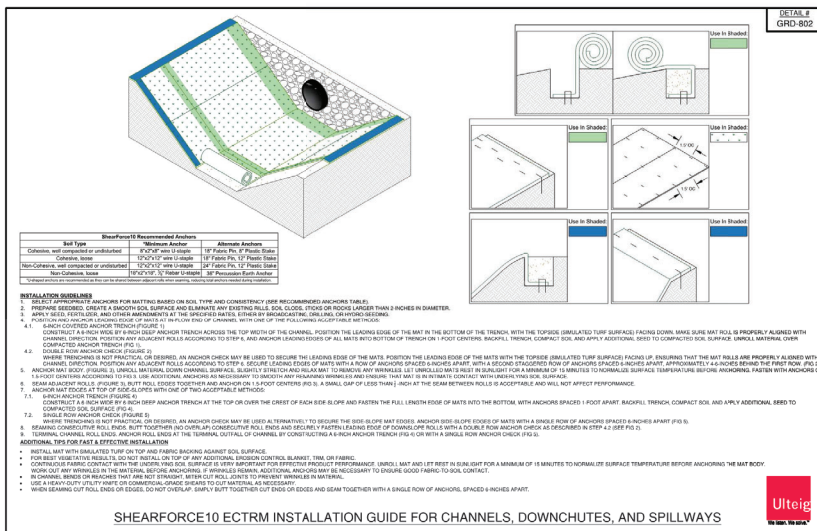
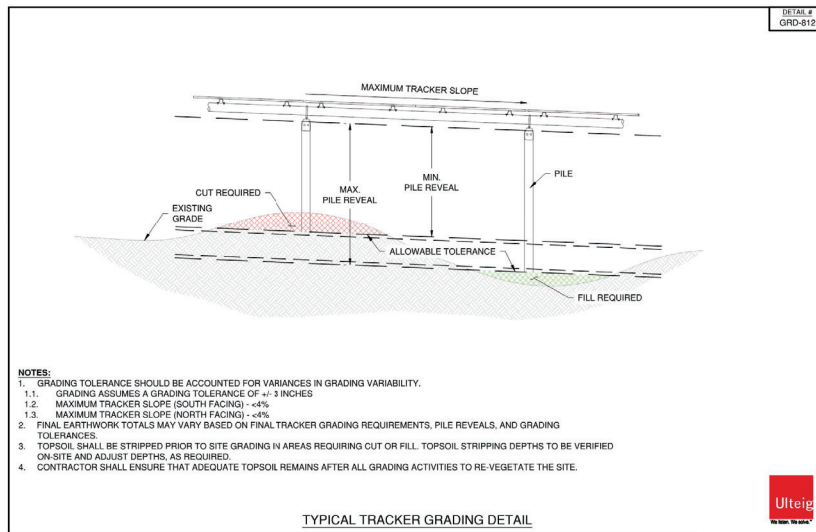
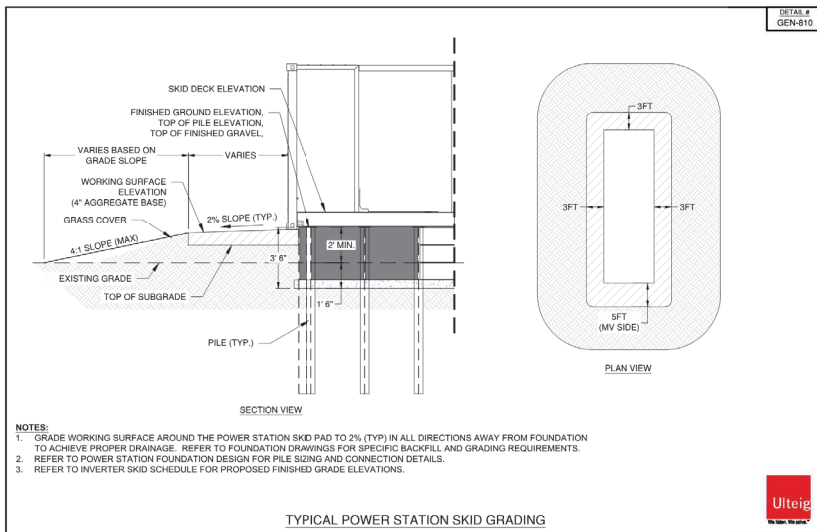

**FOX SQUIRREL
SOLAR, LLC.**
Madison County, Ohio

Rev. Date Description By
0 07/26/2022 ISSUED FOR CONSTRUCTION TLB

edf
renewables
15445 Innovation Dr
San Diego, CA 92128

**BLATTNER
ENERGY**
392 Co. Rd. 50,
Avon, MN 56310

OHIO811
Before You Dig

NAD 83 Ohio State Planes,
South Zone, US Feet

STATE OF OHIO
Professional Engineer
Name: K. BERENDS
E-88072
Date: July 26, 2022

Ulteig
3350 38th Avenue South
Fargo, North Dakota 58104
Phone: 701.280.8500
Fax: 701.237.3191
www.ulteig.com
Project Number: 21.00649
Design By: C. SMAALADEN
Drawn By: K. GUNDERSON
Approved By: L. JORDAHL

**CONSTRUCTION
DETAILS**

REVISION:
0
DRAWING:
FSSP-SG0-C-GRD0-D006

G:\2021\21.00649\Drawings\PV Plant\SG0-C\Detail - Drawings\01 - Plan Set Drawings\21.00649_FSSP_SG0-C-GRD0-D006.dwg

Rev.	Date	Description	By
0	07/26/2022	ISSUED FOR CONSTRUCTION	TL



392 Co. Rd. 50,
Avon, MN 56310



NAD 83 Ohio State Planes,
South Zone, IIS Foot



Date: July 26, 2022

Ulteig

REVISION:
0
DRAWING:
FSSP-SG0-C-GRD0-D007

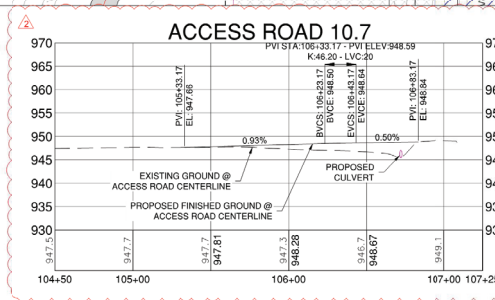
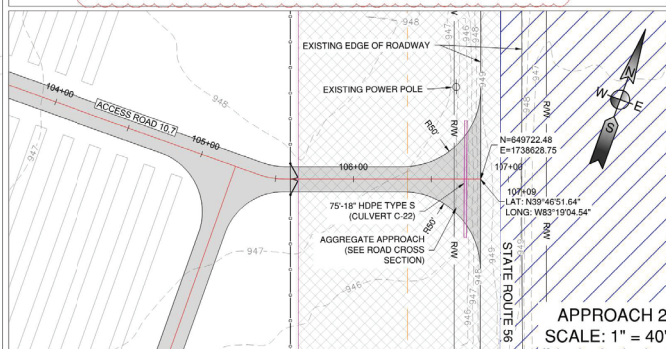
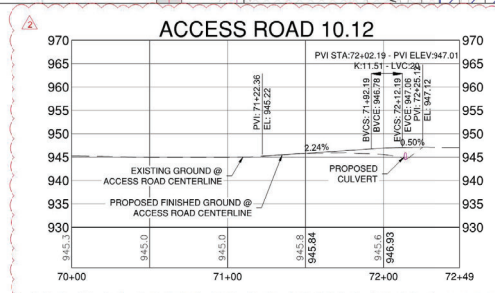
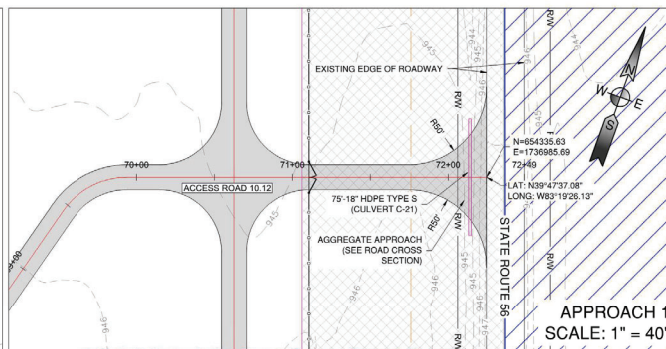
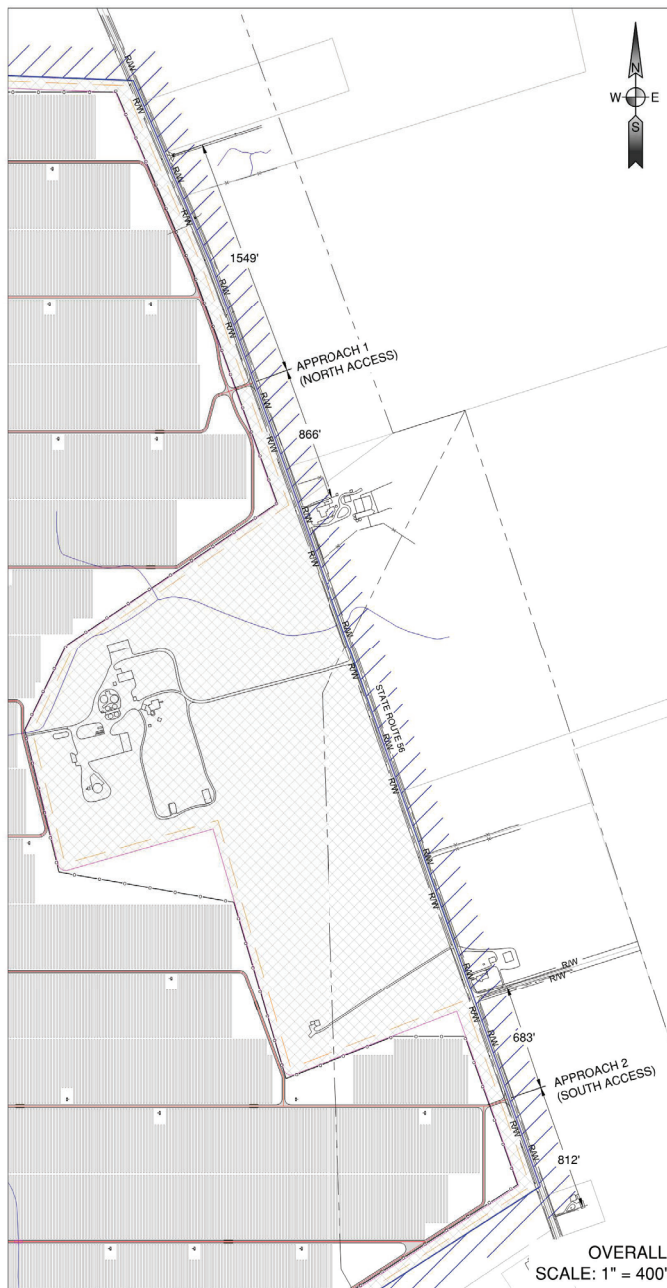

- LEGEND**
- PROJECT BOUNDARY
 - EXISTING RIGHT OF WAY
 - EXISTING PROPERTY BOUNDARY
 - EXISTING STREAM
 - EXISTING CULVERT
 - PV NON-BUILDABLE AREAS
 - FENCE NON-BUILDABLE BOUNDARY
 - PROPOSED 1" SITE ACCESS ROAD
 - PROPOSED CULVERT
 - PROPOSED GAME WIRE FENCE
 - PROPOSED PV ARRAY
 - PROPOSED INVERTER

APPROACH 1 (NORTH ACCESS)
STRAIGHT LINE MILE
COUNTY LOG - 17.264
STATE LOG - 26.712

APPROACH 2 (SOUTH ACCESS)
STRAIGHT LINE MILE
COUNTY LOG - 18.189
STATE LOG - 27.638

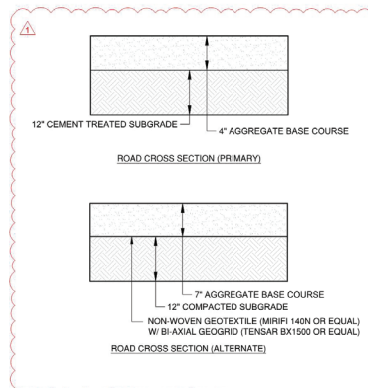

FOX SQUIRREL SOLAR, LLC.
Madison County, Ohio

Rev.	Date	Description	By
0	07/29/2022	ISSUED FOR CONSTRUCTION	TLB
1	08/18/2022	ADD TYPICAL SECTIONS	TLB
2	09/22/2022	PROFILE REVISIONS	TLB

edf
renewables
15445 Innovation Dr
San Diego, CA 92128

BLATTNER ENERGY
392 Co. Rd. 50,
Avon, MN 56310

OHIO811
Before You Dig

NAD 83 Ohio State Planes,
South Zone, US Feet



Date: September 23, 2022

Ulteig
3350 38th Avenue South
Fargo, North Dakota 58104
Phone: 701.280.8500
Fax: 701.237.3191
www.ulteig.com
Project Number: 21.00649
Design By: C. SMAALADEN
Drawn By: K. GUNDERSON
Approved By: L. JORDAHL

SITE ACCESS POINTS
- STATE ROUTE 56 -
DRIVEWAYS

REVISION:
2
DRAWING:
FSSP-SG0-C-GRD-P001

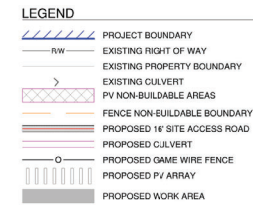
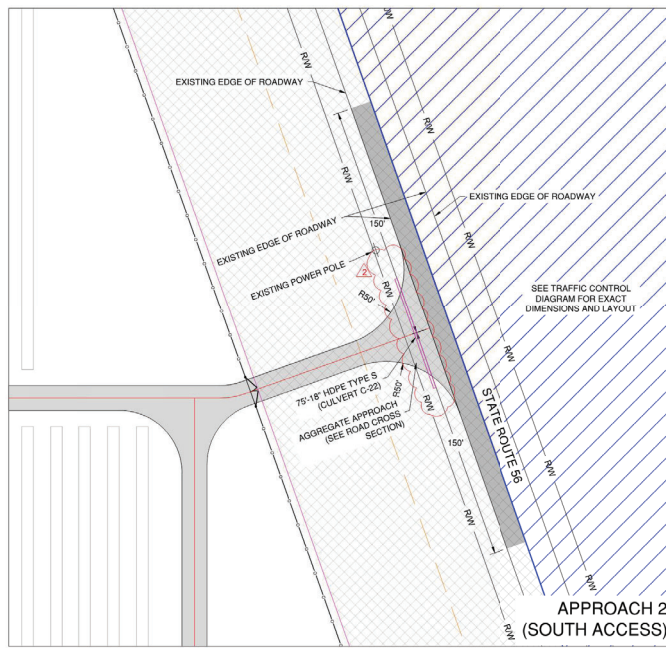
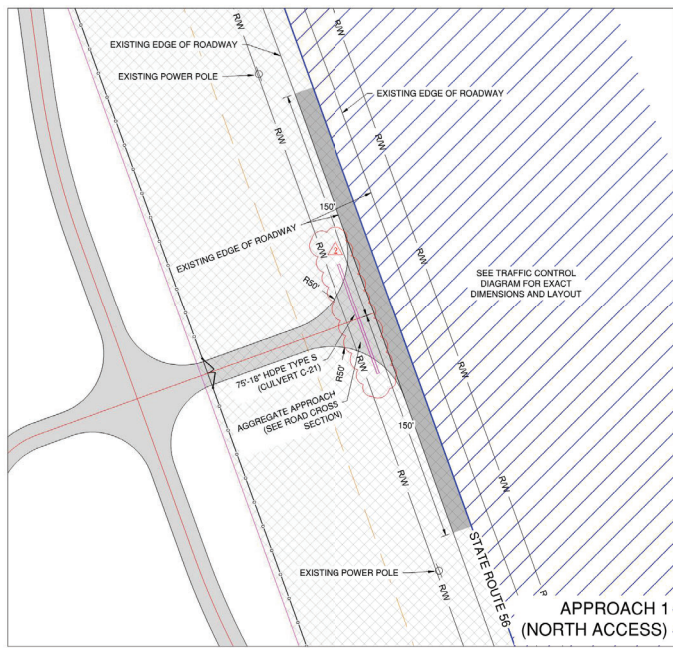

NOTE:
1. ONLY 1 WORK AREA TO IMPEDE STATE ROUTE 56 TRAFFIC AT ANY GIVEN TIME.

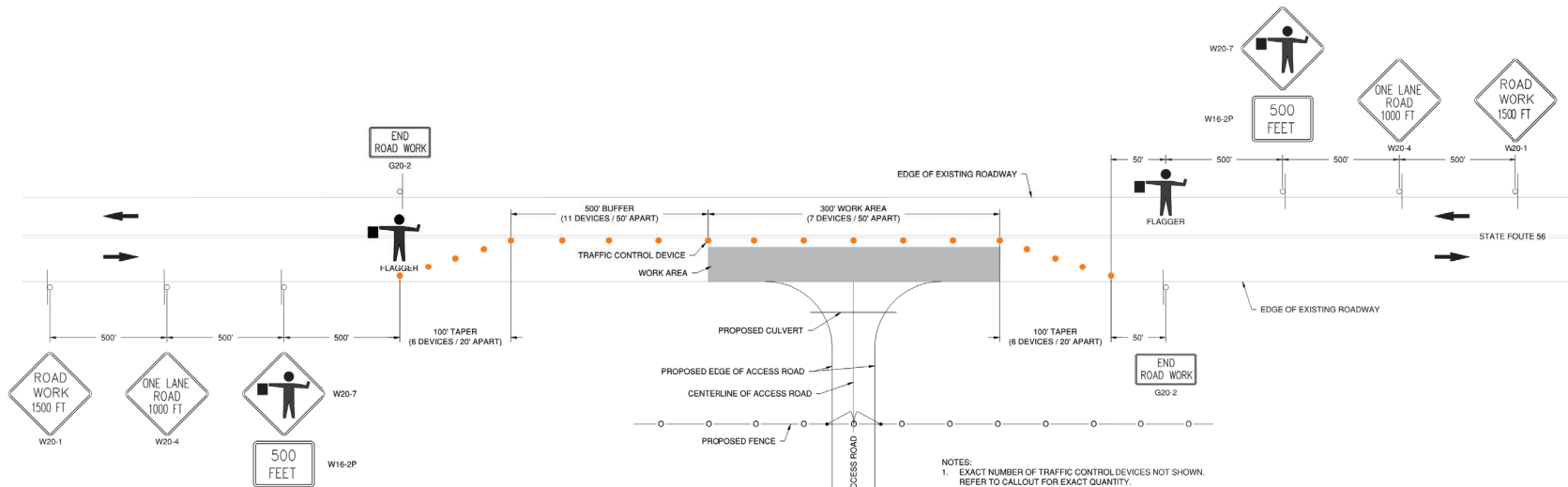

NOTES:
1. EXACT NUMBER OF TRAFFIC CONTROL DEVICES NOT SHOWN. REFER TO CALLOUT FOR EXACT QUANTITY.
2. DETAIL NOT TO SCALE.

TRAFFIC CONTROL - STATE ROUTE 56

FOX SQUIRREL SOLAR, LLC.
Madison County, Ohio

Rev.	Date	Description	By
0	07/29/2022	ISSUED FOR CONSTRUCTION	TLB
2	09/22/2022	CULVERTS ADDED	TLB

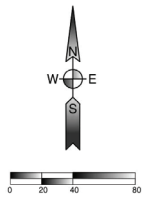

NAD 83 Ohio State Planes, South Zone, US Feet



SITE ACCESS POINTS - STATE ROUTE 56 - TRAFFIC CONTROL

REVISION:
2
DRAWING:
FSSP-SG0-C-GRD7-P002

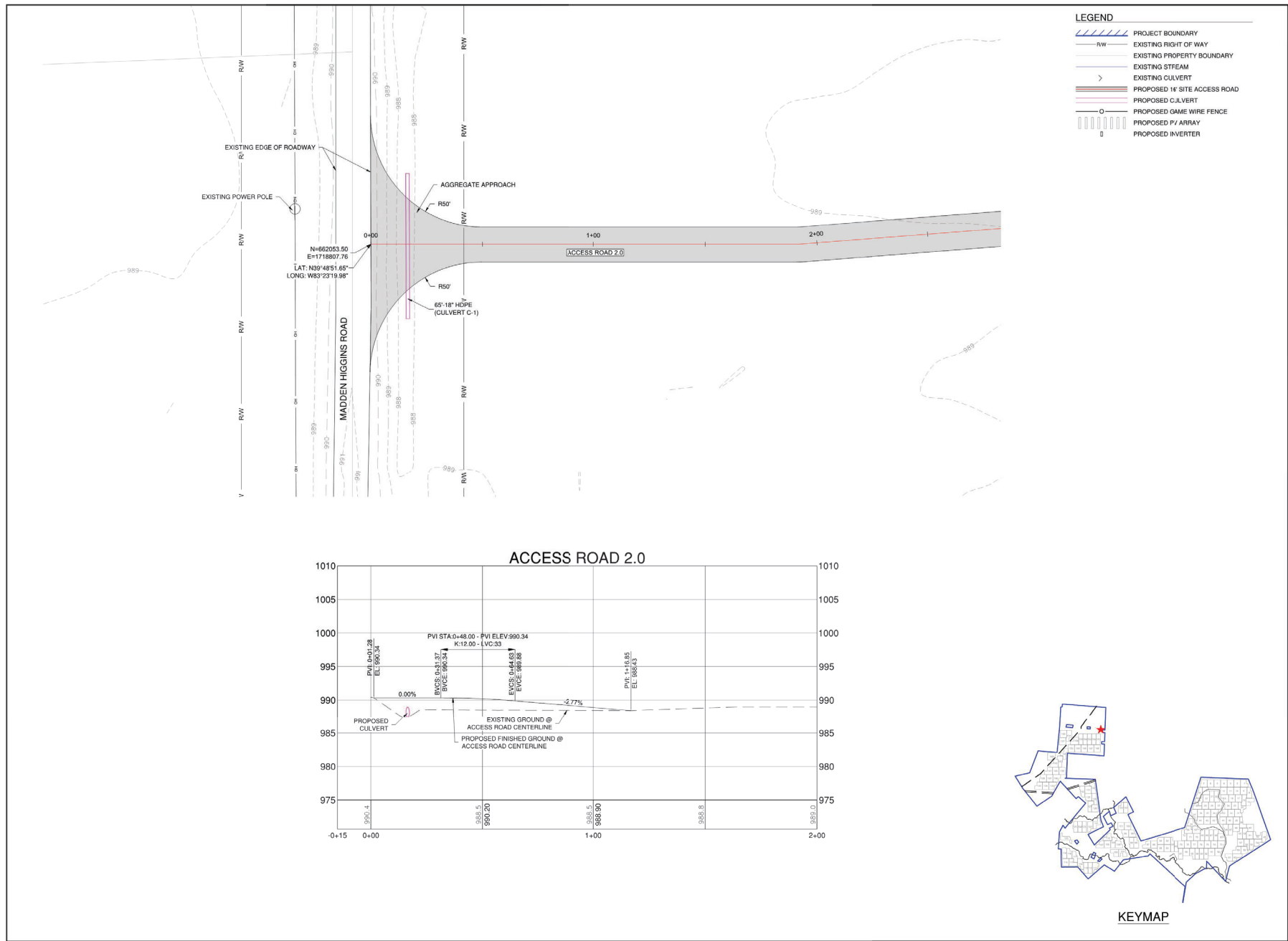

FOX SQUIRREL SOLAR, LLC. Madison County, Ohio

Rev.	Date	Description	By
0	07/26/2022	ISSUED FOR CONSTRUCTION	TLB

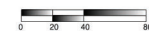

NAD 83 Ohio State Planes,
South Zone, US Feet



SITE ACCESS POINTS - MADDEN HIGGINS ROAD - DRIVEWAY

REVISION:
0
DRAWING:
FSSP-SG0-C-GRD7-P003

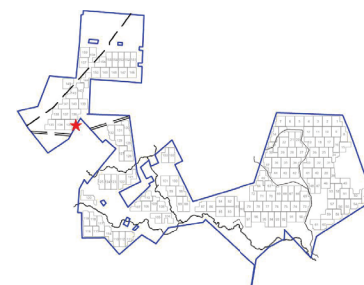
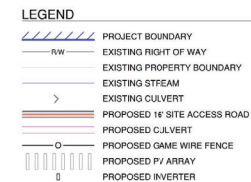

KEYMAP

**FOX SQUIRREL
SOLAR, LLC.**
Madison County, Ohio

Rev.	Date	Description	By
0	07/26/2022	ISSUED FOR CONSTRUCTION	TL



15445 Innovation Dr
San Diego, CA 92128



392 Co. Rd. 50,
Avon, MN 56310

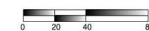

NAD 83 Ohio State Planes,
South Zone, US Foot



Date: July 26, 2022



3350 38th Avenue South
 Fargo, North Dakota 58104
 Phone: 701.280.8500
 Fax: 701.237.3191
 www.ulteig.com
 Project Number: 21.00649
 Design By: C. SMAALADEN
 Drawn By: L. ZEREN
 Approved By: L. JORDAHL

SITE ACCESS POINTS
- JOHNSTON ROAD -
DRIVEWAY

REVISION:
0

DRAWING:
FSSP-SG0-C-GRD7-P004

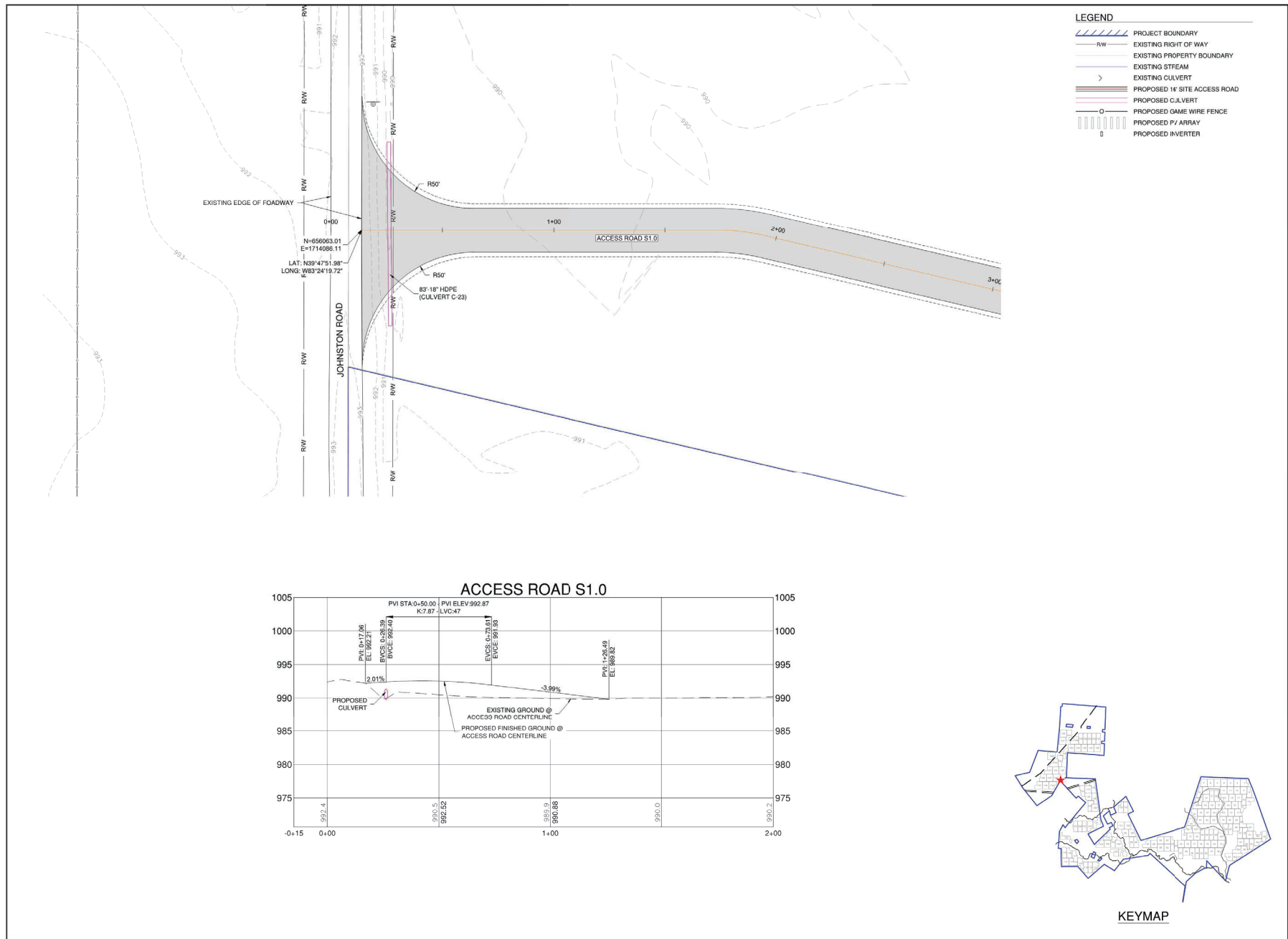

FOX SQUIRREL SOLAR, LLC. Madison County, Ohio

Rev.	Date	Description	By
0	07/26/2022	ISSUED FOR CONSTRUCTION	TLB

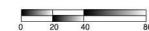
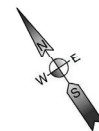

NAD 83 Ohio State Planes,
South Zone, US Feet



SITE ACCESS POINTS - JOHNSTON ROAD - DRIVEWAY

REVISION:
0
DRAWING:
FSSP-SG0-C-GRD7-P005

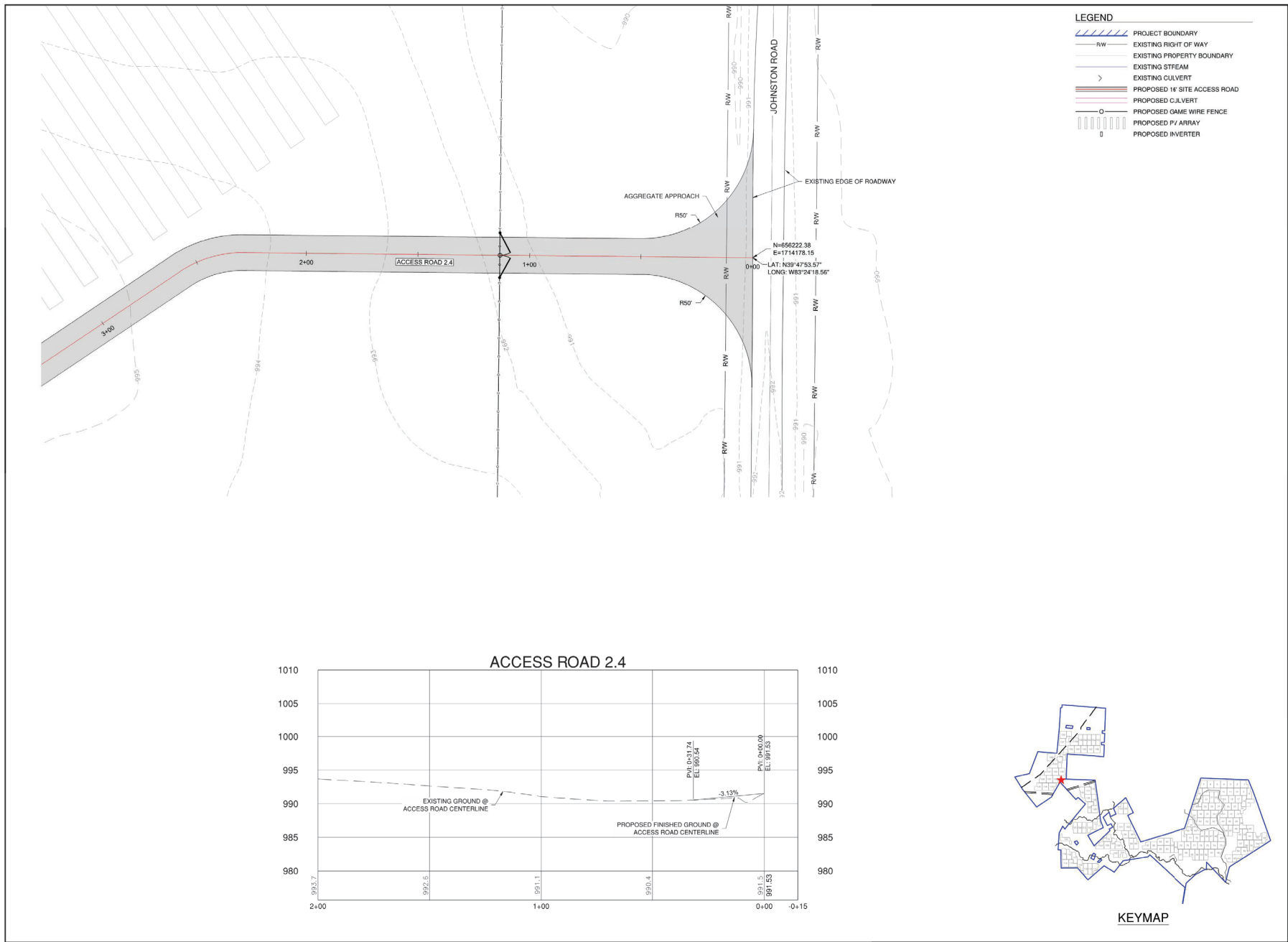

FOX SQUIRREL SOLAR, LLC.
Madison County, Ohio

Rev.	Date	Description	By
0	07/26/2022	ISSUED FOR CONSTRUCTION	TLB

edf renewables
15445 Innovation Dr
San Diego, CA 92128

BLATTNER ENERGY
392 Co. Rd. 50,
Avon, MN 56310

OHIO811
Before You Dig

North Arrow

Scale: 0, 20, 40, 80

NAD 83 Ohio State Planes, South Zone, US Feet

Professional Engineer
Date: July 26, 2022

Ulteig

3350 38th Avenue South
Fargo, North Dakota 58104
Phone: 701.280.8500
Fax: 701.237.3191
www.ulteig.com
Project Number: 21-00649
Design By: C. SMAALADEN
Drawn By: L. ZEREN
Approved By: L. JORDAHL

SITE ACCESS POINTS - JOHNSTON ROAD - DRIVEWAY

REVISION: 0

DRAWING: FSSP-SG0-C-GRD7-P006

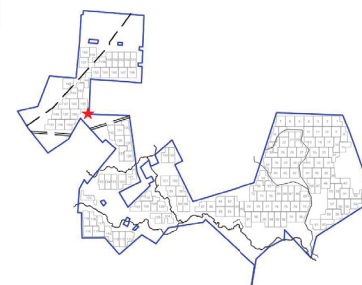
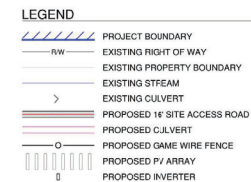

KEYMAP

**FOX SQUIRREL
SOLAR, LLC.**
Madison County, Ohio

Rev.	Date	Description	By
0	07/26/2022	ISSUED FOR CONSTRUCTION	TU



15445 Innovation Dr
San Diego, CA 92128



392 Co. Rd. 50,
Avon, MN 56310

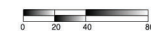
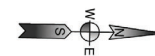

NAD 83 Ohio State Planes,
South Zone, US Foot



Date: July 26, 2022



3350 38th Avenue South
Fargo, North Dakota 58104
Phone: 701.280.8500
Fax: 701.237.3191
www.ulteig.com
Project Number: 21.00649
Design By: C. SMAALADEN
Drawn By: L. ZEREN
Approved By: L. JORDAHL

SITE ACCESS POINTS
- JOHNSTON ROAD -
DRIVEWAY

REVISION:
0

DRAWING:
FSSP-SG0-C-GRD7-P007

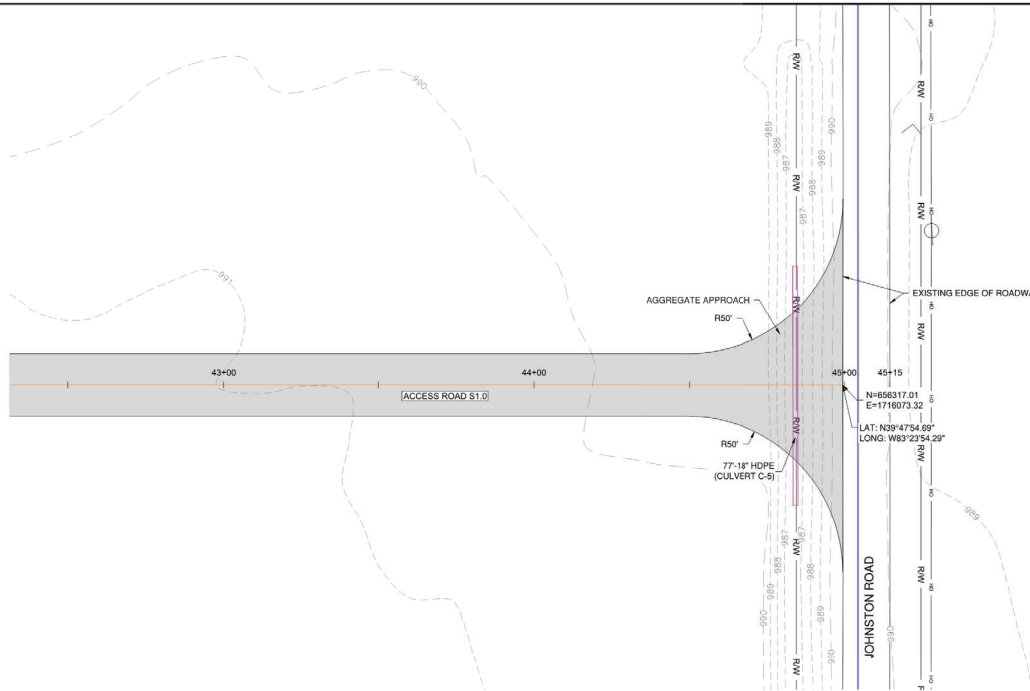

LEGEND

	PROJECT BOUNDARY
	EXISTING RIGHT OF WAY
	EXISTING PROPERTY BOUNDARY
	EXISTING STREAM
	EXISTING CULVERT
	PROPOSED 1' SITE ACCESS ROAD
	PROPOSED C.J. VERT
	PROPOSED GAME WIRE FENCE
	PROPOSED PV ARRAY
	PROPOSED INVERTER

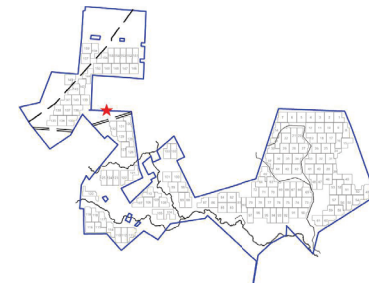
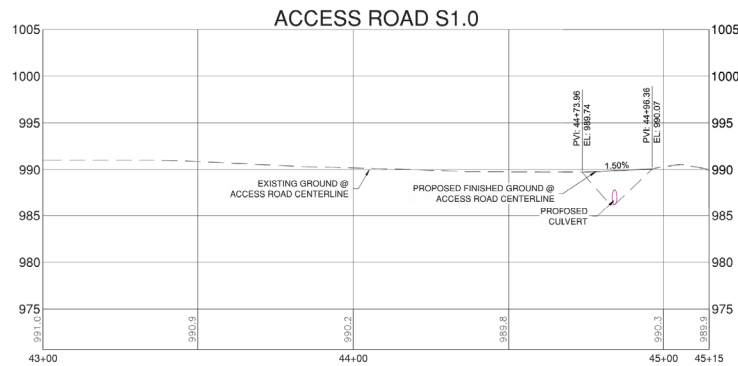

KEYMAP

**FOX SQUIRREL
SOLAR, LLC.**
Madison County, Ohio

Rev.	Date	Description	By
0	07/26/2022	ISSUED FOR CONSTRUCTION TLB	

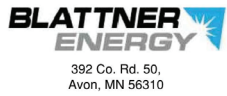

NAD 83 Ohio State Planes,
South Zone, US Feet



**SITE ACCESS POINTS
- JOHNSTON ROAD -
DRIVEWAY**

REVISION:
0
DRAWING:
FSSP-SG0-C-GRD7-P008

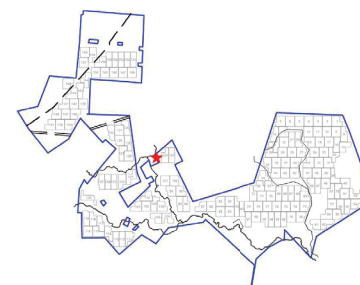
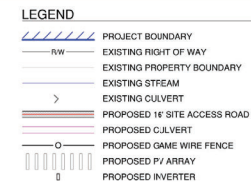

KEYMAP

**FOX SQUIRREL
SOLAR, LLC.**
Madison County, Ohio

Rev.	Date	Description	By
0	07/26/2022	ISSUED FOR CONSTRUCTION	TL



15445 Innovation Dr
San Diego, CA 92128



392 Co. Rd. 50,
Avon, MN 56310



NAD 83 Ohio State Planes,
South Zone, IIS Foot



Date: July 26, 2022



3350 38th Avenue South
 Fargo, North Dakota 58104
 Phone: 701.280.8500
 Fax: 701.237.3191
 www.uliteig.com
 Project Number: 21.00649
 Design By: C. SMAALADEN
 Drawn By: L. ZEREN
 Approved By: L. JORDAHL

SITE ACCESS POINTS
- VAN WAGENER
ROAD - DRIVEWAY

REVISION:
0

DRAWING:
FSSP-SG0-C-GRD7-P009

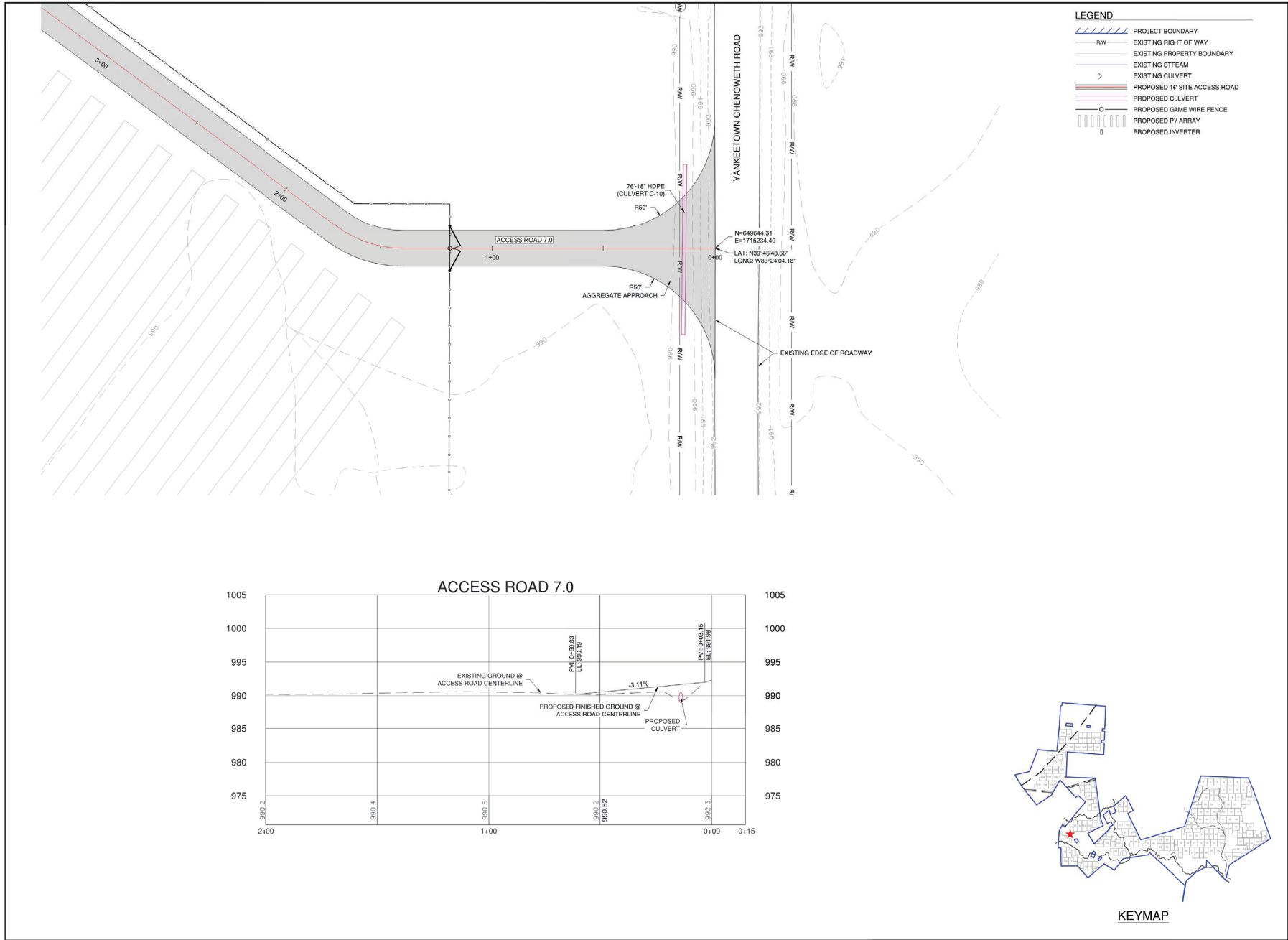

FOX SQUIRREL SOLAR, LLC.
Madison County, Ohio

Rev.	Date	Description	By
0	07/26/2022	ISSUED FOR CONSTRUCTION	TLB

edf
renewables
15445 Innovation Dr
San Diego, CA 92128

BLATTNER ENERGY
392 Co. Rd. 50,
Avon, MN 56310

OHIO811
Before You Dig

0 20 40 80

NAD 83 Ohio State Planes,
South Zone, US Feet

Date: July 26, 2022

3350 38th Avenue South
Fargo, North Dakota 58104
Phone: 701.280.8500
Fax: 701.237.3191
www.ulteig.com
Project Number: 21-00649
Design By: C. SMAALADEN
Drawn By: L. ZEREN
Approved By: L. JORDAHL

SITE ACCESS POINTS - YANKEETOWN CHEROWETH ROAD - DRIVEWAY

REVISION:
0
DRAWING:
FSSP-SG0-C-GRD7-P010

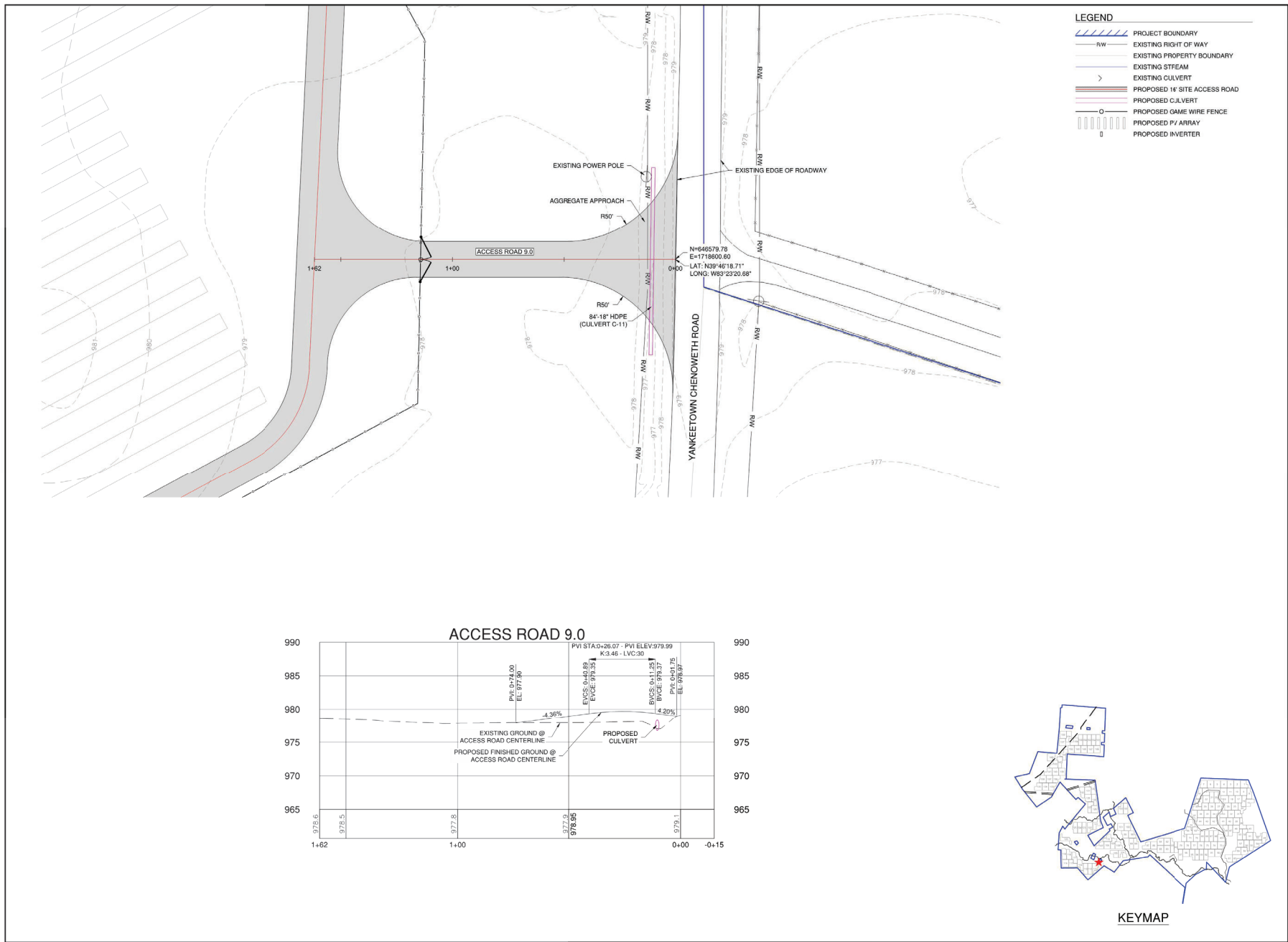

**FOX SQUIRREL
SOLAR, LLC.**
 Madison County, Ohio

Rev.	Date	Description	By
0	07/26/2022	ISSUED FOR CONSTRUCTION	TLB

15445 Innovation Dr
San Diego, CA 92128

392 Co. Rd. 50,
Avon, MN 56310

Before You Dig

NAD 83 Ohio State Planes,
South Zone, US Feet

Date: July 26, 2022

3350 38th Avenue South
Fargo, North Dakota 58104
Phone: 701.280.8500
Fax: 701.237.3191
www.ulteig.com
Project Number: 21.00649
Design By: C. SMAALADEN
Drawn By: L. ZEREN
Approved By: L. JORDAHL

**SITE ACCESS POINTS
- YANKEETOWN
CHENOWETH ROAD -
DRIVEWAY**

REVISION:
0

DRAWING:
FSSP-SG0-C-GRD7-P011

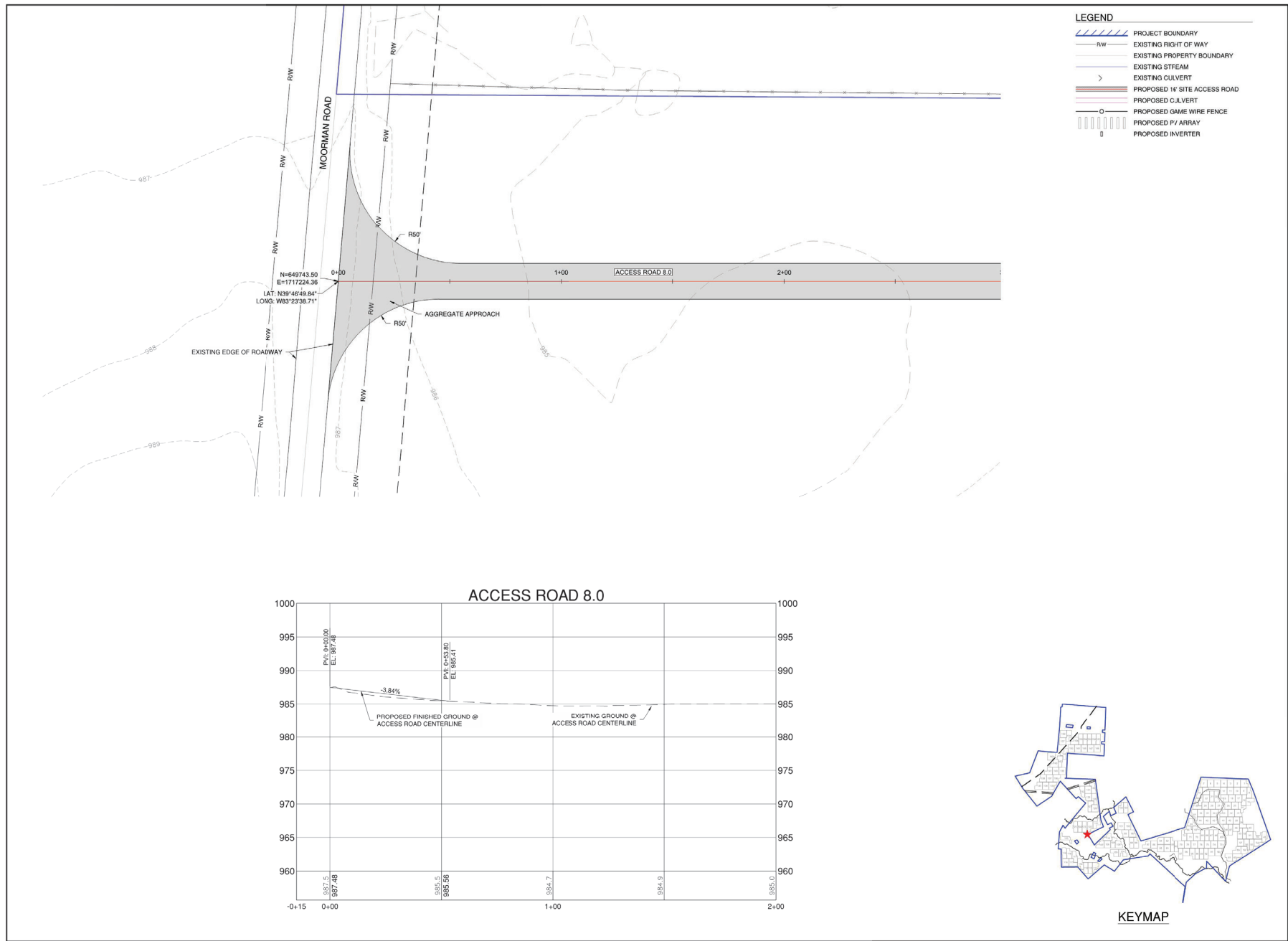

- LEGEND**
- PROJECT BOUNDARY
 - EXISTING RIGHT OF WAY
 - EXISTING PROPERTY BOUNDARY
 - EXISTING STREAM
 - EXISTING CULVERT
 - PROPOSED 1" SITE ACCESS ROAD
 - PROPOSED CULVERT
 - PROPOSED GAME WIRE FENCE
 - PROPOSED PV ARRAY
 - PROPOSED INVERTER

FOX SQUIRREL SOLAR, LLC.
Madison County, Ohio

Rev.	Date	Description	By
0	07/26/2022	ISSUED FOR CONSTRUCTION	TLB

edf
renewables
15445 Innovation Dr
San Diego, CA 92128

BLATTNER ENERGY
392 Co. Rd. 50,
Avon, MN 56310

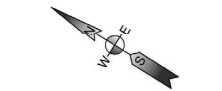

0 20 40 80
NAD 83 Ohio State Planes,
South Zone, US Feet



Ulteig
3350 38th Avenue South
Fargo, North Dakota 58104
Phone: 701.280.8500
Fax: 701.237.3191
www.ulteig.com
Project Number: 21.00649
Design By: C. SMAALADEN
Drawn By: L. ZEREN
Approved By: L. JORDAHL

**SITE ACCESS POINTS
- MOORMAN ROAD -
DRIVEWAY**

REVISION:
0
DRAWING:
FSSP-SG0-C-GRD7-P012

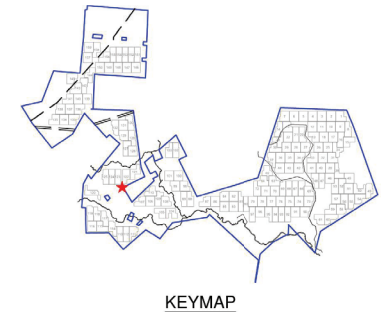

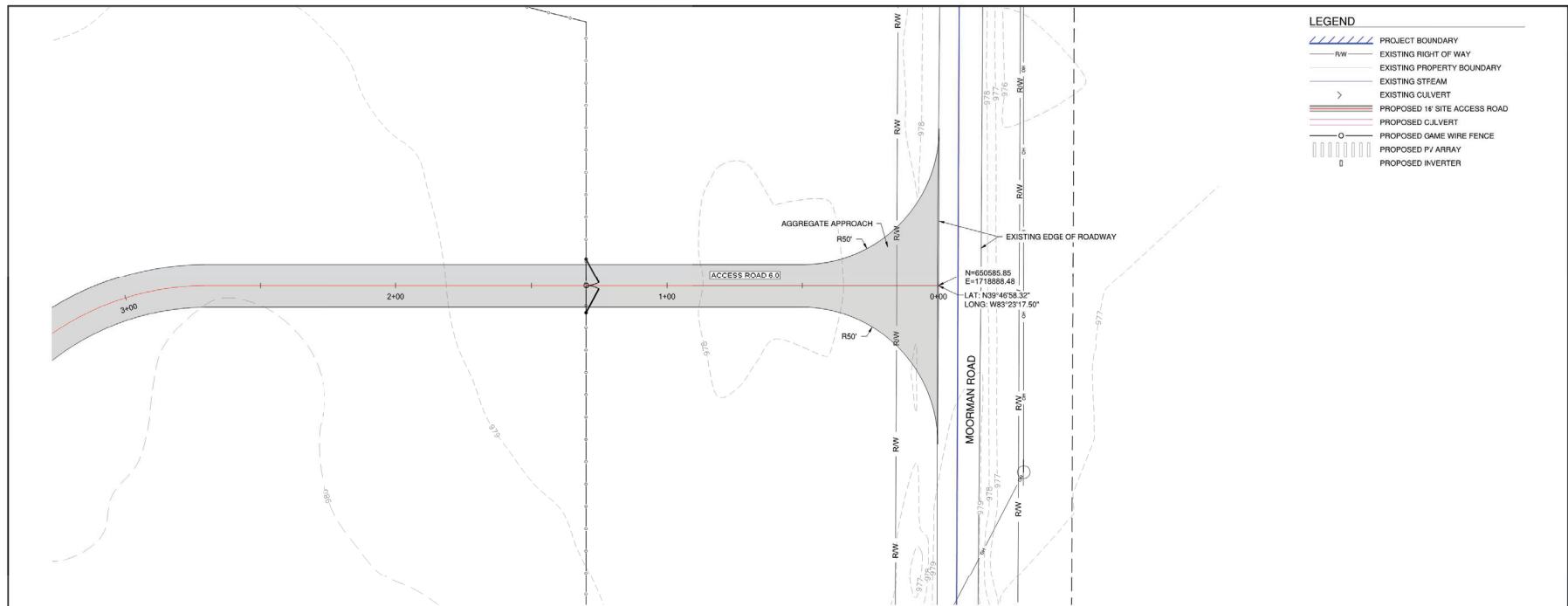

LEGEND

	PROJECT BOUNDARY
	EXISTING RIGHT OF WAY
	EXISTING PROPERTY BOUNDARY
	EXISTING STREAM
	EXISTING CULVERT
	PROPOSED 16' SITE ACCESS ROAD
	PROPOSED CULVERT
	PROPOSED GAME WIRE FENCE
	PROPOSED PV ARRAY
	PROPOSED INVERTER

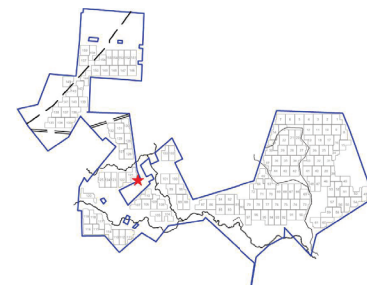
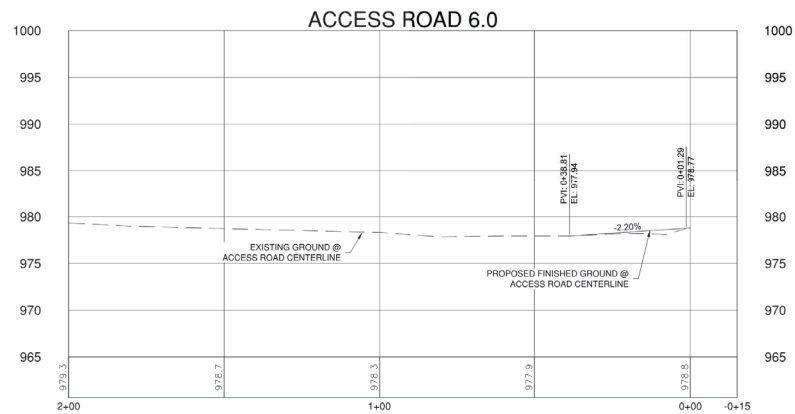

KEYMAP

**FOX SQUIRREL
SOLAR, LLC.**
Madison County, Ohio

Rev.	Date	Description	By
0	07/26/2022	ISSUED FOR CONSTRUCTION	TLB

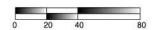
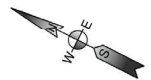
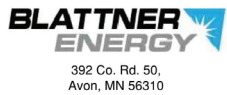

NAD 83 Ohio State Planes,
South Zone, US Feet



**SITE ACCESS POINTS
- MOORMAN ROAD -
DRIVEWAY**

REVISION:
0
DRAWING:
FSSP-SG0-C-GRD7-P013

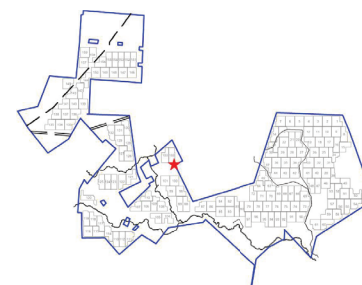
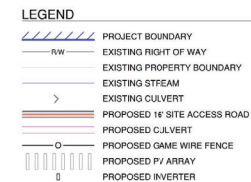

KEYMAP

DRAWING:
FSSP-SG0-C-GRD7-P014

**This foregoing document was electronically filed with the Public Utilities
Commission of Ohio Docketing Information System on**

10/11/2022 2:37:44 PM

in

Case No(s). 20-0931-EL-BGN, 21-1031-EL-BGA

Summary: Notice - Part 11 of 12 - Compliance with Condition 4 – IFC Civil Design
Engineering Drawings electronically filed by Christine M.T. Pirik on behalf of Fox
Squirrel Solar, LLC