

ALTERNATIVE SEDIMENT BASIN NOTE:

1. SEE PLANS FOR RECOMMENDED ALTERNATIVE SEDIMENT BASIN LOCATIONS. THESE ARE BEING SHOWN FOR ILLUSTRATION PURPOSES IN AN EFFORT TO NOT IMPACT THE PROVIDED ARRAY LAYOUT CONFIGURATION. THE ITERATIVE NATURE OF THE LAYOUT DESIGN PROCESS WILL OCCUR PRIOR TO FUTURE PLAN SETS. ADDITIONAL CALCULATIONS ARE NEEDED TO CONFIRM SIZING OF COMPOST FILTER SOCK. IF COMPOST FILTER SOCK SIZING IS INADEQUATE, ARRAY LAYOUT MODIFICATIONS MAY BE REQUIRED TO ACCOMMODATE THE ALTERNATIVE SEDIMENT BASIN LOCATIONS FOR COMPLIANCE WITH CHAPTERS 5, 6 & 7 OF THE OHIO RAINWATER AND LAND DEVELOPMENT MANUAL.

CONCEPT GRADING LEGEND:

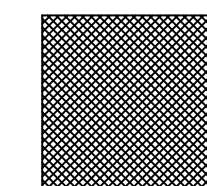
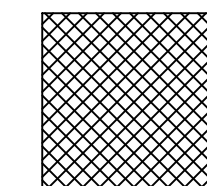
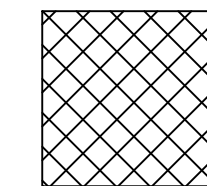

*SEE SHEET C-001 FOR EARTHWORK QUANTITIES AND EARTHWORK NOTES.



KLEINFELDER
Bright People. Right Solutions.

707 17TH STREET, SUITE 3000
DENVER, CO 80202
PHONE: 303-237-6801
WWW.KLEINFELDER.COM

[illegible]

10% DESIGN
NOT FOR CONSTRUCTION

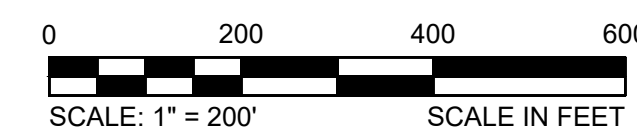
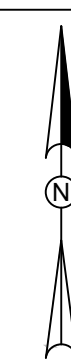

ORIGINAL DRAWING SIZE IS 24 x 36

GRADING & EROSION CONTROL PLAN

BIRCH SOLAR PROJECT
ALLEN COUNTY, OH
AUGLAIZE COUNTY, OH



LIGHTSOURCE bp
400 MONTGOMERY ST, 8TH FLOOR
SAN FRANCISCO, CA 94104

10% CIVIL DESIGN

PROJECT NO. 2012135.001A	C-309
ISSUE DATE 01/14/2021	
CURRENT REVISION A	
DESIGNED BY ARH	
DRAWN BY ARH	
CHECKED BY MDI	
APPROVED BY CGO	SHEET C-309 of 42

KEY MAP

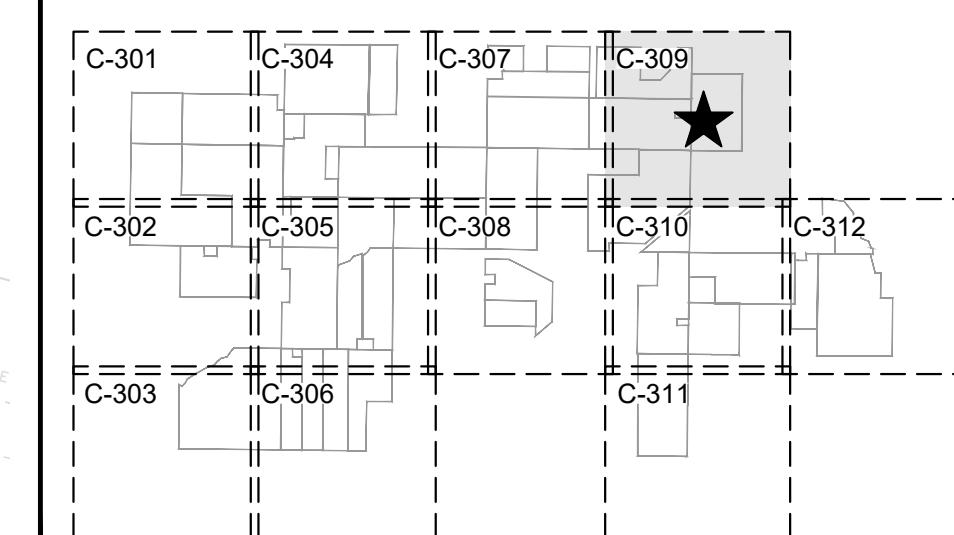

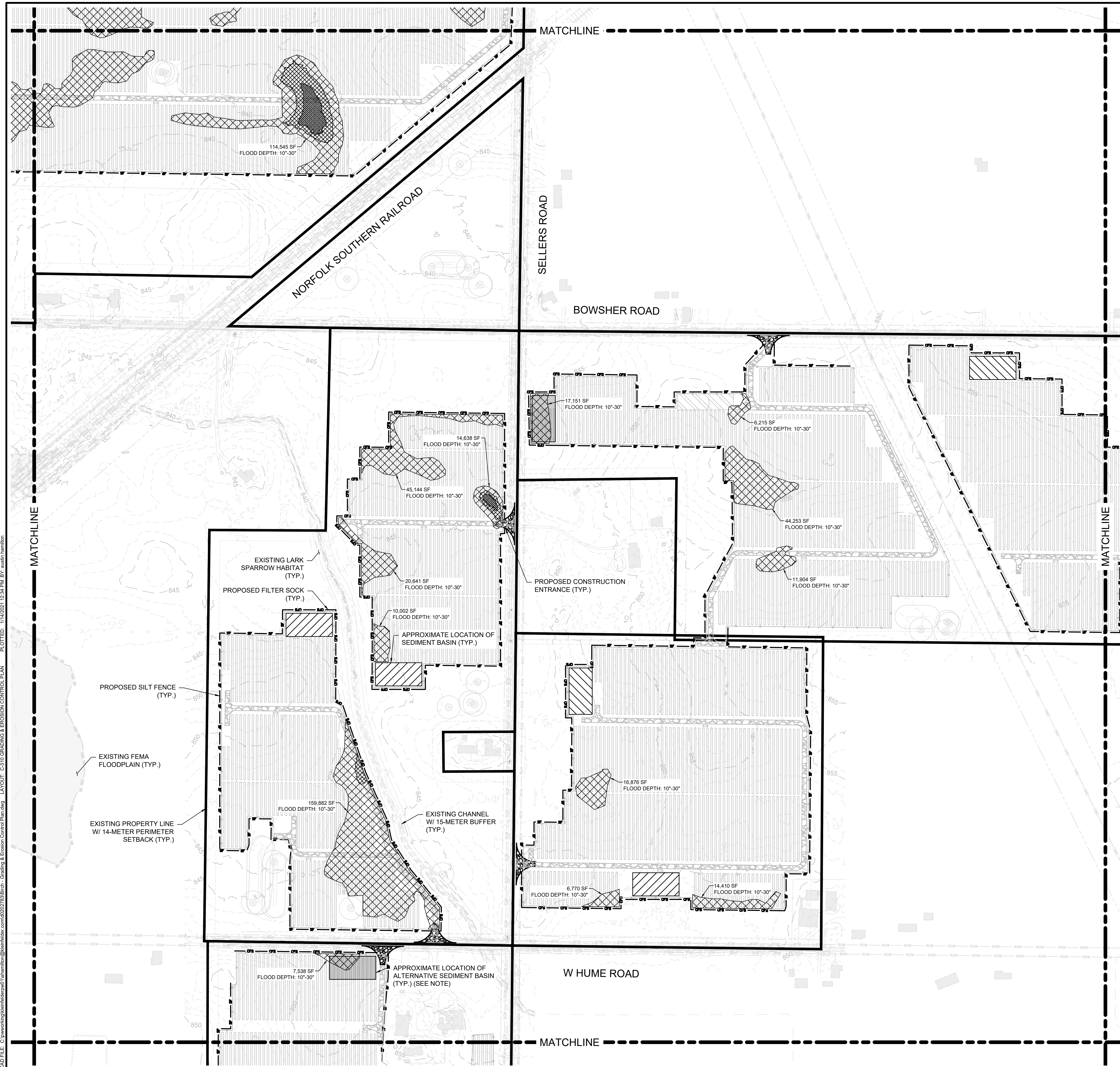

SELLERS ROAD

BOWSHER ROAD

W HUME ROAD

MATCHLINE

EXISTING LARK —
SPARROW HABITAT
(TYP.)

PROPOSED FILTER SOCK —
(TYR)

PROPOSED SILT FENCE
(TYP.)

EXISTING FEMA
FLOODPLAIN (TYP.)

EXISTING PROPERTY LINE
W/ 14-METER PERIMETER
SETBACK (TYP.)

EXISTING CHANNEL
W/ 15-METER BUFFER
(TYP.)

17,151 SF
FLOOD DEPTH: 10"-30"

14,638 SF—
FLOOD DEPTH: 10"-30"

45,144 SF
FLOOD DEPTH: 10"-30"

TELEPHONE DEPT. 10-7300

SEDIMENT BASIN (7)

A hand-drawn diagram of a cell. It features a large, irregular outer boundary representing the cell membrane. Inside, there is a smaller, roughly circular structure labeled 'Nucleus' with a central dot. To the right of the nucleus is a large, clear, oval-shaped area labeled 'Vacuole'. The space between the nucleus and the vacuole is filled with small dots, representing cytoplasm.

TERNATIVE SEDIMENT
() (SEE NOTE)

ALTERNATIVE SEDIMENT BASIN NOTE:

1. SEE PLANS FOR RECOMMENDED ALTERNATIVE SEDIMENT BASIN LOCATIONS. THESE ARE BEING SHOWN FOR ILLUSTRATION PURPOSES IN AN EFFORT TO NOT IMPACT THE PROVIDED ARRAY LAYOUT CONFIGURATION. THE ITERATIVE NATURE OF THE LAYOUT DESIGN PROCESS WILL OCCUR PRIOR TO FUTURE PLAN SETS. ADDITIONAL CALCULATIONS ARE NEEDED TO CONFIRM SIZING OF COMPOST FILTER SOCK. IF COMPOST FILTER SOCK SIZING IS INADEQUATE, ARRAY LAYOUT MODIFICATIONS MAY BE REQUIRED TO ACCOMMODATE THE ALTERNATIVE SEDIMENT BASIN LOCATIONS FOR COMPLIANCE WITH CHAPTER 5, 6 & 7 OF THE OHIO RAINWATER AND LAND DEVELOPMENT MANUAL.

CONCEPT GRADING LEGEND:

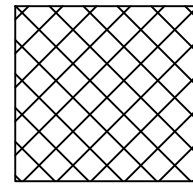

PROPOSED FILL
(AREAS OF 10"-30" OF FLOOD DEPTH)

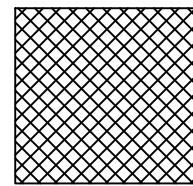

PROPOSED FILL
(AREAS OF 18"-30" OF FLOOD DEPTH)

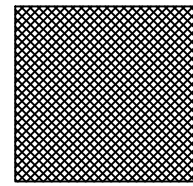

PROPOSED FILL
(AREAS OF 24"-30" OF FLOOD DEPTH)

*SEE SHEET C-001 FOR EARTHWORK QUANTITIES AND EARTHWORK NOTES

[illegible]

ROAD FILE: C:\pwworking\kiefelder\pww01\ahamilton@kiefelder.com\02022783\Birch - Grading & Erosion Control Plan.dwg LAYOUT: C-310 GRADING & EROSION CONTROL PLAN PLOTTED: 1/14/2021 12:34 PM BY: austin hamilton

This foregoing document was electronically filed with the Public Utilities

Commission of Ohio Docketing Information System on

2/17/2021 3:20:02 PM

in

Case No(s). 20-1605-EL-BGN

Summary: Notice - Notice - Large Exhibit A, Site Plan (Part 12 of 14) electronically filed by Christine M.T. Pirik on behalf of Birch Solar 1, LLC