

VIA HAND DELIVERY

December 6, 2018

Ms. Barcy F. McNeal, Secretary
Ohio Power Siting Board
180 E. Broad Street, 11th Floor
Columbus, Ohio 43215

Re: **In the Matter of the Application of Hecate Energy Highland LLC for a Certificate of Environmental Compatibility and Public Need to Construct a Solar-Powered Electric Generating Facility in Highland County, Ohio, Case No. 18-1334-EL-BGN (Before the Ohio Power Siting Board)/Supplement to Application**

Dear Ms. McNeal:

On October 9, 2019, Hecate Energy Highland LLC ("Hecate") filed an application for a certificate of environmental compatibility and public need with the Ohio Power Siting Board to construct a solar-powered electric generating facility in Highland County, Ohio ("Application"). Hecate is filing this supplement to provide the Board with additional information regarding the Application. Hecate asks that the Board consider the following supplemental information as a part of the Application in this matter:

- GIS mapping data of collection lines and access roads demonstrating no impacts to wetlands and jurisdictional waters from the project as set forth in the Application at p 53 at the section captioned [4906-4-08(B)(1)(b)];
- Map of culturally significant landmarks within a ten-mile radius of the Project pursuant to Ohio Administrative Code 4906-4-08(D)(1)

This letter setting forth Hecate's supplement to the Application and the maps are being filed electronically. In addition, ten (10) USB drives containing the foregoing supplemental information in the Application have been hand delivered to you. After reviewing this supplemental information, please let us know if you have any further questions or need additional information.

Respectfully submitted,

A handwritten signature in blue ink, appearing to read "Karen A. Winters", is written over the typed name.

Karen A. Winters
Squire Patton Boggs (US) LLP

Enclosures

cc: Patti Shorr
Danelle M. Gagliardi

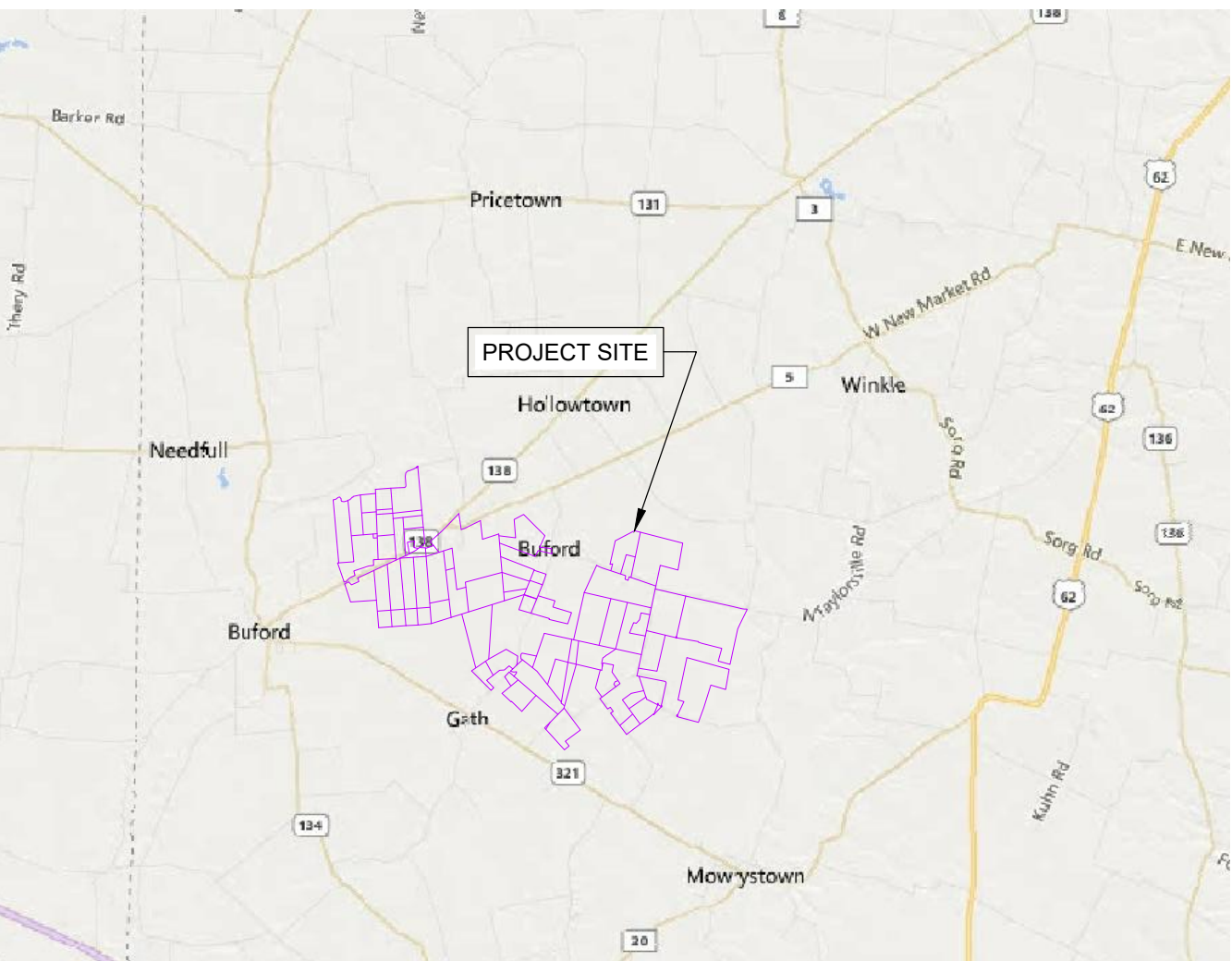
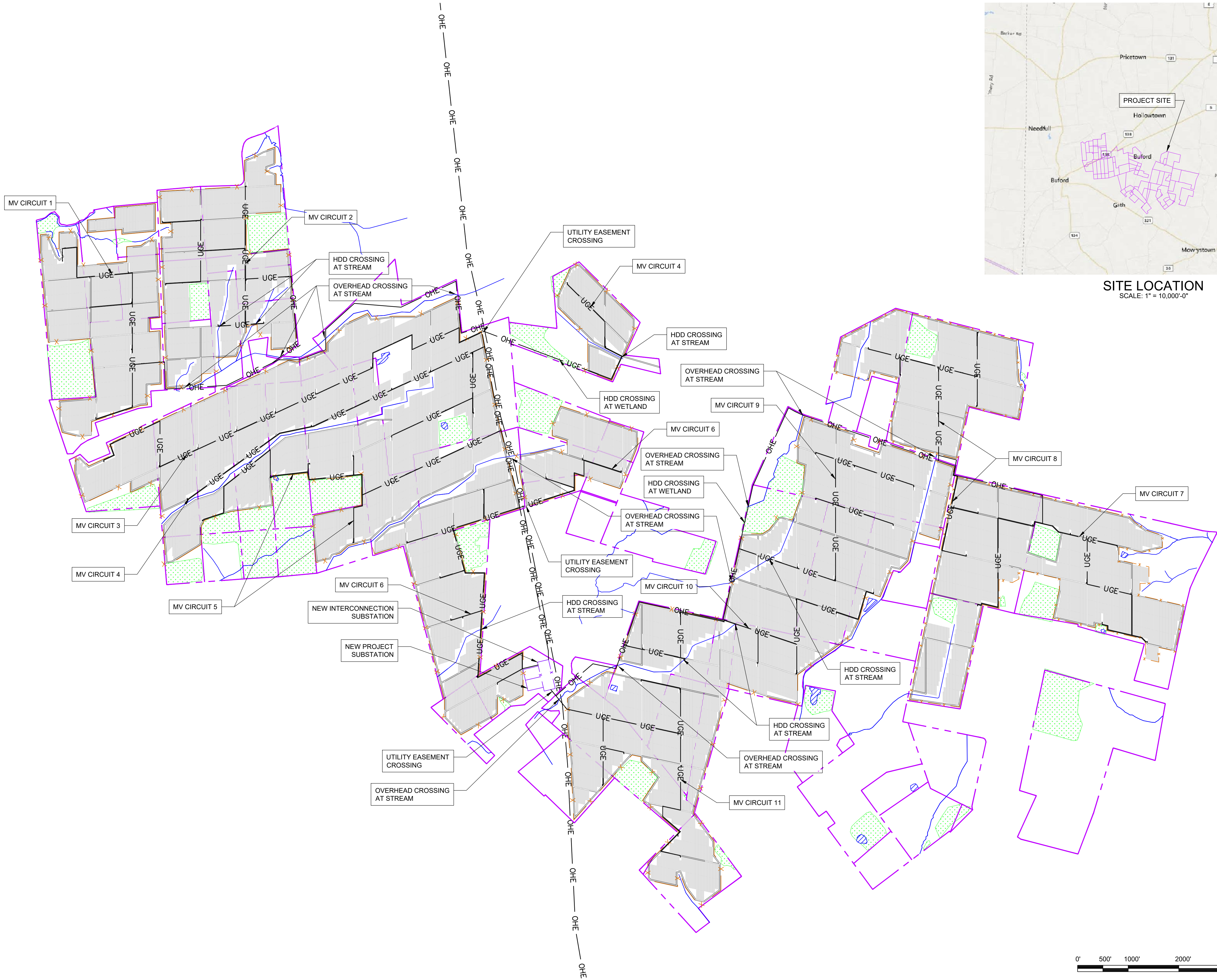

SITE LOCATION
SCALE: 1" = 10,000'-0"

Notes

CAPACITY (AC): 3000 MW
PV MODULES: MFR: RIZEN
INVERTERS: MFR: CHINT
ARRAY: MFR: ARCTECH
TYPE: S.A.T.

Legend

- PROPERTY BOUNDARY
- LEASED AREA
- PV PLANT FENCE
- PUBLIC ROADS
- BLOCK OUTLINES
- OHE OVERHEAD ELECTRIC LINE
- GAS PIPELINE
- SURFACE WATER
- WETLANDS
- BAT HABITAT
- UGE AC COLLECTION SYSTEM TRENCHES
- DC DC TRENCHES
- GRAVEL ROADS

Reference Drawings

A	12/06/18	ARB	ISSUED FOR OPSB REVIEW	JAB	JAB
Rev	Date	Drawn	Description	CK	UNLESS



101 Station Drive
Suite 130
Westwood, MA 02090
United States
T +1 (781) 915-0015
F +1 (781) 915-0001
W www.mottmac.com

Client



Title
AC COLLECTION SYSTEM
HIGHLAND SOLAR PROJECT

PRELIMINARY NOT FOR CONSTRUCTION REPLACE WITH ENGINEERS STAMP AT CONSTRUCTION AND/OR FABRICATION	Designed	-	Eng check	NJM
	Drawn	ARB	Approved	MB
	Dwg check	-	Project Mngr	JAB
	Scale at ANSI D	Date	Rev	
	1" = 1000'-0"	12/06/18	A	
Drawing Number	HIGHLAND-E-001			

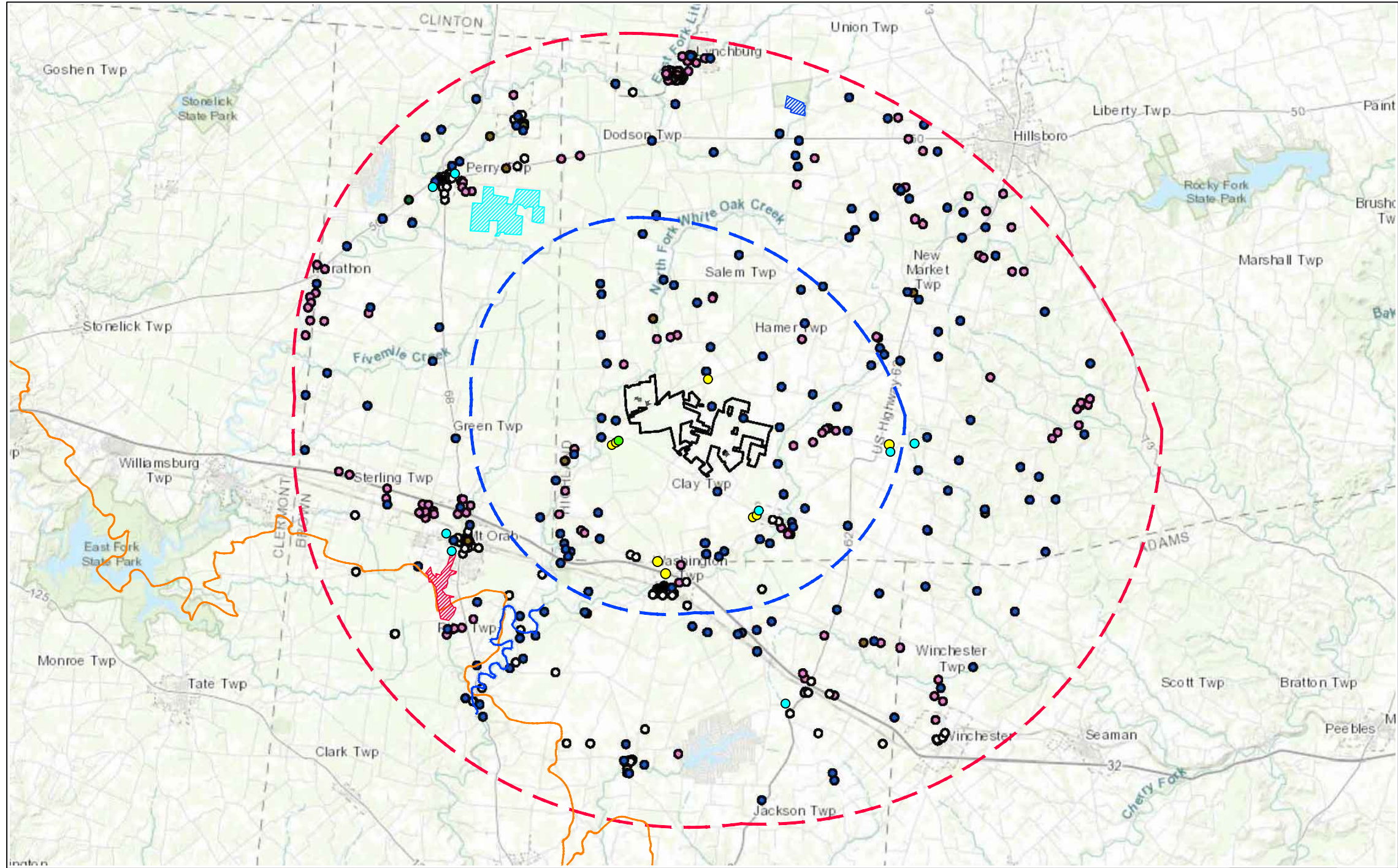

LEGEND

- PROJECT BOUNDARY
- 10 MILE RADIUS
- 5 MILE RADIUS
- CEMETERIES
- RECREATION AREAS
- SCHOOLS
- CHURCHES
- HISTORIC STRUCTURES
- ARCHAEOLOGY SITES

- NORTH COUNTRY NATIONAL SCENIC TRAIL
- WHITE OAK CREEK
- NATIONAL REGISTRY DETERMINATIONS OF ELIGIBILITY
- NATIONAL REGISTRY BOUNDARIES
- NATIONAL REGISTRY LISTINGS
- INDIAN CREEK WILDLIFE AREA
- OLDAKER STATE WILDLIFE AREA
- GRANT LAKE WILDLIFE AREA

Project Mgr:	EK
Drawn By:	JSL
Checked By:	MRF/EK
Approved By:	EK

Project No.	49187638
Scale:	AS SHOWN
File No.	49187638-1
Date:	OCT. 2018

Terracon
Consulting Engineers and Scientists

2105 Newpoint Place, Ste. 600 Lawrenceville, GA 30043
(770) 623-0755 (770) 623-9628

VIEWSHED GENERAL MAP
AESTHETIC RESOURCES MAP
PROPOSED HIGHLAND SOLAR FARM
STATE ROUTE 138 & HIGHLAND COUNTY ROAD 5
BUFORD, HIGHLAND COUNTY, OH

EXHIBIT

1

This foregoing document was electronically filed with the Public Utilities

Commission of Ohio Docketing Information System on

12/6/2018 4:57:08 PM

in

Case No(s). 18-1334-EL-BGN

Summary: Application (Supplement) to Application electronically filed by Ms. Karen A. Winters on behalf of Hecate Energy Highland LLC