



Legal Department

American Electric Power
1 Riverside Plaza
Columbus, OH 43215-2373
AEP.com

February 16, 2018

Chairman Asim Z. Haque
Ohio Power Siting Board
180 East Broad Street
Columbus, Ohio 43215

Hector Garcia
Christen M. Blend
Senior Counsel –
Regulatory Services
(614) 716-3410 (P)
(614) 716-1915 (P)
hgarcia1@aep.com
cmblend@aep.com

Re: Case No. 17-0806-EL-BLN
In the Matter of the Letter of Notification Application of AEP Ohio
Transmission Company, Inc. for a Certificate of Environmental
Compatibility and Public Need for the Heppner Station Project
Notice of Adjustment to Access Road

Dear Chairman Haque,

After consulting with OPSB Staff, AEP Ohio Transmission Company, Inc. (“AEP Ohio Transco”) provides the following notice of adjustment to the location of the access road associated with the above-referenced Project. The access road location required an adjustment due to the rugged terrain on the property on which Heppner Station will be located. The access road will be constructed of asphalt. Attached is a drawing of the new access road layout. This adjustment will not affect any new property owners, the proposed access road will be located entirely on property owned by AEP Ohio Transco, and the land on which the access road will be located has been previously surveyed for ecological features and cultural resources.

Thank you for your attention to this matter. Please contact me with any questions.

Respectfully submitted,

/s/ Christen M. Blend

Christen M. Blend (0086881), Counsel of Record
Hector Garcia (0084517)
Counsel for AEP Ohio Transmission Company, Inc.

Enclosure

cc: Jon Pawley

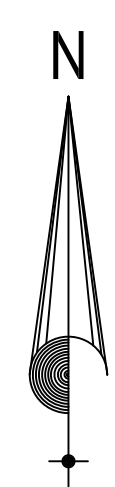

FILE LOCATION: L:\EPC SERVICES\EPCS-328 CITY OF JACKSON DELIVERY POINT\HEPPNER SWITCHYARD\CADD\WORKING\CIVIL\HEPPNER C302018 SERIES 2018-01-04 ASPHALT.DWG LAST SAVED BY: djohnson 1/24/2018 8:59 AM PLOTTED BY: David L. Johnson 1/24/2018 8:59 AM Tab: Site Grading Plan

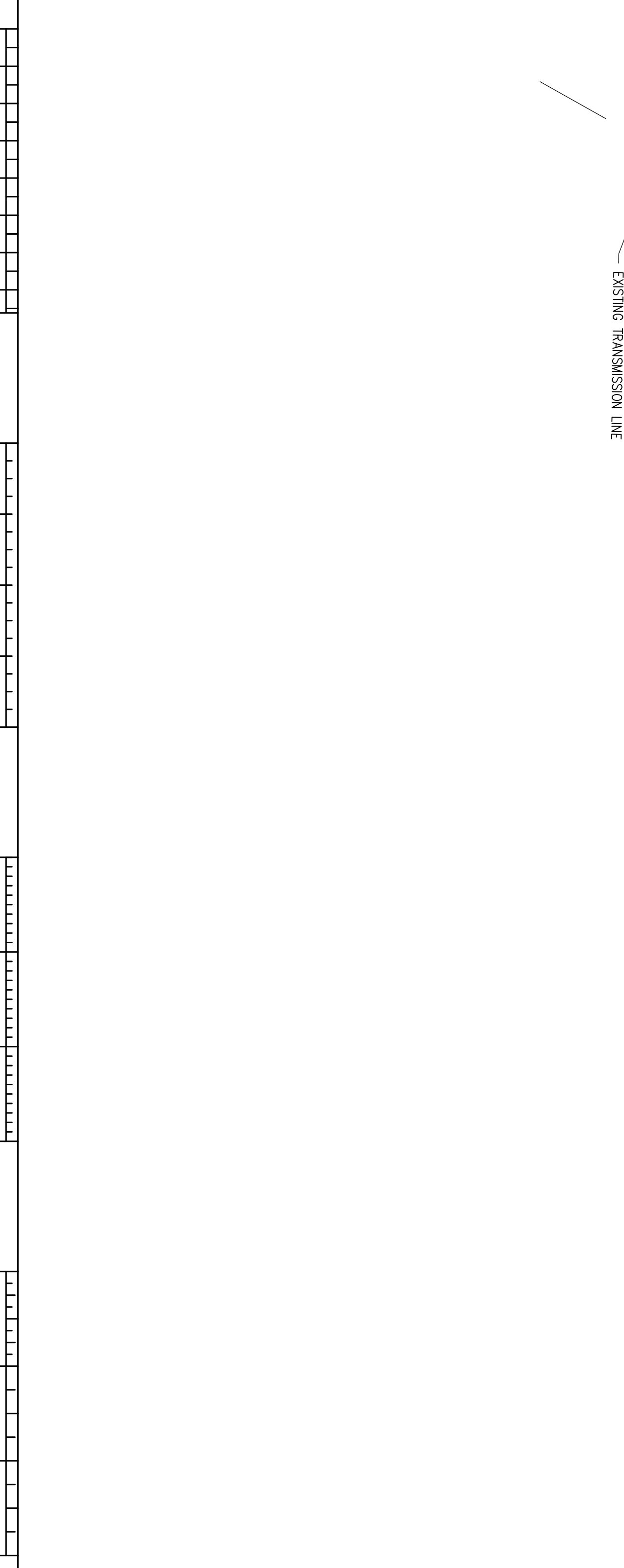
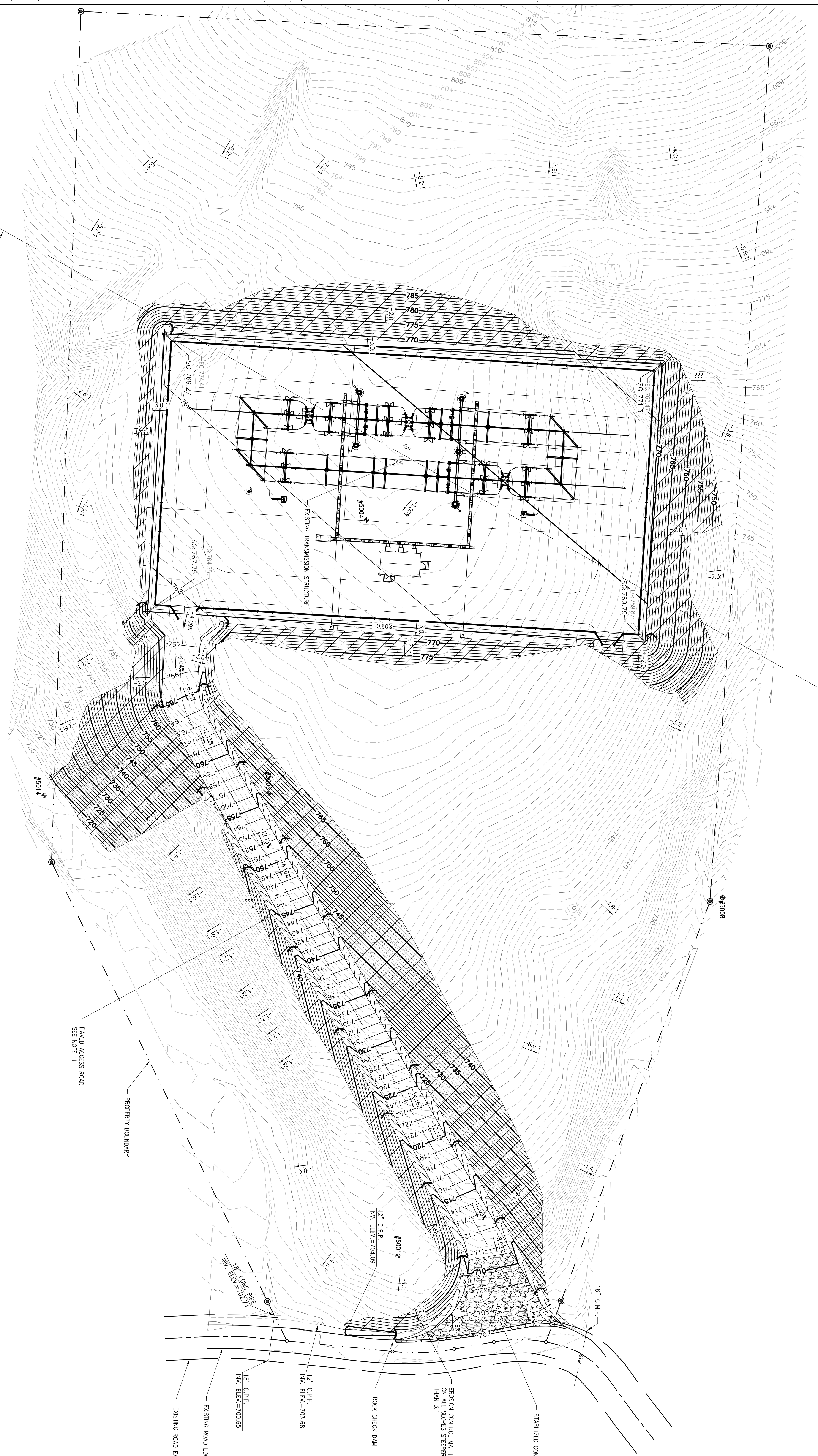

APPROXIMATE EARTHWORK VOLUMES:
DISTURBED AREA: 137,081 SQ. FT. (3.15 ACRES)
TOPSOIL REMOVAL VOLUME @ 4" DEPTH: 1,882 CU. YDS.
TOTAL CUT MINUS TOPSOIL VOLUME: 32,722
FILL VOLUME: 1,171 CU. YDS.
TOTAL VOLUME: 1,185 CU. YDS.
STATION SURFACING 452 STONE: 865 CU. YDS.
ACCESS ROAD ASPHALT PAVING 279 CU. YDS.
SILT FENCE: X 1 F.F. = 4,893 LF.
SEEDING AREA: 57,434 SQ. FT.
EROSION CONTROL MATTING AREA: 50,620 SQ. FT.
(ALL GRADED SLOPES STEEPER THAN 3:1 SHALL HAVE EROSION CONTROL MATTING)

LEGEND:

- EXISTING MAJOR CONTOUR LINE
- EXISTING MINOR CONTOUR LINE
- PROPOSED MAJOR CONTOUR LINE (SURBERGE)
- PROPOSED MINOR CONTOUR LINE (SURBERGE)
- SUBSTATION AXIS LINE
- SET FENCE
- PROPERTY BOUNDARY
- ROCK CHECK DAM
- EROSION CONTROL MATTING (ALL SLOPES STEEPER THAN 3:1)
- STABILIZED CONSTRUCTION ENTRANCE
- EXISTING GRADE
- SURBERGE

GENERAL NOTES:

1. CUT AND FILL VOLUMES ARE RAW VOLUMES WITH NO ALLOWANCES FOR SHRINKAGE WHERE APPLICABLE.
2. CONTRACTOR SHALL STRIP APPROXIMATELY 4 INCHES OF SOILS FROM THE WORKING AREA. STRIPPED TOP SOIL SHALL IMMEDIATELY BE RELOCATED TO THE PAD.
3. SUITABLE EXCESS FILL INCLUDING WASTE TOP SOILS MAY BE USED FOR EMBANKMENTS AND SLOPES OUTSIDE OF THE IMMEDIATE AREA OF THE PAD.
4. SLOPE ACCESS ROADS FOR DRAINAGE.
5. NEW CONTOURS INDICATE SURBERGE AND DO NOT INCLUDE CRUSHED ROCK SURFACING.
6. ALL AREAS NOT RECEIVING CRUSHED ROCK SURFACING OR ROAD MIX SHALL BE FILLED WITH TOPSOIL AND RESEEDED.
7. CRUSHED ROCK SURFACING SHALL NOT BE PLACED UNTIL COMPLETE.
8. THE EARTHWORK CONTRACTOR SHALL FINISH AND INSTALL COMPACTED NON-EXPANSIVE BACKFILL.
9. EROSION CONTROL MATTING TO BE NORTH AMERICAN GREEN SCS20 OR APPROVED EQUAL.
10. CABLE TRENCHING SHALL BE INSTALLED BY OTHERS.
11. ASPHALT PAVING SHALL CONSIST OF 7" COMPACTED SPARSE AGGREGATE BASE, 4" BINDER COURSE AND 2" SURFACE COURSE. ASPHALT PAVING SHALL COMPLY WITH ODOT SPECIFICATIONS.

REFERENCE DRAWINGS:

- E-1201 SITE GRADING PLAN
- E-1203 SITE GRADING SECTIONS
- E-1204 GRADING DETAILS-CIVIL DETAILS
- E-1205 PROPERTY LAYOUT AT EXISTING SITE SURVEY
- E-1206

PRELIMINARY

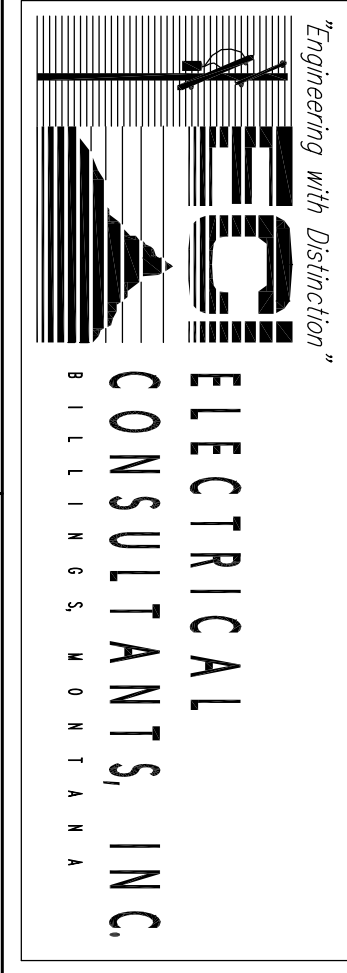

SITE GRADING PLAN/EROSION CONTROL - OPTION 2
HEPPNER SUBSTATION

NO.	DATE	REVISION DESCRIPTION	APPRI.	DR.	ENG.	IC.	ISSUE#

SCALE:	1" = 40'
DATE:	07/24/17
DRAWN BY:	XXXXXX
CHECKED BY:	XXXXXX
DATE:	07/24/17
PROJECT:	HEPPNER SUBSTATION
CLIENT:	OHIO TRANSMISSION COMPANY
PROJECT NO.:	E-1202
PROJECT NAME:	HEPPNER SUBSTATION
PROJECT ADDRESS:	COLUMBUS, OH 43215
PROJECT PHONE:	
PROJECT FAX:	
PROJECT EMAIL:	
PROJECT WEBSITE:	

This foregoing document was electronically filed with the Public Utilities

Commission of Ohio Docketing Information System on

2/16/2018 11:06:21 AM

in

Case No(s). 17-0806-EL-BLN

Summary: Notice of Adjustment to Access Road electronically filed by Ms. Christen M. Blend on behalf of AEP Ohio Transmission Power Company, Inc.