

**Case No.17-0135-EL-REN  
Kollengode-Sheila-OH-PV-13.8kW Residence  
Staff Interrogatories – Initial Set**

Question 1: In section G.4 of the application you have submitted the following:

G.4 SOLAR PHOTOVOLTAIC

G.4a Location of the PV Array: Roof

Description:

G.4b Total number of Modules: 46

All 46 panels are not visible in the photograph submitted under Section G.3. Please submit additional photographs that together with this photograph cover all the panels, OR submit any visual proof that shows the 46 panels and/or their layout.

Also, please confirm the total nameplate capacity of the system submitted in Section I.a.

Answer 1. Please see the panels below. The total nameplate capacity is 13.8 kW.



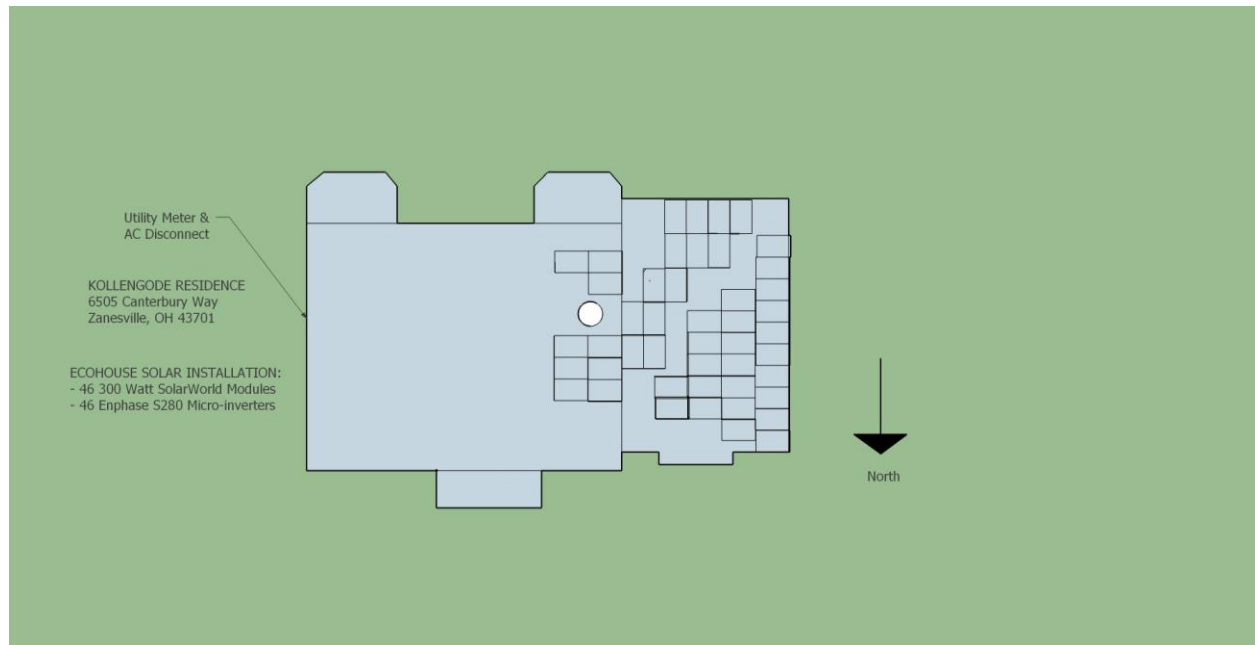



**This foregoing document was electronically filed with the Public Utilities**

**Commission of Ohio Docketing Information System on**

**3/31/2017 4:48:18 PM**

**in**

**Case No(s). 17-0135-EL-REN**

Summary: Reply reply to staff inquiries electronically filed by Mr. Avery Sellers on behalf of Sheila Kollengode