

NC  
FILE

13

RECEIVED-DOCKETING DIV

2015 JUN -2 PM 2:03

**Public Utilities  
Commission of Ohio**

PUCO

# Memo

15-1054-RR-FED

**To:** Docketing Division  
**From:** George Martin, Grade Crossing Planner, Rail Division  
**Re:** In the matter of the authorization of Norfolk Southern Railway to install an active grade crossing warning devices in Athens County  
**Date:** June 2, 2015

The Ohio Rail Development Commission (ORDC) has authorized funding for Norfolk Southern Railway (NS) to install mast-mounted flashing lights and roadway gates at Athens County, Village of Glouster, Braun St, DOT# 513476S, approved cost \$232,308.00. The crossing was surveyed on October 16, 2014 due to its hazard ranking and was found to warrant the upgrade.

The project will be paid for with federal funds, and is actual cost. As the plan and estimate in the above referenced amount has already been approved, staff requests a Finding & Order with completion in nine months. Construction may commence at once. Staff requests that the following language be incorporated in the Entry:

**It is expected that all work necessary for FHWA acceptance of the warning devices will be completed by the in-service due date and that the railroad will be responsible for this work. This work includes, but is not limited to:**

**Any ancillary work to make the warning devices function as designed and visible to the roadway user, and**

**MUTCD compliance, including minor roadway work if necessary.**

A suggested case coding and heading would be:

PUCO Case No. 15- **1054** -RR-FED In the matter of the authorization of Norfolk Southern Railway to install an active grade crossing warning device in Athens County

C: Legal Department

Please serve the following parties of record

This is to certify that the images appearing are an accurate and complete reproduction of a case file document delivered in the regular course of business.  
Technician SM Date Processed JUN 02 2015

Ms Cathy Stout  
Ohio Rail Development Commission  
1980 West Broad St, Mailstop #3140  
Columbus, Oh 43223

Mr Stephen Klinger  
Norfolk Southern Railway  
1200 Peachtree St, Box 123  
Atlanta, Ga 30309

Mr D Casey Talbot  
Eastman & Smith Ltd  
One Seagate, 24th Floor  
PO Box 10032  
Toledo, Oh 43699-0032

Mr Miles Wolf, Mayor  
16 Front St  
Glouster, Oh 45732

Village of Glouster Utility Department  
16 Front St  
Glouster, Oh 45732

**OHIO RAIL DEVELOPMENT COMMISSION  
INTER-OFFICE COMMUNICATION**

**TO:** George Martin, Rail Division, PUCO  
**FROM:** Cathy Stout, Manager, Safety Section, ORDC  
**BY:** Joe Reinhardt, Project Manager, ORDC  
**SUBJECT:** Athens County, Braun Street, DOT 513476S  
DOT 4513476S, PID 99304  
**DATE:** June 1, 2015

---

The Public Utilities Commission of Ohio (PUCO) established a diagnostic survey at the subject location on Braun Street. The Ohio Rail Development Commission (ORDC) attended the review. The Diagnostic Team recommended the improvement of warning devices to flashing lights and roadway gates. Copies of the diagnostic review form and the plan and estimate are attached.

PE has already been provided by the railroad. ORDC approves the site plans and estimates as provided. Please issue a construction-only order for the project outlined above. This construction authorization is made with the stipulation and understanding that any field work needs prior approval before the work begins. This authorization is made with the stipulation and understanding that an approved estimate may contain entries for items or activities that may be cited and found to be ineligible for federal participation during the project audit.

It is expected that all work necessary for FHWA acceptance of the warning devices will be completed by the in-service due date and that the railroad will be responsible for this work. This work includes, but is not limited to:

- any ancillary work to make warning devices function as designed and visible to the roadway user, and
- MUTCD compliance – including minor roadway work if necessary.

Thank you for your assistance with these matters.

Attachment: Diagnostic Review  
Plan & Estimate

c: George Martin, PUCO  
ORDC Project Manager (file)

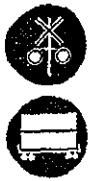

# OHIO RAIL DEVELOPMENT COMMISSION

Mail Stop #3140, 1980 West Broad Street, Columbus OH 43223  
John R. Kasich, Governor • Mark Policinski, ORDC Chairman

June 1, 2015

Mr. Stephen Klinger  
Public Projects Engineer  
1200 Peach Street NE, Box 123  
Atlanta, Ga. 30309

RE: Athens County, Braun Street, DOT 513476S  
PID# 99304, NS Project 10.2147

Dear Mr. Klinger:

The plan and estimate dated April 7, 2015, for the referenced project has been reviewed and is acceptable. NS may proceed with the construction of the proposed grade crossing warning system in accordance with the abbreviated plan. This authorization is made with the stipulation and understanding that the approved estimate may contain entries for items or activities that may be cited and found to be ineligible for federal participation during the project audit. Reimbursement of eligible actual cost is limited to \$232,308.00. Additional costs must be approved in writing by the Ohio Rail Development Commission (ORDC) prior to being incurred. Emergency verbal authorizations by ORDC may be permitted and will be confirmed by ORDC in writing within ten (10) business days of the verbal approval.

This authorization is contingent upon NS accepting the following instructions:

1. NS's project foreman will furnish written notification five (5) working days prior to the date work will start at the project site to Joe Reinhardt, ORDC, email [joe.reinhardt@dot.state.oh.us](mailto:joe.reinhardt@dot.state.oh.us) and to the Public Utilities Commission of Ohio at [George.martin@puc.state.oh.us](mailto:George.martin@puc.state.oh.us). NS's project foreman will also notify the same of any stops and re-starts of the work activity and of the date work was completed for the project.
2. NS will arrange for utilities to be located at the project site by the Ohio Utilities Protection Service (OUPS) prior to any construction activities at the site. Utilities that are not participating members of the service must be contacted directly by NS.
3. NS's project foremen will notify Joe Reinhardt at 614-580-7728 (telephone) or [joe.reinhardt@dot.state.oh.us](mailto:joe.reinhardt@dot.state.oh.us) (email) of any changes in the scope of work, cost overruns, material changes, etc. which are not included in the approved plan and estimate and secure approval of same before the work is performed.
4. Open cut of roadways is not permitted except in unusual circumstances and must be coordinated with the local highway authority and preapproved by ORDC.
5. NS will furnish two (2) copies of each partial bill to ORDC. Please find the enclosed ODOT Purchase Order to reference when billing.



[www.rail.ohio.gov](http://www.rail.ohio.gov)

phone: 614.644.0306

IMPROVING RAIL TODAY FOR TOMORROW'S ECONOMY

6. NS will furnish two (2) copies of the final all-inclusive bill to ORDC stating the exact dates of starting and completing work, the initial and final dates of construction and location where the accounts may be audited.
7. This installation will include any ancillary work to make the warning devices function as designed and meet MUTCD.

Thank you for your assistance with these matters.

Sincerely,

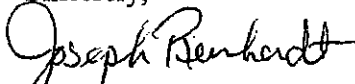
  
Joseph Reinhardt  
Project Manager

C: Randall Schumacher, Rail Division Supervisor, PUCO  
George Martin, Grade Crossing Planner, PUCO  
Susan Arduini, ORDC  
ORDC (file)

## Diagnostic Review Team Survey

Reason for Survey:

(e.g. formula, accident, constituent, etc.)

Formula

Date: 10/16/2014

### Location Data

Street or Road Name:

Braun Street

Route/Road Number

(i.e. Twp., Co., SR or US)

US DOT No.:

513476S

County:

ATH

Township:

City:

(In or Near)

Village of Glouster

Railroad Name:

Norfolk Southern

Railroad Division:

Pocahontas

Branch/Line Name:

West Virginia

Nearest RR

Timetable Station:

Glouster

RR Milepost:

67.31

### On-Site Review Team

(Include: Name - Organization - Phone Number - Email)

1. TIM PERKINS ORDC 614.644.0284
2. GEORGE MARTIN PUCO 614.752-9107
3. (Lennie) MIKE WOLF mayor 740-591-3739
4. JUSTIN ELZEY PUCO 740-637-0588
5. \_\_\_\_\_
6. \_\_\_\_\_
7. \_\_\_\_\_
8. \_\_\_\_\_
9. \_\_\_\_\_

### Existing Traffic Control Devices

Type of Warning Devices	Installed?		Quantity/Comments
Advance Warning Signs (condition?)	<input checked="" type="checkbox"/> Yes	<input type="checkbox"/> No	
'Stop' Signs	<input type="checkbox"/> Yes	<input checked="" type="checkbox"/> No	
'Stop Ahead' Signs	<input type="checkbox"/> Yes	<input checked="" type="checkbox"/> No	
Pavement Markings (condition?)	<input type="checkbox"/> Yes	<input checked="" type="checkbox"/> No	
Crossbucks	<input checked="" type="checkbox"/> Yes	<input type="checkbox"/> No	
Number of Tracks Signs	<input type="checkbox"/> Yes	<input checked="" type="checkbox"/> No	
Inventory Tags	<input checked="" type="checkbox"/> Yes	<input type="checkbox"/> No	
Interconnected Highway Traffic Signal	<input type="checkbox"/> Yes	<input checked="" type="checkbox"/> No	
Mast-Mounted Flashing Lights	<input type="checkbox"/> Yes	<input checked="" type="checkbox"/> No	
Cantilever Flashing Lights	<input type="checkbox"/> Yes	<input checked="" type="checkbox"/> No	Number: Length:
Side Lights	<input type="checkbox"/> Yes	<input checked="" type="checkbox"/> No	
Automatic Gates	<input type="checkbox"/> Yes	<input checked="" type="checkbox"/> No	Number: Length:
Bells	<input type="checkbox"/> Yes	<input checked="" type="checkbox"/> No	Number:
Sidewalk Gate Arms	<input type="checkbox"/> Yes	<input checked="" type="checkbox"/> No	
'No Turn' Signs	<input type="checkbox"/> Yes	<input checked="" type="checkbox"/> No	
Illumination	<input type="checkbox"/> Yes	<input checked="" type="checkbox"/> No	
Is crossing flagged by train crew?	<input type="checkbox"/> Yes	<input checked="" type="checkbox"/> No	
Other	<input type="checkbox"/> Yes	<input type="checkbox"/> No	

Safety Data (Obtain crash reports, if possible, prior to review)		
	Initial Information (from database)	Revised
Number & dates of crashes in previous 5 years	0	
Hazard Ranking	1357	Date Run: 9/5/2014
Railroad Data		
Railroad Characteristics	Initial Information (from database)	Revised
Total trains per day	4	
< 1 per day		
Day thru trains	2	
Night thru trains	2	
Daytime switching movements		
Nighttime switching movements		
Total number of tracks	1	
Number of main tracks	1	
Number of other tracks		
Maximum train speed	30	
Typical train speed	30	
Amtrak		
If non-gated crossing, is clearing sight distance adequate in all quadrants? (See Table 1) <input type="checkbox"/> Yes <input checked="" type="checkbox"/> No		
If multiple tracks, can two trains occupy crossing at the same time? <input type="checkbox"/> Yes <input type="checkbox"/> No		
Can one train block the motorists' view of another train at crossing? <input type="checkbox"/> Yes (Explain below) <input type="checkbox"/> No		
Can one or more tracks be eliminated through the crossing? <input type="checkbox"/> Yes <input type="checkbox"/> No		
Are there other track(s) crossing this same roadway within 100 ft of this crossing? <input type="checkbox"/> Yes <input type="checkbox"/> No		
If yes, Crossing DOT #(if different) _____		
If yes, distance _____ (take measurement between track centerlines at closest point along roadway)		
Roadway Data		
Local Highway Authority:		Village of Gloucester
Roadway Characteristics	Initial Information (from database)	Revised
Average daily traffic	1073 (2008)	
Highway paved	<input checked="" type="checkbox"/> Yes <input type="checkbox"/> No	<input type="checkbox"/> Yes <input type="checkbox"/> No
Roadway Surface: <input checked="" type="checkbox"/> Blacktop <input type="checkbox"/> Gravel <input type="checkbox"/> Concrete <input type="checkbox"/> Other _____		
Roadway width: <u>26</u> ft.		
Number of highway lanes	<u>2</u>	
Urban or Rural	<u>Urban</u>	
Vehicle Speed: <u>20</u> MPH		
School Bus Operation: <input type="checkbox"/> No <input checked="" type="checkbox"/> Yes _____ Amount		
Hazardous Materials Trucks: <input type="checkbox"/> No <input type="checkbox"/> Yes _____ Amount <u>Unknown</u>		
Shoulders: <input checked="" type="checkbox"/> No <input type="checkbox"/> Yes		
Is the shoulder surfaced? <input type="checkbox"/> No <input type="checkbox"/> Yes		
Is there existing guardrail along roadway in crossing vicinity? <input checked="" type="checkbox"/> No <input type="checkbox"/> Yes		
Is stopping site distance adequate? (See Table 2) <input checked="" type="checkbox"/> Yes <input type="checkbox"/> No If no, deficient approach(es) _____		

Quadrant _____ Curb and Gutter: <input type="checkbox"/> Functional (Curb height = 4" or more) <input type="checkbox"/> Non-functional (Curb height = Less than 4") <input checked="" type="checkbox"/> None	Quadrant _____ Curb and Gutter: <input type="checkbox"/> Functional (Curb height = 4" or more) <input type="checkbox"/> Non-functional (Curb height = Less than 4") <input checked="" type="checkbox"/> None
Pedestrians: <input type="checkbox"/> No <input checked="" type="checkbox"/> Yes	
Is sidewalk present? <input checked="" type="checkbox"/> No <input type="checkbox"/> Yes	
Is there a nearby intersection that could cause queuing over the crossing? <input checked="" type="checkbox"/> No <input type="checkbox"/> Yes If yes, Distance _____ Is this intersection signalized? <input type="checkbox"/> No <input type="checkbox"/> Yes Are the signals currently interconnected with the existing crossing warning devices? <input type="checkbox"/> No <input type="checkbox"/> Yes Is there a 'Do not Stop on Track' sign? <input type="checkbox"/> No <input type="checkbox"/> Yes	
Is a roadway improvement project (e.g. widening, turn lanes, nearby new or upgraded traffic signal, sidewalk) planned at or near this location in the foreseeable future? <input type="checkbox"/> No <input type="checkbox"/> Yes If yes, Improvement type _____ Lead Agency _____ Timeline/completion _____	
Is it the consensus of the Diagnostic Review Team that this is a potential closure project? <input type="checkbox"/> No <input type="checkbox"/> Yes Explain reasons: _____	
<b>Type of Development</b>	
<input checked="" type="checkbox"/> Open Space <input type="checkbox"/> Institutional <input type="checkbox"/> Industrial <input checked="" type="checkbox"/> Commercial <input checked="" type="checkbox"/> Residential	Location of nearby schools: _____
<b>Utility Information</b>	
Is commercial power available? <input type="checkbox"/> No <input checked="" type="checkbox"/> Yes Utility Provider (Company Name) <u>Village</u> Phone Number _____ Nearest Available Power Source _____	
What other utilities are present? (add locations to sketch) <input checked="" type="checkbox"/> Gas <input type="checkbox"/> Cable <input type="checkbox"/> Telephone <input checked="" type="checkbox"/> Fiber Optic Cable <input type="checkbox"/> Petroleum <input checked="" type="checkbox"/> Water <input type="checkbox"/> Sanitary Sewer <input type="checkbox"/> Other _____	
Is(are) there potential utility conflict(s) <input type="checkbox"/> Yes <input type="checkbox"/> No <input type="checkbox"/> Unknown Comments: _____	



## Potential Red Flags / Project Challenges

Traffic Signal Preemption (include traffic signal intersection name and LHA with jurisdiction over traffic signal, if known):

N/A

Crossing Consolidation or Closure:

N/A

Real Estate or ROW:

N/A

Culverts / Drainage / Ballast Conditions:

N/A

Roadway and/or Sidewalks:

N/A

Circuitry (e.g. reaches out to other crossings, specific needs, etc.):

N/A

Environmental:

N/A

Other:

Diagnostic Team Recommendations	
<input checked="" type="checkbox"/> Install/upgrade active devices	Quadrants Needed
<input type="checkbox"/> Automatic Flashing Lights (AFLS)	
<input type="checkbox"/> AFLS / Cants	
<input checked="" type="checkbox"/> AFLS / Gates	
<input type="checkbox"/> AFLS / Gates / Cants	
<input type="checkbox"/> Bells / number	
<input type="checkbox"/> Upgrade circuitry / type	
<input type="checkbox"/> Sidelights	
<input type="checkbox"/> Guardrail Needed	
<input type="checkbox"/> Install/Replace curb	
<input type="checkbox"/> Bungalow placement & offset from rail & highway	
<input type="checkbox"/> Other (define)	
Comments:	
<input type="checkbox"/> Install/upgrade traffic signal preemption	
<input type="checkbox"/> No improvements needed	
<input type="checkbox"/> Other (define)	
Acknowledgement of Recommendations (each entity represented at the diagnostic must have at least one signature acknowledgement):	
<u>GM</u>	<u>L.G.</u>
<u>Jim Perkins</u>	
<u>JE</u>	

# Field Dimensions

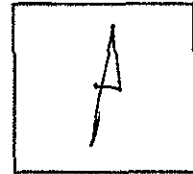
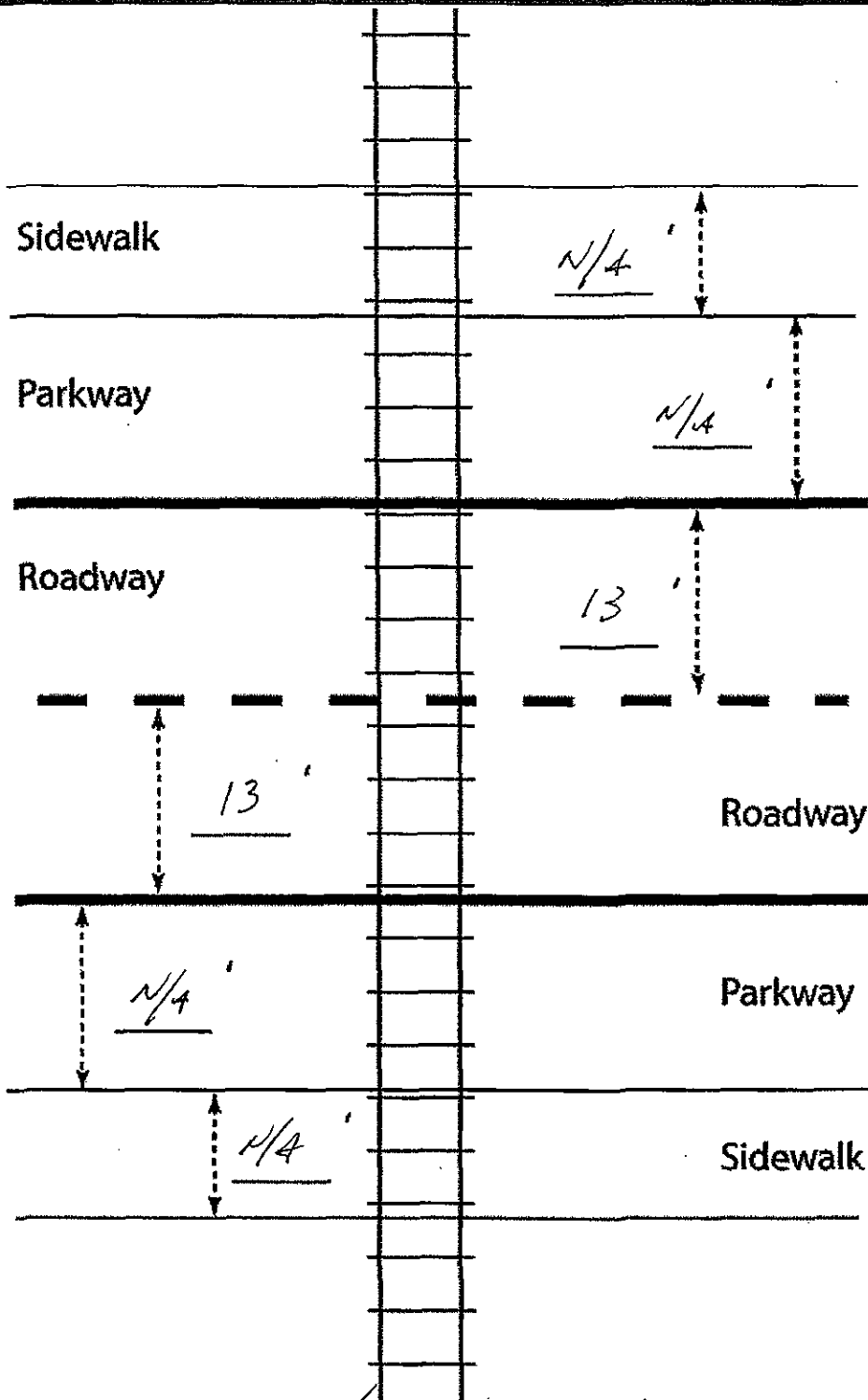

Show North Direction

Crossing Angle ☐ 0-29° ☐ 30-59° ☒ 60-90° Measured in SW Quadrant?

Measurements by: AL

# Field Sketch

Include utilities as marked by OUPS and LHA; include ROW boundaries as indicated by railroad and LHA.

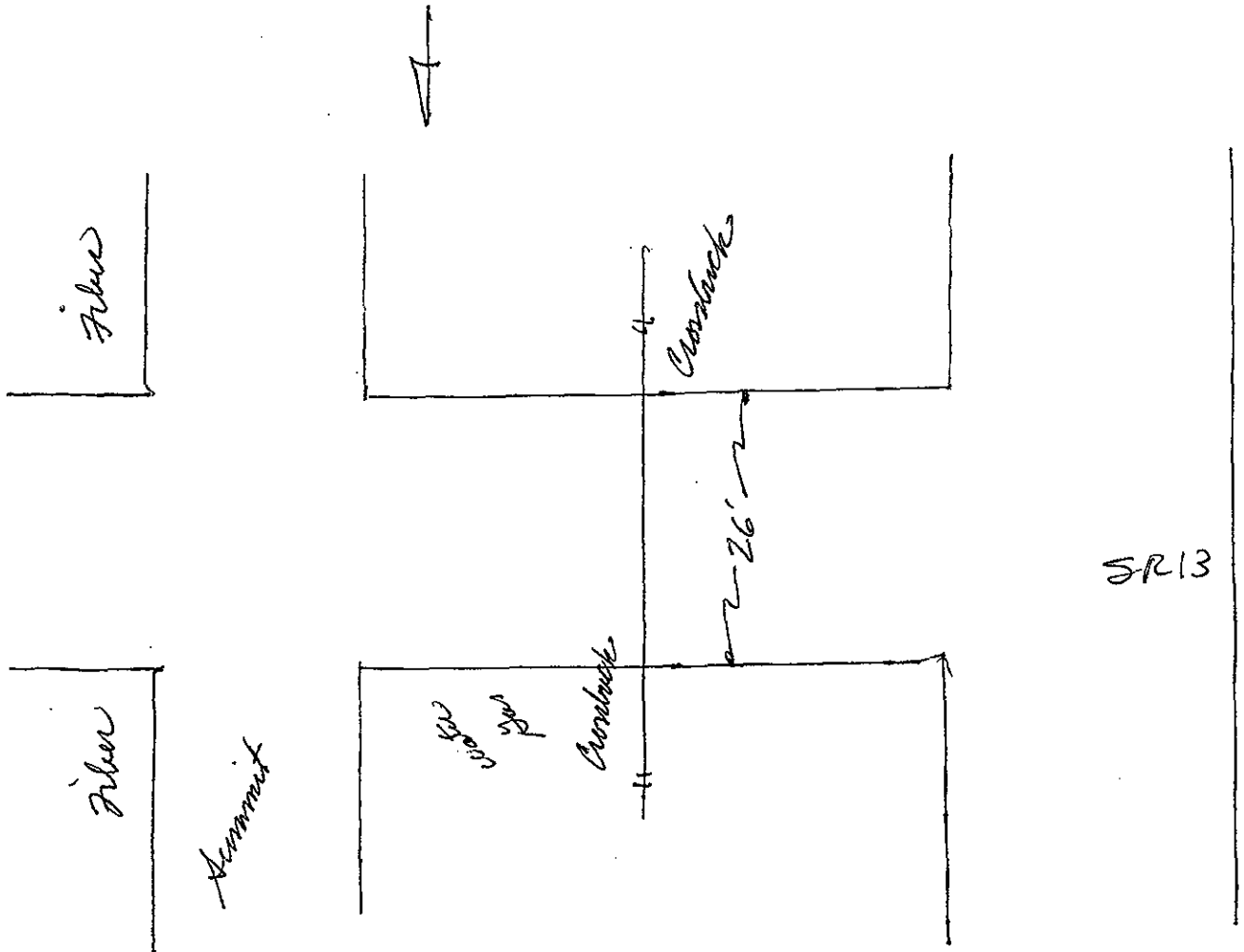

Crossing Angle ☐ 0-29° ☐ 30-59° ☒ 60-90° Measured in SW Quadrant?

Sketch by: SP

TABLE I

## Clearing Sight Distances

Maximum Authorized Train Speed	Distance (dT) Along Railroad from Crossing (ft)
1 - 10	240
15	360
20	480
25	600
30	720
35	840
40	960
45	1080
50	1200
55	1320
60	1440
65	1560
70	1680
75	1800
80	1920
85	2040
90	2160

Source: R-H Grade Crossing Handbook Table 36 (pp. 132-133)

## Notes:

All calculated distances are rounded up to the next higher 5-foot increment.

Distances indicated are for 65-ft double bottom semi-tractor trailers and level single track 90 degree crossings; and may need to be adjusted for multiple tracks, skewed crossings or approaches on grades.

Clearing Sight Distance is to be measured in each vehicle travel direction at non-gated crossings as viewed from a point 25 feet from centerline of nearest track in the center of whichever travel lane is nearest the direction along track being measured.

Table 2

## Stopping Sight Distances

Highway Vehicle Speed	Distance (dH) Along Roadway from Crossing (ft)
0	n/a
5	50
10	70
15	105
20	135
25	180
30	225
35	280
40	340
45	410
50	490
55	570
60	660
65	760
70	865

Source: R-H Grade Crossing Handbook Table 36 (pp. 132-133)

## Notes:

All calculated distances are rounded up to the next higher 5-foot increment.

Distances indicated are for 65-ft double bottom semi-tractor trailers on dry level pavements.

Stopping Sight Distance is to be measured on each roadway approach to crossing from stop bar.