

NO FILE

**Public Utilities
Commission of Ohio**

Memo

RECEIVED-DOCKETING DIV

2014 DEC 23 PM 2:33

PUCO



To: Docketing Division
From: George Martin, Grade Crossing Planner, Rail Division
Re: In the matter of the authorization of CSX Transportation to install an active grade crossing warning device in the Village of Prospect, Marion County
Date: December 23, 2014

The Ohio Rail Development Commission (ORDC) has authorized funding for CSX Transportation (CSX) to install mast-mounted flashing lights and roadway gates at the following crossing:

Marion County, Village of Prospect, E Water St/SR 47, DOT# 228704T, approved cost \$190,298.00

The crossing was surveyed on November 4, 2013 due to its hazard ranking, and was found to warrant the upgrade. **SPECIAL CIRCUMSTANCE:** There is a separate industrial track roughly 36 feet east along the roadway from the crossing authorized for upgrade. This crossing is owned and operated by the Prospect Farmers Exchange, is only used seasonally, and only 2 times per week in season. The Exchange stops and flags both crossings only when the industry track is in use.

Staff requests that the Finding & Order require the stop and flag by Prospect Farmers Exchange to continue, preventing traffic from stopping on the CSX mainline, thus obviating the need for warning device maintenance on the industrial spur.

The project will be paid for with federal funds, and is actual cost. As the plan and estimate for the project has been submitted and approved, staff requests a Finding & Order with completion due in nine months. Construction may commence at once. Staff requests that the following language be incorporated in the Entry:

It is expected that all work necessary for FHWA acceptance of the warning devices will be completed by the in-service due date and that the railroad will be responsible for this work. This work includes, but is not limited to:

Any ancillary work to make the warning devices function as designed and visible to the roadway user, and

MUTCD compliance, including minor roadway work if necessary.

A suggested case coding and heading would be:

PUCO Case No. 14- 2311 -RR-FED In the matter of the authorization of CSX Transportation to install an active grade crossing warning device in the Village of Prospect, Marion County

C: Legal Department

Ms Cathy Stout
Ohio Rail Development Commission
1980 West Broad St, Mailstop 3140
Columbus, Oh 43223

Ms Amanda DeCesare **NEW ADDRESS**
CSX Transportation
500 Meijer Drive, Ste 305
Florence, Ky 41042

Mr Thomas Lasher
Prospect Farmers Exchange
1007 East Water St
Prospect, Oh 43342

Ms Teri Duprey
Village Clerk
139 N. Main St.
Prospect, Ohio 43342

Village of Prospect Electric
139 N Main St
Prospect, Oh 43342

**OHIO RAIL DEVELOPMENT COMMISSION
INTER-OFFICE COMMUNICATION**

TO: George Martin, Rail Division, PUCO
FROM: Cathy Stout, Manager, Safety Section, ORDC
BY: Joe Reinhardt, Project Manager, ORDC
SUBJECT: Marion County, SR 47, E. Water Street, CSX
DOT 228704T, PID 97298
DATE: December 15, 2014

The Public Utilities Commission of Ohio (PUCO) established a diagnostic survey at the subject location on SR47, E. Water Street. The Ohio Rail Development Commission (ORDC) attended the review. The Diagnostic Team recommended the improvement of warning devices to flashing lights and roadway gates. Copies of the diagnostic review form and the plan and estimate are attached.

Please include in the Order to construct, a section that Orders the industry track owner to stop and flag both the industry track and the CSX track when the industry track is in use.

PE has already been provided by the railroad. ORDC approves the site plans and estimates as provided. Please issue a construction-only order for the project outlined above. This construction authorization is made with the stipulation and understanding that any field work needs prior approval before the work begins. This authorization is made with the stipulation and understanding that an approved estimate may contain entries for items or activities that may be cited and found to be ineligible for federal participation during the project audit.

It is expected that all work necessary for FHWA acceptance of the warning devices will be completed by the in-service due date and that the railroad will be responsible for this work. This work includes, but is not limited to:

- any ancillary work to make warning devices function as designed and visible to the roadway user, and
- MUTCD compliance – including minor roadway work if necessary.

Thank you for your assistance with these matters.

Attachment: Diagnostic Review
Plan & Estimate

c: George Martin, PUCO
ORDC Project Manager (file)



OHIO RAIL DEVELOPMENT COMMISSION

Mail Stop #3140, 1980 West Broad Street, Columbus OH 43223

John R. Kasich, Governor • Mark Policinski, ORDC Chairman

December 15, 2014

Ms. Amanda DeCesare
Project Manager
500 Meijer Drive, Suite 305
Florence, Ky 41042

RE: Marion County, SR 47, E. Water Street, DOT 228704T
PID 97298, OH0982

Dear Ms. DeCesare:

The plan and estimate dated November 11, 2014, for the referenced project has been reviewed and is acceptable. CSX may proceed with the construction of the proposed grade crossing warning system in accordance with the abbreviated plan. This authorization is made with the stipulation and understanding that the approved estimate may contain entries for items or activities that may be cited and found to be ineligible for federal participation during the project audit. Reimbursement of eligible actual cost is limited to \$190,298. Additional costs must be approved in writing by the ORDC prior to being incurred. Emergency verbal authorizations by ORDC may be permitted and will be confirmed by ORDC in writing within ten (10) business days of the verbal approval.

This authorization is contingent upon CSX accepting the following instructions:

1. CSX will furnish prior written notification of their scheduled date to start construction to George Martin, PUCO, Railroad Division.
2. CSX's project foreman will furnish FAX or written notification five (5) working days prior to the date work will start at the project site to Joseph Reinhardt, Ohio Rail Development Commission (ORDC), 1980 West Broad Street, Columbus, Ohio 43223, email joe.reinhardt@dot.state.oh.us or FAX (614) 728-4520, (telephone number 614-580-7728), and to the Public Utilities Commission of Ohio at 180 East Broad Street, Columbus, Ohio 43215, email George.martin@puc.state.oh.us, (telephone number 614-752-9107). CSX's project foreman will also notify the same of any stops and re-starts of the work activity and of the date work was completed for the project.
3. CSX will arrange for utilities to be located at the project site by the Ohio Utilities Protection Service (OUPS) prior to any construction activities at the site. Utilities that are not participating members of the service must be contacted directly by CSX.
4. CSX's project foremen will notify Joe Reinhardt of any changes in the scope of work, cost overruns, material changes, etc. which are not included in the approved plan and estimate and secure approval of same before the work is performed.



www.rail.ohio.gov

phone: 614.644.0306

IMPROVING RAIL TODAY FOR TOMORROW'S ECONOMY

5. CSX will furnish two (2) copies of each partial bill to ORDC. Please find the enclosed Encumbrance Estimate to reference when billing.
6. CSX will furnish two (2) copies of the final all-inclusive bill to ORDC stating the exact dates of starting and completing work, the initial and final dates of construction and location where the accounts may be audited.

Thank you for your assistance with these matters.

Sincerely,

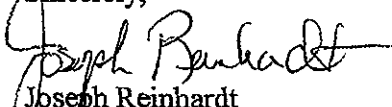

Joseph Reinhardt
Project Manager

C: George Martin, PUCO, Grade Crossing Planner
ORDC (file)



Diagnostic Review Team Survey

Reason for Survey:

(e.g. formula, accident, constituent, etc.)

Formula Pick

Date:

11/4/13

Location Data

Street or Road Name: E Water Street			
Route/Road Number (i.e. Twp., Co., SR or US) SR 47 - 2.91		US DOT No.: 228704T	
County: MAR	Township:	City: (In or Near)	Prospect
Railroad Name: CSX Transportation	Railroad Division: Appalachian	Branch/Line Name:	
Nearest RR Timetable Station: Prospect		RR Milepost: 35.86	

On-Site Review Team

(Include: Name - Organization - Phone Number - Email)

1. Joe Richards ORDC 614-644-0291
2. George Martin Fico 614-752-9107
3. Randy Patterson Fico 614-203-2186
4. Brad Irons Marion Co. Eng. 740-223-4110
5. Justin Fung CSX 904-703-2253
6. Dorothy Brown V. Council 740-494-2644
7. L. Renee Foster Village Council 740-494-2450
8. _____
9. _____

Existing Traffic Control Devices

Type of Warning Devices	Installed?		Quantity/Comments	
Advance Warning Signs (condition?)	<input checked="" type="checkbox"/> Yes	<input type="checkbox"/> No	2	
'Stop' Signs	<input type="checkbox"/> Yes	<input checked="" type="checkbox"/> No		
'Stop Ahead' Signs	<input type="checkbox"/> Yes	<input checked="" type="checkbox"/> No		
Pavement Markings (condition?)	<input checked="" type="checkbox"/> Yes	<input type="checkbox"/> No	2	
Crossbucks	<input checked="" type="checkbox"/> Yes	<input type="checkbox"/> No	2	
Number of Tracks Signs	<input type="checkbox"/> Yes	<input checked="" type="checkbox"/> No		
Inventory Tags	<input checked="" type="checkbox"/> Yes	<input type="checkbox"/> No		
Interconnected Highway Traffic Signal	<input type="checkbox"/> Yes	<input checked="" type="checkbox"/> No		
Mast-Mounted Flashing Lights	<input checked="" type="checkbox"/> Yes	<input type="checkbox"/> No	2	
Cantilever Flashing Lights	<input type="checkbox"/> Yes	<input checked="" type="checkbox"/> No	Number:	Length:
Side Lights	<input type="checkbox"/> Yes	<input checked="" type="checkbox"/> No		
Automatic Gates	<input type="checkbox"/> Yes	<input checked="" type="checkbox"/> No	Number:	Length:
Bells	<input type="checkbox"/> Yes	<input checked="" type="checkbox"/> No	Number:	
Sidewalk Gate Arms	<input type="checkbox"/> Yes	<input checked="" type="checkbox"/> No		
'No Turn' Signs	<input type="checkbox"/> Yes	<input checked="" type="checkbox"/> No		
Illumination	<input type="checkbox"/> Yes	<input checked="" type="checkbox"/> No		
Is crossing flagged by train crew?	<input type="checkbox"/> Yes	<input checked="" type="checkbox"/> No		
Other	<input type="checkbox"/> Yes	<input checked="" type="checkbox"/> No		

Safety Data (Obtain crash reports, if possible, prior to review)		
	Initial Information (from database)	Revised
Number & dates of crashes in previous 5 years	0 (3/6/2006)	1 2-17-13
Hazard Ranking	185	Date Run: 10/9/2013

Railroad Data		
Railroad Characteristics	Initial Information (from database)	Revised
Total trains per day	17	
< 1 per day		
Day thru trains	4	
Night thru trains	11	
Daytime switching movements	2	
Nighttime switching movements	0	
Total number of tracks	2	
Number of main tracks	1	
Number of other tracks	1 Siding	
Maximum train speed	50	
Typical train speed	50	
Amtrak		

If non-gated crossing, is clearing sight distance adequate in all quadrants? (See Table I) ☒ Yes ☐ No

If multiple tracks, can two trains occupy crossing at the same time? ☒ Yes ☐ No

Can one train block the motorists' view of another train at crossing? ☒ Yes (Explain below) ☐ No

Can one or more tracks be eliminated through the crossing? ☐ Yes ☒ No

Are there other track(s) crossing this same roadway within 100 ft of this crossing? ☐ Yes ☒ No

If yes, Crossing DOT # (if different) _____

If yes, distance _____ (take measurement between track centerlines at closest point along roadway)

Roadway Data		
Local Highway Authority: Village of Prospect		
Roadway Characteristics	Initial Information (from database)	Revised
Average daily traffic	2346 (2011)	
Highway paved	<input checked="" type="checkbox"/> Yes <input type="checkbox"/> No	<input type="checkbox"/> Yes <input type="checkbox"/> No
Roadway Surface: <input checked="" type="checkbox"/> Blacktop <input type="checkbox"/> Gravel <input type="checkbox"/> Concrete <input type="checkbox"/> Other _____		
Roadway width: 20 ft.		
Number of highway lanes	2	
Urban or Rural	Rural	
Vehicle Speed: 35 MPH		
School Bus Operation: <input checked="" type="checkbox"/> No <input type="checkbox"/> Yes Amount _____		
Hazardous Materials Trucks: <input checked="" type="checkbox"/> No <input type="checkbox"/> Yes Amount _____		
Shoulders: <input checked="" type="checkbox"/> No <input type="checkbox"/> Yes		
Is the shoulder surfaced? <input checked="" type="checkbox"/> No <input type="checkbox"/> Yes		
Is there existing guardrail along roadway in crossing vicinity? <input checked="" type="checkbox"/> No <input type="checkbox"/> Yes		
Is stopping site distance adequate? (See Table 2) <input checked="" type="checkbox"/> Yes <input type="checkbox"/> No If no, deficient approach(es) _____		

Quadrant <u>SW</u> Curb and Gutter: <input type="checkbox"/> Functional (Curb height = 4" or more) <input type="checkbox"/> Non-functional (Curb height = Less than 4") <input checked="" type="checkbox"/> None	Quadrant <u>NE</u> Curb and Gutter: <input type="checkbox"/> Functional (Curb height = 4" or more) <input type="checkbox"/> Non-functional (Curb height = Less than 4") <input checked="" type="checkbox"/> None
Pedestrians: <input type="checkbox"/> No <input checked="" type="checkbox"/> Yes	
Is sidewalk present? <input type="checkbox"/> No <input checked="" type="checkbox"/> Yes	
Is there a nearby intersection that could cause queuing over the crossing? <input checked="" type="checkbox"/> No <input type="checkbox"/> Yes If yes, Distance _____ Is this intersection signalized? <input checked="" type="checkbox"/> No <input type="checkbox"/> Yes Are the signals currently interconnected with the existing crossing warning devices? <input type="checkbox"/> No <input type="checkbox"/> Yes Is there a 'Do not Stop on Track' sign? <input checked="" type="checkbox"/> No <input type="checkbox"/> Yes	
Is a roadway improvement project (e.g. widening, turn lanes, nearby new or upgraded traffic signal, sidewalk) planned at or near this location in the foreseeable future? <input checked="" type="checkbox"/> No <input type="checkbox"/> Yes If yes, Improvement type _____ Lead Agency _____ Timeline/completion _____	
Is it the consensus of the Diagnostic Review Team that this is a potential closure project? <input checked="" type="checkbox"/> No <input type="checkbox"/> Yes Explain reasons: _____	
Type of Development	
<input type="checkbox"/> Open Space <input checked="" type="checkbox"/> Industrial <input checked="" type="checkbox"/> Residential	<input type="checkbox"/> Institutional <input type="checkbox"/> Commercial Location of nearby schools: _____
Utility Information	
Is commercial power available? <input type="checkbox"/> No <input checked="" type="checkbox"/> Yes Utility Provider (Company Name) <u>City</u> Phone Number _____ Nearest Available Power Source _____	
What other utilities are present? (add locations to sketch) <input type="checkbox"/> Gas <input checked="" type="checkbox"/> Cable <input checked="" type="checkbox"/> Telephone <input type="checkbox"/> Fiber Optic Cable <input type="checkbox"/> Petroleum <input type="checkbox"/> Water <input type="checkbox"/> Sanitary Sewer <input type="checkbox"/> Other _____	
Is(are) there potential utility conflict(s) <input type="checkbox"/> Yes <input type="checkbox"/> No <input checked="" type="checkbox"/> Unknown Comments: _____	

Potential Red Flags / Project Challenges

Traffic Signal Preemption (include traffic signal intersection name and LHA with jurisdiction over traffic signal, if known):

Crossing Consolidation or Closure:

Real Estate or ROW:

Culverts / Drainage / Ballast Conditions:

Roadway and/or Sidewalks:

Sidewalks Outside of Existing Flashers



Circuitry (e.g. reaches out to other crossings, specific needs, etc.):

Environmental:

Other:

JAL
11-4-13

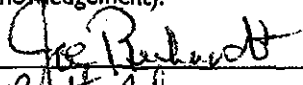
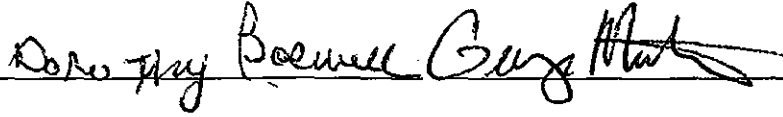
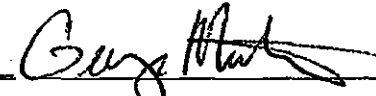
Diagnostic Team Recommendations

	Quadrants Needed
<input checked="" type="checkbox"/> Install/upgrade active devices	
<input type="checkbox"/> Automatic Flashing Lights (AFLS)	
<input type="checkbox"/> AFLS / Cants	
<input checked="" type="checkbox"/> AFLS / Gates	DO NOT INCLUDE SIDING FOR GATES
<input type="checkbox"/> AFLS / Gates / Cants	
<input checked="" type="checkbox"/> Bells / number	ONE
<input type="checkbox"/> Upgrade circuitry / type	
<input type="checkbox"/> Sidelights	
<input type="checkbox"/> Guardrail Needed	
<input type="checkbox"/> Install/Replace curb	
<input type="checkbox"/> Bungalow placement & offset from rail & highway	
<input type="checkbox"/> Other (define)	
<p>Comments:</p> <p>Guardrails or curbs are needed for both quadrants.</p> <p>Possible over head power line issue in SW quad.</p>	
<input type="checkbox"/> Install/upgrade traffic signal preemption	
<input type="checkbox"/> No improvements needed	
<input type="checkbox"/> Other (define)	
<p>Acknowledgement of Recommendations (each entity represented at the diagnostic must have at least one signature acknowledgement):</p> <p>    </p> <p>  </p>	

Field Dimensions

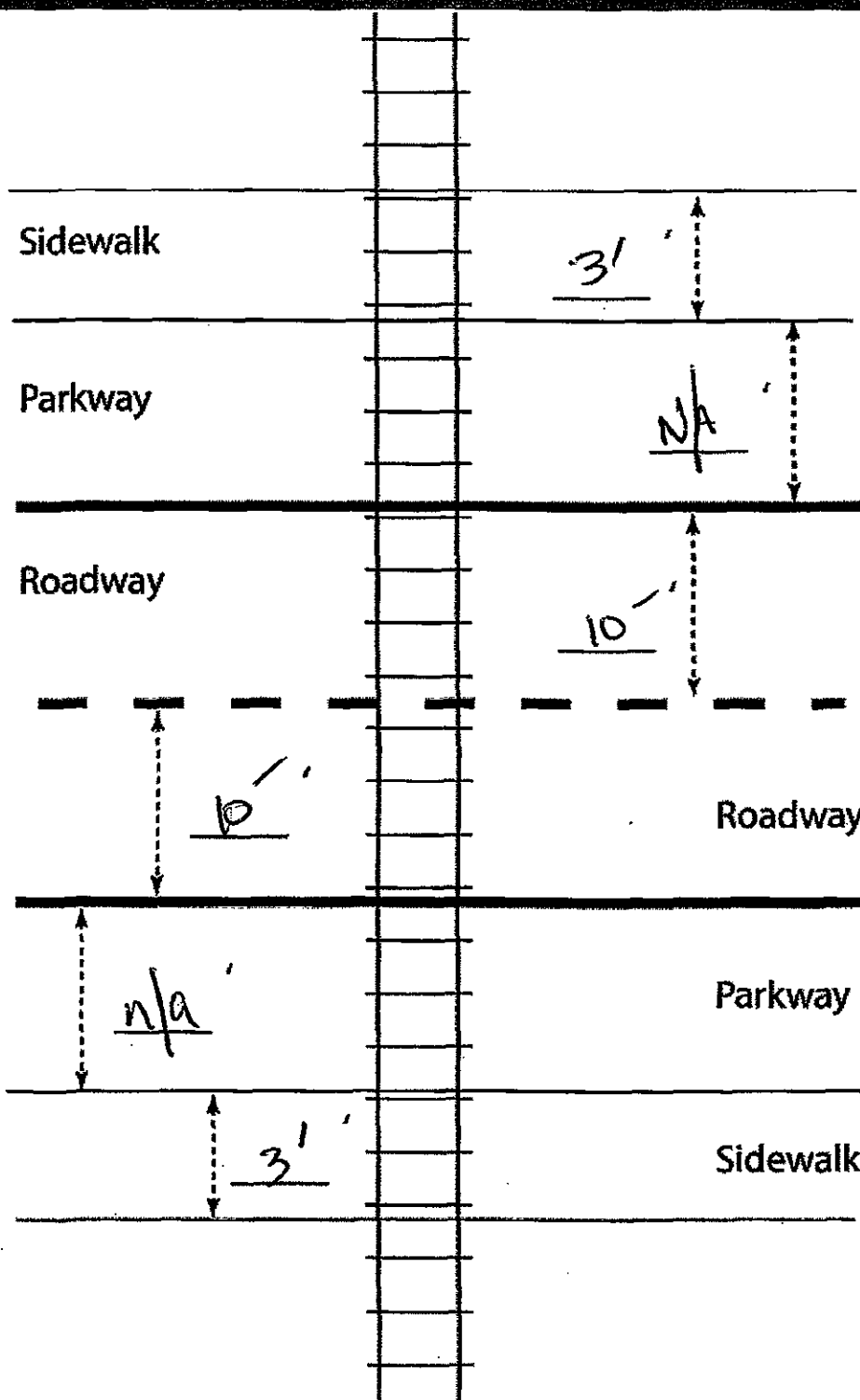

Crossing Angle ☐ 0-29° ☐ 30-59° ☒ 60-90° Measured in _____ Quadrant?

Measurements by *[Signature]*

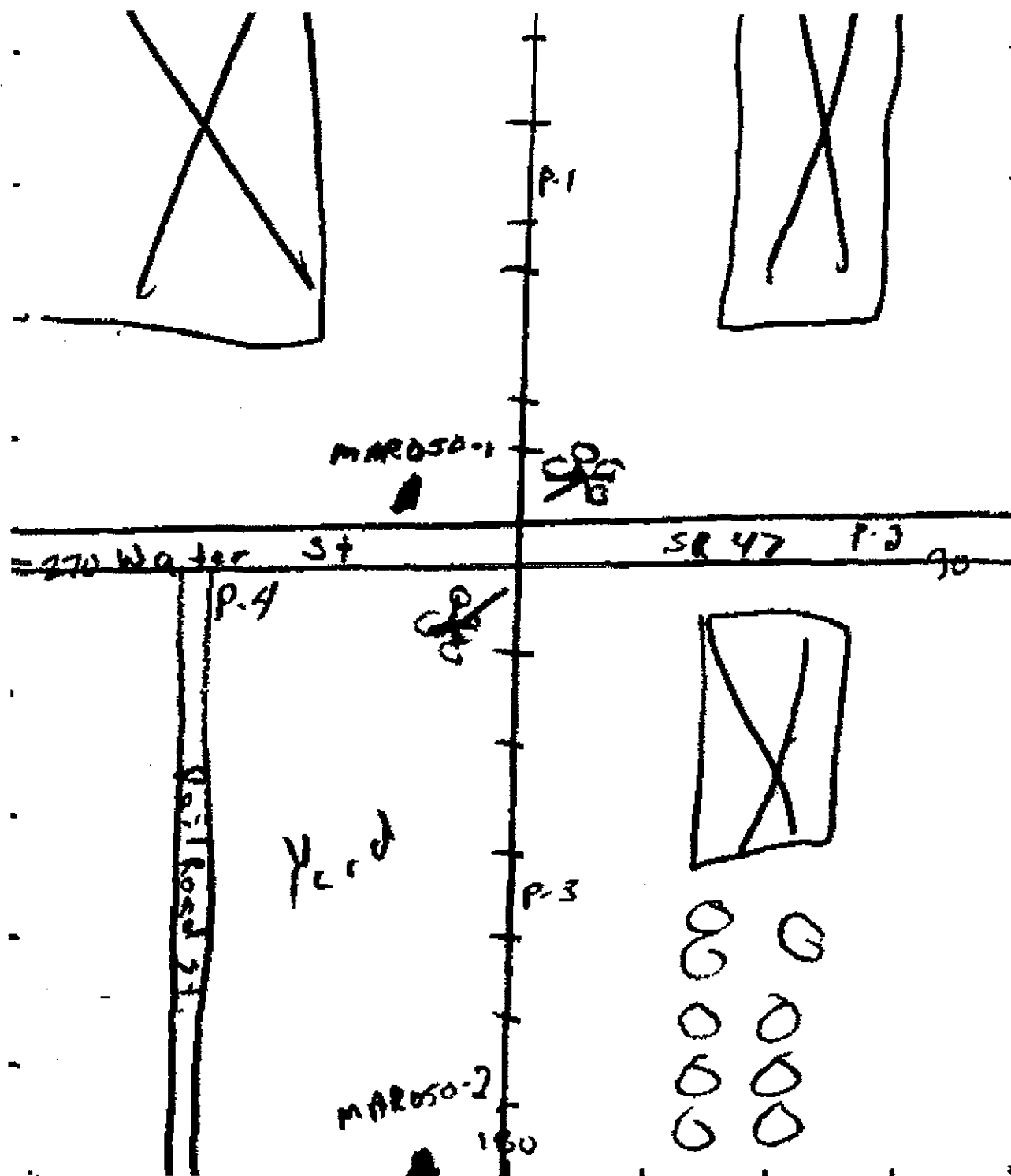

TABLE 1

Clearing Sight Distances

Maximum Authorized Train Speed	Distance (dT) Along Railroad from Crossing (ft)
1 - 10	240
15	360
20	480
25	600
30	720
35	840
40	960
45	1080
50	1200
55	1320
60	1440
65	1560
70	1680
75	1800
80	1920
85	2040
90	2160

Source: R-H Grade Crossing Handbook Table 36 (pp. 132-133)

Notes:

All calculated distances are rounded up to the next higher 5-foot increment.

Distances indicated are for 65-ft double bottom semi-tractor trailers and level single track 90 degree crossings; and may need to be adjusted for multiple tracks, skewed crossings or approaches on grades.

Clearing Sight Distance is to be measured in each vehicle travel direction at non-gated crossings as viewed from a point 25 feet from centerline of nearest track in the center of whichever travel lane is nearest the direction along track being measured.

Table 2

Stopping Sight Distances

Highway Vehicle Speed	Distance (dH) Along Roadway from Crossing (ft)
0	n/a
5	50
10	70
15	105
20	135
25	180
30	225
35	280
40	340
45	410
50	490
55	570
60	660
65	760
70	865

Source: R-H Grade Crossing Handbook Table 36 (pp. 132-133)

Notes:

All calculated distances are rounded up to the next higher 5-foot increment.

Distances indicated are for 65-ft double bottom semi-tractor trailers on dry level pavements.

Stopping Sight Distance is to be measured on each roadway approach to crossing from stop bar.

JAR
11-4-13