



COLUMBUS | CLEVELAND
CINCINNATI-DAYTON
MARIETTA

BRICKER & ECKLER LLP
100 South Third Street
Columbus, OH 43215-4291
MAIN: 614.227.2300
FAX: 614.227.2390

www.bricker.com
info@bricker.com

Sally W. Bloomfield
614.227.2368
sbloomfield@bricker.com

September 11, 2014

Via Electronic Filing

Ms. Barcy McNeal
Public Utilities Commission of Ohio
Administration/Docketing
180 East Broad Street, 11th Floor
Columbus, OH 43215-3793

**Re: Letter of Additional Information for the Oregon Clean Energy
Center, LLC, Case No. 14-1396-EL-BGA**

Dear Ms. McNeal:

On August 15, 2014 Oregon Clean Energy, LLC ("OCE") filed an Amendment ("Amendment"), in the above-captioned case, to its Certificate that was granted by the Ohio Power Siting Board ("Board" or "OPSB") on May 1, 2013 in Case No. 12-2959-EL-BGN. This letter is to provide additional information to OCE's Amendment filing.

Attached to this letter is a more recent engineering drawing of the facility layout, as depicted in the Amendment. The map shows a temporary trailer parking lot to be used by the project's construction contractors, Black & Veatch. Black & Veatch intends to lease the land to be used for this temporary trailer parking lot.

If you have any questions please call at the number listed above.

Sincerely,

Sally W. Bloomfield

cc: Chris Cunningham; Christina Burri

T:\46837
08/26/14
ACAD 18.2s (LMS Tech)
15:32:59

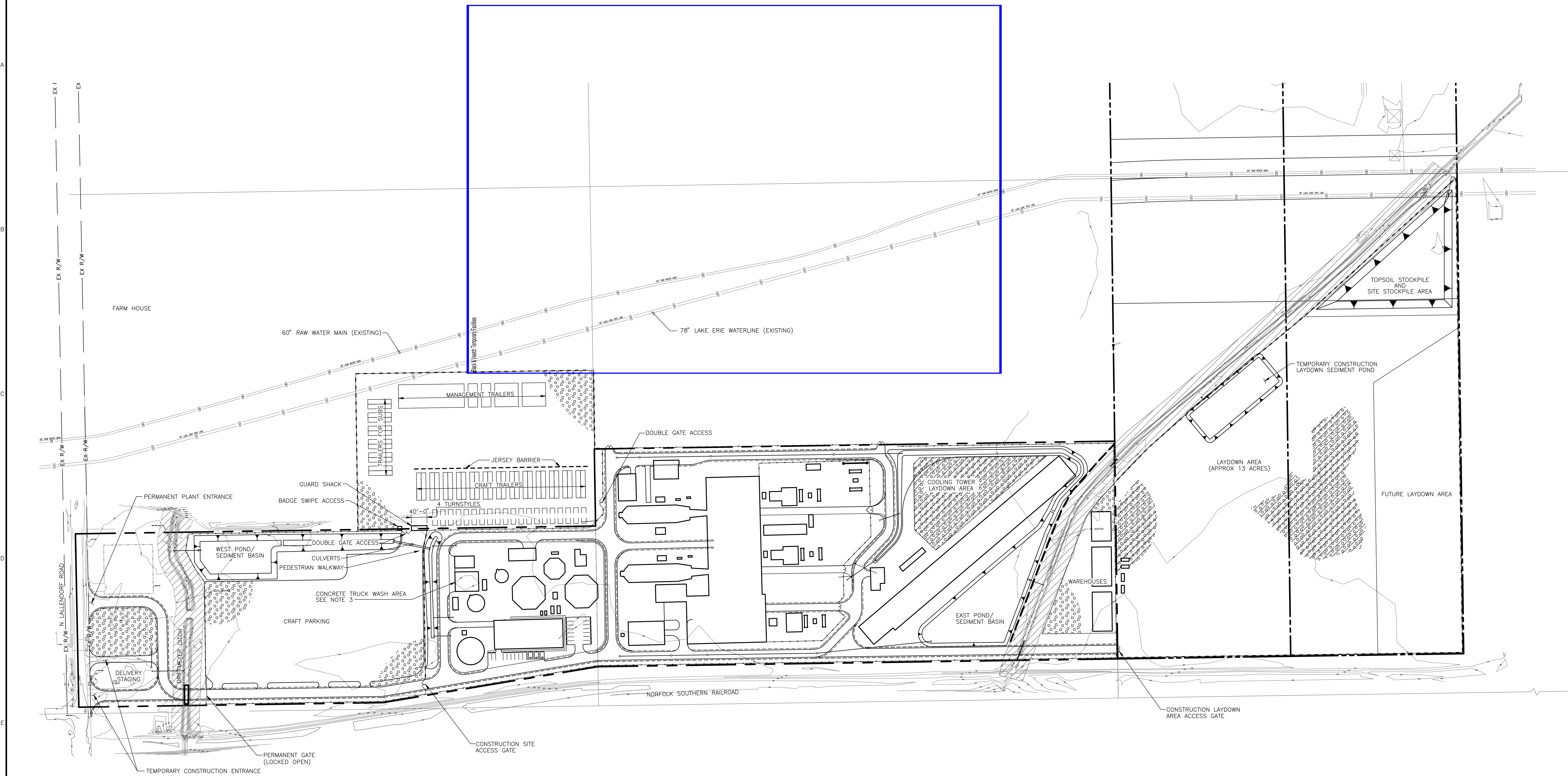

GENERAL LEGEND			
	NEW SECURITY FENCE		ASPHALT SURFACING
	TEMPORARY CONSTRUCTION FENCE		AGGREGATE SURFACING TYPE 1
	PROPERTY BOUNDARY		AGGREGATE SURFACING TYPE 2
			BUFFER
			GRASS

NOTES	
1. SEE DWG 1U2C-S3000 FOR GENERAL NOTES, AND ABBREVIATIONS.	
2. THE PROPERTY BOUNDARY IS FROM THE MANNIK & SMITH GROUP, INC. SITE SURVEY DRAWING DATED 03/14/2014, JOB NO.: C3460004.	
3. CONCRETE TRUCK WASH AREA MAY BE RELOCATED, AS DIRECTED BY SITE MANAGER IN ACCORDANCE WITH THE CONSTRUCTION SWPPP, AS CONSTRUCTION PROGRESSES.	

FOR PERMITTING PURPOSES ONLY
THE DISTRIBUTION AND USE OF THE NATIVE FORMAT CAD FILE OF THIS DRAWING IS UNCONTROLLED. THE USER SHALL VERIFY TRACEABILITY OF THIS DRAWING TO THE LATEST CONTROLLED VERSION.

BLACK & VEATCH CORPORATION OHIO ENGINEERING CREDENTIAL NUMBER FIRM 01645	OREGON CLEAN ENERGY, LLC OREGON CLEAN ENERGY CENTER	PROJECT 184704-1TFX-S3800	DRAWING NUMBER 0
DESIGNER MKK CHECKED IPD DATE 27/AUG/14	DRAWN AET DATE 27/AUG/14	CONSTRUCTION FACILITIES	REV 0

This foregoing document was electronically filed with the Public Utilities

Commission of Ohio Docketing Information System on

9/11/2014 4:42:11 PM

in

Case No(s). 14-1396-EL-BGA

Summary: Correspondence Informational letter concerning location of temporary construction trailers electronically filed by Teresa Orahood on behalf of Sally Bloomfield