

Case No. 14-1049-EL-REN
Couk, James D. & Susan E. Residence - J D & S E Couk
Staff Interrogatories - Initial Set – Response

Question 1: In Sections A through D of the facility application, the address of the facility is listed as "3810 E County Line Rd, Lafayette, IN 47905." According to a search performed on the United States Postal Service website, that address is not recognized. Please verify the address of the facility.

Answer 1: The client has confirmed that there is a discrepancy between what Google Maps shows as the address for this facility, and what the USPS considers the address to be. The only difference is in the "city" for the address.

According to Google maps (and the geographic coordinates shown below), the facility address is 3810 N. County Line Road East, **Delphi**, IN 46923.

According to the US Postal Service, the facility's mailing address is 3810 N. County Line Road East, **Lafayette**, IN 47905.

Question 2: In Section A of the facility application, the coordinates of the facility are listed as (40.323, -86.6951). These coordinates aren't near a residence, but images provided in the application demonstrate that the facility is on a residential rooftop. Please provide more accurate coordinates for the facility.

Answer 2: The coordinates for this facility are 40.472248, -86.694813. Please see below a Google Maps pinpoint for these coordinates. James Couk confirmed that this is the physical location of his facility.

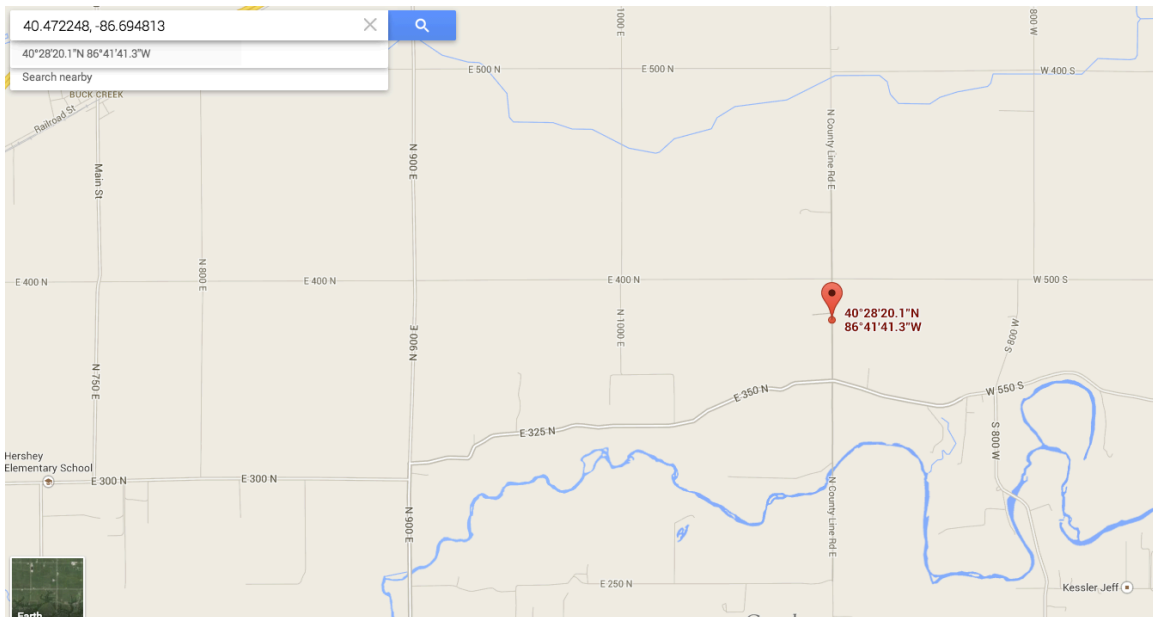

This foregoing document was electronically filed with the Public Utilities

Commission of Ohio Docketing Information System on

9/4/2014 5:49:24 PM

in

Case No(s). 14-1049-EL-REN

Summary: Amended Application Case No. 14-1049-EL-REN
Couk, James D. & Susan E. Residence - J D & S E Couk
Staff Interrogatories - Initial Set - response electronically filed by Mr. Steven Eisenberg on
behalf of James Couk