

Figures – Section 4906-13-02

- Figures 02-1A through 02-1G – Project Area within Five Miles
- Figure 02-2A – Proposed Project and Vicinity (Mitsubishi) and B (Siemens)
- Figures 02-3A and 02-3B – Plot Plan
- Figure 02-4A through 02-4C –Rendering
- Figure 02-5 – Preliminary Water Balance
- Figure 02-6 – Location of Water Treatment Facility Relative to the Site
- Figure 02-7 – Overall Electrical One-Line Diagram
- Figure 02-8 – Project Schedule

C:\Chicago\Author\MNEsta Path\PROJECTS\OCE\MXD\OP\SB_20130104\02-1_OCE_ProjectAreaMB.mxd

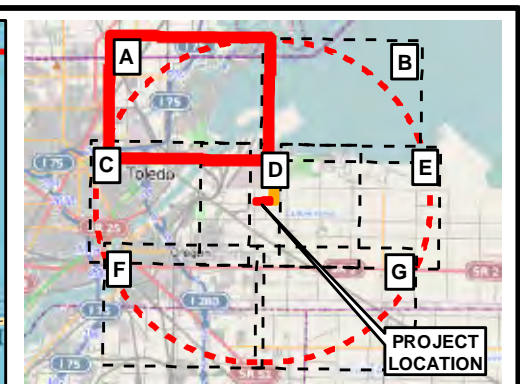
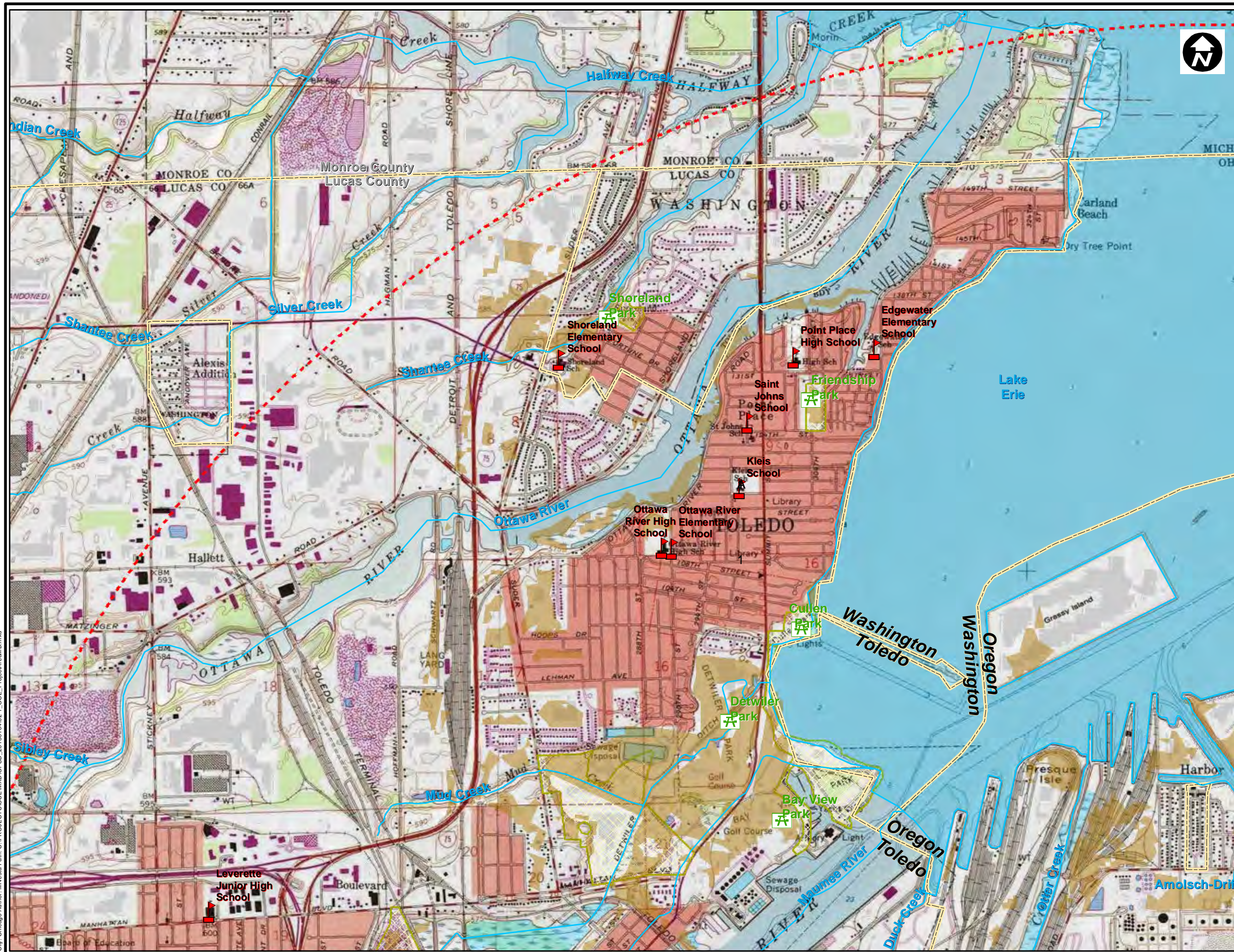

5 Mile Radius / 1:24,000 Scale Index

PAGE INDEX: A

Legend

- Project Site
- Construction Laydown Parcel
- Schools
- Airport
- Heliport
- Substation (Digitized from Topo)
- Transmission Line (Digitized from Topo)
- Parks
- Local Park or Recreation Area
- State park or forest
- National park or forest
- NHD Flowline
- NHD Waterbody
- Developed, Open Space
- Administrative Boundary

Topographic Base Image Source: ArcGIS Online Services, Access date: 12/26/2012, via ArcGIS v. 10. This image is not for re-sale or distribution outside of the use of this PDF.

Data Sources: Schools, Airports, Parks - Geographic Names Information System.

Park Areas: ESRI StreetMap Pro
Flowline/Waterbody: National Hydrology Dataset
Open Space: 2006 National Land Cover Dataset
Administrative Boundaries: Census 2010 Tiger/Line Shapefiles

0 2,000 4,000
Feet

1 inch = 2,000 feet



OREGON CLEAN
ENERGY CENTER

FIGURE 02-1A
PROJECT AREA

Lucas County, Ohio | Date: 01/16/2013

City: Chicago Author: MNeesa Path: C:\PROJECTS\OCE\MXD\OP\SB_20130104\02_1_OCE_ProjectArea\B.mxd

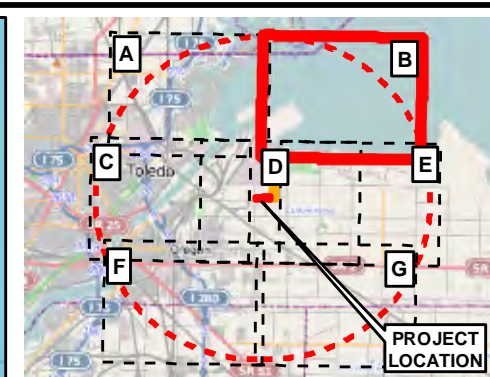
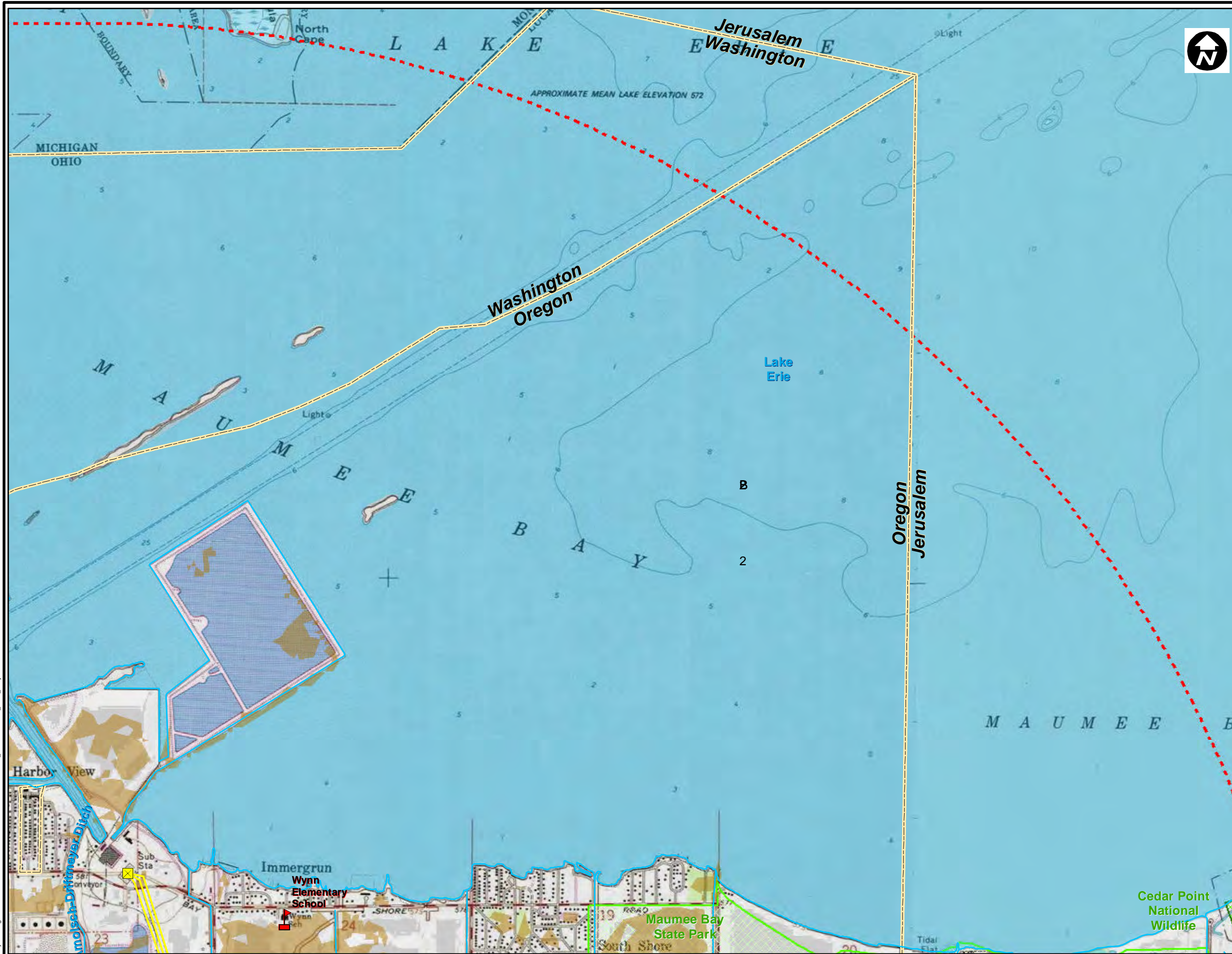

5 Mile Radius / 1:24,000 Scale Index

PAGE INDEX: B

Legend

- Project Site
- Construction Laydown Parcel
- Schools
- Airport
- Heliport
- Substation (Digitized from Topo)
- Transmission Line (Digitized from Topo)
- Parks
- Local Park or Recreation Area
- State park or forest
- National park or forest
- NHD Flowline
- NHD Waterbody
- Developed, Open Space
- Administrative Boundary

Topographic Base Image Source: ArcGIS Online Services, Access date: 12/26/2012, via ArcGIS v. 10. This image is not for re-sale or distribution outside of the use of this PDF.

Data Sources: Schools, Airports, Parks - Geographic Names Information System.

Park Areas: ESRI StreetMap Pro
Flowline/Waterbody: National Hydrology Dataset
Open Space: 2006 National Land Cover Dataset
Administrative Boundaries: Census 2010 Tiger/Line Shapefiles

0 2,000 4,000
Feet

1 inch = 2,000 feet



OREGON CLEAN
ENERGY CENTER

FIGURE 02-1B
PROJECT AREA

Lucas County, Ohio | Date: 01/16/2013

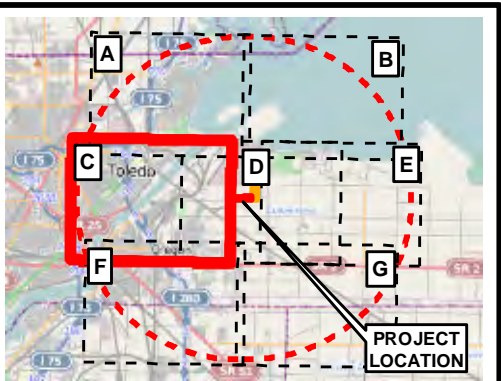
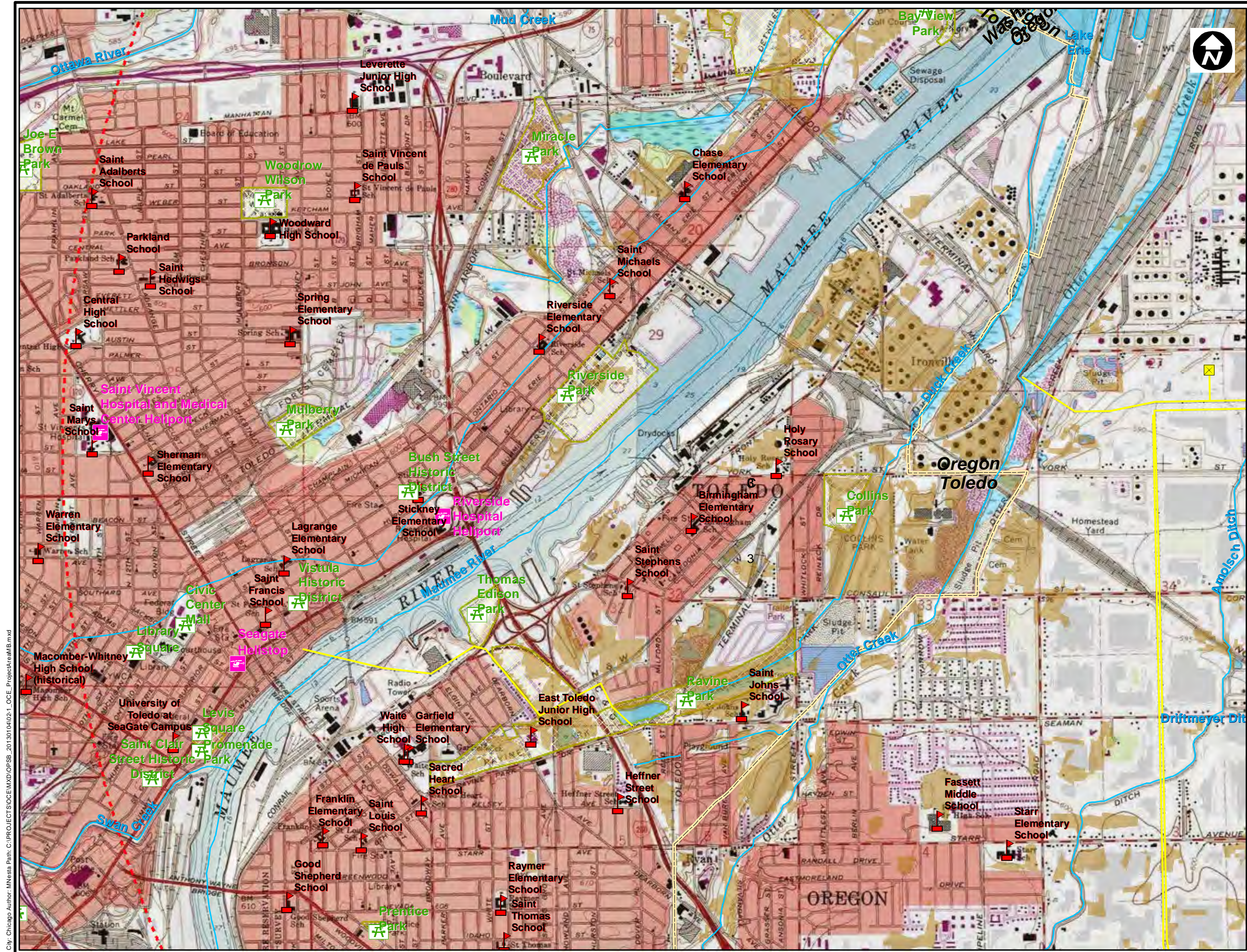

5 Mile Radius / 1:24,000 Scale Index

PAGE INDEX: C

- Legend**
- Project Site
 - Construction Laydown Parcel
 - Schools
 - Airport
 - Heliport
 - Substation (Digitized from Topo)
 - Transmission Line (Digitized from Topo)
 - Parks
 - Local Park or Recreation Area
 - State park or forest
 - National park or forest
 - NHD Flowline
 - NHD Waterbody
 - Developed, Open Space
 - Administrative Boundary

Topographic Base Image Source: ArcGIS Online Services, Access date: 12/26/2012, via ArcGIS v. 10. This image is not for re-sale or distribution outside of the use of this PDF.
Data Sources: Schools, Airports, Parks - Geographic Names Information System.
Park Areas: ESRI StreetMap Pro
Flowline/Waterbody: National Hydrology Dataset
Open Space: 2006 National Land Cover Dataset
Administrative Boundaries: Census 2010 Tiger/Line Shapefiles

0 2,000 4,000
Feet

1 inch = 2,000 feet



OREGON CLEAN ENERGY CENTER

**FIGURE 02-1C
PROJECT AREA**

Lucas County, Ohio | Date: 01/16/2013

City: Chicago Author: MNeeta Path: C:\PROJECTS\OCE\MXD\OPS\SB_20130104\02-1_OCE_ProjectAreaMB.mxd

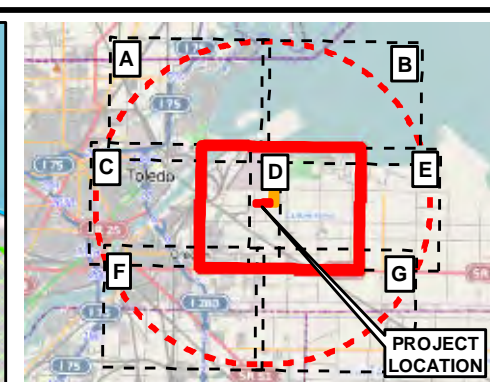
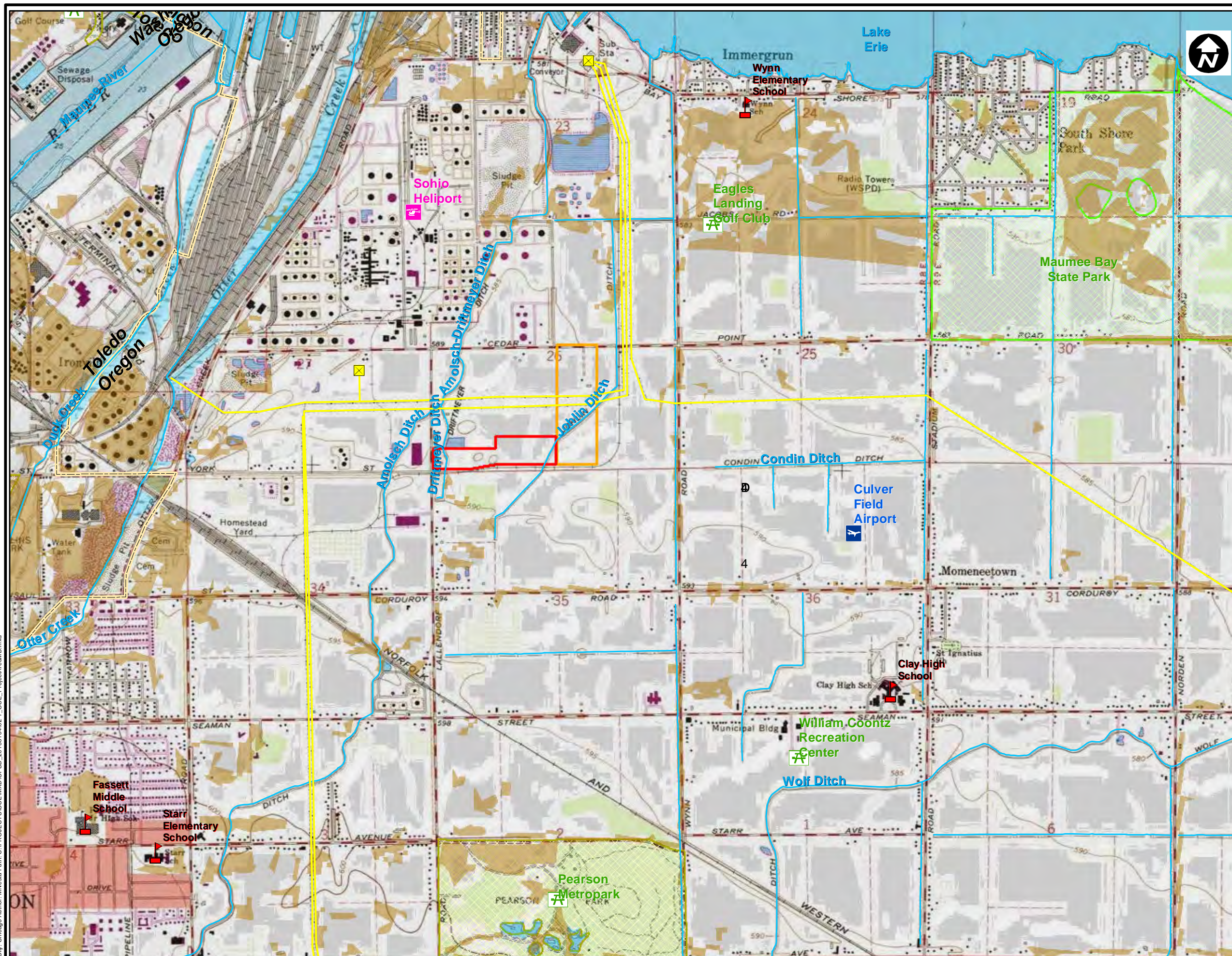

5 Mile Radius / 1:24,000 Scale Index

PAGE INDEX: D

Legend

- Project Site
- Construction Laydown Parcel
- Schools
- Airport
- Heliport
- Substation (Digitized from Topo)
- Transmission Line (Digitized from Topo)
- Parks
- Local Park or Recreation Area
- State park or forest
- National park or forest
- NHD Flowline
- NHD Waterbody
- Developed, Open Space
- Administrative Boundary

Topographic Base Image Source: ArcGIS Online Services, Access date: 12/26/2012, via ArcGIS v. 10. This image is not for re-sale or distribution outside of the use of this PDF.

Data Sources: Schools, Airports, Parks - Geographic Names Information System.

Park Areas: ESRI StreetMap Pro
Flowline/Waterbody: National Hydrology Dataset
Open Space: 2006 National Land Cover Dataset
Administrative Boundaries: Census 2010 Tiger/Line Shapefiles

0 2,000 4,000
Feet

1 inch = 2,000 feet



OREGON CLEAN
ENERGY CENTER

FIGURE 02-1D
PROJECT AREA

Lucas County, Ohio | Date: 01/16/2013

C:\City Chicago\Author: MNeeta Path: C:\PROJECTS\OCE\MXD\OPSB_20130104\02-1_OCE_ProjectAreaMB.mxd

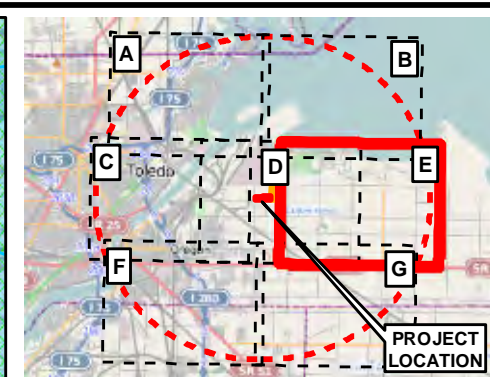
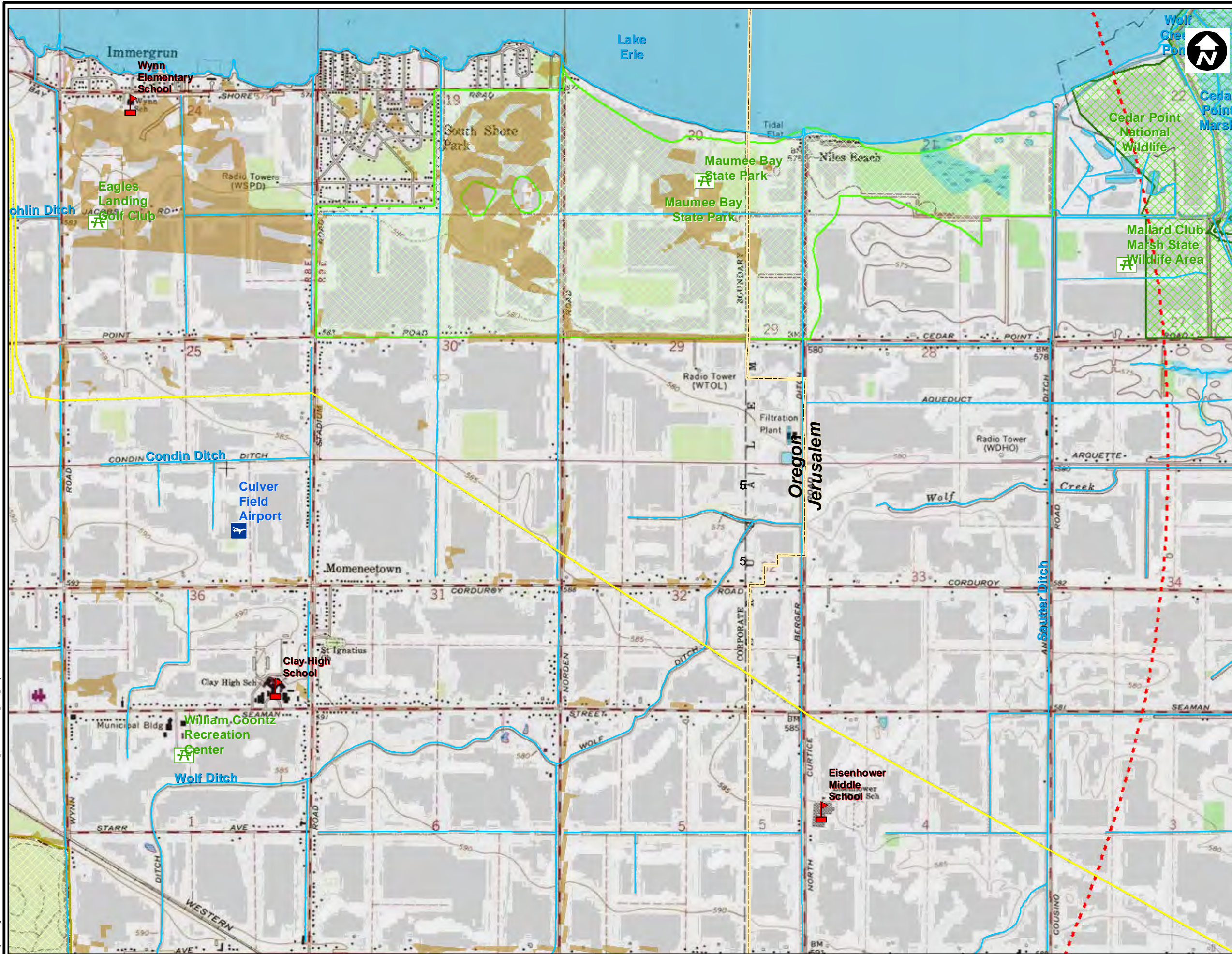

5 Mile Radius / 1:24,000 Scale Index

PAGE INDEX: E

Legend

- Project Site
- Construction Laydown Parcel
- Schools
- Airport
- Heliport
- Substation (Digitized from Topo)
- Transmission Line (Digitized from Topo)
- Parks
- Local Park or Recreation Area
- State park or forest
- National park or forest
- NHD Flowline
- NHD Waterbody
- Developed, Open Space
- Administrative Boundary

Topographic Base Image Source: ArcGIS Online Services, Access date: 12/26/2012, via ArcGIS v. 10. This image is not for re-sale or distribution outside of the use of this PDF.

Data Sources: Schools, Airports, Parks - Geographic Names Information System.

Park Areas: ESRI StreetMap Pro
Flowline/Waterbody: National Hydrology Dataset
Open Space: 2006 National Land Cover Dataset
Administrative Boundaries: Census 2010 Tiger/Line Shapefiles

0 2,000 4,000
Feet

1 inch = 2,000 feet



OREGON CLEAN
ENERGY CENTER

FIGURE 02-1E
PROJECT AREA

Lucas County, Ohio | Date: 01/16/2013

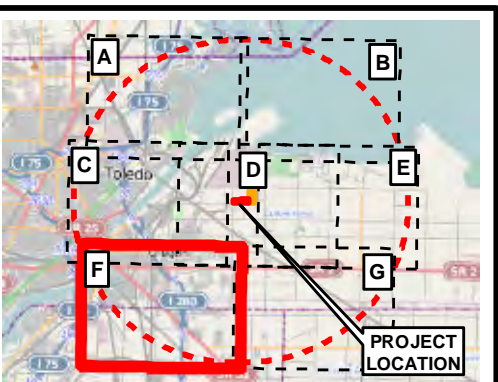
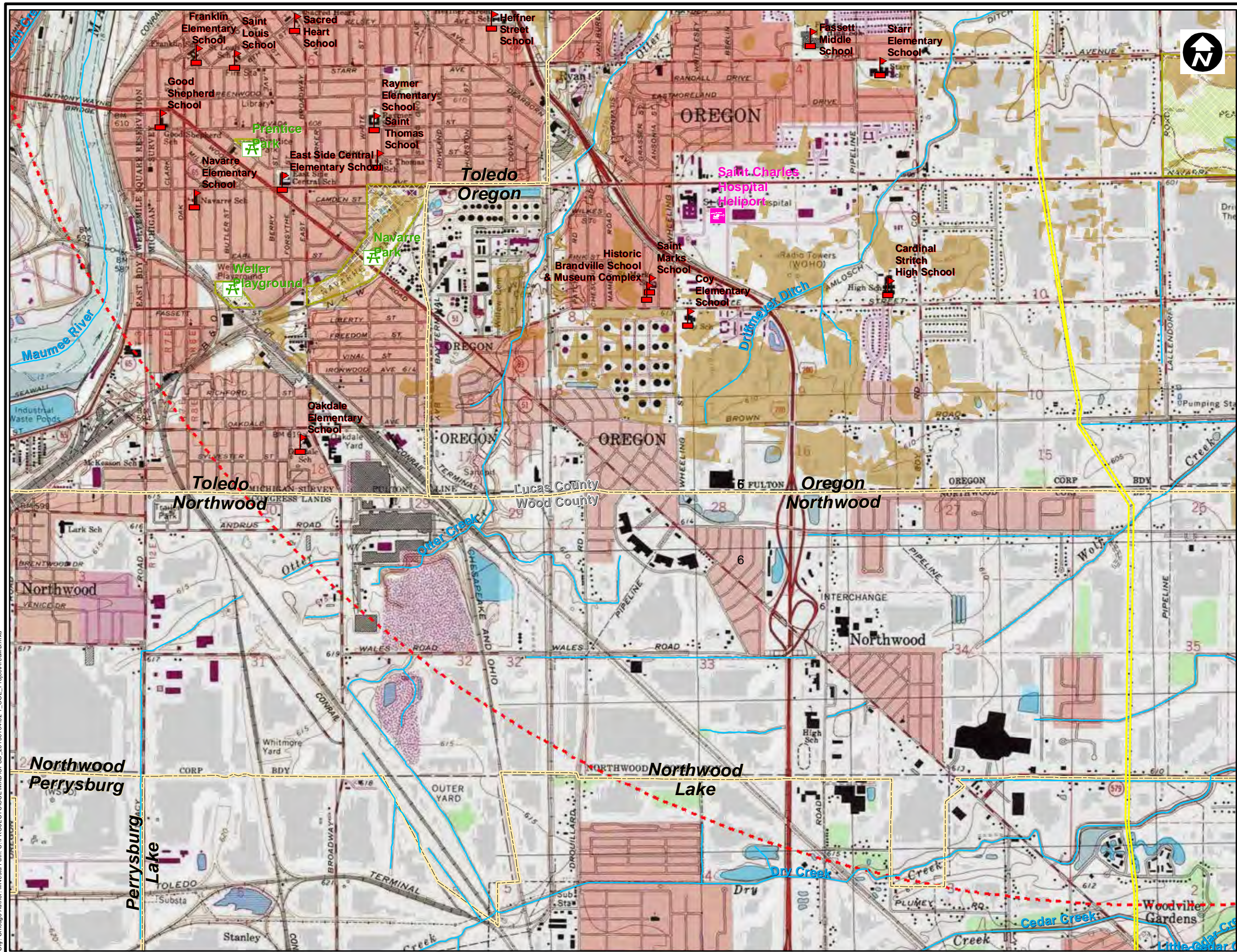

5 Mile Radius / 1:24,000 Scale Index

PAGE INDEX: F

Legend

- Project Site
- Construction Laydown Parcel
- Schools
- Airport
- Heliport
- Substation (Digitized from Topo)
- Transmission Line (Digitized from Topo)
- Parks
- Local Park or Recreation Area
- State park or forest
- National park or forest
- NHD Flowline
- NHD Waterbody
- Developed, Open Space
- Administrative Boundary

Topographic Base Image Source: ArcGIS Online Services, Access date: 12/26/2012, via ArcGIS v. 10. This image is not for re-sale or distribution outside of the use of this PDF.

Data Sources: Schools, Airports, Parks - Geographic Names Information System.

Park Areas: ESRI StreetMap Pro
Flowline/Waterbody: National Hydrology Dataset
Open Space: 2006 National Land Cover Dataset
Administrative Boundaries: Census 2010 Tiger/Line Shapefiles

0 2,000 4,000
Feet

1 inch = 2,000 feet



OREGON CLEAN
ENERGY CENTER

FIGURE 02-1F
PROJECT AREA

Lucas County, Ohio | Date: 01/16/2013

City: Chicago Author: MNeisa Path: C:\PROJECTS\OCE\MXD\OPS\SB_20130104\02-1_OCE_ProjectAreaMB.mxd

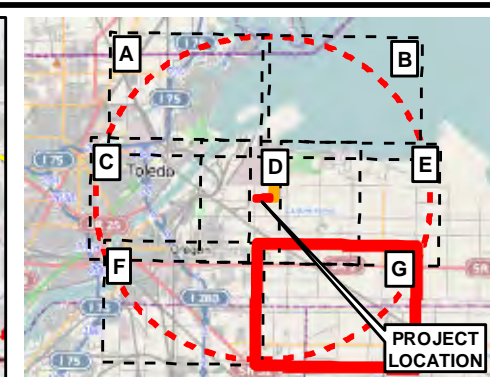
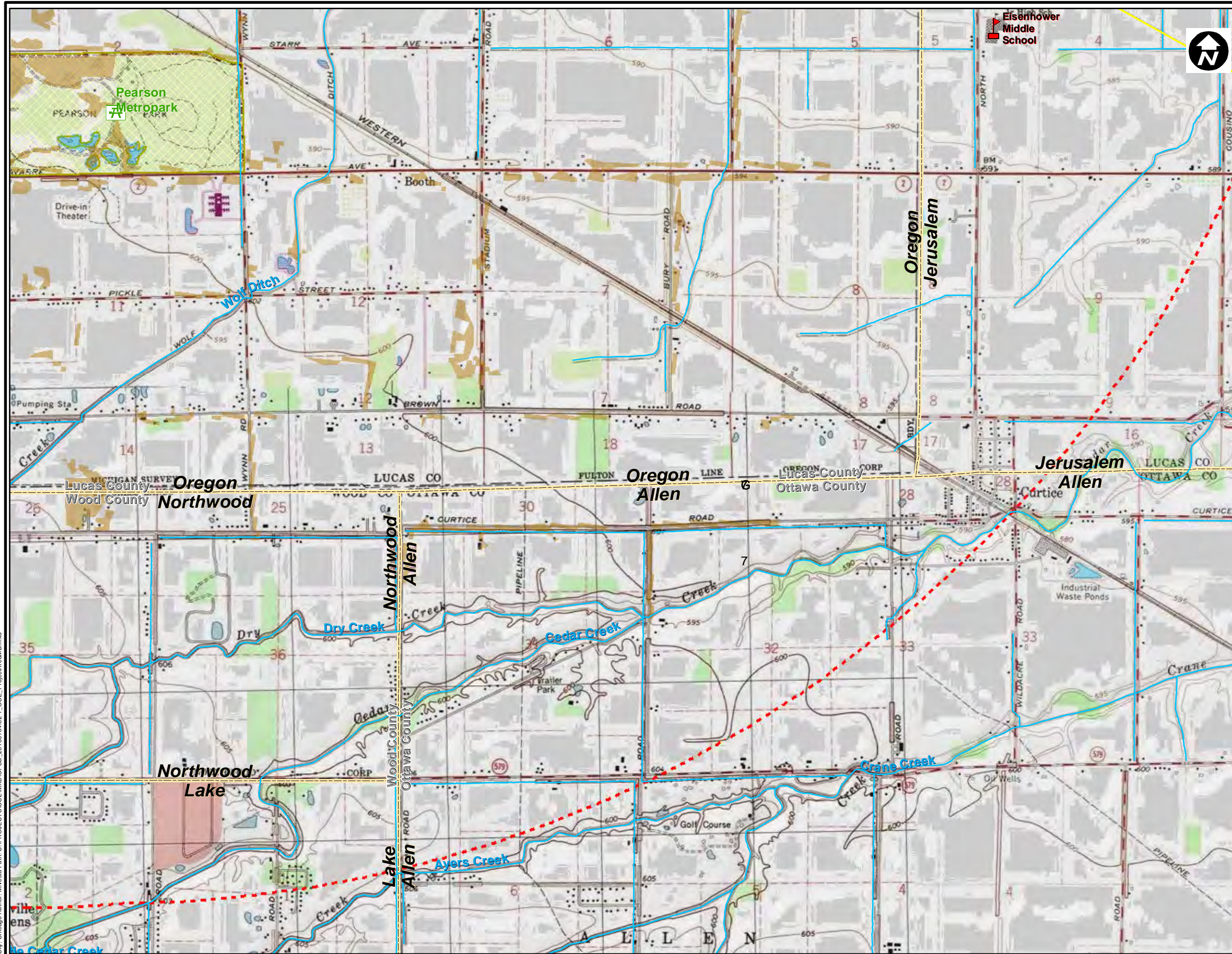

5 Mile Radius / 1:24,000 Scale Index

PAGE INDEX: G

Legend

- Project Site
- Construction Laydown Parcel
- Schools
- Airport
- Heliport
- Substation (Digitized from Topo)
- Transmission Line (Digitized from Topo)
- Parks
- Local Park or Recreation Area
- State park or forest
- National park or forest
- NHD Flowline
- NHD Waterbody
- Developed, Open Space
- Administrative Boundary

Topographic Base Image Source: ArcGIS Online Services, Access date: 12/26/2012, via ArcGIS v. 10. This image is not for re-sale or distribution outside of the use of this PDF.

Data Sources: Schools, Airports, Parks - Geographic Names Information System.

Park Areas: ESRI StreetMap Pro
Flowline/Waterbody: National Hydrology Dataset
Open Space: 2006 National Land Cover Dataset
Administrative Boundaries: Census 2010 Tiger/Line Shapefiles

0 2,000 4,000
Feet

1 inch = 2,000 feet



OREGON CLEAN
ENERGY CENTER

FIGURE 02-1G
PROJECT AREA

Lucas County, Ohio | Date: 01/16/2013

City: Chicago Author: MNeasa Path: C:\PROJECTS\OCE\MXD\OP\SB_20130104\02-2B_OCE_ProposedProjectMtl.mxd



LUCAS COUNTY, OHIO

Legend

- Project Site
- Construction Laydown Parcel
- Substation (Digitized from Topo)
- Transmission Line (Digitized from Topo)
- Proposed Transmission Lines
- Gas Line
- Water Line

Bing Hybrid Aerial Base Image Source: ArcGIS Online Services, Access date: 12/26/2012, via ArcGIS v. 10.
This image is not for re-sale or distribution outside of the use of this PDF.

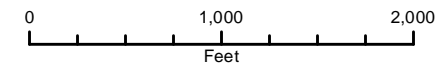

1:12,000



OREGON CLEAN ENERGY, LLC

**FIGURE 02-2B
PROPOSED PROJECT
AND VICINITY**

Lucas County, Ohio | Date: 01/16/2013

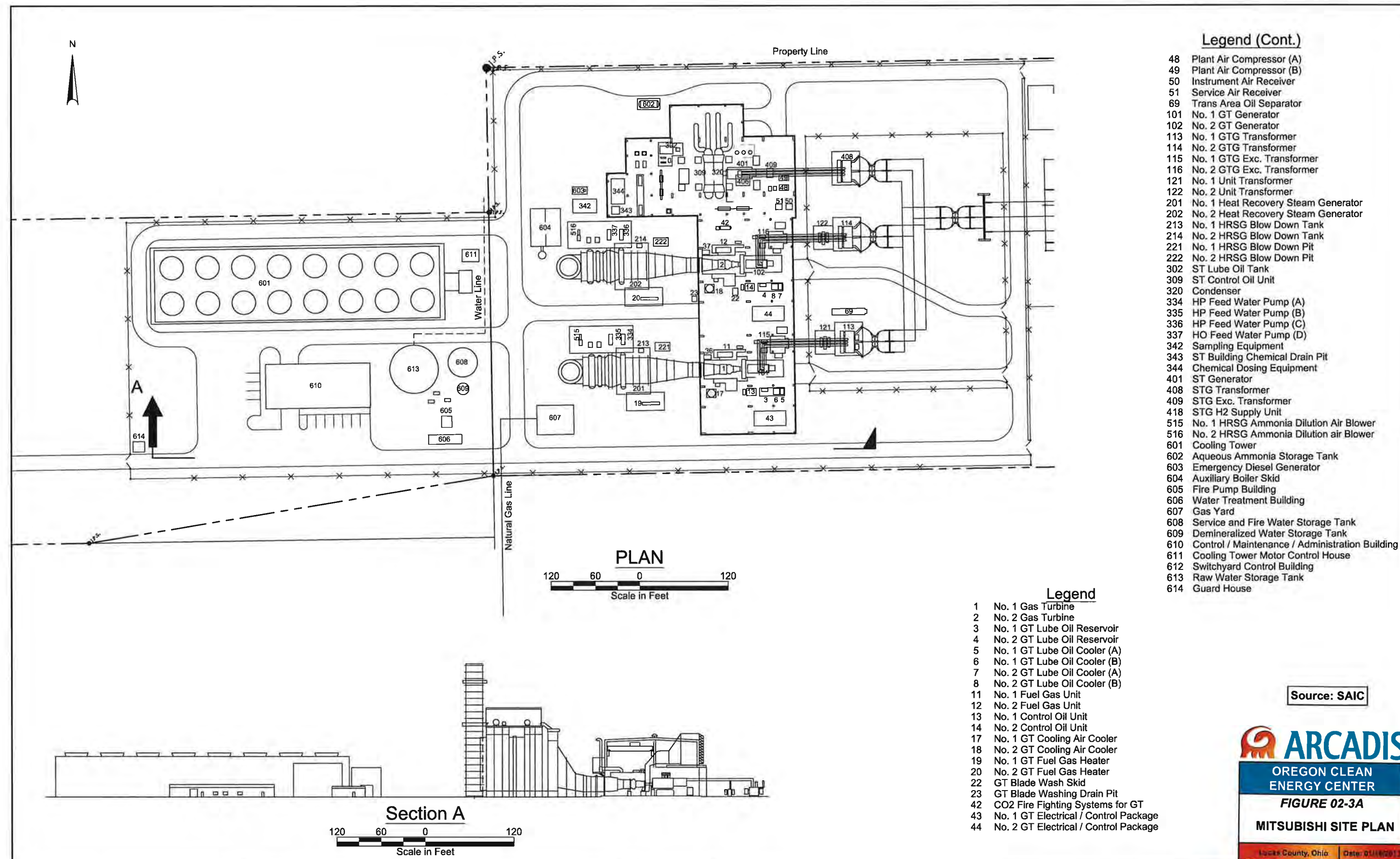

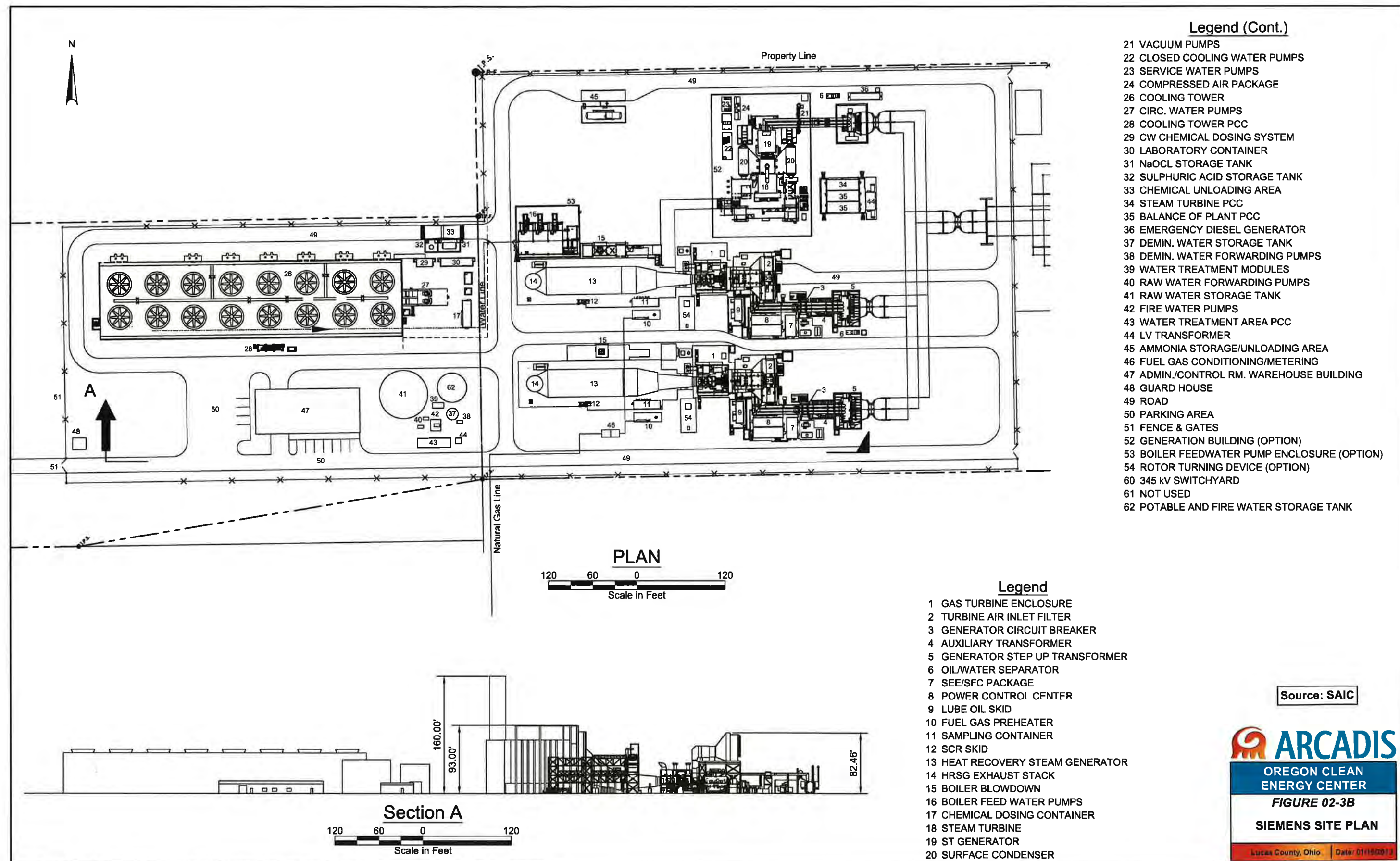



**VISUALIZATION ONLY
NOT TO SCALE**

Source: NTE Energy



**OREGON CLEAN
ENERGY CENTER**

**FIGURE 02-4A
PRELIMINARY RENDERING**

Lucas County, Ohio | Date: 01/16/2013



**VISUALIZATION ONLY
NOT TO SCALE**

Source: NTE Energy



**OREGON CLEAN
ENERGY CENTER**

**FIGURE 02-4B
PRELIMINARY RENDERING**

Lucas County, Ohio | Date: 01/16/2013



**VISUALIZATION ONLY
NOT TO SCALE**

Source: NTE Energy



**OREGON CLEAN
ENERGY CENTER**

**FIGURE 02-4C
PRELIMINARY RENDERING**

Lucas County, Ohio | Date: 01/16/2013

INPUTS [MGD]		
MIN ²	AVG ³	PEAK ⁴
4.18	4.29	4.95
78.80	135.86	466.47
0.00	0.03	0.06

Steam Cycle Circ Flow
Cooling Cycle Circ Flow
Evap Cooler Makeup

OUTPUTS [MGD]		
MIN ²	AVG ³	PEAK ⁴
2.59	3.82	6.68
0.07	0.11	0.16
0.63	0.93	1.61

Raw Water Needed
Potable Water Needed
Sent to WWTP

SUMMARY FLOW TABLE [MGD]			
ID	MIN ²	AVG ³	PEAK ⁴
#1	2.462	3.629	6.346
#2	2.511	3.685	6.418
#3	2.009	2.948	5.131
#4	0.000	0.001	0.002
#5	0.503	0.736	1.280
#6	0.130	0.192	0.334
#7	0.071	0.072	0.084
#8	0.059	0.060	0.071
#9	0.003	0.003	0.004
#10	0.014	0.014	0.017
#11	0.042	0.043	0.049
#12	0.017	0.017	0.020
#13	0.024	0.026	0.029
#14	0.024	0.030	0.037
#15	0.010	0.010	0.013
#16	0.050	0.056	0.068
#17	0.000	0.039	0.075
#18	0.000	0.036	0.072
#19	0.000	0.032	0.058
#20	0.000	0.004	0.009
#21	0.000	0.003	0.014

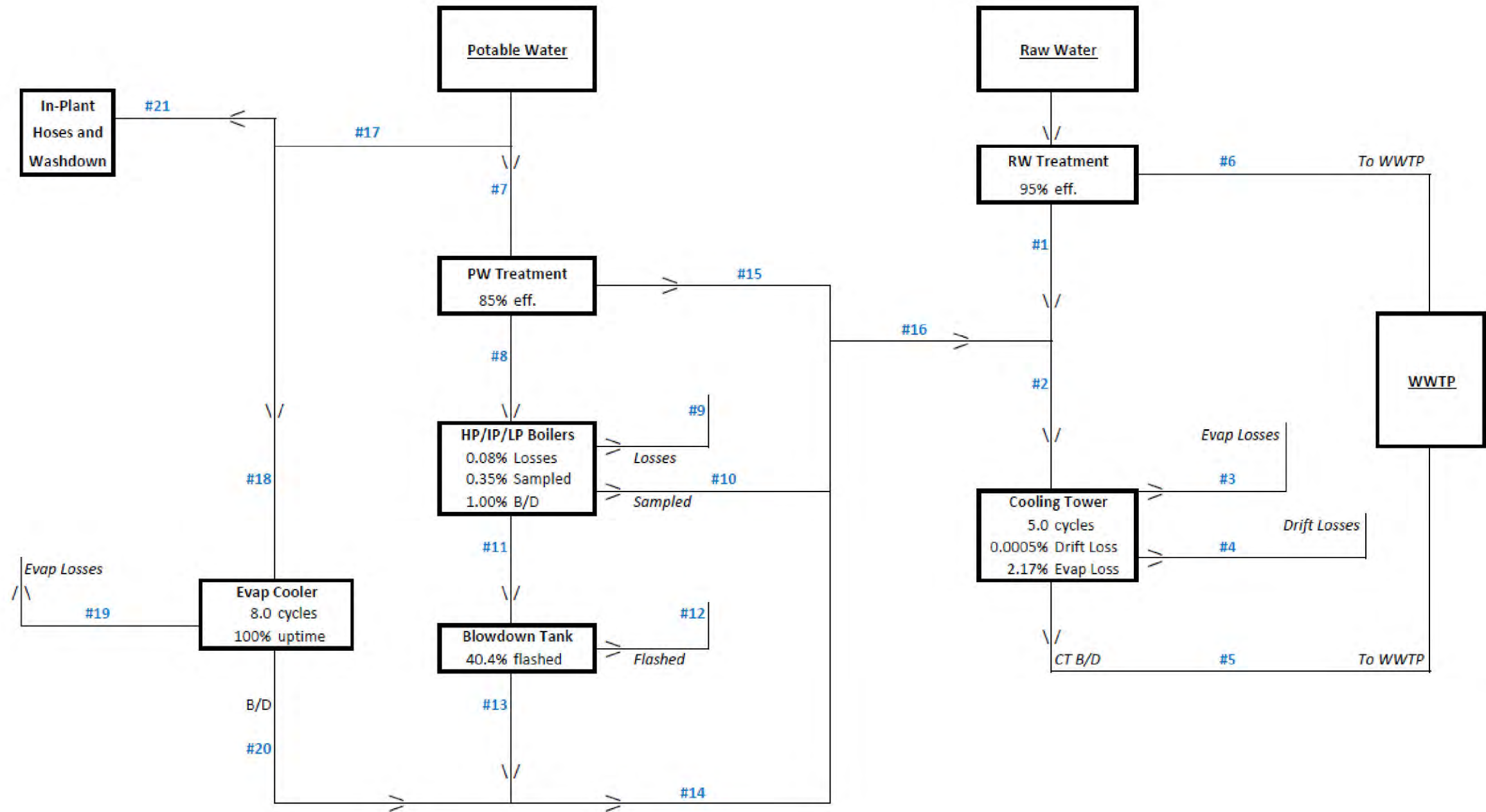

- Notes:
- All values shown are in units of million gallons per day (MGD).
 - The minimum case shown assumes duct burners and evap coolers off, operating at 800 MW net on a 0 F 100% RH day.
 - The average case shown assumes operation with duct burners off at ISO conditions, at 2 x 98% CT load, and evap coolers on.
 - The peak case shown assumes full duct-firing at the 95 F 50% RH design case, with both CTs at full load, and evap coolers on.

SOURCE:
NTE Energy





OREGON CLEAN
ENERGY CENTER

FIGURE 02-5
PRELIMINARY
WATER BALANCE



LUCAS COUNTY, OHIO

Legend

-  Project Site
-  Construction Laydown Parcel
-  Water Treatment Plant

Bing Aerial Hybrid Image Source: ArcGIS Online Services, Access date: 01/04/2013, via ArcGIS v10. This image is not for re-sale or distribution outside of the use of this PDF.

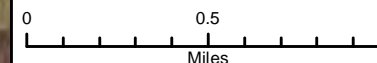

**OREGON CLEAN
ENERGY CENTER**

**FIGURE 02-6
LOCATION OF WATER
TREATMENT FACILITY
RELATIVE TO THE SITE**

Lucas County, Ohio Date: 01/04/2013

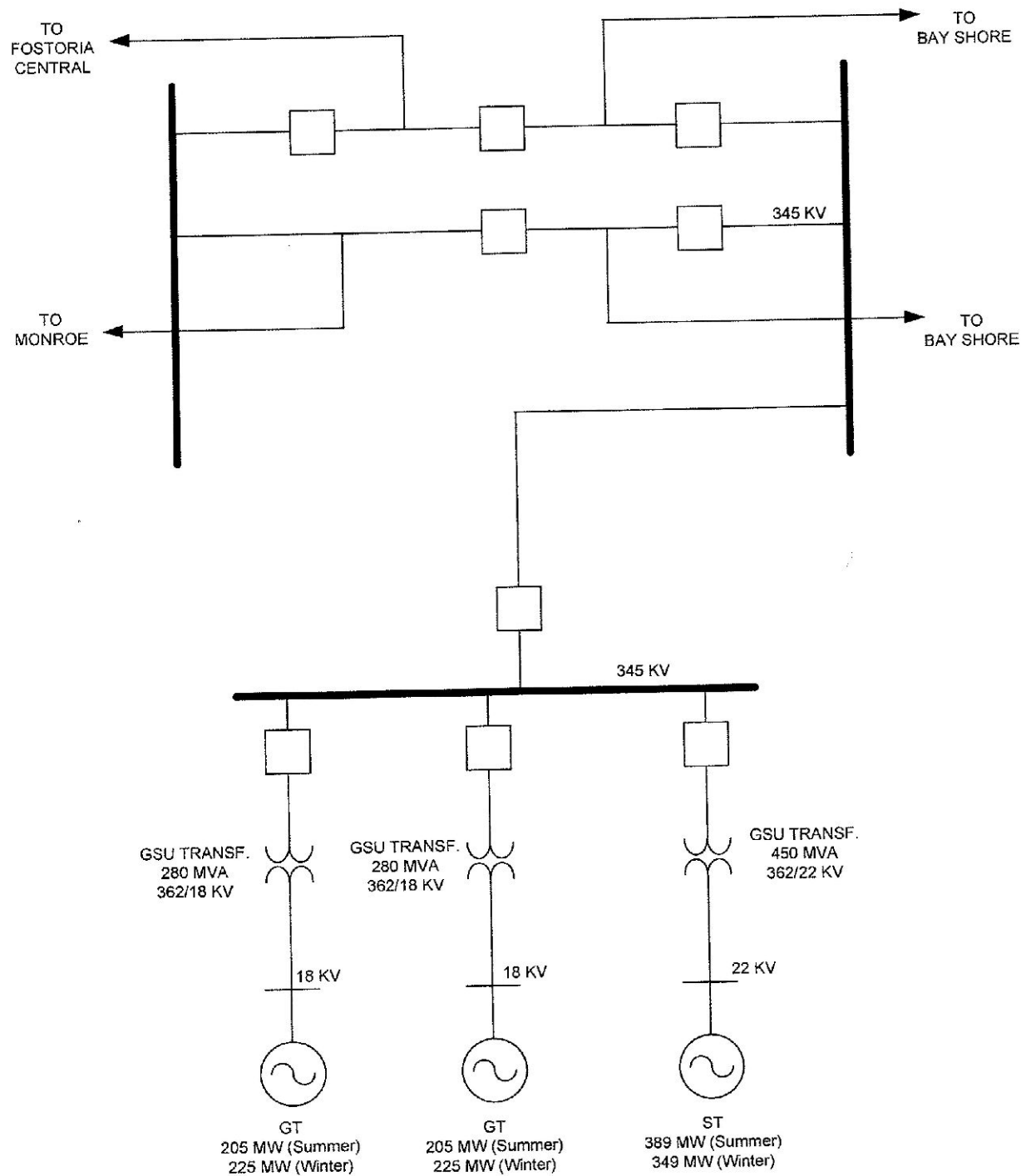

Source:
Oregon Clean Energy, LLC



**OREGON CLEAN
ENERGY CENTER**

**FIGURE 02-7
OVERALL ELECTRICAL
ONE-LINE DIAGRAM**

City: Chicago Author: MNeasa Path: C:\PROJECTS\OCE\MXD\OPSB_20130104\02-8_OCE_Project_Schedule.mxd

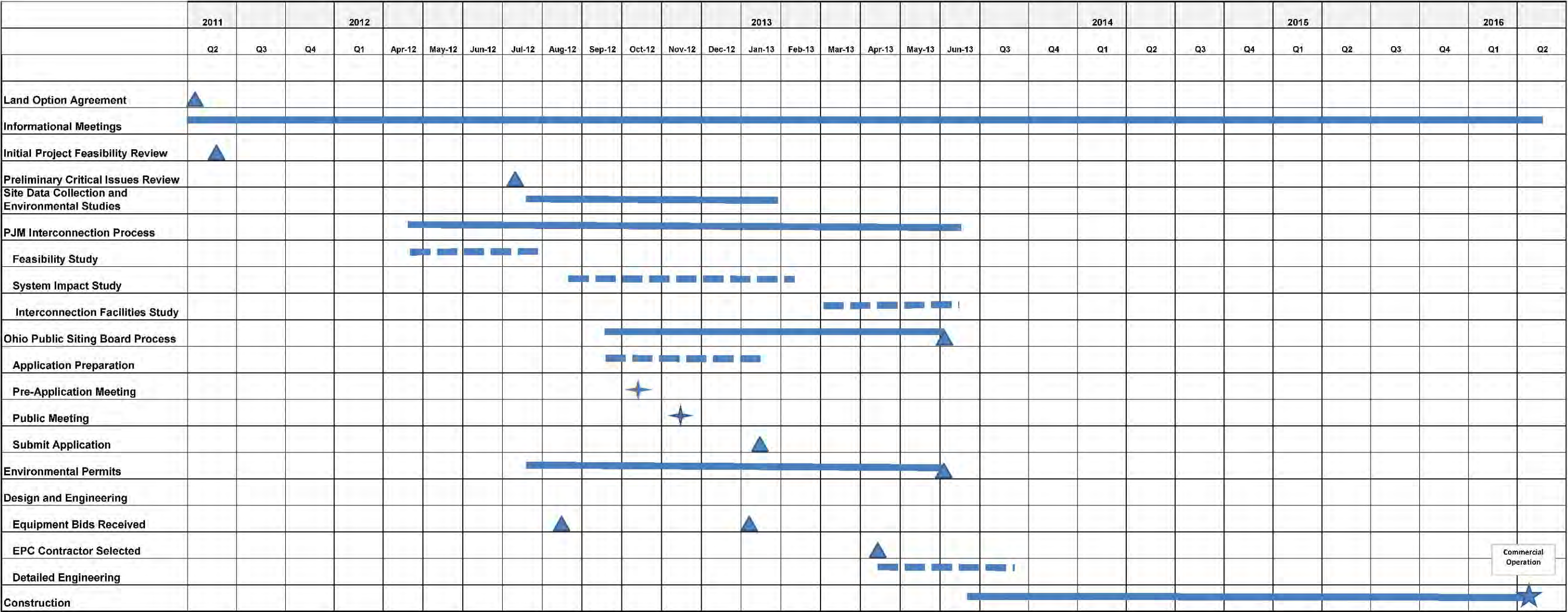

OREGON CLEAN
ENERGY CENTER

FIGURE 02-8
PROJECT SCHEDULE

This foregoing document was electronically filed with the Public Utilities

Commission of Ohio Docketing Information System on

1/17/2013 1:55:36 PM

in

Case No(s). 12-2959-EL-BGN

Summary: Application Section 4906-12-02 Figures electronically filed by Teresa Orahod on behalf of Oregon Clean Energy, LLC and OMA Energy Group