

FILE

USSER

T HMTR  
691-3567Date Prepared  
April 26, 2010

Dominion®

Page 1 of 3

For questions about Dominion East Ohio charges call 1-800-362-7557.

nt Due

int

ount

e by May 12, 2010

112.72  
11,660.88  
\$11,773.60

(See Next Page for Usage Comparison and Meter Readings)

12-1259-GA-CSS

CASE # 12-1259-GA-CSS

RECEIVED SEP 13 2012

RECEIVED-DOCKETING DIV  
2012 SEP 14 PM 12:28  
PUCO

nt Balance of \$11,773.60 by May 12, 2010

## Final Bill Notice -- Dropped from Energy Choice

ast Ohio shut off service to you because of your overdue, unpaid account balance. This is your account, which is now closed. We removed you from the Energy Choice program and have notified your gas supplier. If you wish to establish service with us again, you will need to pay the remaining account balance, so, you will be billed a security deposit in three equal monthly installments or you need to have a creditworthy guarantor. You will also have to pay a reconnection fee if you remain at the same address. To re-enroll again in the Energy Choice program, you must pay all dollars owed or be eligible for a new program. When you can participate in the Energy Choice program, you will be able to purchase gas from a participating natural gas supplier at a new contracted rate.

1 this coupon with a check made payable to Dominion East Ohio. Please see reverse side for mailing address change instructions.

May 12, 2010 Account No. 3 5000 4270 7124

FINAL BILL

0

ice

Amount Enclosed

## SCO Rate Component Change

In Case No. 07-1224-GA-EXM, the Public Utilities Commission of Ohio approved a new Standard Choice Offer (SCO) rate. Effective with this bill, the new SCO rate is \$1.20 plus the NYMEX month-end settlement price rate effective until April 2011. As a result of the variable monthly NYMEX settlement price, the SCO rate changes monthly.

\*\*\*AUTO\*\*5-DIGIT 44691

1 AV 0.335 T#000103

EY L SLUSSER

VESTWOOD CIR

STER OH 44691-4543



DOMINION EAST OHIO

PO BOX 26785

RICHMOND VA 23261-6785



127071240000000011272000011273500 This is to certify that the images appearing are an accurate and complete reproduction of a case file document delivered in the regular course of business.  
Technician SW Date Processed SEP 14 2012

JEFFREY L SLUSSER

431 N MARKET ST HMTR  
WOOSTER OH 44691-3563



Dominion®

431 (2)

Account Number 5000 3429 6154  
Date Prepared August 26, 2008

Next Meter Reading 10/21 - 10/24/2008

For questions about Dominion East Ohio charges call 1-800-362-7557. Avoid estimate-enter a read between 09/23 & 5 p.m. on 09/25/2008 at www.dom.com.

Credits And Charges Since Your Last Bill

Balance from last bill	\$7,233.83
Payment on Aug 25, 2008 - Thank You	100.00 CR
Balance	\$7,133.83
<b>Current Charges</b>	
<b>General Sales Service Rate</b>	
Monthly Service Charge	\$5.70
Gas Usage Charge	
1.4 MCF @ \$14.0857	19.72
Total Current Charges	\$25.42
Total Account Balance	\$7,159.25

This bill includes \$14.92 for SSO gas cost at \$10.657 per thousand cubic feet (MCF) and \$.73 for Gross Receipts Tax.

You may be able to save on the SSO gas cost portion of your bill by shopping for an alternative gas supplier.

Monthly Usage Comparison

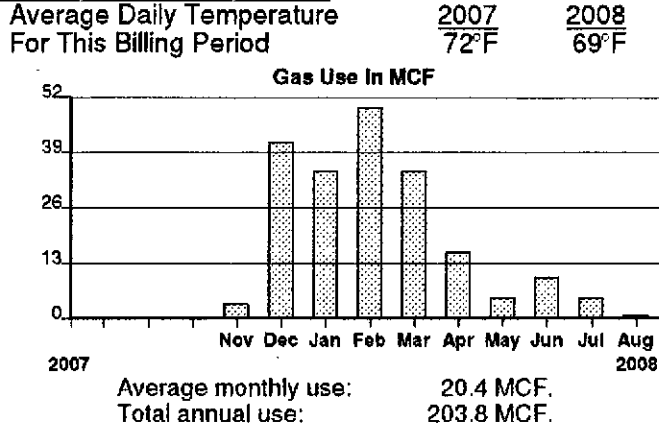

Billing Period And Meter Readings

Date	Read Type	Reading	Difference
Meter Number	18806237		
Aug 21, 2008	Remote	226.6	
Jul 24, 2008	Estimate	225.2	1.4
MCF Used in 28 Days			1.4

Please Pay Account Balance of \$7,159.25 by September 11, 2008

THIS IS A SHUT-OFF NOTICE.

Unless we receive your past-due amount of \$7,133.83 by Sep 11, 2008, your gas may be shut off. If you have any questions about this pending shutoff, please call toll-free 1-800-950-7989. If your gas service is shut-off, you must pay all past-due amounts, a new security deposit and a reconnection fee before we can turn the gas back on. If you are on the Energy Choice program and your service is shut off, you will no longer be served by your current supplier. To participate in the Energy Choice program, you must pay the amount due on time each month.

JEFFREY L SLUSSER

31 N MARKET ST HMTR  
VOOSTER OH 44691-3563



Dominion®

4313

Account Number 5000 3429 6154  
Date Prepared December 27, 2007  
Next Meter Reading 02/22 - 02/27/2008

For questions about Dominion East Ohio charges call 1-800-362-7557. Avoid a  
estimate-enter a read between 01/25 & 5 p.m. on 01/29/2008 at www.dom.com.

Credits And Charges Since Your Last Bill	
Balance from last bill	\$417.40
From Final - Debit	4,709.16
Balance	\$5,126.56
Current Charges	
General Sales Service Rate	
Monthly Service Charge	\$5.70
Gas Usage Charge	
42.3 MCF @ \$12.0028	507.72
Total Current Charges	\$513.42
Total Account Balance	\$5,639.98

This bill includes \$365.60 for SSO gas cost at \$8.643 per thousand cubic  
feet (MCF) and \$17.90 for Gross Receipts Tax.

You may be able to save on the SSO gas cost portion of your bill by  
shopping for an alternative gas supplier.

PD 1.26 CK 13725 400

Monthly Usage Comparison  
Average Daily Temperature  
For This Billing Period 2007  
32°F

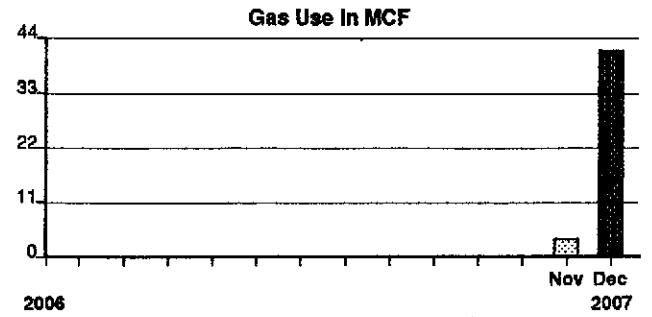

Average monthly use: 23.3 MCF.  
Total annual use: 46.5 MCF.

Billing Period And Meter Readings			
Date	Read Type	Reading	Difference
Meter Number	18806237		
Dec 27, 2007	Remote	69.3	
Nov 20, 2007	Estimate	27.0	42.3
MCF Used in 37 Days			42.3

Please Pay Account Balance of \$5,639.98 by January 14, 2008

THIS IS A SHUT-OFF NOTICE.

Unless we receive your past-due amount of \$5,126.56 by Jan 14, 2008, your gas may be shut off.  
If you have any questions about this pending shutoff, please call toll-free 1-800-950-7989.  
If your gas service is shut-off, you must pay all past-due amounts, a new security deposit and  
a reconnection fee before we can turn the gas back on. If you are on the Energy Choice  
program and your service is shut off, you will no longer be served by your current supplier.  
To participate in the Energy Choice program, you must pay the amount due on time each month.



**Dominion®**

4

August 28, 2010

\*\*\*\*\*AUTO\*\*SCH 3-DIGIT 446  
05954 1 AT 0.357 T#000018  
JEFF L SLUSSER  
1740 WESTWOOD CIR  
WOOSTER OH 44691-4543



**ACCOUNT NO:**

6500012170439

**SERVICE ADDRESS:**

321 NOLD AVE FL 3  
WOOSTER OH 44691-3558

**Balance Due:** \$2,047.84

**Due Date of Final Bill:** 08-18-2010

**Subject: Final Bill Collection Warning**

This is to advise you that we have not received payment of \$2,047.84 which represents your outstanding balance for gas service used at the above service address. In the event that payment has been mailed, please disregard this letter.

If payment has not been made, please remit payment immediately to avoid referral of this account to a collection agency. Referral to a collection agency may be more expensive to you in terms of time and money, since you may be required to pay attorney fees in addition to the balance shown above.

**To avoid further collection action, use one of the following payment methods:**

- **Credit/Debit Card or Electronic Check.** Fees apply. Visit [www.dom.com](http://www.dom.com) any time day or night.
- **Authorized Payment Centers.** If you wish to make a payment in person, visit an authorized payment agent. Visit [www.dom.com](http://www.dom.com) or call (800)362-7557 to find an agent in your area. Fees may apply.
- **By Mail.** Kindly remit payment in full today using the enclosed return envelope.

If you would like to contact us, please call (800)950-7989 Monday through Friday from 7:00 a.m. through 7:00 p.m.

Sincerely,  
Dominion East Ohio  
Customer Credit Services

Enclosure  
lca313

CUT HERE

CUT HERE

Please make checks payable to Dominion East Ohio and return this portion with your payment. Thanks.

<b>PLEASE PAY BY</b>	Upon Receipt	<b>Account No:</b>	6500012170439
<b>Account Balance</b>		<b>Amount Enclosed</b>	
\$2,047.84			

JEFF L SLUSSER  
321 NOLD AVE FL 3  
WOOSTER OH 44691-3558

DOMINION EAST OHIO  
PO BOX 26785  
RICHMOND, VA 23261-6785

SEQ#: 5954 OMR-SW1: 2

0165000121704390000000204784000002047842

Page 3 of 4

For questions about Dominion East Ohio charges call 1-800-362-7557. Avoid : estimate-enter a read between 12/23 & 5 p.m. on 12/29/2009 at [www.dom.com](http://www.dom.com).

Average Daily Temperature For This Billing Period	2008 43°F	2009 48°F
--	--------------	--------------

### Gas Use In MCF

Month	Deaths
Nov 2008	5
Dec 2008	0
Jan 2009	7
Feb 2009	3
Mar 2009	4
Apr 2009	4
May 2009	3
Jun 2009	2
Jul 2009	3
Aug 2009	1
Sep 2009	3
Oct 2009	0
Nov 2009	5

Average monthly use: 3.8 MCF.  
Total annual use: 45.5 MCF.

For questions about DOMINION EAST OHIO charges, call us at 1-800-362-7557.

<u>Date</u>	<u>Read Type</u>	<u>Reading</u>	<u>Difference</u>
Meter Number	12658121		
Nov 23, 2009	Estimate	146.1	
Oct 22, 2009	Remote	140.9	5.2
MCF Used in 32 Days			5.2

For questions about gas supply costs, contact DIRECT ENERGY SERVICES L L C at 1-888-566-9988 or P M B #51, 7385 N State Route 3 Westerville, OH 43082 or [www.directenergy.com](http://www.directenergy.com).

<b>Total Current Charges</b>	<b>\$57.58</b>
<b>Total Account Balance</b>	<b>\$1,986.17</b>

13

\*\*\*\*\*AUTO\*\*5-DIGIT 44691  
15561 2 AV 0.460 T#000064  
JEFF L SLUSSER  
1740 WESTWOOD CIR  
WOOSTER OH 44691-4543



JEFFREY L SLUSSER



Dominion®



Page 2 of 2

1740 WESTWOOD CIR  
WOOSTER OH 44691-4543

Account Number 7 5000 3948 7081 Date Prepared March 23, 2009

Next Meter Reading 05/20 - 05/26/2009

For questions about Dominion East Ohio charges call 1-800-362-7557. Avoid estimate-enter a read between 04/22 & 5 p.m. on 04/24/2009 at [www.dom.com](http://www.dom.com)

**Credits And Charges Since Your Last Bill**

Balance from last bill	\$35.15
Payment on Mar 10, 2009 - Thank You	50.00 CR
Transfer Debit	1,768.00
<b>Balance</b>	<b>\$1,753.15</b>
<b>Current Charges</b>	
<b>General Sales Service Rate</b>	
Basic Monthly Charge	\$12.50
Gas Usage Charges	
18.9 MCF @ \$9.1719	173.35
Gross Receipts Tax	8.56
This bill includes \$120.70 for SSO gas cost at \$6.386 per thousand cubic feet (MCF).	
<b>Total Current Charges</b>	<b>\$194.41</b>
<b>Total Account Balance</b>	<b>\$1,947.56</b>

You may be able to save on the SSO gas cost portion of your bill by shopping for an alternative gas supplier.

**Monthly Usage Comparison**

Average Daily Temperature  
For This Billing Period

2009  
35°F

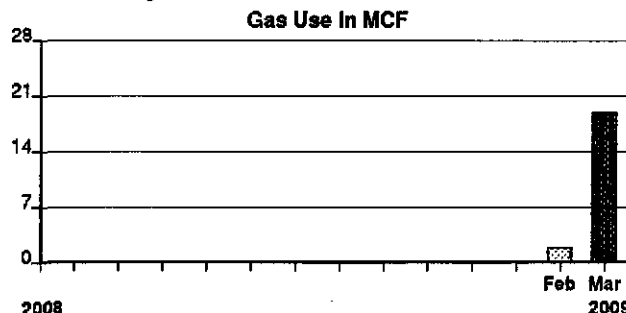

Average monthly use: 10.6 MCF.  
Total annual use: 21.1 MCF.

**Billing Period And Meter Readings**

Date	Read Type	Reading	Difference
Meter Number	11421236		
Mar 20, 2009	Remote	21.1	
Feb 20, 2009	Estimate	2.2	18.9
<b>MCF Used in 28 Days</b>			<b>18.9</b>

Please Pay **Account Balance of \$1,947.56 by April 8, 2009**

**THIS IS A SHUT-OFF NOTICE.**

Unless we receive your past-due amount of \$1,753.15 by Apr 8, 2009, your gas may be shut off. If you have questions about this pending shutoff or need a medical form as outlined below, please call toll-free 1-800-950-7989. If your gas service is shut off, you must pay all past-due amounts. You will be billed a reconnection fee. Also, you will be billed a security deposit in three equal monthly installments or you will need to have a creditworthy guarantor. If you are on the Energy Choice program and your service is shut off, you will no longer be served by your current supplier at the current rate.

NOTE: A medical certification delays a shut off for residential customers when it would be especially dangerous to the health of a permanent member of your household. It allows you time to get financial help. It does not reduce the amount you owe. A licensed medical professional must sign the form.

JEFFREY L SLUSSER



Dominion®



1740 WESTWOOD CIR  
WOOSTER OH 44691-4543

Account Number	Date Prepared	Next Meter Reading	For questions about Dominion East Ohio charges call 1-800-362-7557. Avoid a
1700 0000 3461	October 18, 2006	11/13 - 11/16/2006	estimate-enter a read between 11/14 & 5 p.m. on 11/16/2006 at www.dom.com.

Credits And Charges Since Your Last Bill	
Balance from last bill	\$13.08
Payment on Oct 10, 2006 - Thank You	25.00 CB
From Final - Debit	2,550.14
Balance	\$2,538.22
Current Charges	
General Sales Service Rate	
Monthly Service Charge	\$5.70
Gas Usage Charge	
5.7 MCF @ \$8.1684	46.56
Total Current Charges	\$52.26
Total Account Balance	\$2,590.48

NOT PAID

This bill includes \$32.15 for SSO gas cost at \$5.641 per thousand cubic foot (MCF) and \$1.57 for Gross Receipts Tax.

You may be able to save on the SSO gas cost portion of your bill by shopping for an alternative gas supplier.

from 7.0  
P 2590 C 52.26 PD 50.00 11.7

Monthly Usage Comparison		
Average Daily Temperature For This Billing Period	2005 63°F	2006 55°F

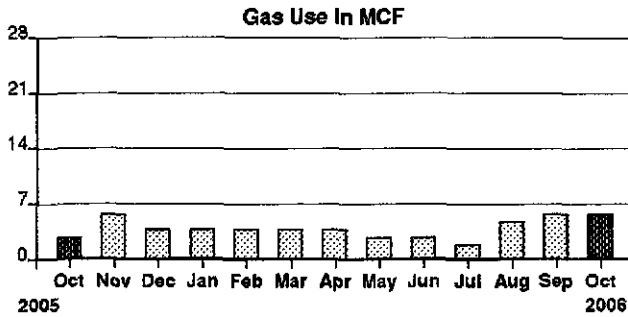

Average monthly use: 4.2 MCF.  
Total annual use: 49.8 MCF.

Billing Period And Meter Readings			
Date	Read Type	Reading	Difference
Meter Number	14002820		
Oct 16, 2006	Estimate	46.8	
Sep 15, 2006	Estimate	41.1	5.7
MCF Used in 31 Days			5.7

Please Pay Account Balance of \$2,590.48 by November 3, 2006

THIS IS A SHUT-OFF NOTICE.

Unless we receive your past-due amount of \$2,538.22 by Nov 3, 2006, your gas may be shut off. If you have questions about this pending shutoff or need a medical form as outlined below, please call toll-free 1-800-950-7989. If your gas service is shut off, you must pay all past-due amounts, a new security deposit and a reconnection fee before we can turn the gas back on. If you are on the Energy Choice program and your service is shut off, you will no longer be served by your current supplier.

NOTE: A medical certification delays a shut off for residential customers when it would be especially dangerous to the health of a permanent member of your household. It allows you time to get financial help. It does not reduce the amount you owe. A licensed physician or local Board of Health physician must sign the form.

15630

99

WILMINGTON DE 19850



# NCO FINANCIAL SYSTEMS INC

507 Prudential Road, Horsham, PA 19044

800-822-1699

OFFICE HOURS:

8AM-9PM MON THRU THURSDAY

8AM-5PM FRIDAY

8AM-12PM SATURDAY

Sep 27, 2010

CREDITOR: EAST OHIO GAS

CREDITOR'S ACCOUNT #: 6500012170439

REGARDING: NCX01222

CURRENT BALANCE DUE: \$ 2047.84

Calls to or from this company may be monitored or recorded for quality assurance.

321-3  
10  
1431



54-1080



2F1IAW

JEFF L SLUSSER

1740 WESTWOOD CIR

WOOSTER OH 44691-4543

## Your Account May Be Credit Reported!

Our records indicate that your balance of \$2047.84 is due in full. It is our intention to work with you to resolve this collection account. However, subject to your dispute and validation rights provided below, if you fail to resolve this collection account, we may report the account to all national credit bureaus.

Returned checks may be subject to the maximum fees allowed by your state.

To assure proper credit, please put our internal account number 2F1IAW on your check or money order.

You may also make payment by visiting us online at [www.ncofinancial.com](http://www.ncofinancial.com). Your unique registration code is C2F1IAW9-9C52U7X. To receive future notices for the account(s) by e-mail, visit [www.ncofinancial.com](http://www.ncofinancial.com) for details.

Unless you notify this office within 30 days after receiving this notice that you dispute the validity of the debt or any portion thereof, this office will assume this debt is valid. If you notify this office in writing within 30 days from receiving this notice, this office will obtain verification of the debt or obtain a copy of a judgment and mail you a copy of such judgment or verification. If you request this office in writing within 30 days after receiving this notice, this office will provide you with the name and address of the original creditor, if different from the current creditor.

This is an attempt to collect a debt. Any information obtained will be used for that purpose. This is a communication from a debt collector.

PLEASE RETURN THIS PORTION WITH YOUR PAYMENT (MAKE SURE ADDRESS SHOWS THROUGH WINDOW)

Our Account #	Current Balance Due
2F1IAW	\$ 2047.84

JEFF L SLUSSER

Payment Amount

\$



321-3  
+0  
431

Check here if your address or phone number has changed and provide the new information below.

Make Payment To:



NCO FINANCIAL SYSTEMS

PO BOX 15740

WILMINGTON, DE 19850-5740

NCOP 1  
1080

0199002F1IAW90000000100000000002047842



15630

99

WILMINGTON DE 19850



# NCO FINANCIAL SYSTEMS INC

507 Prudential Road, Horsham, PA 19044

800-822-1699

OFFICE HOURS:

8AM-9PM MON THRU THURSDAY

8AM-5PM FRIDAY

8AM-12PM SATURDAY

Sep 27, 2010

CREDITOR: EAST OHIO GAS

CREDITOR'S ACCOUNT #: 6500012170439

REGARDING: NCX01222

CURRENT BALANCE DUE: \$ 2047.84

Calls to or from this company may be monitored or recorded for quality assurance.

321-3  
10  
431



54-1080

2F1IAW

JEFF L SLUSSER

1740 WESTWOOD CIR

WOOSTER OH 44691-4543



## Your Account May Be Credit Reported!

Our records indicate that your balance of \$2047.84 is due in full. It is our intention to work with you to resolve this collection account. However, subject to your dispute and validation rights provided below, if you fail to resolve this collection account, we may report the account to all national credit bureaus.

Returned checks may be subject to the maximum fees allowed by your state.

To assure proper credit, please put our internal account number 2F1IAW on your check or money order.

You may also make payment by visiting us online at [www.ncofinancial.com](http://www.ncofinancial.com). Your unique registration code is C2F1IAW9-9C52U7X. To receive future notices for the account(s) by e-mail, visit [www.ncofinancial.com](http://www.ncofinancial.com) for details.

Unless you notify this office within 30 days after receiving this notice that you dispute the validity of the debt or any portion thereof, this office will assume this debt is valid. If you notify this office in writing within 30 days from receiving this notice, this office will obtain verification of the debt or obtain a copy of a judgment and mail you a copy of such judgment or verification. If you request this office in writing within 30 days after receiving this notice, this office will provide you with the name and address of the original creditor, if different from the current creditor.

This is an attempt to collect a debt. Any information obtained will be used for that purpose. This is a communication from a debt collector.

PLEASE RETURN THIS PORTION WITH YOUR PAYMENT (MAKE SURE ADDRESS SHOWS THROUGH WINDOW)

Our Account #	Current Balance Due
2F1IAW	\$ 2047.84

JEFF L SLUSSER

Payment Amount

\$



321-3  
70  
431

Check here if your address or phone number has changed and provide the new information below.

Make Payment To:



NCO FINANCIAL SYSTEMS

PO BOX 15740

WILMINGTON, DE 19850-5740

NCOP 1  
1080

0199002F1IAW90000000100000000002047842

PO BOX 15630  
DEPT 99  
WILMINGTON DE 19850



Calls to or from this company may be monitored  
or recorded for quality assurance.

# NCO FINANCIAL SYSTEMS INC

507 Prudential Road. Horsham, PA 19044

800-392-2084  
OFFICE HOURS:  
8AM-9PM MON THRU THURSDAY  
8AM-5PM FRIDAY  
8AM-12PM SATURDAY  
Jun 30, 2010

10



53-1



816KU1  
JEFFREY L SLUSSER  
1740 WESTWOOD CIR  
WOOSTER OH 44691-4543

312

Creditor	Creditor's Acct #	Regarding	CurBalDue
EAST OHIO GAS	5170000002097	NCX01222	1345.23

Please contact us within 10 days from the date of this letter.

You may also make payment by visiting us online at [www.ncofinancial.com](http://www.ncofinancial.com). Your unique registration code is C816KU19-9BYLB6A. To receive future notices for the account(s) by e-mail, visit [www.ncofinancial.com](http://www.ncofinancial.com) for details.

800-392-2084

This is an attempt to collect a debt. Any information obtained will be used for that purpose. This is a communication from a debt collector.

PLEASE RETURN THIS PORTION WITH YOUR PAYMENT (MAKE SURE ADDRESS SHOWS THROUGH WINDOW)

Our Account #	Current Balance Due
816KU1	\$ 1345.23

JEFFREY L SLUSSER

Payment Amount

\$

312  
TD  
334

Check here if your address or phone number has  
changed and provide the new information below.

Make Payment To:



NCO FINANCIAL SYSTEMS  
PO BOX 15740  
WILMINGTON, DE 19850-5740

NCOP K  
1

019900816KU130000000100000000001345234

PO BOX 15630  
DEPT 99  
WILMINGTON DE 19850

# NCO FINANCIAL SYSTEMS INC

507 Prudential Road, Horsham, PA 19044

800-355-7040

OFFICE HOURS:

8AM-9PM MON THRU THURSDAY

8AM-5PM FRIDAY

8AM-12PM SATURDAY

Aug 27, 2010

Calls to or from this company may be monitored  
or recorded for quality assurance.



55-137



8I6KU1  
JEFFREY L SLUSSER  
1740 WESTWOOD CIR  
WOOSTER OH 44691-4543

2/2

Creditor  
EAST OHIO GAS

Creditor's Acct #  
5170000002097

Current Due  
1345.23

A review of our records indicates that you have not kept the payment arrangement you made with our office. Please contact us within 3 days of your receipt of this letter to discuss why you have not sent your payment. Otherwise, the previous arrangements you made will be null and void. If you want to honor the arrangement, please forward your payment.

To assure proper credit, please enclose the lower portion of this letter, or a copy thereof, with your payment.

You may also make payment by visiting us online at [www.ncofinancial.com](http://www.ncofinancial.com). Your unique registration code is C8I6KU19-9BYLB6A. To receive future notices for the account(s) by e-mail, visit [www.ncofinancial.com](http://www.ncofinancial.com) for details.

Any questions regarding the account(s) should be directed to this office at the above address or phone 800-355-7040.

This is an attempt to collect a debt. Any information obtained will be used for that purpose. This is a communication from a debt collector.

PLEASE RETURN THIS PORTION WITH YOUR PAYMENT (MAKE SURE ADDRESS SHOWS THROUGH WINDOW)

Our Account #	Current Balance Due
8I6KU1	\$ 1345.23

JEFFREY L SLUSSER

Payment Amount

\$



312  
TO  
350

Check here if your address or phone number has  
changed and provide the new information below.

Make Payment To:



NCO FINANCIAL SYSTEMS

PO BOX 15740

WILMINGTON, DE 19850-5740

NCOP H  
137

0199008I6KU130825100100134523001345234

PO BOX 15630  
DEPT 99  
WILMINGTON DE 19850

# NCO FINANCIAL SYSTEMS INC

507 Prudential Road, Horsham, PA 19044

800-355-7040  
OFFICE HOURS:  
8AM-9PM MON THRU THURSDAY  
8AM-5PM FRIDAY  
8AM-12PM SATURDAY  
Oct 5, 2010

Calls to or from this company may be monitored  
or recorded for quality assurance.



59-310



816KU1  
JEFFREY L SLUSSER  
1740 WESTWOOD CIR  
WOOSTER OH 44691-4543

312

Creditor	Creditor's Acct #	Regarding	CurBalDue
EAST OHIO GAS	5170000002097	NCX01222	1345.23

You have not responded to our letter(s) regarding the above account(s). We are sure you have a reason for not resolving the account(s). However, we have no way of knowing unless you advise us.  
Please complete the information below and mail it to us.

1) I can pay \$\_\_\_\_\_ per month starting \_\_\_\_\_.

2) I haven't paid because\_\_\_\_\_

You may also make payment by visiting us online at [www.ncofinancial.com](http://www.ncofinancial.com). Your unique registration code is C816KU19-9BYLB6A. To receive future notices for the account(s) by e-mail, visit [www.ncofinancial.com](http://www.ncofinancial.com) for details.

This is an attempt to collect a debt. Any information obtained will be used for that purpose. This is a communication from a debt collector.

PLEASE RETURN THIS PORTION WITH YOUR PAYMENT (MAKE SURE ADDRESS SHOWS THROUGH WINDOW)

Our Account #	Current Balance Due
816KU1	\$ 1345.23

JEFFREY L SLUSSER

Payment Amount



\$

312  
17  
312

Check here if your address or phone number has  
changed and provide the new information below.

Make Payment To:

|||||  
NCO FINANCIAL SYSTEMS  
PO BOX 15740  
WILMINGTON, DE 19850-5740

NCOP J  
310

019900816KU130825100100134523001345234

# AllianceOne

Receivables Management, Inc.

1684 Woodlands Dr. Ste 150  
Maumee OH 43537

↑ Please send all correspondence to the above address

Telephone: 866-590-6320  
June 21, 2010

Name : JEFFREY L SLUSSER  
Account Number : 19007720 PIN : T77208  
Client Reference Number : 3500042707124  
Client : DOMINION EAST OHIO(GAS)

13

Your account has been referred to our office for Collections.

If this has been an oversight on your behalf, mail the balance in full to our office. If you are experiencing financial difficulties, call our office and a representative will assist you in negotiating a suitable arrangement.

Telephone: 866-590-6320

Unless you notify this office within 30 days after receiving this notice that you dispute the validity of this debt or any portion thereof, this office will assume this debt is valid. If you notify this office in writing within 30 days from receiving this notice that you dispute this debt or any portion thereof, this office will obtain verification of the debt or obtain a copy of a judgment and mail you a copy of such judgment or verification. If you request this office in writing within 30 days after receiving this notice, this office will provide you with the name and address of the original creditor, if different from the current creditor.

It is our practice to place information regarding the debt with the appropriate credit-reporting agencies.

By sending us a check or giving us your checking account information for payment, you authorize AllianceOne to collect funds electronically, in which case your check may not be returned to you. We can also arrange for a direct debit from your checking account.

As of the date of this letter, you owe \$11623.60. Your account balance may be periodically increased due to the addition of accrued interest or other charges if so provided in your agreement with your original creditor.

This communication is from a debt collector. This is an attempt to collect a debt, and any information obtained will be used for that purpose.

AW  
TO TAX

✂ Detach Bottom Portion And Return With Payment ✂



PO BOX 510987  
LIVONIA MI 48151-6987  
RETURN SERVICE REQUESTED

↑ Mail return address only; send no letters

To contact us regarding your account, call:  
866-590-6320

AllianceOne  
Receivables Management, Inc.

Regarding		
DOMINION EAST OHIO(GAS)		
Client Reference Number	Balance	Amount Enclosed
3500042707124	\$11623.60	\$ .

↓ Please make check or money order payable to:

S-ONAMFC10 L-3000 A-19007720 O-DOM  
P1543U00402838 I02840

JEFFREY L SLUSSER  
1740 WESTWOOD CIR  
WOOSTER OH 44691-4543



ALLIANCEONE RECEIVABLES MANAGEMENT INC.  
PO BOX 3102  
SOUTHEASTERN PA 19398-3102



DOM 0003500042707124 19007720 0 00000000 0001162360 0000000000 0

# Property Record Card - Wayne County, Ohio

DATE: 03/07/2014 11:04 AM

141

General Parcel Information	
Parcel	64-00165.000
Owner	SLUSSER JEFFREY & KATHLEEN
Address	431 N MARKET ST WOOSTER OH 44691
Mailing Address Line 1	SLUSSER JEFFREY & KATHLEEN
Mailing Address Line 2	1740 WESTWOOD CIR
Mailing Address Line 3	WOOSTER OH 44691
Land Use	401 - APARTS 4 TO 19 RENTAL UNITS
Legal Description	LOT 1595 60' MP 49 CD 1622
Tax District	64
School District	WOOSTER CSD
Township	KILLBUCK TOWNSHIP
City	WOOSTER CITY

Valuation Details						
Appraised Land Value	Assessed Land Value	Appraised Improvements Value	Assessed Improvements Value	Appraised CAUV Value	Assessed CAUV Value	Taxable Value
\$35,640	\$12,470	\$76,840	\$26,890	\$0	\$0	\$39,360

Land Details					
Land Type	Acreage	Depth	Frontage	Depth Factor	Value
P4 - BUILDING SITE	0.2479	0	0	100	\$35,640

Agricultural Details				
Soil Type	Land Usage	Land Type	Acres	Value
No Agricultural Information Available				

Sales Details			
Date	Buyer	Seller	Price
1/1/1987	SLUSSER JEFFREY & KATHLEE	unknown	\$0

Card 1 - Residential					
Building Style	COMM ON RES SCHED	Finished Area	2940	Rooms	0
Year Built	1880	First Floor Area	1470	Bedrooms	4
Stories	2	Half Floor Area	0	Family Rooms	0
Basement	FULL BASEMENT	Upper Floor Area	1470	Full Baths	4
Heating	CENTRAL WARM AIR	Finished Basement Area	0	Half Baths	1
Cooling	NONE	Exterior Wall	FR	No. Fireplace Openings	0
Attic	NONE	Total Card Value	\$76,840	No. Fireplace Stacks	0

Card 1 - Additions			
Description	Area	Year Built	Value
OFF-Open Fr Porch	336	1880	\$6,650
OFF-Open Fr Porch	60	1880	\$2,150

# Card 1 - Sketch

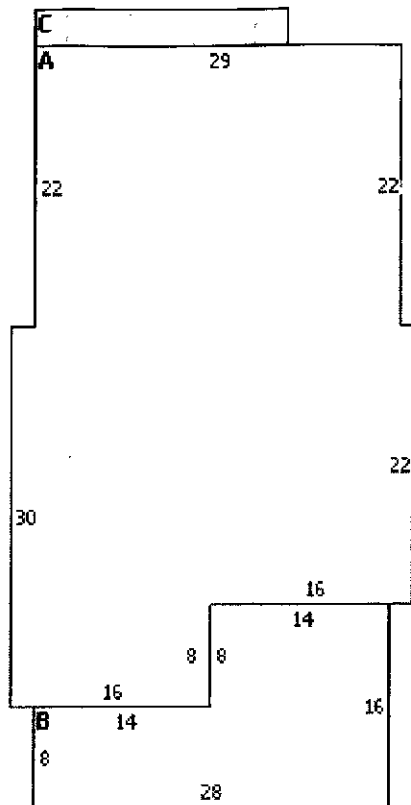

Scale: 5ft

A	2 s Fr/B
	1470 sqft
B	OFP
	336 sqft
C	OFP
	60 sqft

15

1740 WESTWOOD CIRCLE WOOSTER 44691  
OR

725 SPENCE WOOSTER 44691  
OR

878 ZELENTA DR

AKRON 44319

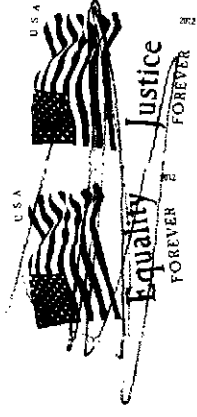

180 EAST BEARD STREET

COLUMBUS, OHIO 43215