

NC
FILE

Public Utilities
Commission of Ohio

Memo

RECEIVED-DOCKETING DIV
2010 JAN 13 AM 11:27
PUCO

To: Docketing Division
From: George Martin, Grade Crossing Planner, Rail Division *GM*
Re: In the matter of the authorization of the Wheeling & Lake Erie Railway to install an active grade crossing warning device in Huron County
Date: January 13, 2010

The Ohio Rail Development Commission (ORDC) has authorized funding for the Wheeling & Lake Erie Railway (WE) to install flashing lights and roadway gates at the following location:

Huron County, near Ripley, New State Rd/CR 150, DOT # 001-983K

This grade crossing was surveyed on December 14, 200 (survey attached) and was found to warrant an upgrade to lights and gates.

The project is actual cost and will be paid for with federal funds. Staff requests an Entry with plans and estimates to be submitted within 90 days and completion within one year. Upon approval of the plans and estimates by ORDC construction may commence. A suggested case coding and heading would be:

PUCO Case No. 10-*0044* -RR-FED In the matter of the authorization of the Wheeling & Lake Erie Railway to install an active grade crossing warning device in Huron County

C: Legal Department

Please serve the following parties of record.

This is to certify that the images appearing are an accurate and complete reproduction of a case file document delivered in the regular course of business.
Technician *AD* Date Processed *4/3/10*

Ms Susan Kirkland
Ohio Rail Development Commission
1980 W Broad St, 2nd Floor
Columbus, Oh 43223

Mr Dan Reinsel
Wheeling & Lake Erie Railway
100 East First St
Brewster, Oh 44613

Mr Joseph Kovach
Huron County Engineer
150 Jefferson St
Norwalk, Oh 44857-1996

Firelands Electric Cooperative
PO Box 32
New London, Oh 44851-0032

OHIO RAIL DEVELOPMENT COMMISSION INTEROFFICE COMMUNICATION

TO: George Martin, Railroad Division, PUCO
FROM: Joseph N. Reinhardt, Grade Crossing Specialist
SUBJECT: Grade Crossing Warning Project
DATE: January 6, 2010

You may authorize the following warning project to proceed with the non-field work involved with the below mentioned non-lump sum project. This construction authorization is made with the stipulation and understanding that any field work needs prior approval before the work begins. This authorization is made with the stipulation and understanding that an approved estimate may contain entries for items or activities that may be cited and found to be ineligible for federal participation during the project audit.

Project List

Wheeling & Lake Erie Railway:

Huron County, New State Road, DOT 001983K

Thank you for your assistance with these matters.

JR:jnr

c: S. Kirkland - Files (J. Reinhardt)

RAIL DIVISION

30 JAN 12 AM 7:41

RECEIVED
PUBLISHED
COMMUNICATIONS
SECTION



Diagnostic Review Team Survey

Date: 12/14/2009

Location Data

Street or Road Name: New State Road (CR150)

Route/Road Number (i.e. Twp., Co., SR or US) Co (include SLM if State or US route) AAR-DOT No.: 001983 K

County: Huron Township: _____ City: (In or Near) Ripley

Railroad Name: WLE Railroad Division: Carey Branch/Line Name: _____

Nearest RR Timetable Station: Plymouth RR Milepost: 96.73

On-Site Review Team

(Include: Name - Organization - Phone Number)

1. Joseph P. Pugh ORDC 614-644-0291
2. George Martin PUCO 614-752-9107
3. Scott R. R. H.C. EMA 419-663-5772
4. Dan Reinert WLE 330-767-7202
5. Joe Kevach Huron Cty Eng 419-668-1997
6. Gary Giller " " " " " "
7. _____
8. _____
9. _____

Existing Traffic Control Devices

Type of Warning Devices	Installed?		Quantity/Comments
Advance Warning Signs	<input checked="" type="checkbox"/> Yes	<input type="checkbox"/> No	<u>Two</u>
'Stop' Signs	<input type="checkbox"/> Yes	<input checked="" type="checkbox"/> No	
'Stop Ahead' Signs	<input type="checkbox"/> Yes	<input checked="" type="checkbox"/> No	
Pavement Markings	<input type="checkbox"/> Yes	<input checked="" type="checkbox"/> No	
Crossbucks	<input checked="" type="checkbox"/> Yes	<input type="checkbox"/> No	<u>TWO & TWO ADVANCE WARNING SIGNS</u>
Number of Tracks Signs	<input checked="" type="checkbox"/> Yes	<input type="checkbox"/> No	
Inventory Tags	<input checked="" type="checkbox"/> Yes	<input type="checkbox"/> No	<u>ONE</u>
Interconnected Highway Traffic Signal	<input type="checkbox"/> Yes	<input checked="" type="checkbox"/> No	
Mast-Mounted Flashing Lights	<input type="checkbox"/> Yes	<input checked="" type="checkbox"/> No	
Cantilever Flashing Lights	<input type="checkbox"/> Yes	<input checked="" type="checkbox"/> No	Number: _____ Length: _____
Side Lights	<input type="checkbox"/> Yes	<input checked="" type="checkbox"/> No	
Automatic Gates	<input type="checkbox"/> Yes	<input checked="" type="checkbox"/> No	Number: _____ Length: _____
Bells	<input type="checkbox"/> Yes	<input checked="" type="checkbox"/> No	
Sidewalk Gate Arms	<input type="checkbox"/> Yes	<input checked="" type="checkbox"/> No	
'No Turn' Signs	<input type="checkbox"/> Yes	<input type="checkbox"/> No	
Illumination	<input checked="" type="checkbox"/> Yes	<input type="checkbox"/> No	<u>ONE</u>
Is crossing flagged by train crew?	<input type="checkbox"/> Yes	<input checked="" type="checkbox"/> No	
Other <u>Rumble Strip</u>	<input checked="" type="checkbox"/> Yes	<input type="checkbox"/> No	<u>BOTH</u>

Safety Data (Obtain crash reports, if possible, prior to review)

	Initial Information (from database)	Revised
Number & dates of crashes in previous 5 years	7-14-09	
Hazard Ranking	22	Date Run: 9/26/09
Railroad Data		
Railroad Characteristics	Initial Information (from database)	Revised
Total trains per day	4	
< 1 per day		
Day thru trains	2	
Night thru trains		
Daytime switching movements	0	
Nighttime switching movements	0	
Total number of tracks	ONE	
Number of main tracks	ONE	
Number of other tracks	NONE	
Maximum train speed	40	
Typical train speed		
Amtrak	NONE	
If non-gated crossing, is clearing sight distance adequate in all quadrants? (See Table 1) <input type="checkbox"/> Yes <input checked="" type="checkbox"/> No		
If multiple tracks, can two trains occupy crossing at the same time? <input type="checkbox"/> Yes <input checked="" type="checkbox"/> No		
Can one train block the motorists' view of another train at crossing? <input type="checkbox"/> Yes (Explain below) <input checked="" type="checkbox"/> No		
Are there other track(s) crossing this same roadway within 100 ft of this crossing? <input type="checkbox"/> Yes <input checked="" type="checkbox"/> No		
If yes, Crossing DOT #(if different) _____		
If yes, distance _____ (take measurement between track centerlines at closest point along roadway)		
Roadway Data		
Local Highway Authority: <u>HURON COUNTY</u>		
Roadway Characteristics	Initial Information (from database)	Revised
Average daily traffic	651	
Highway paved	<input checked="" type="checkbox"/> Yes <input type="checkbox"/> No	<input type="checkbox"/> Yes <input type="checkbox"/> No
Roadway Surface: <input checked="" type="checkbox"/> Blacktop <input type="checkbox"/> Gravel <input type="checkbox"/> Concrete <input type="checkbox"/> Other _____		
Roadway width: <u>21</u> ft.		
Number of highway lanes	TWO	
Urban or Rural	RURAL	
Vehicle Speed: _____ MPH	55	
School Bus Operation: <input type="checkbox"/> No <input checked="" type="checkbox"/> Yes _____ Amount		
Hazardous Materials Trucks: <input checked="" type="checkbox"/> No <input type="checkbox"/> Yes _____ Amount		
Shoulders: <input type="checkbox"/> No <input checked="" type="checkbox"/> Yes		
Is the shoulder surfaced? <input checked="" type="checkbox"/> No <input type="checkbox"/> Yes		
Is there existing guardrail along roadway in crossing vicinity? <input checked="" type="checkbox"/> No <input type="checkbox"/> Yes		
Is stopping site distance adequate? (See Table 2) <input checked="" type="checkbox"/> Yes <input type="checkbox"/> No If no, deficient approach(es) _____		
Quadrant <u>NW</u> Curb and Gutter:	Quadrant <u>SE</u> Curb and Gutter:	
<input type="checkbox"/> Functional (Curb height = 4" or more)	<input type="checkbox"/> Functional (Curb height = 4" or more)	
<input type="checkbox"/> Non-functional (Curb height = Less than 4")	<input type="checkbox"/> Non-functional (Curb height = Less than 4")	
<input checked="" type="checkbox"/> None	<input checked="" type="checkbox"/> None	

Pedestrians: ☒ No ☐ Yes

Is sidewalk present? ☒ No ☐ Yes

Is there a nearby intersection that could cause queuing over the crossing? ☒ No ☐ Yes

If yes,
Distance _____

Is this intersection signalized? ☒ No ☐ Yes

Are the signals currently interconnected with the existing crossing warning devices? ☒ No ☐ Yes

Is it the consensus of the Diagnostic Review Team that this is a potential closure project? ☒ No ☐ Yes

Explain reasons:
To heavy traveled roadway to close.

Type of Development

- ☒ Open Space ☐ Institutional
- ☐ Industrial ☐ Commercial
- ☒ Residential

Location of nearby schools:

Plymouth School Elementary School

Utility Information

Is commercial power available? ☐ No ☒ Yes

Utility Provider (Company Name) *Firelands*

Phone Number _____

Nearest Available Power Source _____

What other utilities are present? _____

Is there potential utility conflict(s) ☐ Yes ☐ No ☐ Unknown

Diagnostic Team Recommendations

	Quadrants Needed
<input checked="" type="checkbox"/> Install/upgrade active devices	<i>NW - SE</i>
<input type="checkbox"/> Automatic Flashing Lights (AFLS)	
<input type="checkbox"/> AFLS / Cants	
<input type="checkbox"/> AFLS / Gates	
<input type="checkbox"/> AFLS / Gates / Cants	
<input type="checkbox"/> Upgrade circuitry	
<input type="checkbox"/> Sidelights	
<input type="checkbox"/> Guardrail Needed	
<input type="checkbox"/> Install/Replace curb	
<input type="checkbox"/> Other (define)	

Comments:

Possibly remove trees on private property.

- ☐ Install/upgrade traffic signal preemption
- ☐ No improvements needed
- ☐ Other (define)

Field Dimensions

Show North
Direction

Crossing Angle
 ☐ 0-29°
 ☐ 30-59°
 ☒ 60-90°
 Measured in SE Quadrant?

Measurements by: QK

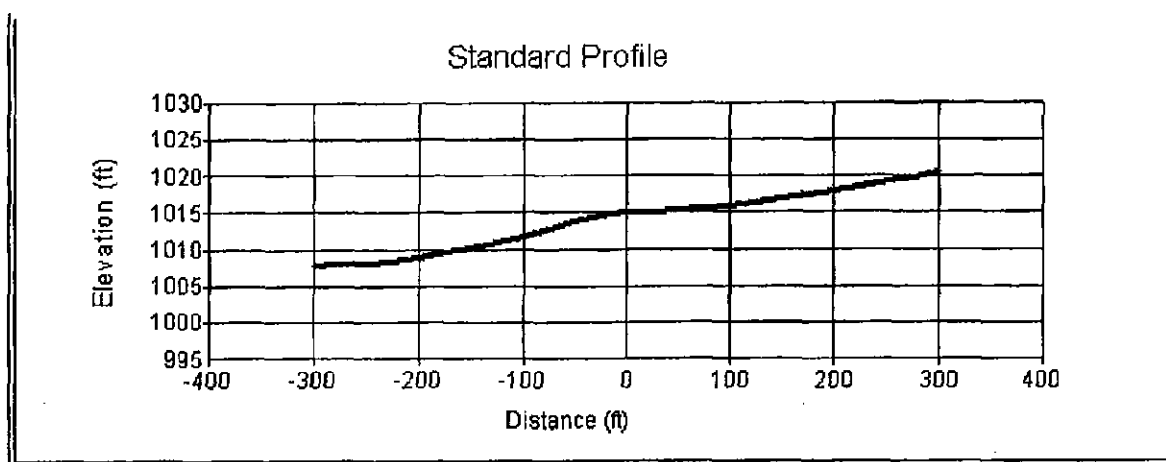

(Click on Profile to View Data)

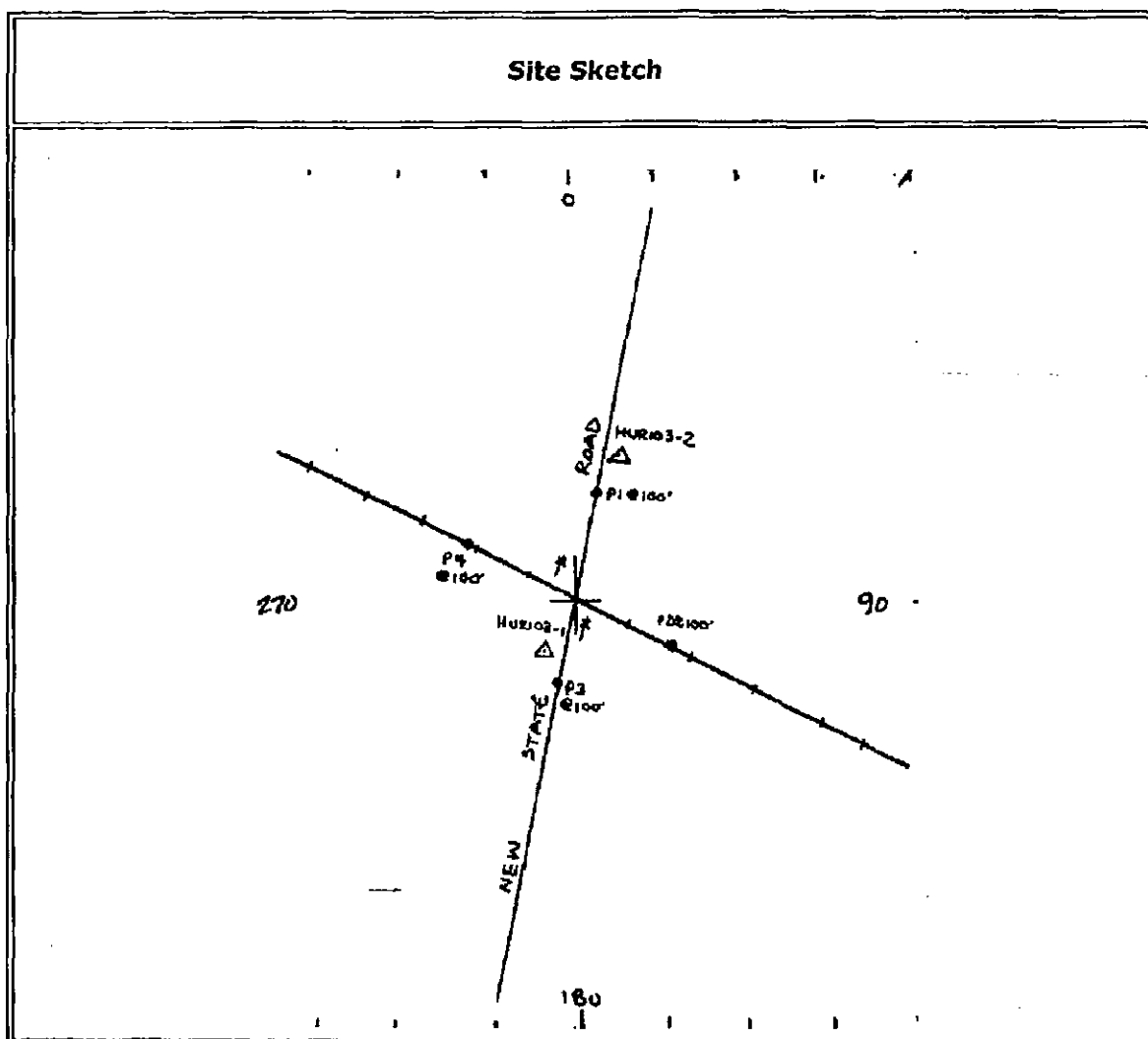

[Back to Top](#)

Field Sketch

Crossing Angle ☐ 0-29° ☐ 30-59° ☐ 60-90° Measured in _____ Quadrant?

Sketch by: _____

TABLE 1

Clearing Sight Distances

Maximum Authorized Train Speed	Distance (dT) Along Railroad from Crossing (ft)
1 - 10	240
15	360
20	480
25	600
30	720
35	840
40	960
45	1080
50	1200
55	1320
60	1440
65	1560
70	1680
75	1800
80	1920
85	2040
90	2160

Source: R-H Grade Crossing Handbook Table 36 (pp. 132-133)

Notes:

All calculated distances are rounded up to the next higher 5-foot increment.

Distances indicated are for 65-ft double bottom semi-tractor trailers and level single track 90 degree crossings; and may need to be adjusted for multiple tracks, skewed crossings or approaches on grades.

Clearing Sight Distance is to be measured in each vehicle travel direction at non-gated crossings as viewed from a point 25 feet from centerline of nearest track in the center of whichever travel lane is nearest the direction along track being measured.

Table 2

Stopping Sight Distances

Highway Vehicle Speed	Distance (dH) Along Roadway from Crossing (ft)
0	n/a
5	50
10	70
15	105
20	135
25	180
30	225
35	280
40	340
45	410
50	490
55	570
60	660
65	760
70	865

Source: R-H Grade Crossing Handbook Table 36 (pp. 132-133)

Notes:

All calculated distances are rounded up to the next higher 5-foot increment.

Distances indicated are for 65-ft double bottom semi-tractor trailers on dry level pavements.

Stopping Sight Distance is to be measured on each roadway approach to crossing from stop bar.

Martin, George

From: Dalton, Leah
Sent: Thursday, November 19, 2009 9:53 AM
To: Martin, George
Subject: FW: Diagnostic Review: Huron County, New State Road (CR150), AAR# 001938R (WLE)

From: Catherine.Stout@dot.state.oh.us [mailto:Catherine.Stout@dot.state.oh.us]
Sent: Thursday, November 19, 2009 9:53 AM
To: dreinsel@wlerwy.com; Dalton, Leah; jbkovachhce@accnorwalk.com; Joe.Reinhardt@dot.state.oh.us
Subject: Diagnostic Review: Huron County, New State Road (CR150), AAR# 001938R (WLE)

Everyone:

I am establishing a diagnostic review for the railroad grade crossing outlined below. This on-site meeting will determine the need for upgrading of warning devices. Should improvements be warranted, the Ohio Rail Development Commission (ORDC) will be the funding agency. Joe Reinhardt will be the Project Manager from the ORDC leading the diagnostic review, he can be reached at (614) 580-7728.

Huron County New State Road (CR 150) ~~AAR 001938R~~ 001-983K

The review will take place on **Monday, December 14 at 11:00 a.m.** at the grade crossing.

It is crucial that both the local highway authority and the railroad be present at this review. **Please respond to this e-mail and let me know who from your company will be attending the meeting.** If it is impossible for your company to be represented at the meeting, let me know and we will select another date and time.

The diagnostic team will need to evaluate current traffic and railroad data during the review process. Representatives from the railroad should come prepared to discuss current train volumes and speed and the local highway authority should come prepared to discuss the current average daily traffic count and school bus usage of the crossing.

Thank you.

Cathy Stout
Assistant Manager, Safety Programs
Ohio Rail Development Commission
1980 W. Broad Street, 2nd Floor
Columbus, OH 43223
614-644-0313

4 TRANS @ 40 mph
XB
ADT - 651 (2002)
2 SCHOOL BUSES
~~C. Stout~~
~~ADT~~
~~TR 44~~



Sorry! When printing directly from the browser your map may be incorrectly cropped. To print the entire map, try clicking the "Printer-Friendly" link at the top of your results page.

AOL | myAOL | Mail | Download the MapQuest Toolbar!

Search the Web

Search

Maps Directions Yellow Pages Gas Prices

★ **Latitude: 41.0109773**
Longitude: -82.6068444



Sorry! When printing directly from the browser your map may be incorrectly cropped. To print the entire map, try clicking the "Printer-Friendly" link at the top of your results page.

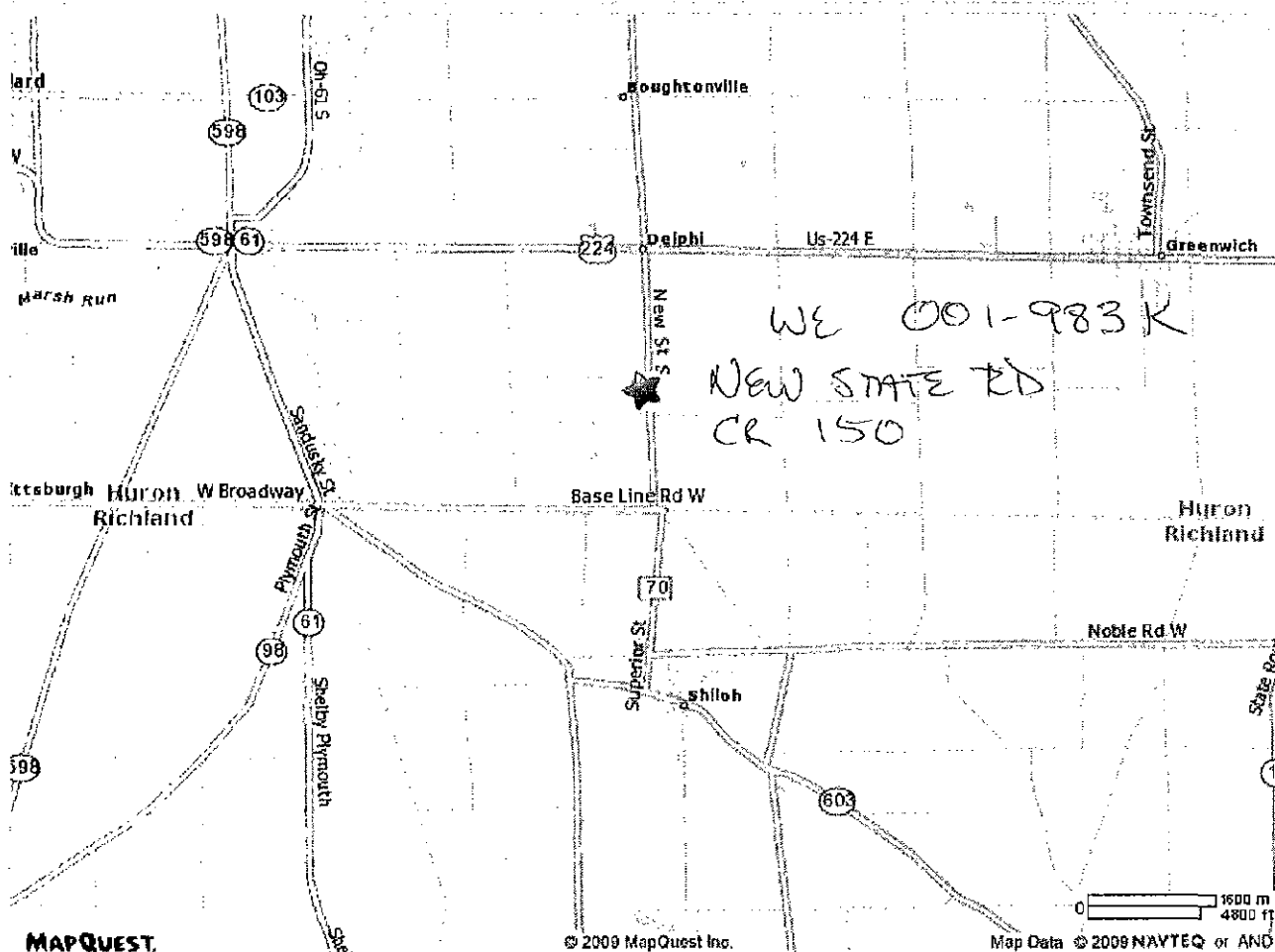

All rights reserved. Use Subject to License/Copyright

This map is informational only. No representation is made or warranty given as to its content. User assumes all risk of use. MapQuest and its suppliers assume no responsibility for any loss or delay resulting from such use.

103 TO 224