

TO
THE PUBLIC UTILITIES COMMISSION OF OHIO
CONSUMER SERVICES DEPARTMENT
ELECTRIC SECTION
COMPLIANCE DIVISION

PETITION FOR A REALLOCATION OF TERRITORY

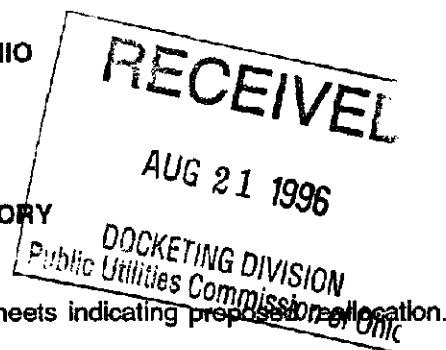

Submit four (4) copies of petition and associated boundary maps and/or overlap sheets indicating proposed reallocation.

Electric Supplier: COLUMBUS SOUTHERN POWER COMPANY

Address: 215 North Front Street, Columbus, OH 43215-2291

Location of Reallocation:

PUCO Map No.: L16 Kilbourne

Effective Dates: June 3, 1981 (CSP) and

County: Delaware

April 22, 1981 (DRE)

Township: Berlin

Reason for Reallocation: A proposed new subdivision straddles the existing boundary line. Due to the distance Delaware Rural Electric is from their portion of the subdivision, the cost to build a line, and the fact that Columbus Southern Power has facilities nearby which can serve the entire subdivision, it is best for Columbus Southern Power to serve Delaware Rural Electric's portion also.

Description of Reallocation: Relocate the boundary in First Quarter of Township 4 North, Range 18 West beginning at a point on the existing boundary line where it angles 4025 feet west of County Road Number 10 (North Old State Road); thence east along a property line a distance of 760 feet; thence south along a property line a distance of 925 feet to where it meets the existing boundary line, as shown on the attached map.

Are affected customers aware of and in agreement with the proposed reallocation? Yes

If no, explain:

Signature

OHIO RATES DIRECTOR

Title

COLUMBUS SOUTHERN POWER COMPANY

Supplier

Signature

GENERAL MANAGER

Title

DELAWARE RURAL ELECTRIC COOPERATIVE, INC.

Supplier

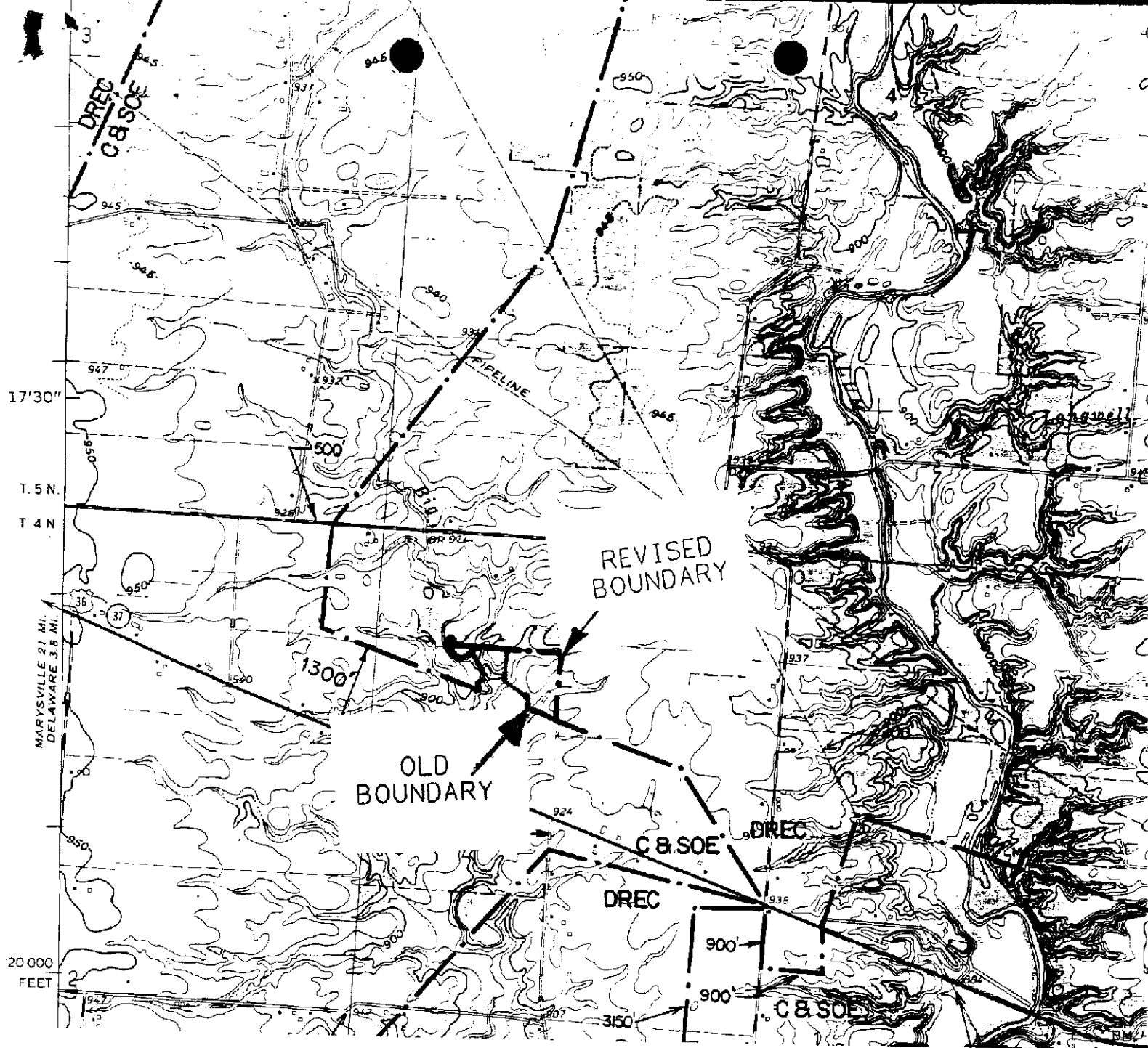

L16

**REVISED BOUNDARY
JUNE 10, 1996**