

FILE



RECEIVED-DOCKETING DIV

2008 SEP 26 PM 12:05

PUCO

September 25, 2008

Kimberly D. Bose  
Secretary  
Federal Energy Regulatory Commission  
888 First Street, N.E.  
Room 1A  
Washington, DC 20426

06-1142-GA-BFN

RE: Docket No. CP07-208-000  
Rockies Express Pipeline LLC, REX-East Project  
Spread F – Additional Revisions to Alignment Sheets

Ms. Bose:

On September 19, 2008, Rockies Express Pipeline LLC ("Rockies Express") submitted revised materials, including alignment sheets, to obtain authority to commence construction ("Notice to Proceed" or "NTP") on the Indiana portion of Spread F of the REX-East Project.<sup>1</sup> The September 19 filing reflected new areas on Spread F where Rockies Express had received necessary approvals to construct, and it eliminated other areas on the Spread that previously were shown as cleared, but still await approvals. To reflect these revisions, Rockies Express filed ten (10) new alignment sheets and several corrected tables.

Rockies Express hereby further clarifies its September 19 filing with the following data:

1. five (5) revised alignment sheets that are numbered 1280-D-105-138, -139, -140, -141, -146 and reflected as "REV 0" with a 9/24/08 revision date. These 5 alignment sheets have been revised to better identify re-routes across specific properties. (Attachment A);
2. a revised table 3.1.3-1, entitled "Additional Temporary Workspace, Mainline Valve, and Route Changes – Spread F Indiana Only" that is revised to show beginning and ending mileposts, tracts crossed, and improved detail in the "reroute reason" column. The table, appended as Attachment B, reflects the changes on the alignment sheets;

<sup>1</sup> The REX-East project was granted a certificate of public convenience and necessity pursuant to Section 7(c) of the Natural Gas Act by the Federal Energy Regulatory Commission on May 30, 2008 in this docket. Rockies Express Pipeline LLC, 123 FERC ¶ 61,234 (2008). On June 2, 2008, Rockies Express, pursuant to Section 157.20(a) of the Commission's Regulations, 18 C.F.R. § 157.20(a), notified the Commission that it accepted the Commission's Order.

This is to certify that the images appearing are an accurate and complete reproduction of a case file document delivered in the regular course of business. Technician Ann Date Processed 9/26/08

3. a revised table 2.1.4 "Exclusion Zones" for Spread F to include the two main line valves that were recently moved and will now require a new architectural survey since the main line valves are aboveground features. (Attachment C) Rockies Express is requesting approval to construct the mainline through the tracts. Rockies Express will not begin construction of the mainline valve, however, until the survey is complete and the information has been appropriately filed with the Indiana State Historic Preservation Office (SHPO) and the FERC.

With respect to the Yane property, Rockies Express has reviewed the location of the Yane residence and pond from the revised route. The construction work area will be approximately 605 feet east of the residence and pond. The construction work area and the relevant features on the property are depicted in the drawing appended as Attachment D. As previously stated, Rockies Express will implement its Upland Construction Plan and its Wetland and Waterbody Procedures to ensure protection for the Yane's pond from contamination and siltation resulting from construction.

Rockies Express is providing complete copies of this filing directly to the FERC Project Manager. If you have any questions, please do not hesitate to Ryan Childs at (307) 760-5635.

Respectfully submitted,

*/s/ Shippen Howe*

Shippen Howe  
Van Ness Feldman, P.C.  
1050 Thomas Jefferson Street, NW  
Washington, DC 20007

Attorney for  
Rockies Express Pipeline LLC

Attachments

cc: Laura Turner  
John Peconom  
Ellen Saint Onge  
All Parties

Rockies Express Pipeline LLC  
REX-East Project  
CP07-208

ATTACHMENT A

Rockies Express Pipeline –East Project Explanations of Alignment Sheet Page Change Outs - Spread F Rev. 9/24/08				
Alignment Sheet No. / D – 1280-105-	Rev. No.	Rev. Date	Milepost	Comment
-138	0	9/24/08	374.9	Label changed from Rev. 1 to Rev. 0 at ATWS deletion. ATWS did not have all necessary environmental approvals.
-138	0	9/24/08	375.9	Label changed from Rev. 1 to Rev. 0 at ATWS deletion. ATWS lacks sufficient justification for its size.
-138	0	9/24/08	376.3	A cloud was added around reroutes 2274, 2027, and 2340, in addition the old centerline was shown and beginning and ending MPs for the reroutes are labeled.
-139	0	9/24/08	377.1	The end points for reroutes 2027 and 2340 were labeled.
-140	0	9/24/08	380.8	Label changed from Rev. 1 to Rev. 0 at ATWS deletion. ATWS shown on the south side lacks sufficient justification for its size.
-140	0	9/24/08	381.3	Label changed from Rev. 1 to Rev. 0 at temporary access road deletion. Temporary access road shown did not have landowner approval.
-141	0	9/24/08	383.2	A cloud was added around reroute 2276 and beginning and ending MPs for the reroute are labeled.
-141	0	9/24/08	383.8	A cloud was added around reroute 2308 and beginning and ending MPs for the reroute are labeled.
-141	0	9/24/08	385.3	Label changed from Rev. 1 to Rev. 0 at temporary access road deletion. Temporary access road shown did not have landowner approval.
-146	0	9/24/08	398.4	Label changed from Rev. 1 to Rev. 0 at ATWS deletion. ATWS shown on the south side lacks sufficient justification for its size
-146	0	9/24/08	398.5	Label changed from Rev. 1 to Rev. 0 at ATWS deletion. ATWS shown on the south side lacks sufficient justification for its size
-146	0	9/24/08	398.6	Label changed from Rev. 1 to Rev. 0 at ATWS deletion. ATWS shown on the south side lacks sufficient justification for its size

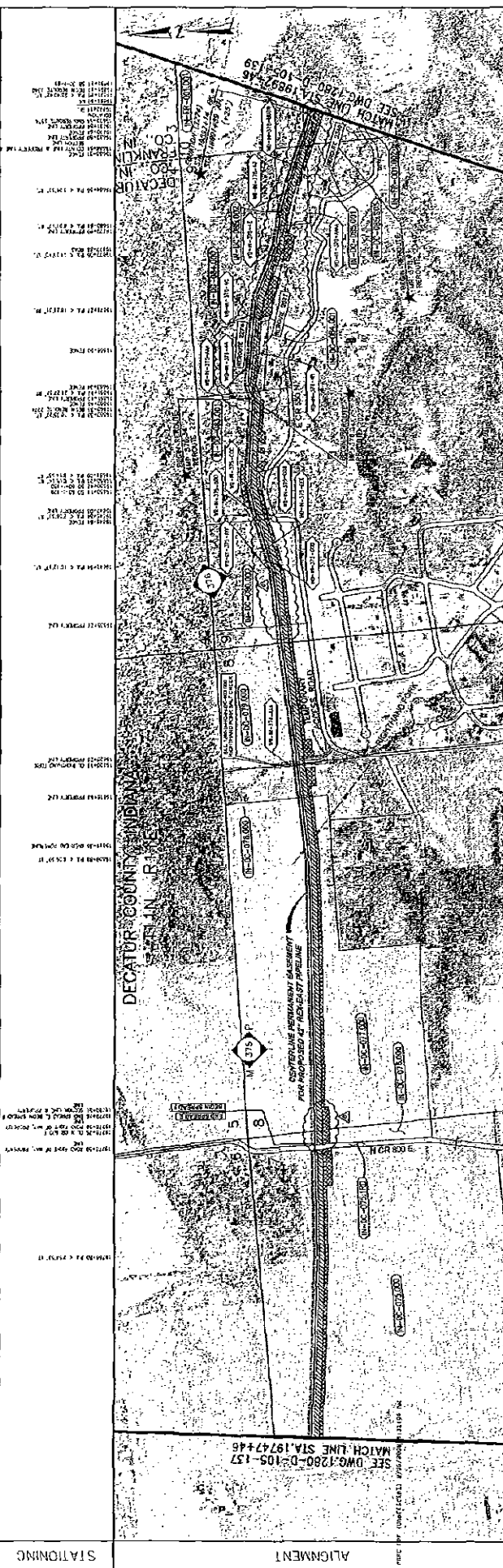
[illegible][illegible][illegible][illegible]

BUILINTERSTATE  
ENGINEERING

**SUMMARY**

Rockies Express Pipeline (REX) SYSTEM  
 REK-EAST  
 CONSTRUCTION ALIGNMENT SHEET  
 MP 379.50 TO MP 382.24

UTAH ZONE 10  
 DRAWN BY: JAC  
 DATE: 12/25/93

FRANKLIN COUNTY  
 INDIANA  
 SCALE: 1"=200'

**ISSUED FOR CONSTRUCTION - SPREAD F**

NO. IN EACH BEARING		DATE		NO. IN EACH BEARING		DATE	
1	1	1	1	1	1	1	1
2	2	2	2	2	2	2	2
3	3	3	3	3	3	3	3
4	4	4	4	4	4	4	4
5	5	5	5	5	5	5	5
6	6	6	6	6	6	6	6
7	7	7	7	7	7	7	7
8	8	8	8	8	8	8	8
9	9	9	9	9	9	9	9
10	10	10	10	10	10	10	10
11	11	11	11	11	11	11	11
12	12	12	12	12	12	12	12
13	13	13	13	13	13	13	13
14	14	14	14	14	14	14	14
15	15	15	15	15	15	15	15
16	16	16	16	16	16	16	16
17	17	17	17	17	17	17	17
18	18	18	18	18	18	18	18
19	19	19	19	19	19	19	19
20	20	20	20	20	20	20	20
21	21	21	21	21	21	21	21
22	22	22	22	22	22	22	22
23	23	23	23	23	23	23	23
24	24	24	24	24	24	24	24
25	25	25	25	25	25	25	25
26	26	26	26	26	26	26	26
27	27	27	27	27	27	27	27
28	28	28	28	28	28	28	28
29	29	29	29	29	29	29	29
30	30	30	30	30	30	30	30
31	31	31	31	31	31	31	31
32	32	32	32	32	32	32	32
33	33	33	33	33	33	33	33
34	34	34	34	34	34	34	34
35	35	35	35	35	35	35	35
36	36	36	36	36	36	36	36
37	37	37	37	37	37	37	37
38	38	38	38	38	38	38	38
39	39	39	39	39	39	39	39
40	40	40	40	40	40	40	40
41	41	41	41	41	41	41	41
42	42	42	42	42	42	42	42
43	43	43	43	43	43	43	43
44	44	44	44	44	44	44	44
45	45	45	45	45	45	45	45
46	46	46	46	46	46	46	46
47	47	47	47	47	47	47	47
48	48	48	48	48	48	48	48
49	49	49	49	49	49	49	49
50	50	50	50	50	50	50	50
51	51	51	51	51	51	51	51
52	52	52	52	52	52	52	52
53	53	53	53	53	53	53	53

1. MATERIAL DETAIL

2. IMPLEMENTATION

3. PLAN

4. ISSUE

5. 1/10/22

6. 1/10/22

7. 1/10/22

8. 1/10/22

9. 1/10/22

10. 1/10/22

11. 1/10/22

12. 1/10/22

13. 1/10/22

14. 1/10/22

15. 1/10/22

16. 1/10/22

17. 1/10/22

18. 1/10/22

19. 1/10/22

20. 1/10/22

21. 1/10/22

22. 1/10/22

23. 1/10/22

24. 1/10/22

25. 1/10/22

26. 1/10/22

27. 1/10/22

28. 1/10/22

29. 1/10/22

30. 1/10/22

31. 1/10/22

32. 1/10/22

33. 1/10/22

34. 1/10/22

35. 1/10/22

36. 1/10/22

37. 1/10/22

38. 1/10/22

39. 1/10/22

40. 1/10/22

41. 1/10/22

42. 1/10/22

43. 1/10/22

44. 1/10/22

45. 1/10/22

46. 1/10/22

47. 1/10/22

48. 1/10/22

49. 1/10/22

50. 1/10/22

51. 1/10/22

52. 1/10/22

53. 1/10/22

54. 1/10/22

55. 1/10/22

56. 1/10/22

57. 1/10/22

58. 1/10/22

59. 1/10/22

60. 1/10/22

61. 1/10/22

62. 1/10/22

63. 1/10/22

64. 1/10/22

65. 1/10/22

66. 1/10/22

67. 1/10/22

68. 1/10/22

69. 1/10/22

70. 1/10/22

71. 1/10/22

72. 1/10/22

73. 1/10/22

74. 1/10/22

75. 1/10/22

76. 1/10/22

77. 1/10/22

78. 1/10/22

79. 1/10/22

80. 1/10/22

81. 1/10/22

82. 1/10/22

83. 1/10/22

84. 1/10/22

85. 1/10/22

86. 1/10/22

87. 1/10/22

88. 1/10/22

89. 1/10/22

90. 1/10/22

91. 1/10/22

92. 1/10/22

93. 1/10/22

94. 1/10/22

95. 1/10/22

96. 1/10/22

97. 1/10/22

98. 1/10/22

99. 1/10/22

100. 1/10/22

101. 1/10/22

102. 1/10/22

103. 1/10/22

104. 1/10/22

105. 1/10/22

106. 1/10/22

107. 1/10/22

108. 1/10/22

109. 1/10/22

110. 1/10/22

111. 1/10/22

112. 1/10/22

113. 1/10/22

114. 1/10/22

115. 1/10/22

116. 1/10/22

117. 1/10/22

118. 1/10/22

119. 1/10/22

120. 1/10/22

121. 1/10/22

122. 1/10/22

123. 1/10/22

124. 1/10/22

125. 1/10/22

126. 1/10/22

127. 1/10/22

128. 1/10/22

129. 1/10/22

130. 1/10/22

131. 1/10/22

132. 1/10/22

133. 1/10/22

134. 1/10/22

135. 1/10/22

136. 1/10/22

137. 1/10/22

138. 1/10/22

139. 1/10/22

140. 1/10/22

141. 1/10/22

142. 1/10/22

143. 1/10/22

144. 1/10/22

145. 1/10/22

146. 1/10/22

147. 1/10/22

148. 1/10/22

149. 1/10/22

150. 1/10/22

151. 1/10/22

152. 1/10/22

153. 1/10/22

154. 1/10/22

155. 1/10/22

156. 1/10/22

157. 1/10/22

158. 1/10/22

159. 1/10/22

160. 1/10/22

161. 1/10/22

162. 1/10/22

163. 1/10/22

164. 1/10/22

165. 1/10/22

166. 1/10/22

167. 1/10/22

168. 1/10/22

169. 1/10/22

170. 1/10/22

171. 1/10/22

172. 1/10/22

173. 1/10/22

174. 1/10/22

175. 1/10/22

176. 1/10/22

177. 1/10/22

178. 1/10/22

179. 1/10/22

180. 1/10/22

181. 1/10/22

182. 1/10/22

183. 1/10/22

184. 1/10/22

185. 1/10/22

186. 1/10/22

187. 1/10/22

188. 1/10/22

189. 1/10/22

190. 1/10/22

191. 1/10/22

192. 1/10/22

193. 1/10/22

194. 1/10/22

195. 1/10/22

196. 1/10/22

197. 1/10/22

198. 1/10/22

199. 1/10/22

200. 1/10/22

201. 1/10/22

202. 1/10/22

203. 1/10/22

204. 1/10/22

205. 1/10/22

206. 1/10/22

207. 1/10/22

208. 1/10/22

209. 1/10/22

210. 1/10/22

211. 1/10/22

212. 1/10/22

213. 1/10/22

214. 1/10/22

215. 1/10/22

216. 1/10/22

217. 1/10/22

218. 1/10/22

219. 1/10/22

220. 1/10/22

221. 1/10/22

222. 1/10/22

223. 1/10/22

224. 1/10/22

225. 1/10/22

226. 1/10/22

227. 1/10/22

228. 1/10/22

229. 1/10/22

230. 1/10/22

231. 1/10/22

232. 1/10/22

233. 1/10/22

234. 1/10/22

235. 1/10/22

236. 1/10/22

237. 1/10/22

238. 1/10/22

239. 1/10/22

240. 1/10/22

241. 1/10/22

242. 1/10/22

243. 1/10/22

244. 1/10/22

245. 1/10/22

246. 1/10/22

247. 1/10/22

248. 1/10/22

249. 1/10/2

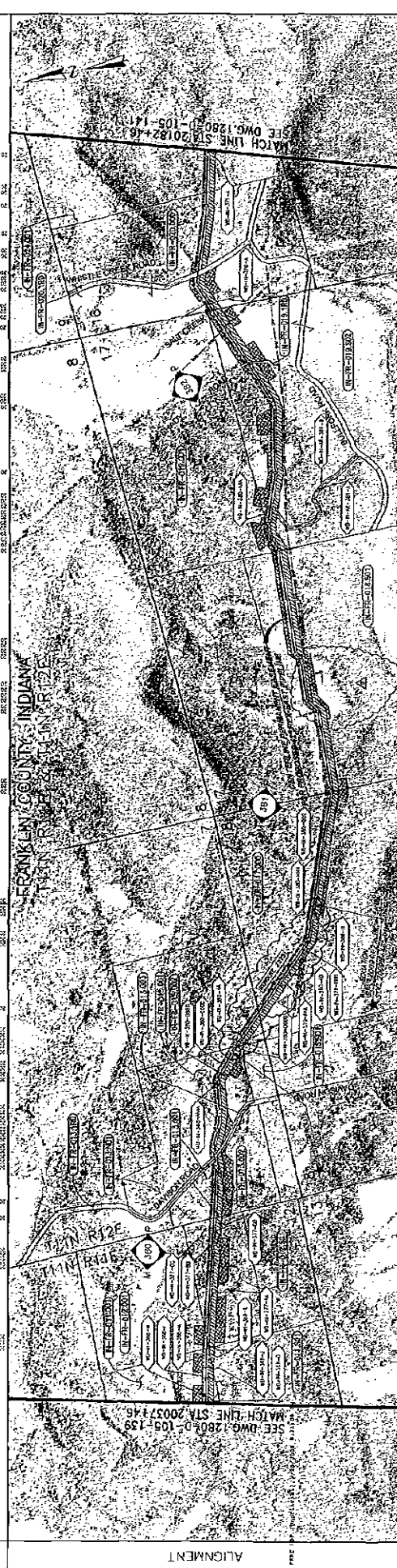
[illegible]

STATIONING

ENVIRONMENTAL CONSTRAINTS

[illegible][illegible]

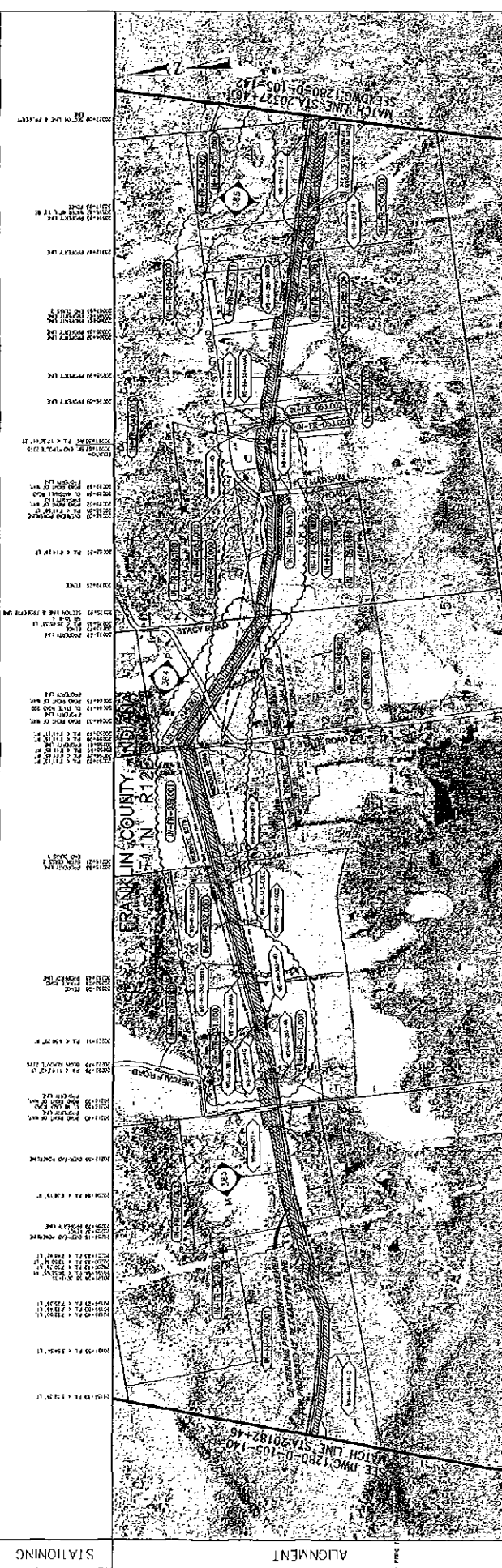

[illegible][illegible][illegible][illegible][illegible]





Rockies Express Pipeline LLC  
REX-East Project  
CP07-208

ATTACHMENT B

20080925-5009

TABLE 3.1.3-1 Rev. 9/24/08

**Rockies Express Pipeline - East Project  
Additional Temporary Workspace, Mainline Valve, and Route Changes - Spread F- Indiana Only**

Reroute Number	Begin MP	End MP	Tracts Crossed	County, State	Reroute Reason	New Landowner(s) Affected (Y/N)	Land Use and Cover	Wetland & Waterbody Surveys Completed	U.S. Fish & Wildlife Service Clearance Date	Cultural Survey Completed (If yes, list report)	State Historic Preservation Office Clearance	Landowner Easement attained?	Abutting Sensitive Resource
2274/ 2027	376.34	376.94 / 377.16	IN-DC-083.001 IN-DC-084.000 IN-FR-001.001 IN-FR-001.002	Decatur, IN	Reroute to improve the constructability by avoiding a steep ravine. Note that reroute 2274 and 2027 begin at the same milepost.	Yes	Forest area	Surveys complete - (mainline) WB-IN-376-4A WB-IN-376-4B WB-IN-376-4C WB-IN-376-4E WB-IN-376-AAAA WB-IN-376-4D WB-IN-376-8888	4/24/2008	REX-EAST-IN-25 LC 2274 Spread F Arch Survey Form 9/15/2008	6/4/2008 7/2/08	Yes	WB-IN-376-4A WB-IN-376-4B WB-IN-376-4C WB-IN-376-4E WB-IN-376-AAAA WB-IN-376-4D WB-IN-376-8888
2340	376.94	377.25	IN-FR-001.002 IN-FR-002.001	Decatur, IN	Reroute to avoid ravine	No	Forest area	Surveys complete - (mainline) WB-IN-377-AAAA and WB-IN-377-4A (workspace) WB-IN-378-CCCC Surveys complete - WB-IN-367-K on mainline	4/24/2008	REX-EAST-IN-25 REX-EAST-IN-35	6/4/2008 6/27/2008	Yes	WB-IN-377-AAAA WB-IN-377-4A WB-IN-378-CCCC
2023	378.98	379.14	IN-FR-005.001 IN-FR-010.001	Franklin, IN	Reroute to avoid ravine	Yes	Open and scattered forest	WB-IN-378-CCCC WB-IN-367-K on mainline	4/24/2008	REX-EAST-IN-03 REX-EAST-IN-25 REX-EAST-IN-35 REX-EAST-IN-40 REX-EAST-IN-21 REX-EAST-IN-25 REX-EAST-IN-40	5/14/2007 6/4/2008 6/27/2008 7/21/2008 2/12/2008 6/4/2008 7/21/2008	Yes	WB-IN-367-K
2275	380.43	380.58	IN-FR-015.001 IN-FR-015.001 IN-FR-015.002 IN-FR-017.000	Franklin, IN	Yane Route Variation	No	Open and forested	Surveys complete - (mainline) WB-IN-380-4A WB-IN-380-4B (workspace) WB-IN-379-AAA WB-IN-379-888	4/24/2008		2/12/2008 6/4/2008 7/21/2008	No	WB-IN-380-4A WB-IN-380-4B WB-IN-379-AAA WB-IN-379-888
N/A	380.75	380.86	IN-FR-017.000	Franklin, IN	Added ATMS - waterbody spoil storage and workspace for WB-IN-380-III crossing	No	Forest area	Surveys complete - no wetlands or waterbodies	4/24/2008	REX-EAST-IN-25	6/4/2008	Yes	

20080925-5009

TABLE 3.1.3-1 Rev. 9/24/08

Rockies Express Pipeline - East Project  
Additional Temporary Workspace, Mainline Valve, and Route Changes - Spread F- Indiana Only

Reroute Number	Begin MP	End MP	Trails Crossed	County, State	Reroute Reason	New Landowner(s) Affected (Y/N)	Land Use and Cover	Wetland & Waterbody Surveys Completed (mainline)	U.S. Fish & Wildlife Service Clearance Date	Cultural Survey Completed (if yes, list report)	State Historic Preservation Office Clearance	Landowner Easement attained?	Abutting Sensitive Resource
2276	383.21	384.20	IN-FR-031.000 IN-FR-031.001 IN-FR-032.000 IN-FR-039.001	Franklin, IN	Morgan Route Variation	No	Cultivated agricultural and scattered forest	Surveys complete - (mainline) WB-IN-383-4C WB-IN-383-4D WB-IN-383-AAAA WB-IN-383-B88B WB-IN-383-C0CC WB-IN-383-DDDD (workspace) WB-IN-383-4B WB-IN-383-EEEE	4/24/2008	REX-EAST-IN-21 REX-EAST-IN-35	2/12/2008 6/27/2008	No	WB-IN-383-4A WB-IN-383-FFF
2308	383.88	384.54	IN-FR-049.001 IN-FR-049.002 IN-FR-051.000 IN-FR-053.010 IN-FR-054.N10	Franklin, IN	Residence Route Variation	Yes	Cultivated agricultural	Surveys complete - no wetlands or waterbodies	4/24/2008	REX-EAST-IN-25 REX-EAST-IN-35	6/4/2008 6/27/2008	No	
N/A	384.28	384.43	IN-FR-051.000	Franklin, IN	Moved ATWS to reduce road impacts and provide spoil storage and workspace for crossing of Marshall Road	Yes	Cultivated agricultural	Surveys complete - no wetlands or waterbodies	4/24/2008	REX-EAST-IN-25	6/4/2008	Yes	
2342	386.17	386.51	IN-FR-061.000 IN-FR-061.N02 IN-FR-062.000	Franklin, IN	Route revised due to new survey data and to avoid a pond and ravine area.	No	Open and forested	Survey Complete - (mainline) WB-IN-386-4A WB-IN-386-4B WB-IN-386-4A WB-IN-386-4A	4/24/2008	REX-EAST-IN-25 REX-EAST-IN-35	6/4/2008 6/27/2008	Yes	
2035	386.90	387.59	IN-FR-065.000 IN-FR-066.000 IN-FR-067.000	Franklin, IN	Reroute to reduce tree impacts	Yes	Open and forested	Surveys complete - (mainline) WB-IN-387-4A WB-IN-387-4B WB-IN-386-AAAA WB-IN-387-4E WB-IN-386-CCC WB-IN-386-DDD	4/24/2008	No	No	Yes	WB-IN-387-4A WB-IN-387-4B WB-IN-387-4E WB-IN-386-CCC WB-IN-386-DDD
2266	387.71	388.01	IN-FR-068.000 IN-FR-070.000	Franklin, IN	Realignment to avoid deep ravine and side hill construction	No	Forest area	Surveys complete (mainline) WB-IN-387-AAA	4/24/2008	REX-EAST-IN-25 LC 2266 Spread F Arch Survey Form	6/4/2008 7/2/08*	Yes	

8/20/2008

20080925-5009

TABLE 3.1.3-1 Rev. 9/24/08

Rockies Express Pipeline - East Project  
Additional Temporary Workspace, Mainline Valve, and Route Changes - Spread F, Indiana Only

Reroute Number	Begin MP	End MP	Tracts Crossed	County, State	Reroute Reason	New Landowner(s) Affected (Y/N)	Land Use and Cover	Wetland & Waterbody Surveys Completed	U.S. Fish & Wildlife Service Clearance Date	Cultural Survey Completed (If yes, list report)	State Historic Preservation Office Clearance	Landowner Easement attained?	Abutting Sensitive Resource
N/A	388.85	388.85	IN-FR-073.000	Franklin, IN	Moved MLV 20 from MP 386.6 to MP 388.9. Pipeline length adjustment required moving of MLV per DOT-dictated regulations	No	Cultivated agricultural	Surveys complete - no wetlands or waterbodies	4/24/2008	REX-EAST-IN-25	6/4/2008	Yes	
N/A	389.74	389.79	IN-FR-082.000	Franklin, IN	Added ATWS - spoil storage and workspace for construction in steep terrain	No	Forest area	Surveys complete - no wetlands or waterbodies	4/24/2008	REX-EAST-IN-25	6/4/2008	Yes	
2139	394.92	395.28	IN-FR-131.501 IN-FR-132.001	Franklin, IN	Reroute to reduce tree impacts	No	Open, scattered forest, and cultivated agricultural	Surveys complete - no wetlands or waterbodies	4/24/2008	REX-EAST-IN-25	6/4/2008	Yes	
2086	396.04	396.13	IN-FR-136.000 IN-FR-138.001 IN-FR-137.002	Franklin, IN	Reroute to avoid future development and straighten crossing of Sharps Hill Road. Previous route is not visible or alignment as line shift was less than 10 feet scale of mainline width is larger.	No	Cultivated agricultural	Surveys complete - WB-IN-396-CCCC on mainline	4/24/2008	REX-EAST-IN-03 REX-EAST-IN-25	5/14/2007 6/4/2008	Yes	
2021	397.21	397.76	IN-FR-144.501 IN-FR-145.000 IN-FR-147.000	Franklin, IN	Realign to improve crossing of Big Cedar Road and Big Cedar Creek (WB-IN-397-KKKK)	No	Open and forested	Surveys complete - (mainline) WB-IN-397-DDDD WB-IN-397-KKKK WL-IN-397-AAAA (workspace) WB-IN-397-BBBB WB-IN-397-III WB-IN-397-4HHH	4/24/2008	REX-EAST-IN-21 REX-EAST-IN-25	2/1/2008 6/4/2008	Yes	

\* Rockies Express completed survey of this tract and per the letter agreement can proceed with construction

Rockies Express Pipeline LLC  
REX-East Project  
CP07-208

ATTACHMENT C

TABLE 2.1-4 Rev. 9/24/08

**Rockies Express Pipeline-East Project  
Construction Exclusion Areas and Restricted Construction Travel Lane Areas – Spread F <sup>a</sup>**

State	County	Entry MP	Exit MP	Discrete Start Point	Discrete Stop Point	Reason for the Exclusion Zone	Month Available for Construction
Indiana	Franklin	386.0	387.5	Western boundary of tract IN-FR-061.000	Western boundary of tract IN-FR-068.000	Cultural resources surveys and/or SHPO concurrence pending for reroute 2035.	October
Indiana	Franklin	388.9	388.9	MLV20 located on west side of St. Marys Road on tract IN-FR-073.000		Cultural resources surveys and/or SHPO concurrence pending	October
Indiana	Franklin	392.2	394.3	Southern boundary of tract IN-FR-105.001	Private drive on tract IN-FR-129.001	Cultural resources surveys and/or SHPO concurrence pending.	September - November
Indiana	Franklin	395.7	395.9	Southern boundary of tract IN-FR-133.001 at Holland Road	Northwestern boundary of tract IN-FR-136.000	Cultural resources surveys and/or SHPO concurrence pending.	October
Ohio	Butler	404.8	404.8	MLV21 located on east side of State Line Road on tract OH-BU-001.001		Cultural resources surveys and/or SHPO concurrence pending	October
Ohio	Butler	409.3	409.7	Western boundary of tract OH-BU-046.000 at Chapel Road	Eastern boundary of tract OH-BU-046.000	Cultural resources surveys and/or SHPO concurrence pending for reroute 2331.	September
Ohio	Butler	425.9	426.2	Eastern boundary of tract OH-BU-158.000 at Trenton Road	Western boundary of tract OH-BU-159.000	Certificate Condition 37 reroute (Chase Property)	October
Ohio	Warren	441.9	443.6	Eastern edge of track OH-WA-017.000	Eastern edge of track OH-WA-020.000	Cultural resources surveys and/or SHPO concurrence pending.	October

<sup>a</sup> Rockies Express commits to installing exclusion fencing at the end of the start or stop tracks as a visual barrier to prevent construction from extending into exclusion areas.



Rockies Express Pipeline LLC  
REX-East Project  
CP07-208

ATTACHMENT D

**FRANKLIN COUNTY, INDIANA**  
**T11N R12E SECTION 18**

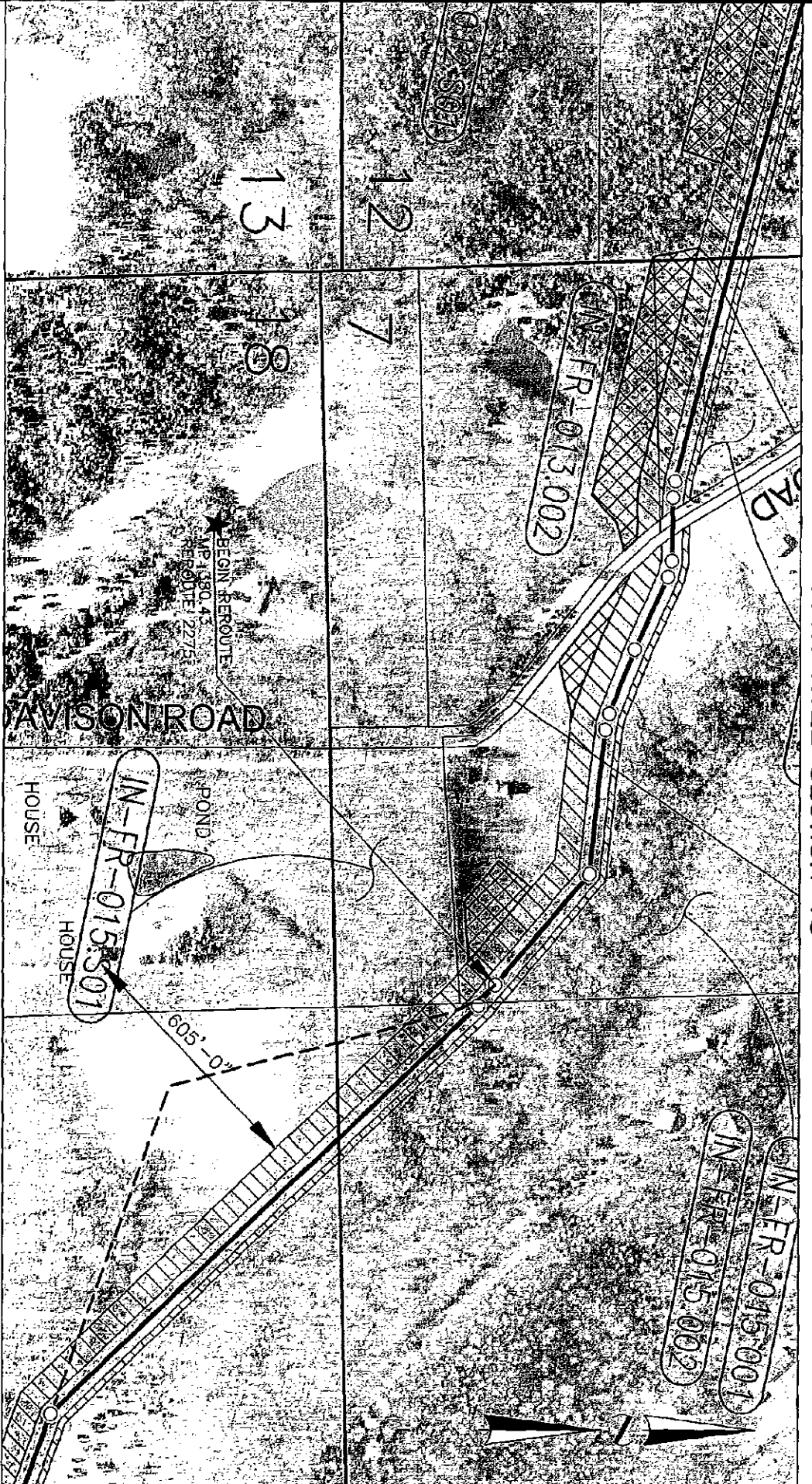

REF. ALIGNMENT SHEET NO. 1280-D-105-140

**LEGEND**

- EXTRA TEMPORARY EASEMENT
- TEMPORARY EASEMENT
- PERMANENT EASEMENT
- EXISTING PIPELINE
- CENTERLINE PERMANENT EASEMENT
- PROPOSED REX-EAST PIPELINE
- OLD CENTERLINE



DWG. BY:	G.I.E.	09/24/08	<b>Rockies Express Pipeline</b> ROCKIES EXPRESS PIPELINE REX-EAST REROUTE VARIANCE RR-2275 - M.P. 380.4 Franklin County, Indiana
CHK.	G.I.E.	09/24/08	
PROJ. ENGR.	G.I.E.		
PROJ. MGR.	G.I.E.		
CLIENT APP.	G.I.E.		
SCALE	1" = 300'		DWG. NO. 1280-A-IN-FR-015.S01
			SHEET NO. 1 of 1
			REV. 0

Document Content(s)

Letter.PDF.....	1-2
Compiled Attachment A.PDF.....	3-9
Attach B TABLE 3 1 3-1 RR_rev 092408 Indiana only.PDF.....	10-13
Attach C TABLE 2.1-4 exclusions_CLEAN_09.24.08.PDF.....	14-15
Attach D 1280-Yane.PDF.....	16-17