

FILE



RECEIVED-DOCKETING DIV

2008 SEP 24 AM 11:46
LLC

PUCO

06-1142-GA-BTN

September 19, 2008

Kimberly D. Bose
Secretary
Federal Energy Regulatory Commission
888 First Street, N.E.
Room 1A
Washington, DC 20426

RE: Docket No. CP07-208-000
Rockies Express Pipeline LLC, REX-East Project
Supplemental Information and Request for NTP for Indiana Portion of
Spread F

Ms. Bose:

On August 1, 2008, Rockies Express Pipeline LLC ("Rockies Express") filed for Notice to Proceed ("NTP") for Spread F of the REX-East Project.¹ As set forth below, Rockies Express hereby revises its August 1 filing to reflect new areas on Spread F where Rockies Express has received necessary approvals to construct and to eliminate other areas on the Spread that previously were shown as cleared, but still await approvals. To reflect these revisions, Rockies Express is filing ten (10) new alignment sheets. Additionally, Rockies Express, as explained below, is correcting several tables that were submitted on August 1 to reflect the revisions.

As the Commission is aware, pipeline construction for Spread F will cross from Indiana into Ohio, with approximately 30 miles of construction to take place in Indiana and 40 miles in Ohio. Rockies Express is concerned that pending matters in Ohio may prevent the Commission Staff from issuing a NTP for the entirety of the spread. Accordingly, at this time, in order to enhance timely completion of the project, Rockies Express respectfully requests an NTP for only the Indiana portion of Spread F, from mileposts (MP) 374.8 (the start of Spread F in Indiana) to MP 404.7 (at the Indiana/Ohio border).

¹ The REX-East project was granted a certificate of public convenience and necessity pursuant to Section 7(c) of the Natural Gas Act by the Federal Energy Regulatory Commission on May 30, 2008 in this docket. Rockies Express Pipeline LLC, 123 FERC ¶ 61,234 (2008). On June 2, 2008, Rockies Express, pursuant to Section 157.20(a) of the Commission's Regulations, 18 C.F.R. § 157.20(a), notified the Commission that it accepted the Commission's Order.

Rockies Express believes a clear stop point exists at the Indiana/Ohio border at State Line Road, located approximately at MP 404.7 of the Project. The road is located along the boundary of the two states and would be a clear point of demarcation. Thus, there is hardly any likelihood that construction would mistakenly proceed east from that point.

The Indiana section of Spread F, for which Rockies Express seeks authority here, is shown on the August 1 alignment sheets that are numbered 1280-D-105-138 through 149 and are labeled "Rev 0." In this filing, Rockies Express is filing five (5) revised alignment sheets for the Indiana portion of Spread F: Sheet Nos. 138, 140, 141, 142 and 146. These alignment sheets also are marked as "Rev 0," but have a September 16, 2008 revision date on them. Rockies Express requests that these five alignment sheets be substituted for the alignment sheets filed on August 1.

Finally, for purposes of efficiency and expedition, Rockies Express is including with this filing revised alignment sheets for Spread F in Ohio. For the Ohio portion of Spread F, Rockies Express is submitting five (5) revised alignment sheets: Sheet Nos. 152, 153, 158, 159 and 162. These sheets also are marked as "Rev 0," with a September 16, 2008 revision date. All the August 1 alignment sheets for Ohio were marked as "Rev 0" except for Sheet No. 156 which was marked as "Rev. 1." Regarding Sheet No. 156, Rockies Express continues to work with the landowners in the area of Certificate Condition No. 37 (MPs 426.1 to 426.3) and will file a revised alignment sheet and updated information as necessary for this area when it requests notice to proceed for Spread F in Ohio.

Below, and in the attachments that are appended to this letter, Rockies Express provides the supporting data for an NTP of Spread F of the REX-East Project. As noted previously, Rockies Express only is requesting authorization to commence construction on the Indiana portion of Spread F.

Certificate Condition No. 5

For Certificate Condition No. 5, Rockies Express has revised table 3.1.3-1, "Route Realignment," for Spread F. Rockies Express has revised the cultural resources survey status and agency clearances as appropriate for each pipeline route change or additional temporary workspace additions. The revised table is included as Attachment A of this filing. Supporting documentation for the areas where surveys have been completed is included as Attachment B of this filing. Attachment B includes cultural information and is therefore marked privileged and confidential.

Certificate Condition No. 114

Rockies Express is providing a revised table 3.38-1 and residential site specific crossing plan in Attachment C to include a residence located at MP 431.1. This residence is within 25 feet of the construction work area and Rockies Express will reduce the additional temporary workspace and construction right-of-way to avoid the building (see

site-specific drawing OH-BU-176.N01). If feasible, the drag construction technique will be used.

Access Roads, Restricted Construction and Construction Skip, Alignment Sheet Revisions, and Cultural Resources Status Tables

Rockies Express is providing a revised table 2.1-3 (entitled “Existing Roads Requiring Modifications”) for Spread F to only show roads where landowner approval has been obtained. This table is appended hereto as Attachment D. Any additional roads requiring modifications where landowner approval has been obtained will be requested at a later date via the variance request process.

Since filing its Notice to Proceed request, Rockies Express has completed and filed supplemental biological and cultural resources survey reports and State Historic Preservation Office (SHPO) correspondence and concurrence with the various cultural resources survey reports. As a result of completed cultural resources surveys and/or SHPO clearances, including supplemental filings with the FERC, table 2.1-4 of the Notice to Proceed with construction request for Spread F can be revised such that several previous exclusion areas no longer apply. The revised version of table 2.1-4 and SHPO clearance letters are included as Attachment E of this filing. Supporting SHPO correspondence and documentation is included as Attachment F.

To assist the Staff, Rockies Express is providing a table listing the revised alignment sheets that are filed herein for Spread F along with an explanation of the changes that were made to the alignment sheets. This table is included with the alignment sheets in Attachment G.

Tables 4.1.1-4 and 4.1.1-5 from Rockies Express’ August 1 NTP request for Spread F also have been updated to support revised table 2.1-4 and are included as Attachments H and I, respectively. Also attached is table 4.1.2-2 (Attachment J) regarding cultural resources survey status at the Whitewater River horizontal directional drill, which has been updated to reflect new and revised survey data.

To summarize, enclosed are the following tables and documentation to support the requested revisions and clarifications:

- Attachment A – revised table 3.1.3-1 for Spread F showing cultural resources updates for route changes and additional temporary workspace areas;
- Attachment B – supporting survey completion documentation (Privileged);
- Attachment C – revised table 3.38-1 (Residences with 25 feet of the Right-of-Way) and site specific drawing OH-BU-176.N01
- Attachment D – revised table 2.1-3 (Existing Roads Requiring Modifications – Spread F);

- Attachment E - revised table 2.1-4 (Restricted Construction and Construction Exclusion Areas) and SHPO clearance letters for Spread F;
- Attachment F – supporting SHPO correspondence and documentation;
- Attachment G – revised alignment sheets with summary table.
- Attachment H – revised table 4.1.1-4 (Status of Cultural Resources Surveys and Compliance Along Spread F);
- Attachment I – revised table 4.1.1-5 (Status of Remaining Pipeline and Workspace Areas Along Spread F); and
- Attachment J – revised table 4.1.2-2 (Status of Cultural Resources Surveys and Compliance at Whitewater River Horizontal Directional Drill).

Rockies Express believes that, with these changes, the data necessary for a NTP for the Indiana portion of Spread F (with noted exclusion areas) is complete. Rockies Express, therefore, respectfully requests authorization to start construction of the Indiana portion of Spread F (MPs 374.8 to 404.7) as shown on the alignment sheets, enumerated above, that are labeled “Rev 0.”

Rockies Express is providing complete copies of this filing directly to the FERC Project Manager. If you have any questions, please do not hesitate to contact me.

Respectfully submitted,

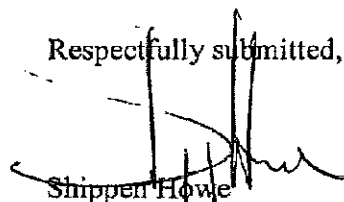

Shippin Howe
Van Ness Feldman, P.C.
1050 Thomas Jefferson Street, NW
Washington, DC 20007

Attorney for
Rockies Express Pipeline LLC

Attachments

cc: Laura Turner, FERC
Ellen Saint Onge
John Peconom
All Parties

Rockies Express Pipeline LLC
REX-East Project
CP07-208

ATTACHMENT A

Public

Rockies Express Pipeline LLC
REX-East Project
CP07-208

ATTACHMENT B

***Contains Privileged Information
Do Not Release***

Rockies Express Pipeline LLC
REX-East Project
CP07-208

ATTACHMENT C

Public

Rockies Express Pipeline LLC
REX-East Project
CP07-208

ATTACHMENT D

Public

Rockies Express Pipeline LLC
REX-East Project
CP07-208

ATTACHMENT E

Public

Rockies Express Pipeline LLC
REX-East Project
CP07-208

ATTACHMENT F

Public

Rockies Express Pipeline LLC
REX-East Project
CP07-208

ATTACHMENT G

Public

Rockies Express Pipeline LLC
REX-East Project
CP07-208

ATTACHMENT H

Public

Rockies Express Pipeline LLC
REX-East Project
CP07-208

ATTACHMENT I

Public

Rockies Express Pipeline LLC
REX-East Project
CP07-208

ATTACHMENT J

Public

TABLE 3.1.3-1 Rev. 9/18/08

Rockies Express Pipeline - East Project Additional Temporary Workspace, Mainline Valve, and Route Changes – Spread F											
Reroute Number	Begin MP	County, State	Reroute Reason	New Landowner(s) Affected (Y/N)	Land Use and Cover	Wetland & Waterbody Surveys Completed	U.S. Fish & Wildlife Service				
							Clearance Date	Cultural Survey Completed (If yes, list report)	State Historic Preservation Office Clearance	Landowner Easement attained?	Abutting Sensitive Resource
2180	376.0	Decatur, IN	Added ATWS - staging area	No	Cultivated agricultural and forest area	Surveys complete - no wetlands or waterbodies	4/24/2008	REX-EAST-IN-21 REX-EAST-IN-25	2/1/2008 6/4/2008	Yes	
2274	376.3	Decatur, IN	Reroute to improve the constructability by avoiding a steep ravine.	Yes	Forest area	Surveys complete - (mainline) WB-IN-376-4A WB-IN-376-4B WB-IN-376-4C WB-IN-376-4E WB-IN-376-AAAA WB-IN-376-4D WB-IN-376-BBBB	4/24/2008	REX-EAST-IN-25 LC 2274 Spread F Arch Survey Form 9/15/2008	6/4/2008 7/2/08*	Yes	WB-IN-376-4A WB-IN-376-4B WB-IN-376-4C WB-IN-376-4E WB-IN-376-AAAA WB-IN-376-4D WB-IN-376-BBBB
2027	376.9	Franklin, IN	Reroute to avoid ravine and cemetery	Yes	Forest area	Surveys complete - (mainline) WB-IN-376-4A WB-IN-376-4B WB-IN-376-4C WB-IN-376-4E WB-IN-376-AAAA WB-IN-376-4D WB-IN-376-BBBB	4/24/2008	REX-EAST-IN-25	6/4/2008	Yes	WB-IN-376-4A WB-IN-376-4B WB-IN-376-4C WB-IN-376-4E WB-IN-376-AAAA WB-IN-376-4D WB-IN-376-BBBB
2340	376.9	Decatur, IN	Reroute to avoid ravine	No	Forest area	Surveys complete - WB-IN-377-AAAA and WB-IN-377-4A on mainline and WB-IN-376-CCCC in workspace	4/24/2008	REX-EAST-IN-25 REX-EAST-IN-35	6/4/2008 6/27/2008	Yes	WB-IN-377-AAAA WB-IN-377-4A WB-IN-376-CCCC
2100	378.5	Franklin, IN	Moved ATWS to avoid cemetery and WB-IN-367-H	No	Forest area	Surveys complete - no wetlands or waterbodies	4/24/2008	REX-EAST-IN-25	6/4/2008	Yes	
2023	379.0	Franklin, IN	Reroute to avoid ravine	Yes	Open and scattered forest	Surveys complete - WB-IN-367-K on mainline	4/24/2008	REX-EAST-IN-03 REX-EAST-IN-25 REX-EAST-IN-35 REX-EAST-IN-40	5/14/2007 6/4/2008 6/27/2008 7/2/2008	Yes	WB-IN-367-K

TABLE 3.1.3-1 Rev. 9/18/08

Rockies Express Pipeline - East Project Additional Temporary Workspace, Mainline Valve, and Route Changes - Spread F										
Reroute Number	Begin MP	County, State	Reroute Reason	New Landowner(s) Affected (Y/N)	Land Use and Cover	Wetland & Waterbody Surveys Completed	U.S. Fish & Wildlife			
							Service Clearance Date	Cultural Survey Completed (if yes, list report)	State Historic Preservation Office Clearance	Landowner Easement attained?
2275	380.4	Franklin, IN	Yane Route Variation	No	Open and forested	Surveys complete - WB-IN-380-4A and WB-IN-380-4B on mainline and WB-IN-379-AAA and WB-IN-379-BBB in workspace	4/24/2008	REX-EAST-IN-21 REX-EAST-IN-25 REX-EAST-IN-40	2/1/2008 6/4/2008 7/2/2008	No
N/A	380.9	Franklin, IN	Added ATWS - waterbody spoil storage and workspace for WB- IN-380-III crossing Morgan Route Variation	No	Forest area	Surveys complete - no wetlands or waterbodies	4/24/2008	REX-EAST-IN-25	6/4/2008	Yes
2276	383.1	Franklin, IN	Morgan Route Variation	No	Cultivated agricultural and scattered forest	Surveys complete - (mainline) WB-IN-383-4C WB-IN-383-AAAA WB-IN-383-BBBB WB-IN-383-CCCC and WB-IN-383-DDDD (workspace) WB-IN-383-4B and WB-IN-383-EEEE	4/24/2008	REX-EAST-IN-21 REX-EAST-IN-35	2/1/2008 6/27/2008	No
2308	383.1	Franklin, IN	Residence Route Variation	Yes	Cultivated agricultural	Surveys complete - no wetlands or waterbodies	4/24/2008	REX-EAST-IN-25 REX-EAST-IN-35	6/4/2008 6/27/2008	No
2269	384.2	Franklin, IN	Moved ATWS to reduce road impacts and provide spoil storage and workspace for crossing of Marshall Road	Yes	Cultivated agricultural	Surveys complete - no wetlands or waterbodies	4/24/2008	REX-EAST-IN-25	6/4/2008	Yes

WB-IN-380-4A
WB-IN-380-4B
WB-IN-379-
AAA
WB-IN-379-
BBB

WB-IN-383-4C
WB-IN-383-
AAAA
WB-IN-383-
BBBB
WB-IN-383-
CCCC
WB-IN-383-
DDDD
WB-IN-383-4B
WB-IN-383-
EEEE

TABLE 3.1.3-1 Rev. 9/18/08

Rockies Express Pipeline - East Project Additional Temporary Workspace, Mainline Valve, and Route Changes - Spread F										
Reroute Number	Begin MP	County, State	Reroute Reason	New Landowner(s) Affected (Y/N)	Land Use and Cover	Wetland & Waterbody Surveys Completed	U.S. Fish & Wildlife Service		State Historic Preservation Office Clearance	Abutting Sensitive Resource
							Clearance Date	Cultural Survey Completed (If yes, list report)		
2342	386.2	Franklin, IN	New survey on previously skipped track	No	Open and forested	Survey Complete - (mainline) WB-IN-386-4A WB-IN-386-4B TEH-IN-386-4A WL-IN-386-4A	4/24/2008	REX-EAST-IN-25 REX-EAST-IN-35	6/4/2008 6/27/2008	Yes
2035	386.9	Franklin, IN	Reroute to reduce tree impacts	Yes	Open and forested	Surveys complete - (mainline) WB-IN-387-4A WB-IN-387-4B WB-IN-386-AAA WB-IN-387-4E WB-IN-386-CCC WB-IN-386-DDD	4/24/2008	No	No	WB-IN-387-4A WB-IN-387-4B WB-IN-386-AAA WB-IN-387-4E WB-IN-386-CCC WB-IN-386-DDD
2266	387.9	Franklin, IN	Realignment to avoid deep ravine and side hill construction	No	Forest area	Surveys complete (mainline) WB-IN-387-AAA	4/24/2008	REX-EAST-IN-25 LC 2266 Spread F Arch Survey Form 8/20/2008	6/4/2008 7/2/08*	Yes
N/A	388.9	Franklin, IN	Moved MLV 20 from MP 386.6 to MP 388.9. Pipeline length adjustment required moving of MLV per DOT-dictated regulations	No	Cultivated agricultural	Surveys complete - no wetlands or waterbodies	4/24/2008	REX-EAST-IN-25	6/4/2008	Yes
N/A	389.8	Franklin, IN	Added ATWS - spoil storage and workspace for construction in steep terrain	No	Forest area	Surveys complete - no wetlands or waterbodies	4/24/2008	REX-EAST-IN-25	6/4/2008	Yes
2139	395.0	Franklin, IN	Reroute to reduce tree impacts	No	Open, scattered forest, and cultivated agricultural	Surveys complete - no wetlands or waterbodies	4/24/2008	REX-EAST-IN-25	6/4/2008	Yes

TABLE 3.1.3-1 Rev. 9/18/08

Rockies Express Pipeline - East Project Additional Temporary Workspace, Mainline Valve, and Route Changes – Spread F												
Reroute Number	Begin MP	County, State	Reroute Reason	New Landowner(s) Affected (Y/N)	Land Use and Cover	Wetland & Waterbody Surveys Completed	U.S. Fish & Wildlife Service		Cultural Survey Completed (if yes, list report)	State Historic Preservation Office Clearance	Landowner Easement attained?	Abutting Sensitive Resource
							Clearance Date	Clearance				
2086	398.0	Franklin, IN	Reroute to avoid future development and straighten crossing of Harps Hill Road	No	Cultivated agricultural	Surveys complete - WB-IN-396-CCCC on mainline	4/24/2008		REX-EAST-IN-03 REX-EAST-IN-25	5/14/2007 6/4/2008	Yes	WB-IN-396-CCCC
2021	397.3	Franklin, IN	Realignment to improve crossing of Big Cedar Road and Big Cedar Creek (WB-IN-397-KKKK)	No	Open and forested	Surveys complete - WB-IN-397-DDDD WB-IN-397-KKKK WL-IN-397-AAAA on mainline and WB-IN-397-BBB WB-IN-397-III WB-IN-397-HHHH in workspace	4/24/2008		REX-EAST-IN-21 REX-EAST-IN-25	2/1/2008 6/4/2008	Yes	WB-IN-397-DDDD WB-IN-397-KKKK WL-IN-397-AAAA WB-IN-397-BBB WB-IN-397-III WB-IN-397-HHHH
N/A	404.8	Franklin, IN	Moved MLV 21 from MP 403.7 to MP 404.8. Pipeline length adjustment required moving of MLV per DOT-dictated regulations	No	Cultivated agriculture	Surveys complete - no wetlands or waterbodies	4/24/2008		REX-EAST-IN-03	5/10/2007	Yes	
2292	405.2	Butler, OH	Realignment to avoid landowner's hay field	No	Cultivated agriculture	Surveys complete - no wetlands or waterbodies	4/24/2008		LC 2292 Spread F Arch Survey Form 8/19/2008	7/23/08*	Yes	
2343	408.0	Butler, OH	Realignment to improve construction on rough terrain	No	Open and forested	Surveys complete - no wetlands or waterbodies	4/24/2008		LC 2343 Spread F Arch Survey Form 8/29/2008	7/23/08*	Yes	
ATWS-44	409.2	Butler, OH	Added ATWS - Spoil storage and workspace for CR 216 crossing	No	Cultivated agricultural	Surveys complete - no wetlands or waterbodies	4/24/2008		ATWS-044 Spread F Arch Survey Form 9/8/08	7/23/08*	Yes	
2331	409.3	Butler, OH	New survey on previously skipped track	No	Cultivated agricultural	Surveys complete - WB-OH-409-AAAA on mainline	4/24/2008		No	No	Yes	WB-OH-409-AAAA

TABLE 3.1.3-1 Rev. 9/18/08

Rockies Express Pipeline - East Project Additional Temporary Workspace, Mainline Valve, and Route Changes - Spread F										
Reroute Number	Begin MP	County, State	Reroute Reason	New Landowner(s) Affected (Y/N)	Land Use and Cover	Wetland & Waterbody Surveys Completed	U.S. Fish & Wildlife			Abutting Sensitive Resource
							Clearance Date	Cultural Survey Completed (If yes, list report)	State Historic Preservation Office Clearance	Landowner Easement attained?
2129	414.7	Butler, OH	Realignment to reduce impacts to riding trails and reduce forest impacts	No	Cultivated agricultural and scattered forest	Surveys complete - (mainline) WB-OH-414-5A WB-OH-414-4B WB-OH-414-4C WB-OH-402-J	4/24/2008	REX-EAST-OH-07 REX-EAST-OH-20 REX-EAST-OH-29	9/6/2007 5/30/2008 7/10/2008	Yes WB-OH-414-5A WB-OH-414-4B WB-OH-414-4C WB-OH-402-J
2243	416.5	Butler, OH	Added ATWS - spoil storage and workspace for CSX Railroad crossing	No	Cultivated agricultural	Surveys complete - no wetlands or waterbodies	4/24/2008	REX-EAST-OH-02 REX-EAST-OH-16 REX-EAST-OH-29	12/21/2007 4/29/2008 7/10/2008	Yes
2165	417.9	Butler, OH	Moved ATWS - spoil storage and workspace for Krucker Road crossing	No	Cultivated agricultural and forest area	Surveys complete - WB-OH-405-C in workspace	4/24/2008	REX-EAST-OH-07 REX-EAST-OH-16 REX-EAST-OH-29	9/6/2007 4/29/2008 7/10/2008	Yes
2281	417.8	Butler, OH	Storck-Stumb & Hasford Route Variation - FERC requirement	Yes	Cultivated agricultural and forest area	Surveys complete - WB-OH-418-4B on mainline	4/24/2008	REX-EAST-OH-20	5/30/2008	Yes WB-OH-418-4B
2175	417.9	Butler, OH	Reroute to collocate with utility corridor; Storck-Stump Route Variation	Yes	Cultivated agricultural and forest area	Surveys complete - WB-OH-418-4B on mainline	4/24/2008	REX-EAST-OH-20	5/30/2008	Yes WB-OH-418-4B
2301	423.8	Butler, OH	Realignment to avoid cultural resource	No	Cultivated agricultural	Surveys complete - no wetlands or waterbodies	4/24/2008	REX-EAST-OH-29	7/10/2008	No
2054	424.1	Butler, OH	Martin Marietta Reroute	No	Cultivated agricultural and forest area	Surveys complete - WB-OH-411-A on mainline	4/24/2008	REX-EAST-OH-02 REX-EAST-OH-07 REX-EAST-OH-16	12/21/2007 9/6/2007 4/29/2008	Yes WB-OH-411-A
2300	425.2	Butler, OH	Realignment to avoid Duke Energy Property	No	Cultivated agricultural and industrial	Surveys complete - no wetlands or waterbodies	4/24/2008	LC 2300 Spread F Arch Survey Form 7/30/2008	7/23/08*	Yes

TABLE 3.1.3-1 Rev. 9/18/08

Rockies Express Pipeline - East Project Additional Temporary Workspace, Mainline Valve, and Route Changes -- Spread F											
U.S. Fish & Wildlife											
Reroute Number	Begin MP	County, State	Reroute Reason	New Landowner(s) Affected (Y/N)	Land Use and Cover	Waterbody Surveys Completed	Wildlife Service Clearance Date	Cultural Survey Completed (if yes, list report)	State Historic Preservation Office Clearance	Landowner Easement attained?	Abutting Sensitive Resource
N/A	425.9	Butler, OH	Moved MLV 23 from MP 425.0 to MP 425.9. Pipeline length adjustment required moving of MLV per DOT-dictated regulations	No	Cultivated agricultural	Surveys complete - no wetlands or waterbodies	4/24/2008	REX-EAST-OH-16	4/29/2008 5/13/2008	Yes	
2282	426.1	Butler, OH	Chase Route Variation	No	Cultivated agricultural and forest area	Surveys complete - (mainline) WB-OH-425-AAA WB-OH-425-BBB WB-OH-414-A1 WB-OH-414-A2	4/24/2008	REX-EAST-OH-02 REX-EAST-OH-13 REX-EAST-OH-16 REX-EAST-OH-29	12/21/2007 3/14/2008 5/13/2008 7/10/2008	No	WB-OH-425-AAA WB-OH-425-BBB WB-OH-414-A1 WB-OH-414-A2
2311	428.5	Butler, OH	Reroute to avoid old landfill	No	Cultivated agricultural and forest area	Surveys Complete - (mainline) WB-OH-427-AA WB-OH-427-BB WL-OH-427-AA WB-OH-426-AA WL-OH-LC2311-A WL-OH-LC2311-B WL-OH-LC2311-C WB-OH-LC2311-A	N/A	REX-EAST-OH-02 REX-EAST-OH-16 LC 2311 Spread F Arch Survey Form 9/10/08	12/21/08 5/13/08 7/23/08	Yes	WB-OH-414-A2
2233	431.0	Butler, OH	Moved ATWS - HDD workspace, spoil storage, and wetland spoil storage and workspace	No	Open and forested	Surveys complete - WB-OH-418-B and WB-OH-418-A in workspace	4/24/2008	LC 2233 Spread F Arch Survey Form 8/29/2008	7/23/08 ^a	Yes	WB-OH-418-B WB-OH-418-A
2344	431.3	Butler, OH	Realignment to avoid Duke Energy	No	Open, uncultivated	Surveys complete - no wetlands or waterbodies	4/24/2008	LC 2344 Spread F Arch Survey Form 8/22/2008	7/23/08 ^a	Yes	
2305	432.0	Butler, OH	Realignment to avoid Duke Energy	No	Open, uncultivated	Surveys complete - no wetlands or waterbodies	4/24/2008	REX-EAST-OH-02	12/21/2007	Yes	

TABLE 3.1.3-1 Rev. 9/18/08

Rockies Express Pipeline - East Project
Additional Temporary Workspace, Mainline Valve, and Route Changes - Spread F

Reroute Number	Begin M/P	County, State	Reroute Reason	New Landowner(s) Affected (Y/N)	Land Use and Cover	Wetland & Waterbody Surveys Completed	U.S. Fish & Wildlife Service			State Historic Preservation Office Clearance	Landowner Easement attained?	Abutting Sensitive Resource
							Clearance Date	Cultural Survey Completed (if yes, list report)	Clearance			
2250	RR 2126 MP43 2.9+ 1.3	Butler, OH	Realignment to avoid Cincinnati Gas facility expansion	No	Open and scattered trees	Surveys complete - (mainline) WB-OH-434-4A WB-OH-434-4B WB-OH-435-CCC WB-OH-434-4C WB-OH-434-4D	4/24/2008	REX-EAST-OH-02 REX-EAST-OH-07 REX-EAST-OH-13 REX-EAST-OH-24	12/21/2007 9/6/2007 3/14/2008 6/24/2008	No	WB-OH-434-4A WB-OH-434-4B WB-OH-435-CCC WB-OH-434-4C WB-OH-434-4D WB-OH-436-5A	
2137	RR 2126 MP43 2.9+ 3.5	Warren, OH	Added ATWS - spoil and waterbody storage and workspace for Warren County Canal (WB-OH-436-5A) crossing	No	Cultivated agricultural and scattered forest	Surveys complete - WB-OH-436-5A in workspace	4/24/2008	REX-EAST-OH-16 REX-EAST-OH-29	4/29/2008 7/10/2008	No	WB-OH-436-5A	
N/A	433.5	Butler, OH	New MLV 23A. Pipeline length adjustment required moving of MLV per DOT-dictated regulations	No	Open and commercial/industrial	Surveys complete - no wetlands or waterbodies	4/24/2008	REX-EAST-OH-16	4/29/2008	Yes		
2332	441.6	Warren, OH	New survey on previously skipped track	No	Cultivated agricultural and forest area	Surveys complete - WB-OH-440-AAA WB-OH-440-BBB WB-OH-441-4A on mainline and WB-OH-440-AAA in workspace	4/24/2008	REX-EAST-OH-16 REX-EAST-OH-20 REX-EAST-OH-29	4/29/2008 5/30/2008 7/10/2008	No	WB-OH-440-AAA WB-OH-440-BBB WB-OH-441-4A WL-OH-440-AAA	

^a Rockies Express completed survey of this tract and per the letter agreement can proceed with construction

TABLE 3-38-1 Revised 09/19/08					
Rockies Express Pipeline - East Project Residences Within 25 Feet of Right-of-Way – Spread F					
State, County	Milepost	Distance From Centerline to Residence (feet)	Distance from Construction Work Area (feet)	Direction from Pipeline	Site-specific Drawing ID
INDIANA					
Franklin	384.5	134	14	N	IN-FR-054.N10
Franklin	401.8	90	25	S	IN-FR-170.000
Franklin	401.7	34	9	S	IN-FR-165.000
OHIO					
Butler	406.0	86	21	N	OH-BU-006.000
Butler	408.4	47	22	N	OH-BU-009.N02
Butler	408.2	90	25	N	OH-BU-022.000
Butler	411.7	78	9	S	OH-BU-059.000
Butler	418.8	74	25	N	OH-BU-110.000
Butler	419.9	77	25	N	OH-BU-120.N01
Butler	423.1	91	25	S	OH-BU-145.000
Butler	425.9	131	25	S	OH-BU-157.S01
Butler	431.1	40	15	N	OH-BU-176.N01
Butler	431.7	46	21	N	OH-BU-177.000
Butler	431.7	130	25	S	OH-BU-178.000
Butler	431.7	60	25	N	OH-BU-179.000

BUTLER COUNTY, OHIO

M.P. 431.1

OH-BU-176.N01



CL MEDIAN STATE ROAD 4
(HAMILTON MIDDLETON ROAD)

BUILDING

HOUSE

POOL

BUILDING

BARN

DUKE ENERGY PIPELINE

CENTERLINE PERMANENT EASEMENT
FOR PROPOSED 42" REX-EAST PIPELINE

NOTES:

1. CONSTRUCTION ACTIVITIES WILL BE PERFORMED SO AS TO ALLOW CONTINUOUS ACCESS TO PROPERTY DURING CONSTRUCTION.
2. SEE CONSTRUCTION IMPACT MITIGATION NOTES, ON RESIDENTIAL MITIGATION DRAWING INDEX & NOTES, 1280-A-SS-RES-INDEX 01 & 02.

CONSTRUCTION TECHNIQUES

[a] REDUCE WIDTH OF TEMPORARY WORKSPACE

LEGEND



ADDITIONAL TEMPORARY WORKSPACE



TEMPORARY WORKSPACE



PERMANENT EASEMENT



DUKE ENERGY PIPELINE



CENTERLINE PERMANENT EASEMENT
FOR PROPOSED 42" REX-EAST PIPELINE

REF. ALIGNMENT SHEET NO. 1280-D-105-158



GULF INTERSTATE
ENGINEERING
HOUSTON, TEXAS

DWN. BY: G.I.E. 7/17/07

CHK. S.H. 7/17/07

PROJ. ENGR.

PROJ. MGR.

CLIENT APP.

SCALE: 1" = 100'



Rockies Express Pipeline

ROCKIES EXPRESS PIPELINE SYSTEM
PROPOSED REX-EAST PIPELINE
RESIDENTIAL MITIGATION PLAN
M.P. 431.1

DWG. NO.
1280-A-SS-OH-BU-176-N01

SHT. NO.
1 Of 1

REV.
0

C:\PLOT\1280-a-ss-oh-bu-176-n01.dwg Plotted on: Sep 19, 2008 - 9:38am by bens

TABLE 2.1-3 Rev. 9/18/08

TABLE 2.1-3 Rev. 9/18/08								
Rockies Express Pipeline-East Project								
New and Existing Roads Requiring Modifications – Spread F								
Milepost	Existing Road Type	Improvement Required (Y/N)	Type Of Improvement (Maximum Road Width Is 40 Feet)	Length (miles)	Wetlands and Waterbodies Affected	Eligible Cultural Resources Affected	T/E Species Affected	Tract and Landowner Agreement Attained
375.6	Field Road	Yes	Grade road / Gravel low spots if necessary	0.1	None	None	None	IN-DC-079.S01TAR -Yes
381.7	Temp. Road	Yes	Grade Road / Gravel low spots if necessary / Possible tree trimming	0.3	WB-IN-AR-381-A WB-IN-AR-381-B	None	None	IN-FR-019.S02 – Yes
385.7	Field Road	Yes	Widen and grade road / Gravel low spots if necessary / Possible tree trimming	0.6	None	None	None	IN-FR-058.N02 – Yes
388.4	Field Road	Yes	Widen and grade road / Gravel low spots if necessary / Possible tree trimming	0.6	WB-OH-387-FFF	None	None	IN-FR-072.000 -Yes
407.6	Field Road	Yes	Widen and grade road / Gravel low spots if necessary / Possible tree trimming / Mat to cross TETCO	0.2	None	None	None	OH-BU-019.000 - Yes OH-BU-018.000 – Yes
407.6	Field Road	Yes	Widen and grade road / Gravel low spots if necessary / Possible tree trimming / Mat to cross TETCO	0.2	None	None	None	OH-BU-019.000 - Yes OH-BU-018.000 – Yes
408.5	Dirt Road	Yes	Grade road / Gravel low spots if necessary	0.5	None	None	None	OH-BU-031.000 – Yes
416.5	New	New	Grade road / Gravel low spots if necessary / Possible tree trimming	0.8	None	None	None	OH-BU-094.000 – Yes
421.9	Field Road	Yes	Grade road / Gravel low spots if necessary	0.5	WB-OH-409-B	None	None	OH-BU-136.000 – Yes
422.4	Dirt Road	Yes	Widen and grade road / Gravel low spots if necessary / Possible tree trimming	0.5	WB-OH-409-A	None	None	OH-BU-139.000 – Yes
422.6	Dirt Road	Yes	Widen and grade road / Gravel low spots if necessary	0.1	None	None	None	OH-BU-144.000 – Yes
430.0	Field Road	Extend	Grade road and extend 600 feet / Gravel low spots if necessary / Possible tree trimming	0.2	None	None	None	OH-BU-170.000 – Yes
430.8	Field Road	Yes	Widen and grade road / Gravel low spots if necessary / Possible tree trimming	0.5	None	None	None	OH-BU-174.002 – Yes
437.3	Field Road	Yes	Grade road / Gravel low spots if necessary	0.3	None	None	None	OH-WA-004.000 - Yes
440.1	Private Road	Yes	Grade road / Gravel low spots if necessary / Possible tree trimming / Mat to cross TETCO	0.2	WB-OH-440-A2 WB-OH-440-A3	None	None	OH-BU-010.000 - Yes



Indiana Department of Natural Resources

Mitchell E. Daniels, Jr., Governor
Robert E. Carter, Jr., Director

Division of Historic Preservation & Archaeology • 402 W. Washington Street, W274 • Indianapolis, IN 46204-2739
Phone 317-232-1646 • Fax 317-232-0693 • dhpa@dnr.IN.gov



August 19, 2008

Kari Krause
Natural Resource Group, Inc.
80 South Eighth Street
Minneapolis, MN 55402

Federal Agency: Federal Energy Regulatory Commission

Re: Phase II archaeological investigations for spread 5 and 6 pertaining to the Rockies Express Pipeline LLC's installation of a 622 mile long natural gas pipeline through Illinois, Indiana, and Ohio (FERC Docket #PF06-30-000; DHPA#1562)

Dear Ms. Krause:

Pursuant to Section 106 of the National Historic Preservation Act (16 U.S.C. § 470f) and 36 C.F.R. Part 800, the staff of the Indiana State Historic Preservation Officer ("Indiana SHPO") has conducted an analysis of the materials received on July 21, 2008, for the above indicated project in Johnson and Franklin counties, Indiana.

In terms of archaeological resources in the phase II report, we concur with the recommendations that sites 12Jo536, 12Jo559, and 12Fr466 do not appear eligible for inclusion in the National Register of Historic Places. Therefore, no further archaeological investigations are necessary for these sites.

If any archaeological artifacts or human remains are uncovered during construction, demolition, or earthmoving activities, state law (Indiana Code 14-21-1-27 and 29) requires that the discovery must be reported to the Department of Natural Resources within two (2) business days. In that event, please call (317) 232-1646. Be advised that adherence to Indiana Code 14-21-1-27 and 29 does not obviate the need to adhere to applicable federal statutes and regulations.

We appreciate the levels of effort for identifying and evaluating cultural resources for this project and look forward to continuing our review. *A copy of the revised 36 C.F.R. Part 800 that went into effect on August 5, 2004, may be found on the Internet at www.achp.gov for your reference.* If you have questions about archaeological issues please contact Cathy Draeger at (317) 234-3791. Additionally, in all future correspondence regarding the above indicated project, please refer to DHPA #1562.

Very truly yours,

A handwritten signature in black ink, appearing to read "James A. Glass", is written over a horizontal line.

James A. Glass, Ph.D.
Deputy State Historic Preservation Officer

JAG:CLD:cl

cc: Kimberly Bose, Federal Energy Regulatory Commission
emc: Ellen Saint Onge, Federal Energy Regulatory Commission
Thomas Chadderton, Louis Berger Group
Seth Mitchell, AK Environmental, LLC



Indiana Department of Natural Resources

Mitchell E. Daniels, Jr., Governor
Robert E. Carter, Jr., Director

Division of Historic Preservation & Archaeology • 402 W. Washington Street, W274 • Indianapolis, IN 46204-2739
Phone 317-232-1646 • Fax 317-232-0693 • dhpa@dnr.IN.gov



August 21, 2008

Kari Krause
Natural Resource Group, Inc.
80 South Eighth Street
Minneapolis, MN 55402

Federal Agency: Federal Energy Regulatory Commission

Re: Treatment plan 2 for affected historic properties pertaining to the Rockies Express Pipeline LLC's installation of a 622 mile long natural gas pipeline through Illinois, Indiana, and Ohio (FERC Docket #PF06-30-000; DHPA #1562)

Dear Ms. Krause:

Pursuant to Section 106 of the National Historic Preservation Act (16 U.S.C. § 470f) and 36 C.F.R. Part 800, the staff of the Indiana State Historic Preservation Officer ("Indiana SHPO") has conducted an analysis of the materials dated July 24, 2008 and received on July 25, 2008, for the above indicated project in Vermillion, Parke, Hendricks, Shelby, Decatur, and Franklin counties, Indiana.

In terms of cultural resources, we concur with the proposed actions in the treatment plan dated July 21, 2008 for the following resources: sites 12Ve586, 12P652, 12He347, 12Sh450, 12De745, and 12Fr335. We do, however, have a few comments regarding the treatment plan:

1. The archaeological plans for the data recovery must be approved by our office prior to initiation of field investigations.
2. It is our understanding that additional treatment plans for other cultural resources will follow.
3. If the horizontal directional drill method of avoiding site 12FR335 fails, then this site must be subjected to data recovery.
4. Site 12Ve593, recorded through the reroute, must be avoided by all project activities or subjected to further archaeological investigations.

If you have questions about archaeological issues please contact Cathy Draeger at (317) 234-3791 or cdraeger@dnr.IN.gov. If you have questions about buildings or structures please contact Holly Tate at (317) 234-3919 or htate@dnr.IN.gov. Additionally, in all future correspondence regarding the above indicated project, please refer to DHPA #1562.

Very truly yours,

James A. Glass, Ph.D.
Deputy State Historic Preservation Officer

JAG:HAT:CLD:eld

cc: Kimberly Bose, Federal Energy Regulatory Commission
enc: Ellen Saint Onge, Federal Energy Regulatory Commission
Seth Mitchell, AK Environmental, LLC,
Thomas Chadderton, Louis Berger Group
Sandy Stevens, John Milner Associates



Rockies Express Pipeline

June 3, 2008

Mr. Jim Glass
Deputy State Historic Preservation Officer
Division of Historic Preservation & Archaeology
402 West Washington Street
Room W274
Indianapolis, Indiana 46204

RE: Letter of Agreement Governing Cultural Resources during the Construction of the
Rockies Express Pipeline-East (REX-East) Project (DHPA#1562)

Dear Mr. Glass,

I am writing to you concerning the Rockies Express Pipeline-East (REX-East) Project planned through portions of Indiana. To date, Rockies Express Pipeline LLC (Rockies Express) has received several cultural resource clearances from your office regarding this project. Additional cultural resource clearance requests may be made of your office once construction commences due to unforeseen circumstances (i.e. landowner required minor reroutes, additional temporary extra work spaces, offsite surface disposal of drilling mud).

Rockies Express would like to enter into a Letter of Agreement with your office to streamline the review process during a major construction project while adhering to the regulatory requirements. As you are aware, all Rockies Express construction work is subject to environmental monitoring by the Federal Energy Regulatory Commission (FERC) or other approved monitors.

During construction, it may be necessary to make minor adjustments or realignments to facilities based on field conditions. The monitoring staff can approve, in the field, a majority of these minor adjustments or realignments, pending approval from your office. Examples of these variances include:

- a change of orientation of a work space or the addition of an extra work space (average size of work spaces is 50 x 100 feet);
- modifications to, or the addition of, a contractor staging area or pipe storage yard (average size is less than 10 acres);
- modification or relocation of a directional drill site along the previously approved route (average size is 200 x 200 feet);
- minor realignment of the pipeline corridor (corridor includes permanent and temporary construction right-of-way);
- use of a road (paved, improved, or dirt) for access to the pipeline or a facility.

Rockies Express proposes the execution of a formal "Letter of Agreement" between Rockies Express and the Indiana Department of Natural Resources which will allow both of our organizations to handle these types of modifications quickly and efficiently. The use of this



Rockies Express Pipeline

Letter of Agreement will ensure that the construction schedule is not delayed and that your office is not burdened with paperwork that will require a response by a certain deadline.

The terms of this agreement would not apply to any major reroutes of the pipeline corridor. Any major reroutes would be subject to a formal cultural resource assessment survey and report. Major reroutes would include those that affected new landowners, or deviated by more than 0.5 miles from the previously approved route.

The proposed terms of the Letter of Agreement are as follows. When a modification is required, and the Area of Potential Effect (APE) is outside of that previously surveyed and approved by your office, the Rockies Express cultural resource consultants, will initiate a site review. The Indiana State Site Files will be examined to determine if any cultural resources have been identified within the new APE. A crew of professional archaeologists and architectural historians will be sent to the work site, as necessary, to evaluate the new APE and perform a Phase I cultural resource assessment survey of the new APE. If no cultural resources are identified within the new APE, Rockies Express may proceed with their construction immediately. The cultural resource consultants will submit a letter report to your office no later than seven working days following completion of the fieldwork. The letter report will describe the type of facility, the modifications to the facility, the survey methods used, and the results (negative) of the field survey. Rather than requesting clearance and asking that your office respond within 30 days, we would instead be informing you that the work had occurred, the results were negative, and that construction will be proceeding. In this way, Rockies Express can proceed with work under this Letter of Agreement and no response would be required from your office.

If an archaeological site or historical structure is located during the Phase I survey of the new APE, we would follow the standard procedure for reporting cultural resources. A letter report will be sent to your office complete with a map, survey log sheet and site file form. The letter would request concurrence with the Archaeologist / Historian's recommendations that the property is either eligible or ineligible for listing on the National Register of Historic Places.

If you agree with the content of this Letter of Agreement with Rockies Express for REX-East through Indiana, please sign below and return one of the originals in the enclosed envelope.

Thank you for your cooperation and assistance. Please do not hesitate to contact me by telephone at 307.760.5635 or by email at ryan_childs@kindermorgan.com, or Jim Thompson at 614.866.7046 or by email at jimt@caprock-llc.com, should you have any questions.

Sincerely,

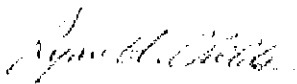

Ryan Childs
Environmental Project Manager for Rockies Express Pipeline East Project

cc: Jim Thompson, REX East
Seth Mitchell, REX East



I agree with and enter into this Letter of Agreement Governing Cultural Resources during the Construction of the Rockies Express Pipeline-East (REX-East) Project through Indiana.

Mr. Jim Glass
Deputy State Historic Preservation Officer

Date



Indiana Department of Natural Resources

Mitchell E. Daniels, Jr., Governor
Robert E. Carter, Jr., Director

Division of Historic Preservation & Archaeology • 402 W. Washington Street, W274 • Indianapolis, IN 46204-2739
Phone 317-232-1646 • Fax 317-232-0693 • dhpa@dnr.IN.gov



July 2, 2008

Ryan Childs
Rockies Express Pipeline
500 Dallas Street, Suite 100
Houston, Texas 77002

Federal Agency: Federal Energy Regulatory Commission

Re: Request to enter into an agreement of additional project activities after the start of construction pertaining to the Rockies Express Pipeline LLC's installation of a 622 mile long natural gas pipeline through Illinois, Indiana, and Ohio (FERC Docket #PF06-30-000; DHPA#1562)

Dear Mr. Childs:

Pursuant to Section 106 of the National Historic Preservation Act (16 U.S.C. § 470f) and 36 C.F.R. Part 800, the staff of the Indiana State Historic Preservation Officer ("Indiana SHPO") has conducted an analysis of the materials dated June 3, 2008 and received on June 6, 2008, for the above indicated project in Vermillion, Parke, Putnam, Hendricks, Morgan, Johnson, Shelby, Decatur, and Franklin counties, Indiana.

Although we prefer that project activities be reviewed by our office prior to their clearance, even if cultural resources are not encountered during the archaeological and architectural investigations, we are willing to agree to the proposed agreement with the following conditions:

1. All areas will be archaeologically and architecturally investigated. Even if archaeological resources are not encountered during these investigations, a summary of the archaeological investigations will still be required. If any cultural resources are encountered, then a formal review will be necessary.
2. The archaeological investigations must be done in accordance with the "Secretary of the Interior's Standards and Guidelines for Archaeology and Historic Preservation" (48 F.R. 44716) and must be directly supervised in the field by an archaeologist meeting the "Secretary of the Interior's Professional Qualifications Standards."
3. If architectural resources not previously identified are present, information on those resources that may be potentially eligible for the National Register of Historic Places must be provided to our office for review.

We acknowledge the importance of the timeliness of this project and appreciate the levels of effort for identifying and evaluating cultural resources for this project. We look forward to continuing to work with you on this project. *A copy of the revised 36 C.F.R. Part 800 that went into effect on August 5, 2004, may be found on the Internet at www.achp.gov for your reference.* If you have questions about archaeological issues please contact Cathy Draeger at (317) 234-3791. Additionally, in all future correspondence regarding the above indicated project, please refer to DHPA #1562.

Very truly yours,

James A. Glass, Ph.D.
Deputy State Historic Preservation Officer

JAG:CLD:eld

cc: Kimberly Bose, Federal Energy Regulatory Commission
Kari Krause, Natural Resource Group, Inc.
cmc: Ellen Saint Onge, Federal Energy Regulatory Commission



June 3, 2008

Mr. David Snyder
Archaeology Reviews Manager
Ohio Historic Preservation Office
567 East Hudson Street
Columbus, Ohio 43211-1030

RE: Letter of Agreement Governing Cultural Resources during the Construction of the
Rockies Express Pipeline-East (REX-East) Project (FERC Docket No.CP07-208-000)

Dear Mr. Snyder,

I am writing to you concerning the Rockies Express Pipeline-East (REX-East) Project planned through portions of Ohio. To date, Rockies Express Pipeline LLC (Rockies Express) has received several cultural resource clearances from your office regarding this project. Additional cultural resource clearance requests may be made of your office once construction commences due to unforeseen circumstances (i.e. landowner required minor reroutes, additional temporary extra work spaces, offsite surface disposal of drilling mud).

Rockies Express would like to enter into a Letter of Agreement with your office to streamline the review process during a major construction project while adhering to the regulatory requirements. As you are aware, all Rockies Express construction work is subject to environmental monitoring by the Federal Energy Regulatory Commission (FERC) or other approved monitors.

During construction, it may be necessary to make minor adjustments or realignments to facilities based on field conditions. The monitoring staff can approve, in the field, a majority of these minor adjustments or realignments, pending approval from your office. Examples of these variances include:

- a change of orientation of a work space or the addition of an extra work space (average size of work spaces is 50 x 100 feet);
- modifications to, or the addition of, a contractor staging area or pipe storage yard (average size is less than 10 acres);
- modification or relocation of a directional drill site along the previously approved route (average size is 200 x 200 feet);
- minor realignment of the pipeline corridor (corridor includes permanent and temporary construction right-of-way);
- use of a road (paved, improved, or dirt) for access to the pipeline or a facility.



Rockies Express Pipeline

Rockies Express proposes the execution of a formal "Letter of Agreement" between Rockies Express and the Ohio Historic Preservation Office which will allow both of our organizations to handle these types of modifications quickly and efficiently. The use of this Letter of Agreement will ensure that the construction schedule is not delayed and that your office is not burdened with paperwork that will require a response by a certain deadline.

The terms of this agreement would not apply to any major reroutes of the pipeline corridor. Any major reroutes would be subject to a formal cultural resource assessment survey and report. Major reroutes would include those that affected new landowners, or deviated by more than 0.5 miles from the previously approved route.

The proposed terms of the Letter of Agreement are as follows. When a modification is required, and the Area of Potential Effect (APE) is outside of that previously surveyed and approved by your office, the Rockies Express cultural resource consultants, will initiate a site review. The Ohio State Site Files will be examined to determine if any cultural resources have been identified within the new APE. A crew of professional archaeologists and architectural historians will be sent to the work site, as necessary, to evaluate the new APE and perform a Phase I cultural resource assessment survey of the new APE. If no cultural resources are identified within the new APE, Rockies Express may proceed with their construction immediately. The cultural resource consultant will submit a letter report to your office no later than seven working days following completion of the fieldwork. The letter report will describe the type of facility, the modifications to the facility, the survey methods used, and the results (negative) of the field survey. Rather than requesting clearance and asking that your office respond within 30 days, we would instead be informing you that the work had occurred, the results were negative, and that construction will be proceeding. In this way, Rockies Express can proceed with work under this Letter of Agreement and no response would be required from your office.

If an archaeological site or historical structure is located during the Phase I survey of the new APE, we would follow the standard procedure for reporting cultural resources. A letter report will be sent to your office complete with a map, survey log sheet and site file form. The letter would request concurrence with the Archaeologist / Historian's recommendations that the property is either eligible or ineligible for listing on the National Register of Historic Places.

If you agree with the content of this Letter of Agreement with Rockies Express for REX-East through Ohio, please sign below and return one of the originals in the enclosed envelope.

Thank you for your cooperation and assistance. Please do not hesitate to contact me by telephone at 307.760.5635 or by email at ryan_childs@kindermorgan.com, or Jim Thompson at 614.866.7046 or by email at jimt@caprock-llc.com, should you have any questions.



Sincerely,

Ryan Childs
Environmental Project Manager for Rockies Express Pipeline East Project

cc: Jim Thompson, REX East
Seth Mitchell, REX East

I agree with and enter into this Letter of Agreement Governing Cultural Resources during the Construction of the Rockies Express Pipeline-East (REX-East) Project through Ohio.

Mr. David Snyder
Archaeology Reviews Manager

Date

July 23
~~June 3~~, 2008

Mr. Mark J. Epstein, Department Head
Resource Protection and Review Ohio Historic Preservation Office
567 E. Hudson Street
Columbus, OH 43211-1030

RE: Letter of Agreement Governing Cultural Resources during Construction of the
Rockies Express Pipeline-East (REX-East) Project (FERC Docket No. CP07-208-000)

Dear Mr. Epstein,

I am writing to you concerning the Rockies Express Pipeline-East (REX-East) Project planned through portions of Ohio. To date, Rockies Express Pipeline LLC (Rockies Express) has provided project documentation including reports of archaeological and architectural surveys and received comments from your office regarding this project. Additional requests for reviews of project documentation may be made of your office once construction commences due to unforeseen circumstances (e.g., landowner required minor reroutes, additional temporary extra work spaces, offsite surface disposal of drilling mud).

Rockies Express would like to enter into a Letter of Agreement with your office to streamline the review process during a major construction project while adhering to the regulatory requirements. As you are aware, all Rockies Express construction work is subject to environmental monitoring by the Federal Energy Regulatory Commission (FERC) or other approved monitors.

During construction, it may be necessary to make minor adjustments or realignments to facilities based on field conditions. The monitoring staff can approve, in the field, a majority of these minor adjustments or realignments, pending coordination with your office and approval from the FERC. Examples of these variances include:

- a change of orientation of a work space or the addition of an extra work space (average size of work spaces is 50 x 100 feet);
- modifications to, or the addition of, a contractor staging area or pipe storage yard (average size is less than 10 acres);
- modification or relocation of a directional drill site along the previously approved route (average size is 200 x 200 feet);
- minor realignment of the pipeline corridor (corridor includes permanent and temporary construction right-of-way);
- use of a road (paved, improved, or dirt) for access to the pipeline or a facility.

Page 1 of 4
LOA REX-East
Ohio
7/23/08

Rockies Express proposes the execution of a Letter of Agreement between Rockies Express and the Ohio Historic Preservation Office (OHPO) that will allow both of our organizations to handle these types of modifications quickly and efficiently. The use of this Letter of Agreement will ensure that the construction schedule is not delayed and that your office may provide strategic comments in a timely manner.

The terms of this agreement would not apply to any major reroutes of the pipeline corridor. Any major reroutes would be subject to a formal cultural resource assessment survey and report. Major reroutes would include those that affected new landowners, or deviated by more than 0.5 miles from the previously approved route.

The Letter of Agreement establishes a limited coordination agreement [pursuant to provisions of regulations at 36 CFR 800.3(g), 800.4(a), and 800.4(b)(1)] for the REX-East Project. Within the framework of this limited coordination agreement Rockies Express will continue to submit documentation on behalf of FERC to OHPO for comments on a case-by-case basis where there is a question of eligibility or there is a potential for an adverse effect to an historic property. However, where Rockies Express determines based on field review by an appropriate preservation professional that there isn't the potential for the modification to result in an adverse effect to an historic property, Rockies Express may proceed with construction and is not required to obtain case-by-case review comments from OHPO prior to proceeding with the construction. For all modifications that are not submitted to OHPO for case-by-case review, Rockies Express will complete coordination with OHPO through documentation provided annually in a mutually agreed upon format.

The proposed terms of the Letter of Agreement are as follows. When a modification is required, and the Area of Potential Effect (APE) is outside of that previously surveyed and reviewed by your office, Rockies Express' cultural resource consultants will initiate a site review. As appropriate and necessary, OHPO files will be examined to determine if any cultural resources have been identified within the new APE. A crew of professional archaeologists and/or architectural historians will be sent to the work site to evaluate the new APE. If the preservation professionals recommend that an identification level survey is needed, Rockies Express will ensure that Phase I cultural resource assessment of the new APE is conducted. If no cultural resources are identified within the new APE, Rockies Express may proceed with their construction immediately. If the preservation professional identifies a cultural resource and recommends that the cultural resources is not eligible for inclusion in the National Register, then Rockies Express may proceed with their construction immediately. If the preservation professional recommends further consideration is needed to evaluate an identified cultural resource for inclusion in the National Register, then the preservation professional will prepare appropriate documentation that Rockies Express will review and submit to OHPO for review and comment. Rockies Express may request an expedited review of the documentation by OHPO.

If a modification is proposed within the APE that has been previously reviewed by OHPO, Rockies Express will determine if the proposed modification has the potential to adversely affect an identified property. If the proposed modification has the potential to adversely affect an historic property in a manner not previously considered or if a property that may be adversely affected requires further consideration to determine its eligibility for the National Register, Rockies Express will provide appropriate documentation for OHPO to review on a case-by-case basis. Rockies Express may request an expedited review of the documentation by OHPO. Otherwise, Rockies Express may proceed with its construction.

Page 2 of 4
LOA REX-East
OHPO
7/23/08

This Letter of Agreement extends for a period not to exceed two (2) years from its signing. It may be amended or extended by agreement of the signatories.

If you agree with the content of this Letter of Agreement with Rockies Express for REX-East through Ohio, please sign below and return one of the originals in the enclosed envelope.

Thank you for your cooperation and assistance. Please do not hesitate to contact me by telephone at 307.760.5635 or by email at ryan_childs@kindermorgan.com, or Jim Thompson at 614.866.7046 or by email at jimt@caprock-llc.com, should you have any questions.

Page 3 of 4
LOA REX-East
Ohio
7/23/08

Sincerely,

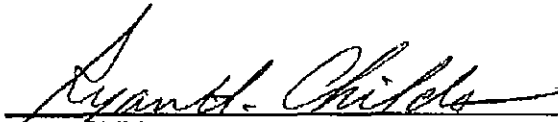

Ryan Childs

Environmental Project Manager for Rockies Express Pipeline East Project

Cc: Jim Thompson, REX East
Seth Mitchell, REX East

I agree with and enter into this Letter of Agreement establishing a Limited Coordination Agreement Governing Cultural Resources during the Construction of the Rockies Express Pipeline-East (REX-East) Project through Ohio.



Mr. Mark J. Epstein
Department Head
Resource Protection and Review
Ohio Historic Preservation Office

7.23.08
Date



REX-EAST-OH-33

September 8, 2008

Kari Krause
Cultural Resource Manager
Natural Resource Group, Inc.
1000 IDS Center
80 S. Eighth Street
Minneapolis, MN 55402

Re: Treatment Plan #2, Rockies Express Pipeline, Ohio (REX-East-OH-33)

Dear Ms. Krause,

This is in response to correspondence from your office dated August 12, 2008 (received August 13) transmitting the Treatment Plan #2 for the Rockies Express Pipeline East project. The Treatment Plan specifies the management of historic properties during construction of the Rockies Express Pipeline – East project. The comments of the Ohio Historic Preservation Office (OHPO) are submitted in accordance with provisions of the National Historic Preservation Act of 1966, as amended (16 U.S.C. 470 [36 CFR 800]).

Based on the information in the Treatment Plan #2, OHPO accepts and approves the Treatment Plan. For the purposes of this correspondence, references to the Treatment Plan refer to the second treatment plan dated August 11, 2008.

The Treatment Plan provides a constructive approach to the management of significant archaeological sites where there will be adverse effects to the archaeological site as a result of the construction of the proposed pipeline. It offers a perspective that is helpful in evaluating preservation priorities and in establishing a meaningful level of mitigation effort both for individual sites and for the whole project. In addition, the Treatment Plan begins to lay out some ideas for the management of significant architectural properties.

The Treatment Plan covers 12 archaeological sites: 33-WA-823, 33-CN-428, 33-CN-430, 33-CN-433, 33-PI-179, 33-PI-952, 33-PI-953, 33-PE-807, 33-PE-808, 33-PE-837, 33-MU-1306, and 33-MO-77. In addition, the Treatment Plan proposes mitigation for two architectural properties: BUT-2447-6 (the Lefler Farm), and WAR-1424-5 (the Sams House). Archaeological site 33-PI-953 will be avoided by horizontal directional drilling (HDD). We agree that this treatment measure is appropriate and concur with the finding of No Adverse Effect. Architectural property WAR-1424-5 is located at the edge of the area of potential effects and is buffered from the construction by several modern facilities, including the proximity of the property to Interstate Route 75. We agree that the avoidance measures for this historic property are appropriate and concur with the finding of No Adverse Effect.

OHIO HISTORICAL SOCIETY

Ohio Historic Preservation Office

567 East Hudson Street, Columbus, Ohio 43211-1030 ph: 614.298.2000 fx: 614.298.2037
www.ohiohistory.org

Ms. Kari Krause
September 8, 2008
Page 2 – Treatment Plan #2

We agree that the eleven archaeological sites recommended as eligible and requiring treatment are eligible and that data recovery is appropriate at these eleven archaeological sites. We understand that this is not a complete list of all significant archaeological sites in Ohio along the REX-East corridor. To the best of our knowledge, none of these eleven archaeological sites has produced burials or other sensitive materials in or in the immediate vicinity of the REX-East corridor.

In general the data recovery plans for the archaeological sites include additional collection of artifacts, use of geophysical testing, hand excavation of test units, mechanical removal of topsoil from strip blocks, and excavation of features. Not all methods are employed at each site. The collection of artifacts, which includes selective use of timed controlled surface collection, geophysical testing, and excavation of test units are strategies designed to allow researchers to focus on areas within the sites likely to contain patterns of subplowzone features. We agree that the recovery of data from features should be a priority. We also agree that the collection and analysis of artifacts and other data on site conditions are important for understanding and interpreting these archaeological sites. The data recovery plans generally call for the removal of topsoil, combining excavation units and mechanical strip blocks, from approximately 8% to 12% of the site area within the portion of the project corridor where topsoil will be removed as part of the construction process. The percentages appear to be consistent with many other data recovery operations. In many ways, the proposed research designs and data recovery plans are routine. Generally for these sites we agree that this approach is appropriate.

The data recovery plans will result in the analysis of artifacts, preparation of reports, presentation of a synthetic paper, and curation of assemblages and project documentation.

The mitigation at the Leffler Farm should augment the completed Ohio Historic Inventory form and should add to our ability to appreciate and recognize the significance of this property.

Three of the archaeological sites included in the Treatment Plan are historic-era sites in Clinton County. In addition to individual significance, the sites are of interest as a group for several reasons. The sites show good integrity, represent similar farms occupied at different times, were occupied by families who knew each other, and are in a region of Ohio influenced by Quaker philosophy.

Three of the sites are in Pickaway County along sections of the pipeline crossing the Scioto River valley (site 33-PI-953 will be avoided by HDD and won't be included in the excavations). The combined information from the Scioto River valley cross-section promises to add valuable new information on this important region.

Three of the archaeological sites included in the Treatment Plan are Perry County sites. The sites along the Noll Reroute portion of the project have produced amazing prehistoric assemblages. The data recovery plans include a number of creative ideas. Some of these

Ms. Kari Krause
September 8, 2008
Page 3 – Treatment Plan #2

ideas, such as use of petrographic analysis may need some additional thought to ensure that the sampling is appropriate. From previous experience we know that these sites will produce very large assemblages, and we also know that there will be unexpected features identified at probably each site. At any one location the assemblage is likely to represent only a limited range of activities. The excavations along the pipeline corridor offer the potential for research on a range of activities and thus enable a greater potential to interpret organizational patterns.

For all eleven of the archaeological sites, Rockies Express proposes to use the travel lane and restrict archaeological data recovery excavations to the construction corridor. We agree.

In summary, OHPO accepts and approves the Treatment Plan #2. We see no reason to object to the initiation of data recovery fieldwork at any of these eleven archaeological sites. Any questions concerning this matter should be addressed to David Snyder at (614) 298-2000, between the hours of 8 am. to 5 pm. Thank you for your cooperation.

Sincerely,

A handwritten signature in black ink that reads "David Snyder". The signature is fluid and cursive, with the first name "David" and last name "Snyder" clearly distinguishable.

David Snyder, Ph.D., RPA, Archaeology Reviews Manager
Resource Protection and Review

DMS:ds (OHPO Serial Number 1020995)

xc Erica L. Schnelder, ASC Group, Inc., 800 Freeway Drive North, Suite 101, Columbus, OH 43229
Michael Hornum, Ph.D., R.C. Goodwin & Associates, Inc., 241 E. Fourth Street, Suite 100, Frederick, MD 21701

[illegible]

[illegible]

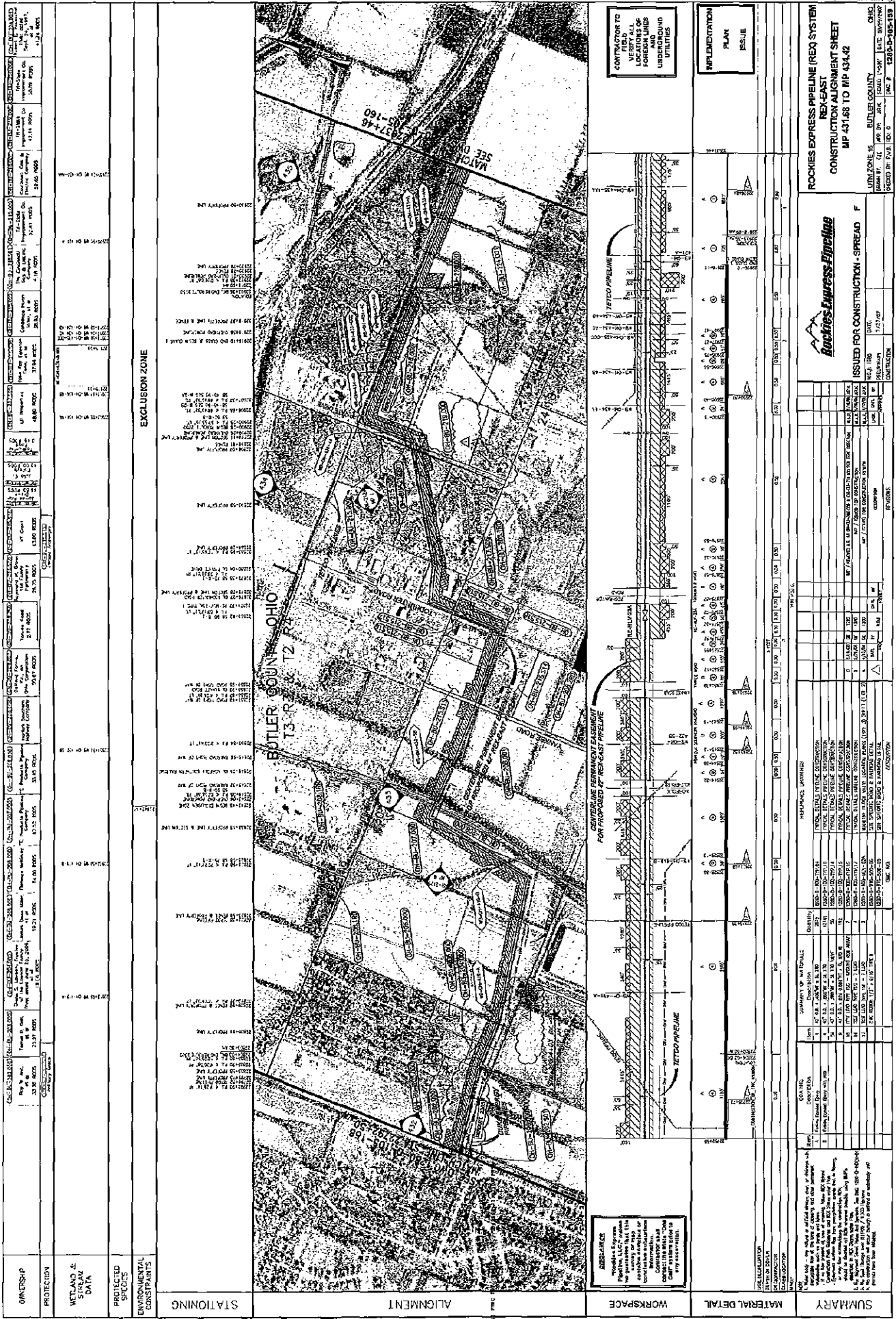

ITEM	DESCRIPTION	QUANTITY	UNIT	AMOUNT	REMARKS
1	PIPELINE (RED SYSTEM)	1.00	MI	1.00	PIPELINE (RED SYSTEM)
2	CONSTRUCTION ALIGNMENT	1.00	MI	1.00	CONSTRUCTION ALIGNMENT
3	EXCLUSION ZONE	1.00	MI	1.00	EXCLUSION ZONE
4	RIGHT-OF-WAY	1.00	MI	1.00	RIGHT-OF-WAY
5	STATIONING	1.00	MI	1.00	STATIONING
6	ALIGNMENT	1.00	MI	1.00	ALIGNMENT
7	WORKSPACE	1.00	MI	1.00	WORKSPACE
8	MATERIAL DETAIL	1.00	MI	1.00	MATERIAL DETAIL
9	SUMMARY	1.00	MI	1.00	SUMMARY

Attachment G					
Rockies Express Pipeline –East Project					
Explanations of Alignment Sheet Page Change Outs and Requests for Further Justification - Spread F					
Milepost	Alignment Sheet No. / D – 1280-105-	Tract No.	Comment	Addition or Deletion Made to the Alignment Sheet	Justification if necessary
374.9	- 138	IN-DC-077.000	ATWS shown did not have all necessary environmental approvals.	ATWS reduced to 400 ft by 75 ft	ATWS reduced to area where cultural resources surveys have been completed.
375.9	- 138	IN-DC-080.000	ATWS shown on the south side lacks sufficient justification for its size.	ATWS reduced to 35 ft in width	ATWS to provide area for topsoil storage
380.8	- 140	IN-FR-017.000	ATWS shown on the south side lacks sufficient justification for its size.	ATWS removed	NA
381.3	- 140	IN-FR-018.S01	Temporary access road shown did not have landowner approval.	Temporary access road removed	NA
385.3	- 141	IN-FR-054.000; - 054.N02	Temporary access road shown did not have landowner approval.	Temporary access road removed	NA
385.3	-142	IN-FR-055.000	Temporary access road shown did not have landowner approval.	Temporary access road removed	NA
398.5	- 146	IN-FR--149.000; - 150.S01	ATWS shown on the south side lacks sufficient justification for its size.	ATWS reduced to 35 ft in width	ATWS to provide area for spoil storage due to terrain.
414.0	- 152	OH-BU-085.S02	ATWS shown did not have all necessary environmental approvals.	ATWS removed	NA
416.5	- 153	OH-BU-094.000; - 095.000	ATWS shown lacks sufficient justification for its size.	ATWS reduced	ATWS on the northwest and southwest sides of railroad will be used to complete the railroad bore.
429.5	- 158	OH-BU-168.000	Temporary access road did not extend to right-of-way.	Temporary access road removed	NA
432.5	- 159	Unlabeled east of OH-BU-202.S01	Temporary access road shown did not have landowner approval.	Temporary access road removed	NA
RR-2031 MP 433.9+ .15	- 159	OH-BU-219.001	Temporary access road shown did not have landowner approval.	Temporary access road removed	NA
443.6	- 162	OH-WA-020.S01	ATWS shown did not have all necessary environmental approvals.	ATWS reduced to 150 ft by 65 ft	ATWS reduced to area where cultural resources surveys have been completed.

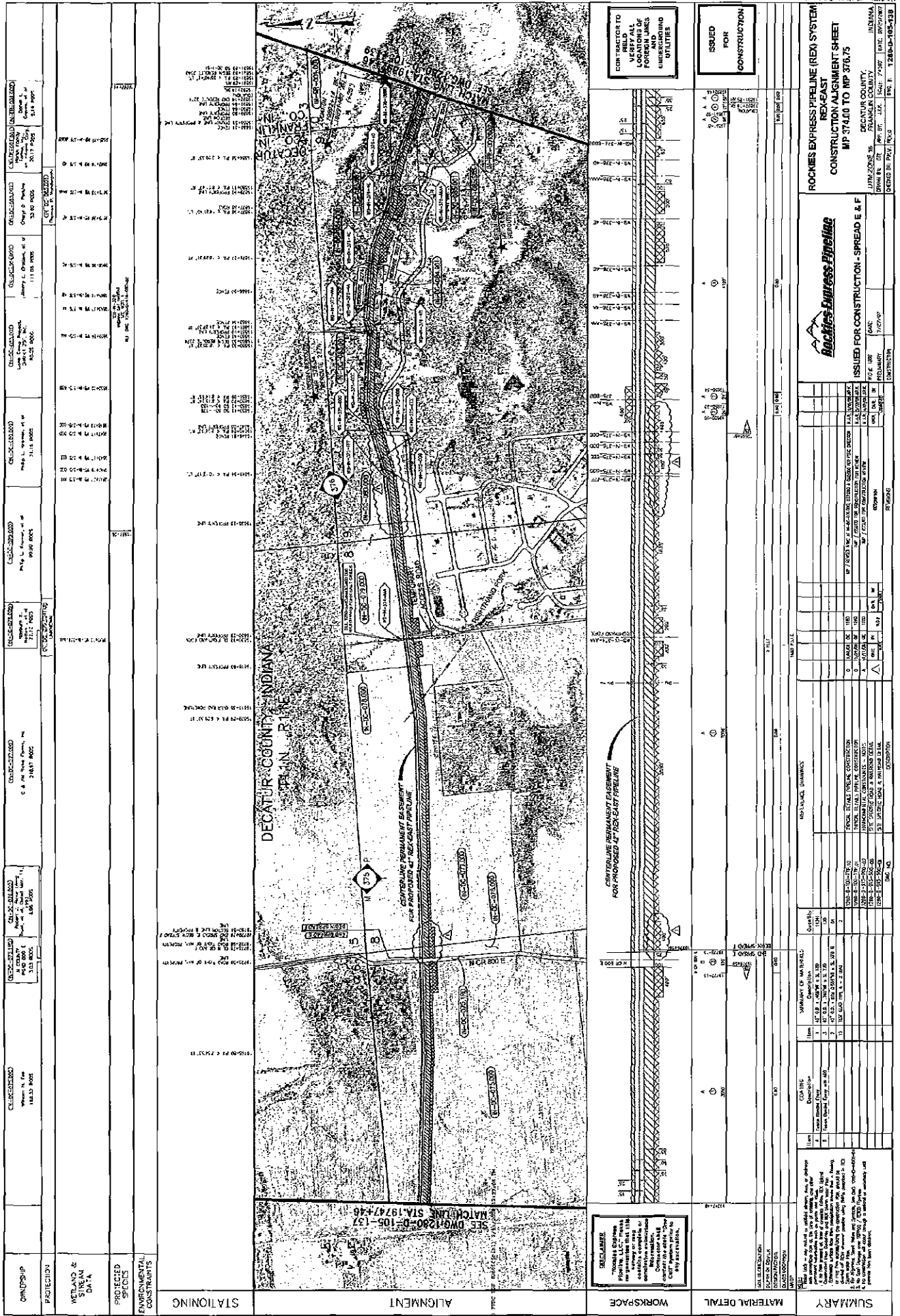

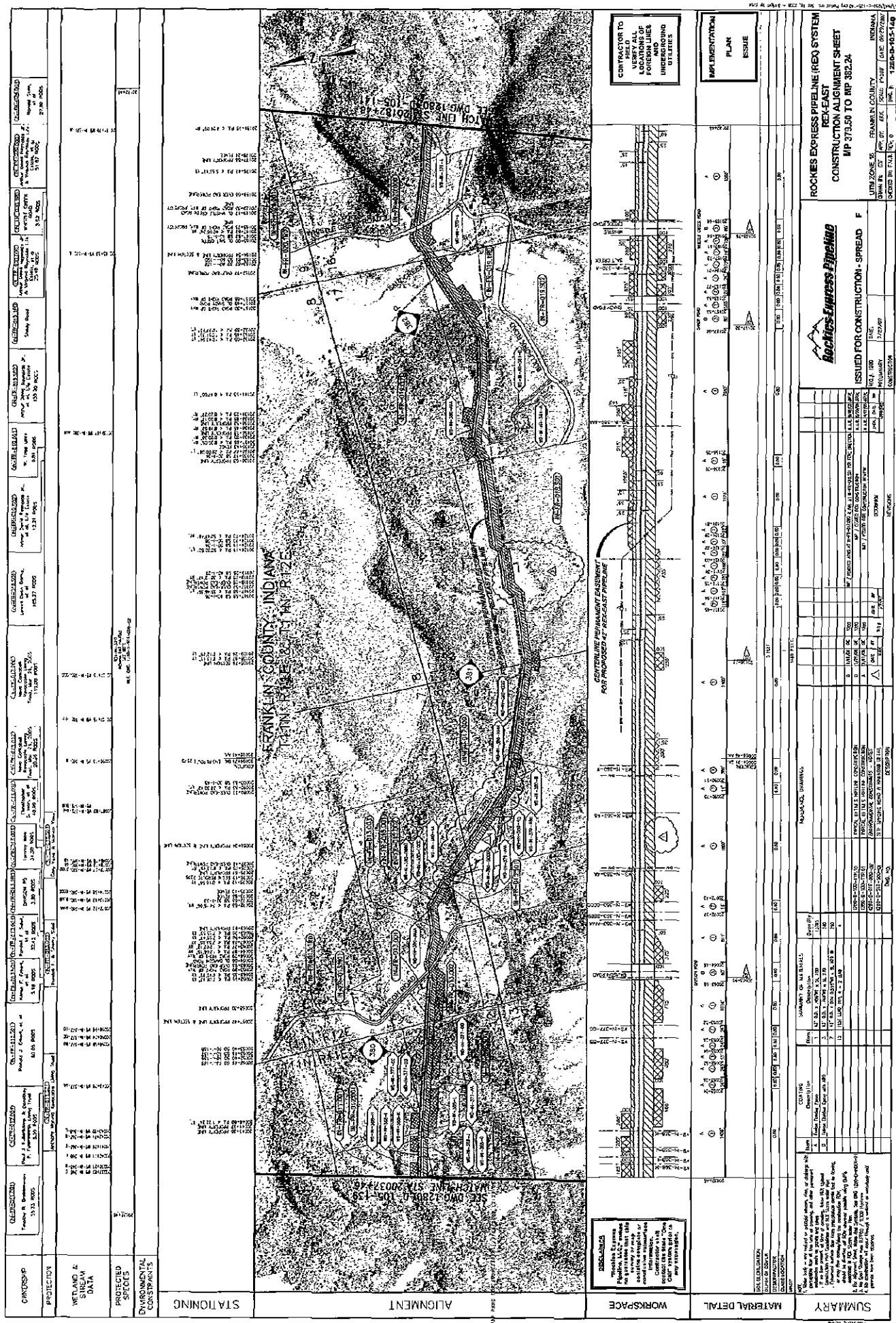

CONTRACTOR TO VERIFY ALL LOCATIONS OF UTILITIES AND STRUCTURES		IMPLEMENTATION PLAN ISSUE	
CONTRACTOR TO VERIFY ALL LOCATIONS OF UTILITIES AND STRUCTURES		IMPLEMENTATION PLAN ISSUE	
CONTRACTOR TO VERIFY ALL LOCATIONS OF UTILITIES AND STRUCTURES		IMPLEMENTATION PLAN ISSUE	
CONTRACTOR TO VERIFY ALL LOCATIONS OF UTILITIES AND STRUCTURES		IMPLEMENTATION PLAN ISSUE	
CONTRACTOR TO VERIFY ALL LOCATIONS OF UTILITIES AND STRUCTURES		IMPLEMENTATION PLAN ISSUE	
CONTRACTOR TO VERIFY ALL LOCATIONS OF UTILITIES AND STRUCTURES		IMPLEMENTATION PLAN ISSUE	
CONTRACTOR TO VERIFY ALL LOCATIONS OF UTILITIES AND STRUCTURES		IMPLEMENTATION PLAN ISSUE	
CONTRACTOR TO VERIFY ALL LOCATIONS OF UTILITIES AND STRUCTURES		IMPLEMENTATION PLAN ISSUE	
CONTRACTOR TO VERIFY ALL LOCATIONS OF UTILITIES AND STRUCTURES		IMPLEMENTATION PLAN ISSUE	
CONTRACTOR TO VERIFY ALL LOCATIONS OF UTILITIES AND STRUCTURES		IMPLEMENTATION PLAN ISSUE	

GULF INTERNATIONAL ENGINEERING
 KUSTAN, KANSAS
 1-9-2022

TABLE 4.1.1-4 Rev. 9/18/08

Rockies Express Pipeline-East Project
Status of Cultural Resources Surveys and Compliance Along Spread F

Report No.	Report Title	Submitted to SHPO	SHPO Comment Received	Report Filed with FERC	SHPO Comments Filed with FERC
REX-East-IN-03	Phase I Archeological Survey for the Proposed Rockies Express East Pipeline Project, Vermilion, Parke, Putnam, Hendricks, Morgan, Johnson, Shelby, Decatur, and Franklin Counties, Indiana. Vol. I-III (w/ Unanticipated Discovery Plan) Draft and Final (2 Vol.)	4/5/2007; Final 2/5/08	5/10/2007	4/30/2007	5/18/2007
REX-East-IN-10	Phase I Archeological Survey for the Proposed Rockies Express Pipeline-East (REX-EAST) Project - Spreads 5 and 6, Johnson, Shelby, Decatur, and Franklin Counties, Indiana. Vol. I-III.	8/16/2007	9/17/2007	8/27/2007	9/28/2007
REX-East-IN-16	Phase II Archeological Investigations Rockies Express East Pipeline Project Spread 6, Indiana. Sites 12DE701, 12DE713, 12FR307, and 12FR310, Decatur and Franklin Counties, Indiana. (draft and final)	11/13/07; Final 1/14/08	12/14/07; Final 2/11/08	12/3/2007	2/19/2008
REX-East-IN-21	Phase I Archeological Investigations, Rockies Express Pipeline-East (REX-EAST) Project, Spreads 5 and 6, Indiana - Third Mobilization. Hendricks, Morgan, Johnson, Shelby, Decatur, and Franklin Counties, Indiana. Vol. I-III.	Vo. 1-2; 12/21/07; Vo. 3; 1/10/08	2/1/2008	Vo. 1-2; 12/21/07; Vo. 3;	2/19/2008
REX-East-IN-22	Architectural Investigations Rockies Express East Pipeline Project, Spread 5 & 6, Indiana. Hendricks, Morgan, Shelby, Johnson, Decatur, and Franklin Counties, Indiana	12/21/07; Final 1/29/08	1/17/2008; Final 2/4/08	12/21/2007 final 2/11/08	2/1/2008 Final 2/11/08
REX-East-IN-25	Phase I Archeological Investigations, Rockies Express Pipeline-East Project, Spreads 5 and 6, Indiana - Fourth and Fifth Mobilizations. Hendricks, Morgan, Johnson, Shelby, Decatur, and Franklin Counties, Indiana. Vol. I-III.	5/2/2008	6/4/2008	5/5/2008	6/10/2008
REX-East-IN-29	Phase II Archeological Investigations Rockies Express East Pipeline Project Spreads 5 and 6, Indiana - Second Mobilization. Morgan, Shelby, Decatur, and Franklin Counties, Indiana	5/2/2008	6/4/2008	5/5/2008	6/10/2008
REX-East-IN-31	Treatment Plan for Affected Historic Properties in Spreads 4, 5, and 6 of the Rockies Express Pipeline - East Project	5/13/2008	6/16/2008; 7/22/2008	5/14/2008	6/23/2008; 7/25/2008
REX-East-IN-35	Phase I Archeological Investigations Rockies Express East Pipeline Project Spread 5 and 6, Indiana, Sixth Mobilization.	6/3/2008	6/27/2008	6/4/2008	7/3/2008
REX-East-IN-37	Phase II Archeological Investigations Rockies Express East Pipeline Project Spreads 5 and 6, Indiana - Third Mobilization. Decatur, and Franklin Counties, Indiana	6/10/2008	7/17/2008	6/11/2008	7/18/2008
REX-East-IN-40	Phase I Archeological Investigations Rockies Express East Pipeline Project Spread 5 and 6, Indiana, Seventh Mobilization.	6/23/2008	7/21/2008	6/23/2008	7/25/2008
REX-East-IN-43	Phase II Archeological Investigations Rockies Express East Pipeline Project Spreads 5 and 6, Indiana - Fourth Mobilization.	7/16/2008	8/19/2008	7/18/2008	8/21/2008
REX-East-IN-44	Treatment Plan 2 for Affected Historic Properties in Indiana for the Rockies Express Pipeline-East Project	7/24/2008	8/21/2008	7/25/2008	8/28/2008

TABLE 4.1.1-4 Rev. 9/18/08

**Rockies Express Pipeline-East Project
Status of Cultural Resources Surveys and Compliance Along Spread F**

Report No.	Report Title	Submitted to SHPO	SHPO Comment Received	Report Filed with FERC	SHPO Comments Filed with FERC
REX-East-IN-48	Phase II Archaeological Investigations Rockies Express East Pipeline Project Spreads 5 and 6, Indiana - Fourth Mobilization.	8/25/2008	Pending 9/2008	8/27/2008	Pending 9/2008
REX-East-IN-51	Treatment Plan 3 for Affected Historic Properties in Indiana for the Rockies Express Pipeline-East Project	8/28/2008	Pending 9/2008	8/28/2008	Pending 9/2008
REX-East-OH-02	Phase I Archeological Survey for the Proposed Rockies Express East Pipeline Project, Butler, Warren, Clinton, Greene, Fayette, Pickaway, Fairfield, Perry, Muskingum, Morgan, Guernsey, Noble, Belmont, and Monroe Counties, Ohio. Vol. I - II (w/ Unanticipated Discovery Plan) (5 Vol. draft and 2 Vol. final)	4/10/2007; Final 11/13/07	5/9/2007; UDP 5/14/2007; final 12/21/07	4/30/2007; Final 12/3/07	5/18/2007
REX-East-OH-07	Phase I Cultural Resources Survey for the Proposed Rockies Express Pipeline-East Project, Butler, Warren, Clinton, Greene, Fayette, and Pickaway Counties, Ohio. Vol. I - III	8/13/2007	9/6/2007	8/27/2007	9/28/2007
REX-East-OH-09	Phase II Archaeological Evaluative Testing of Six Sites for the Proposed Rockies Express Pipeline-East (REX-East) Project, Butler, Warren, and Pickaway Counties, Ohio. Vol. I-II	11/9/2007	3/5/2008	12/3/2007	4/11/2008
REX-East-OH-13	Addendum Report: Additional Phase I Cultural Resources Survey for the Proposed Rockies Express Pipeline-East Project, Butler, Warren, Clinton, Greene, Fayette, and Pickaway Counties, Ohio. Vol. I - II	12/21/2007	3/14/2008	12/21/2007	4/11/2008
REX-East-OH-15	Request for Expedited Review of Sites 33BU1039 and 33WA823	3/3/2008	3/18/2008	4/11/2008	4/11/2008
REX-East-OH-16	Second Addendum Report: Additional Phase I Cultural Resources Survey for the Proposed Rockies Express Pipeline-East Project, Butler, Warren, Clinton, Greene, Fayette, and Pickaway Counties, Ohio. Vol. I - III	4/4/2008	4/29/2008	4/11/2008	5/9/2008
REX-East-OH-18	Additional Phase II Archaeological Evaluative Testing of Nine Sites for the Proposed Rockies Express Pipeline-East (REX-East) Project in Butler, Warren, Clinton, Fayette, and Pickaway Counties, Ohio. Vol. I-III	4/24/2008	5/27/2008	5/5/2008	6/4/2008
REX-East-OH-19	Treatment Plan for Historic Properties: Rockies Express Pipeline-East Project, Butler, Warren, Clinton, Greene, Fayette, Pickaway, Fairfield, Perry, Muskingum, Guernsey, Noble, Belmont and Monroe Counties, Ohio.	4/30/2008; revised 7/25/2008	7/3/2008	5/5/2008; revised 7/25/2008	7/18/2008
REX-East-OH-20	Letter Format Report for Phase I Cultural Resources Survey Between February 16, 2008 and April 23, 2008 for the REX-East Pipeline in Butler, Warren, Clinton, Greene, Fayette, and Pickaway Counties, Ohio	5/1/2008	5/30/2008	5/5/2008	6/4/2008
REX-East-OH-25	Intensive Phase I testing at Two Sites and Phase II Archaeological Evaluative Testing of Four Sites for the Proposed Rockies Express Pipeline-East (REX-East) Project in Butler, Warren, Clinton, Fayette, and Pickaway Counties, Ohio.	6/3/2008	6/26/2008	6/4/2008	7/3/2008
REX-East-OH-28	Email - Rockies Express East - Expedited Review of Lebanon Hub in Warren County, OH.	6/12/2008	6/18/2008	6/23/2008	6/23/2008

TABLE 4.1.1-4 Rev. 9/18/08

**Rockies Express Pipeline-East Project
Status of Cultural Resources Surveys and Compliance Along Spread F**

Report No.	Report Title	Submitted to SHPO	SHPO Comment Received	Report Filed with FERC	SHPO Comments Filed with FERC
REX-East-OH-29	Letter Format Report for Phase I Cultural Resources Survey Between May 16, 2008 and June 15, 2008 for the REX-East Pipeline in Butler, Warren, Clinton, Greene, Fayette, and Pickaway Counties, Ohio.	6/23/2008	7/10/2008	6/23/2008	7/18/2008
REX-EAST-OH-33	Second Treatment Plan for Historic Properties, Rockies Express Pipeline-East Project, Butler, Warren, Clinton, Greene, Fayette, Pickaway, Fairfield, Perry, Muskingum, Guernsey, Noble, Belmont and Monroe Counties, Ohio (draft and final)	8/12/2008 final 9/10/08	9/8/2008	8/13/2008 final 9/11/08	9/11/2008

TABLE 4.1.1-5 Rev. 9/18/08

Rockies Express Pipeline-East Project Status of Remaining Pipeline and Workspace Areas Along Spread F									
State	County	Parcel Number	Entry MP	Exit MP	Cultural Resources Outstanding	Phase I Report Number	SHPO Concurrence on Phase I Report	Phase II Report Number	SHPO Concurrence on Phase II Report
Indiana	Franklin	IN-FR-062.000	386.25	386.49	Cultural resources surveys and/or SHPO concurrence pending.	REX-EAST-IN-35	6/27/2008	REX-EAST-IN-48	Pending 09/2008
Indiana	Franklin	IN-FR-066.000	386.98	387.25 ^a	Cultural resources surveys and/or SHPO concurrence pending.	REX-EAST-IN-21 REX-EAST-IN-25	02/01/2008 06/04/2008	N/A	N/A
Indiana	Franklin	IN-FR-067.000	387.25	387.51 ^a	Cultural resources surveys and/or SHPO concurrence pending.	REX-EAST-IN-21 REX-EAST-IN-25	02/01/2008 06/04/2008	N/A	N/A
Indiana	Franklin	IN-FR-097.001	392.22	392.59	Cultural resources surveys and/or SHPO concurrence pending.	REX-EAST-IN-10 REX-EAST-IN-25 REX-EAST-IN-35	09/17/2007 06/04/2008 06/27/2008	REX-EAST-IN-48	Pending 09/2008
Indiana	Franklin	IN-FR-109.001 (formerly IN-FR-109.002)	392.59	392.87	Cultural resources surveys and/or SHPO concurrence pending.	REX-EAST-IN-35	06/27/2008	REX-EAST-IN-48	Pending 09/2008
Indiana	Franklin	IN-FR-112.001	393.08	393.45	Cultural resources surveys and/or SHPO concurrence pending.	REX-EAST-IN-10	09/17/2007	REX-EAST-IN-37	07/17/2008
Indiana	Franklin	IN-FR-115.001	393.60	394.16	Cultural resources surveys and/or SHPO concurrence pending.	REX-EAST-IN-10 REX-EAST-IN-21	09/17/2007 02/01/2008	REX-EAST-IN-29 REX-EAST-IN-48	05/04/2008 Pending 09/2008
Indiana	Franklin	IN-FR-129.001	394.16	394.69	Cultural resources surveys and/or SHPO concurrence pending.	REX-EAST-IN-10 REX-EAST-IN-21	09/17/2007 02/01/2008	REX-EAST-IN-48	Pending 09/2008
Indiana	Franklin	IN-FR-134.001	395.68	395.89	Cultural resources surveys and/or SHPO concurrence pending.	REX-EAST-IN-03 REX-EAST-IN-25	05/14/2007 06/04/2008	REX-EAST-IN-16	02/11/2008
Ohio	Butler	OH-BU-046.000	409.32	409.73	Cultural resources surveys and/or SHPO concurrence pending.	REX-EAST-OH-16	04/29/2008	N/A	N/A
Ohio	Warren	OH-WA-018.000	441.90	442.41	Cultural resources surveys and/or SHPO concurrence pending.	REX-EAST-OH-20	05/30/2008	N/A	N/A
Ohio	Warren	OH-WA-020.000	442.62	443.59	Cultural resources surveys and/or SHPO concurrence pending.	REX-EAST-OH-07 REX-EAST-OH-16	09/06/2007 04/29/2008	REX-EAST-OH-32	08/1/2008

Rockies Express Pipeline-East Project Status of Remaining Pipeline and Workspace Areas Along Spread F

State	County	Parcel Number	Entry MP	Exit MP	Cultural Resources Outstanding	Phase I Report Number	SHPO Concurrence on Phase I Report	Phase II Report Number	SHPO Concurrence on Phase II Report
<p>^a The pipeline route and/or additional temporary workspace at this location has changed since the FEIS (see table 3.1.3-1). As a result, Rockies Express will conduct additional cultural resources surveys. Therefore, this area will be excluded from construction until the necessary cultural resources survey and documentation has been completed and a separate request for construction has been filed with the FERC (see table 2.1-4).</p>									

TABLE 4.1.2-2 Rev. 9/18/08

Status of Cultural Resources Surveys and Compliance at Whitewater River Horizontal Directional Drill						
Facility	Report No.	Report Title	Submitted to SHPO	SHPO Comment Received	Report Filed with FERC	SHPO Comments Filed with FERC
Whitewater River	REX-East-IN-10	Phase I Archaeological Survey for the Proposed Rockies Express Pipeline-East (REX-EAST) Project - Spreads 5 and 6, Johnson, Shelby, Decatur, and Franklin Counties, Indiana. Vol. I-III.	8/16/2007	9/17/2007	8/27/2007	9/28/2007
	REX-East-IN-21	Phase I Archaeological Investigations, Rockies Express Pipeline-East (REX-EAST) Project, Spreads 5 and 6, Indiana - Third Mobilization. Hendricks, Morgan, Johnson, Shelby, Decatur, and Franklin Counties, Indiana. Vol. I-III. (draft and final)	12/21/07; 1/10/08 final 7/08/2008	2/1/2008	12/21/07; 2/11/08 Final 7/17/2008	2/19/2008
	REX-East-IN-25	Phase I Archaeological Investigations, Rockies Express Pipeline-East (REX-EAST) Project, Spreads 5 and 6, Indiana - Fourth Mobilization. Hendricks, Morgan, Johnson, Shelby, Decatur, and Franklin Counties, Indiana. Vol. I-III.	5/2/2008	6/4/2008	5/5/2008	6/10/2008
	REX-East-IN-29	Phase II Archaeological Investigations Rockies Express East Pipeline Project Spreads 5 and 6, Indiana - Second Mobilization. Morgan, Shelby, Decatur, and Franklin Counties, Indiana (draft and final)	5/2/2008 final 7/8/2008	6/4/2008	5/5/2008 Final 7/17/2008	6/10/2008
	REX-East-IN-31	Treatment Plan for Affected Historic Properties in Spreads 4, 5, and 6 of the Rockies Express Pipeline - East Project	5/13/2008	6/16/2008 update 7/23/08	5/14/2008	6/23/2008 Update 7/25/2008
	REX-East-IN-35	Phase I Archaeological Investigations Rockies Express East Pipeline Project Spread 5 and 6, Indiana, Sixth Mobilization. (draft and final)	6/3/2008 final 7/8/2008	6/27/2008	6/4/2008 Final 7/17/2008	7/3/2008
	REX-East-IN-37	Phase II Archaeological Investigations Rockies Express East Pipeline Project Spreads 5 and 6, Indiana - Third Mobilization. Decatur, and Franklin Counties, Indiana (draft and final)	6/12/2008 final 7/8/2008	7/17/2008	6/12/2008 Final 7/17/2008	7/18/2008
	REX-East-IN-44	Treatment Plan 2 for Affected Historic Properties in Indiana for the Rockies Express Pipeline-East Project	7/24/2008	8/21/2008	7/25/2008	8/28/2008
	REX-East-IN-48	Phase II Archaeological Investigations Rockies Express East Pipeline Project Spreads 5 and 6, Indiana - Fourth Mobilization.	8/25/2008	Pending 9/2008	8/28/2008	Pending 9/2008

Document Content(s)

Letter.PDF.....	1-14
Attach A TABLE 3.1.3-1 RR_CLEAN.PDF.....	15-21
Attach C1 TABLE 3-38-1 residential CLEAN.PDF.....	22-22
Attach C2 1280-a-ss-oh-bu-176_n01-Model.PDF.....	23-23
Attach D TABLE 2.1-3 AR_Rev CLEAN.PDF.....	24-24
Attach E TABLE 2.1-4 exclusions_CLEAN.PDF.....	25-25
Attach F_SHPO correspondence.PDF.....	26-41
Attach G 1280-d-105-152-1280-D-105-152.PDF.....	42-42
Attach G 1280-d-105-153-1280-D-105-153.PDF.....	43-43
Attach G 1280-d-105-158-1280-D-105-158.PDF.....	44-44
Attach G 1280-d-105-159-1280-D-105-159.PDF.....	45-45
Attach G 1280-d-105-162-1280-D-105-162.PDF.....	46-46
Attach G table_alignment sheet changes Spread F.PDF.....	47-47
Attach G 1280-d-105-138-f-1280-D-105-138.PDF.....	48-48
Attach G 1280-d-105-140-1280-D-105-140.PDF.....	49-49
Attach G 1280-d-105-141-1280-D-105-141.PDF.....	50-50
Attach G 1280-d-105-142-1280-D-105-142.PDF.....	51-51
Attach G 1280-d-105-146-1280-D-105-146.PDF.....	52-52
Attach H TABLE 4.1.1-4 reports_CLEAN.PDF.....	53-55
Attach I TABLE 4.1.1-5 tracts_CLEAN.PDF.....	56-57
Attach J TABLE 4.1.2-2 HDD report_CLEAN.PDF.....	58-58