



FILE

NC

RECEIVED-DOCKETING DIV

2007 DEC 17 PM 1:19

PUCO

DUKE ENERGY CORPORATION
139 East Fourth St.
PO Box 960
Cincinnati, OH 45201-0960

15

07-1269-EL-BNR

December 14, 2007

Ms. Reneé Jenkins, Secretary
Public Utilities Commission of Ohio
Docketing Division, 13th Floor
180 East Broad Street
Columbus, Ohio 43215-3793

Re: Construction Notice
Montgomery Road 138kV Transmission Line Relocation Project Phase II

Dear Ms. Jenkins:

Enclosed for filing are ~~ten~~ copies and one original of a Construction Notice regarding a Duke Energy Ohio project.

If you have any questions or concerns regarding this submittal, please contact me at (513) 287-2379.

Sincerely,
Duke Energy Ohio

Stephen R. Lane
Environmental Scientist

Cc Mr. Jim O'Dell (OPSB)

Enclosures

This is to certify that the images appearing are an accurate and complete reproduction of a case file document delivered in the regular course of business
Technician Am Date Processed 12/17/07

CONSTRUCTION NOTICE

OHIO ADMINISTRATIVE CODE 4906-11-02

Montgomery Road 138kV Transmission Line Relocation Project Phase II

PUCO Case No. 07-1269 -EL-BNR

DUKE ENERGY OHIO

December 14, 2007

1. Project Name: Montgomery Road 138kV Transmission Line Relocation Project Phase II.

2. Project Description: This project is in response to an Ohio Department of Transportation (ODOT) request to move the Montgomery-Foster 138,000 volt (138 kV) transmission line (Feeder circuit no. 5487) to the opposite side of Montgomery Road from Pole 116 to Pole 88 inclusive. The total length of the project is approximately 5,230 feet. A USGS map of the project location is attached to this Construction Notice; smaller scale maps of the project route are also attached.

This project meets the requirements of a Construction Notice as it is a “relocation of an electric power transmission line and associated facilities where the project is required by publicly funded entities and is located on or adjacent to right-of-way or land owned by the public entity requiring the project” (OAC 4906-1-01, Appendix A).

This proposed project involves reusing the existing 954 kcmil ACSR conductors and replacing the existing 1/0 ACSR static with 1/0 AAAC static. Pole heights will be increased from an average of 60 feet to 75 feet (maximum of 80 feet) along the project route to meet new engineering standards. The project will be overbuilt on existing 7.2/13kV distribution lines. No additional right-of-way (ROW) will be required as the proposed project will be located completely within existing road ROW. Some additional

vegetation clearing will be required along Montgomery Road to accommodate the relocated transmission line.

Access to the existing and proposed pole locations will be from existing road ROW. Vegetation clearing along the relocation route will be completed prior to the start of the project. Based upon the nature of the project construction impacts will be less than 0.5 acre for the entire project route. As such, this project does not require Duke Energy to develop a formal Storm Water Pollution Prevention Plan or apply for project coverage under NPDES permit no. OHC000002. Even so, Duke Energy will follow Best Management Practices by employing erosion and sedimentation controls as appropriate.

3. Project Need: ODOT plans to construct retaining walls as required along the northwestern edge of Montgomery Road to support a proposed cut associated with the widening of Montgomery Road. ODOT has requested that the 138 kV circuit be moved for both the widening of Montgomery Road and for the construction of these walls. The extent of ODOTs upcoming road widening activities define the limits of this relocation project.

4. Schedule: Construction is planned to start March 1, 2008 with an expected end date of January 1, 2009.

5. Capital Cost: The capital cost of the project is approximately \$450,000.

6. Operating Features: The proposed work will not affect the operating characteristics of the existing line although the new line will be relocated from the northerwestern to the southeastern side of Montgomery Road from pole numbers 116 through 88 inclusive, for a total of 28 relocated poles. The total number of poles will remain the same, the voltage will remain at 138 kV, no new ROW will be needed as the project will be relocated entirely within existing road right-of-way, and maintenance procedures will not change.

7. Map and Directions: A USGS map of the project location is attached to this Construction Notice; smaller scale maps of the project route are also attached. One way to reach the project location from Columbus is to take I-71 south to the Mason Montgomery Road exit (exit 19). From the end of the exit ramp turn left and follow Mason Montgomery Road south for approximately 1 mile to Montgomery Road. Turn right (southwest) onto Montgomery Road, drive past Seven Gables Park on the right, before reaching Seven Gables Road also on the right. This point represents the southwestern end of the project. The northeastern end of the project can be reached by continuing northwest along Montgomery Road to Union Cemetery Road.

8. Public Notifications: This proposed project takes place within Symmes Township, Hamilton County, Ohio. Copies of letters transmitting the Construction Notice to the Symmes Township Trustees and Hamilton County Planning Commission are attached.

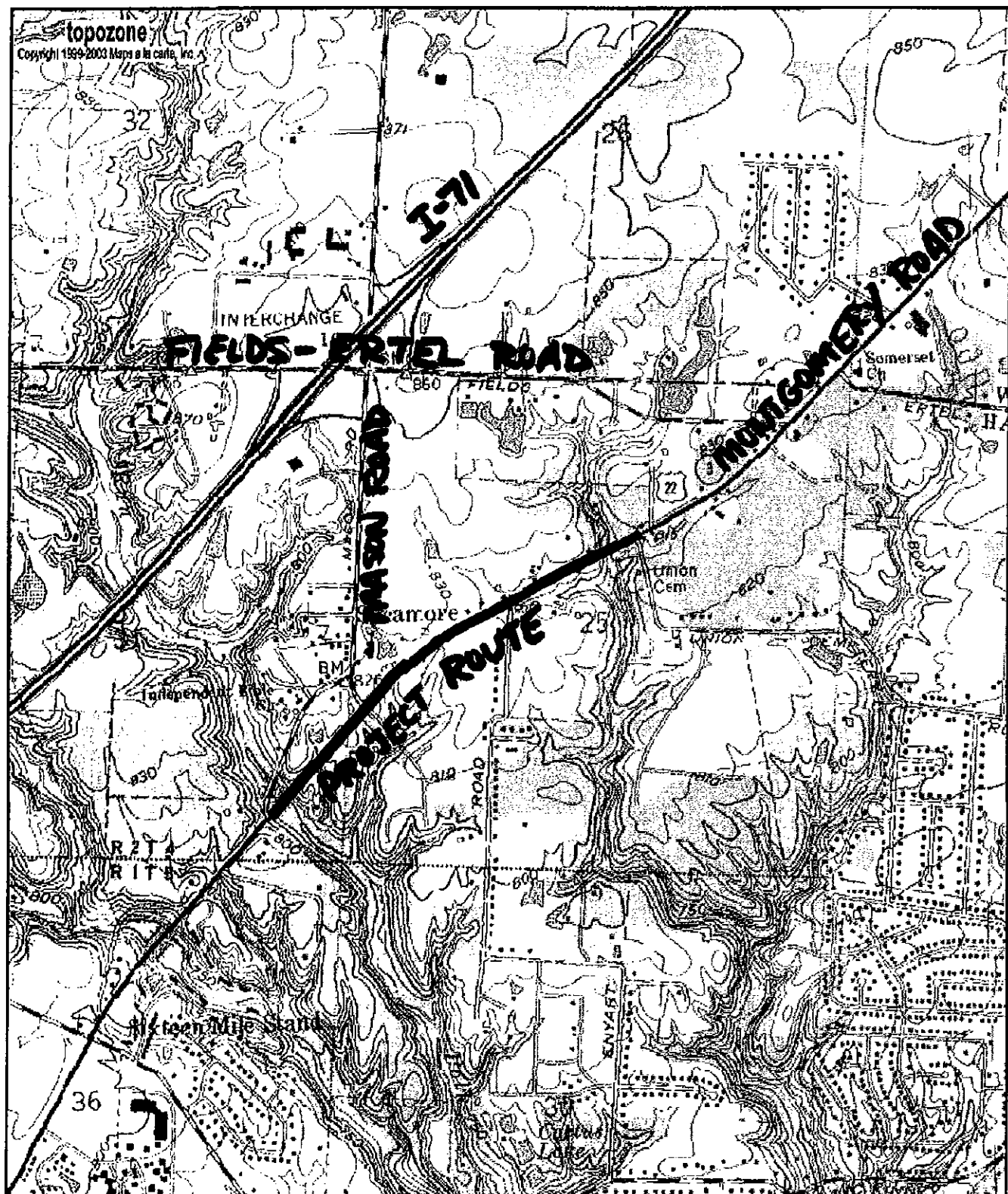

0 0.3 0.6 0.9 1.2 1.5 km
0 0.2 0.4 0.6 0.8 1 mi

UTM 16 731997E 4351914N (NAD83/WGS84)

USGS Mason (OH) Quadrangle

Projection is UTM Zone 16 NAD83 Datum



M=-5.409
G=1.704

LOCATION RI-MONTGOMERY RD. N/O CALUMET WAY / PHASE 4

DATE 10-30-07 CITY/TWP SYMMES TWP. DATE 10-30-07
 CUTIN DATE 1-01-09

ORIGINATED FROM 000T PID# 75880

PROJECT PURPOSE RELOCATE OVERHEAD & UNDERGROUND ELECTRIC FOR ROAD IMPROVEMENT

DISTRIBUTION DESIGN EAST

REV	DATE	BY	CHKD	DESCRIPTION
1	10-30-07	ARON WRIGHT		ISSUED FOR CONSTRUCTION
2	10-30-07	MIKE KOEHLER		REVISIONS
3	10-30-07	MIKE KOEHLER		REVISIONS
4	10-30-07	MIKE KOEHLER		REVISIONS

502 - BRECON

*Constr. Resd. Center

*Add. Constr. Resd. Ctr

*Contractor

800 - DIST.

650 - TRANS.

EXPENSE

367

367

367

367

367

367

367

367

367

367

367

367

367

367

367

367

367

367

367

367

367

367

367

367

367

367

367

367

367

367

367

367

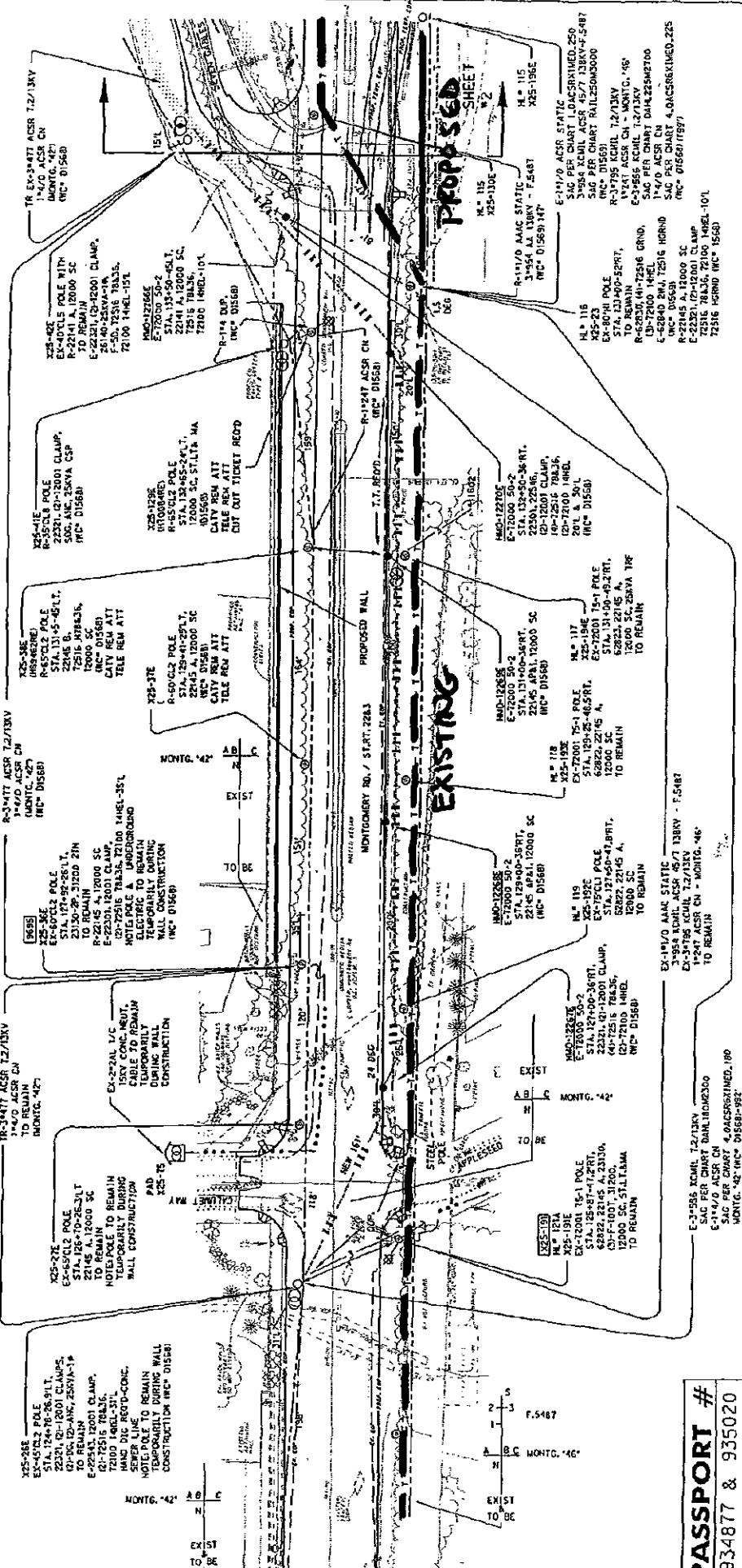

PASSPORT #
 934877 & 935020

LOCATION RI-MONTGOMERY RD./N/O CALUMET WAY / PHASE 4

MONTGOMERY '42' TWENTY MILE '41'
 FEEDER MONTGOMERY '46' F. 5487
 PURPOSE RELOCATE OVERHEAD & UNDERGROUND ELECTRIC FOR ROAD IMPROVEMENT

CITY/TWP SYMMES TWP.
 DATE 10-30-07
 CUTIN DATE 1-01-09

COORD PID# 75880

Duke Energy

DISTRIBUTION DESIGN EAST

App'd by: *Constr. Resp. Center
 502 - BRECON

Rev.	DATE	DESCRIPTION	BY	CHKD
1	10-30-07	INITIAL DESIGN	JW	
2	11-01-09	REVISION INFO	JW	

NO.	DATE	REVISION
1	10-30-07	INITIAL DESIGN
2	11-01-09	REVISION INFO

NO.	DATE	REVISION
1	10-30-07	INITIAL DESIGN
2	11-01-09	REVISION INFO

NO.	DATE	REVISION
1	10-30-07	INITIAL DESIGN
2	11-01-09	REVISION INFO

NO.	DATE	REVISION
1	10-30-07	INITIAL DESIGN
2	11-01-09	REVISION INFO

NO.	DATE	REVISION
1	10-30-07	INITIAL DESIGN
2	11-01-09	REVISION INFO

NO.	DATE	REVISION
1	10-30-07	INITIAL DESIGN
2	11-01-09	REVISION INFO

NO.	DATE	REVISION
1	10-30-07	INITIAL DESIGN
2	11-01-09	REVISION INFO

NO.	DATE	REVISION
1	10-30-07	INITIAL DESIGN
2	11-01-09	REVISION INFO

NO.	DATE	REVISION
1	10-30-07	INITIAL DESIGN
2	11-01-09	REVISION INFO

NO.	DATE	REVISION
1	10-30-07	INITIAL DESIGN
2	11-01-09	REVISION INFO

NO.	DATE	REVISION
1	10-30-07	INITIAL DESIGN
2	11-01-09	REVISION INFO

NO.	DATE	REVISION
1	10-30-07	INITIAL DESIGN
2	11-01-09	REVISION INFO

NO.	DATE	REVISION
1	10-30-07	INITIAL DESIGN
2	11-01-09	REVISION INFO

NO.	DATE	REVISION
1	10-30-07	INITIAL DESIGN
2	11-01-09	REVISION INFO

NO.	DATE	REVISION
1	10-30-07	INITIAL DESIGN
2	11-01-09	REVISION INFO

NO.	DATE	REVISION
1	10-30-07	INITIAL DESIGN
2	11-01-09	REVISION INFO

NO.	DATE	REVISION
1	10-30-07	INITIAL DESIGN
2	11-01-09	REVISION INFO

NO.	DATE	REVISION
1	10-30-07	INITIAL DESIGN
2	11-01-09	REVISION INFO

NO.	DATE	REVISION
1	10-30-07	INITIAL DESIGN
2	11-01-09	REVISION INFO

NO.	DATE	REVISION
1	10-30-07	INITIAL DESIGN
2	11-01-09	REVISION INFO

NO.	DATE	REVISION
1	10-30-07	INITIAL DESIGN
2	11-01-09	REVISION INFO

NO.	DATE	REVISION
1	10-30-07	INITIAL DESIGN
2	11-01-09	REVISION INFO

NO.	DATE	REVISION
1	10-30-07	INITIAL DESIGN
2	11-01-09	REVISION INFO

NO.	DATE	REVISION
1	10-30-07	INITIAL DESIGN
2	11-01-09	REVISION INFO

NO.	DATE	REVISION
1	10-30-07	INITIAL DESIGN
2	11-01-09	REVISION INFO

NO.	DATE	REVISION
1	10-30-07	INITIAL DESIGN
2	11-01-09	REVISION INFO

NO.	DATE	REVISION
1	10-30-07	INITIAL DESIGN
2	11-01-09	REVISION INFO

NO.	DATE	REVISION
1	10-30-07	INITIAL DESIGN
2	11-01-09	REVISION INFO

NO.	DATE	REVISION
1	10-30-07	INITIAL DESIGN
2	11-01-09	REVISION INFO

NO.	DATE	REVISION
1	10-30-07	INITIAL DESIGN
2	11-01-09	REVISION INFO

NO.	DATE	REVISION
1	10-30-07	INITIAL DESIGN
2	11-01-09	REVISION INFO

NO.	DATE	REVISION
1	10-30-07	INITIAL DESIGN
2	11-01-09	REVISION INFO

NO.	DATE	REVISION
1	10-30-07	INITIAL DESIGN
2	11-01-09	REVISION INFO

NO.	DATE	REVISION
1	10-30-07	INITIAL DESIGN
2	11-01-09	REVISION INFO

NO.	DATE	REVISION
1	10-30-07	INITIAL DESIGN
2	11-01-09	REVISION INFO

NO.	DATE	REVISION
1	10-30-07	INITIAL DESIGN
2	11-01-09	REVISION INFO

NO.	DATE	REVISION
1	10-30-07	INITIAL DESIGN
2	11-01-09	REVISION INFO

NO.	DATE	REVISION
1	10-30-07	INITIAL DESIGN
2	11-01-09	REVISION INFO

NO.	DATE	REVISION
1	10-30-07	INITIAL DESIGN
2	11-01-09	REVISION INFO

NO.	DATE	REVISION
1	10-30-07	INITIAL DESIGN
2	11-01-09	REVISION INFO

NO.	DATE	REVISION
1	10-30-07	INITIAL DESIGN
2	11-01-09	REVISION INFO

NO.	DATE	REVISION
1	10-30-07	INITIAL DESIGN
2	11-01-09	REVISION INFO

NO.	DATE	REVISION
1	10-30-07	INITIAL DESIGN
2	11-01-09	REVISION INFO

NO.	DATE	REVISION
1	10-30-07	INITIAL DESIGN
2	11-01-09	REVISION INFO

NO.	DATE	REVISION
1	10-30-07	INITIAL DESIGN
2	11-01-09	REVISION INFO

NO.	DATE	REVISION
1	10-30-07	INITIAL DESIGN
2	11-01-09	REVISION INFO

NO.	DATE	REVISION
1	10-30-07	INITIAL DESIGN
2	11-01-09	REVISION INFO

NO.	DATE	REVISION
1	10-30-07	INITIAL DESIGN
2	11-01-09	REVISION INFO

NO.	DATE	REVISION
1	10-30-07	INITIAL DESIGN
2	11-01-09	REVISION INFO

NO.	DATE	REVISION
1	10-30-07	INITIAL DESIGN
2	11-01-09	REVISION INFO

NO.	DATE	REVISION
1	10-30-07	INITIAL DESIGN
2	11-01-09	REVISION INFO

NO.	DATE	REVISION
1	10-30-07	INITIAL DESIGN
2	11-01-09	REVISION INFO

NO.	DATE	REVISION
1	10-30-07	INITIAL DESIGN
2	11-01-09	REVISION INFO

NO.	DATE	REVISION
1	10-30-07	INITIAL DESIGN
2	11-01-09	REVISION INFO

NO.	DATE	REVISION
1	10-30-07	INITIAL DESIGN
2	11-01-09	REVISION INFO

NO.	DATE	REVISION
1	10-30-07	INITIAL DESIGN
2	11-01-09	REVISION INFO

NO.	DATE	REVISION
1	10-30-07	INITIAL DESIGN
2	11-01-09	REVISION INFO

NO.	DATE	REVISION
1	10-30-07	INITIAL DESIGN
2	11-01-09	REVISION INFO

NO.	DATE	REVISION
1	10-30-07	INITIAL DESIGN
2	11-01-09	REVISION INFO

NO.	DATE	REVISION
1	10-30-07	INITIAL DESIGN
2	11-01-09	REVISION INFO

NO.	DATE	REVISION
1	10-30-07	INITIAL DESIGN
2	11-01-09	REVISION INFO

NO.	DATE	REVISION
1	10-30-07	INITIAL DESIGN
2	11-01-09	REVISION INFO

NO.	DATE	REVISION
1	10-30-07	INITIAL DESIGN
2	11-01-09	REVISION INFO

NO.	DATE	REVISION
1	10-30-07	INITIAL DESIGN
2	11-01-09	REVISION INFO

NO.	DATE	REVISION
1	10-30-07	INITIAL DESIGN
2	11-01-09	REVISION INFO

NO.	DATE	REVISION
1	10-30-07	INITIAL DESIGN
2	11-01-09	REVISION INFO

NO.	DATE	REVISION
1	10-30-07	INITIAL DESIGN
2	11-01-09	REVISION INFO

NO.	DATE	REVISION
1	10-30-07	INITIAL DESIGN
2	11-01-09	REVISION INFO

NO.	DATE	REVISION
1	10-30-07	INITIAL DESIGN
2	11-01-09	REVISION INFO

NO.	DATE	REVISION
1	10-30-07	INITIAL DESIGN
2	11-01-09	REVISION INFO

NO.	DATE	REVISION
1	10-30-07	INITIAL DESIGN
2	11-01-09	REVISION INFO

NO.	DATE	REVISION
1	10-30-07	INITIAL DESIGN
2	11-01-09	REVISION INFO

NO.	DATE	REVISION
1	10-30-07	INITIAL DESIGN
2	11-01-09	REVISION INFO

NO.	DATE	REVISION
1	10-30-07	INITIAL DESIGN
2	11-01-09	REVISION INFO

NO.	DATE	REVISION
1	10-30-07	INITIAL DESIGN
2	11-01-09	REVISION INFO

NO.	DATE	REVISION
1	10-30-07	INITIAL DESIGN
2	11-01-09	REVISION INFO

NO.	DATE	REVISION
1	10-30-07	INITIAL DESIGN
2	11-01-09	REVISION INFO

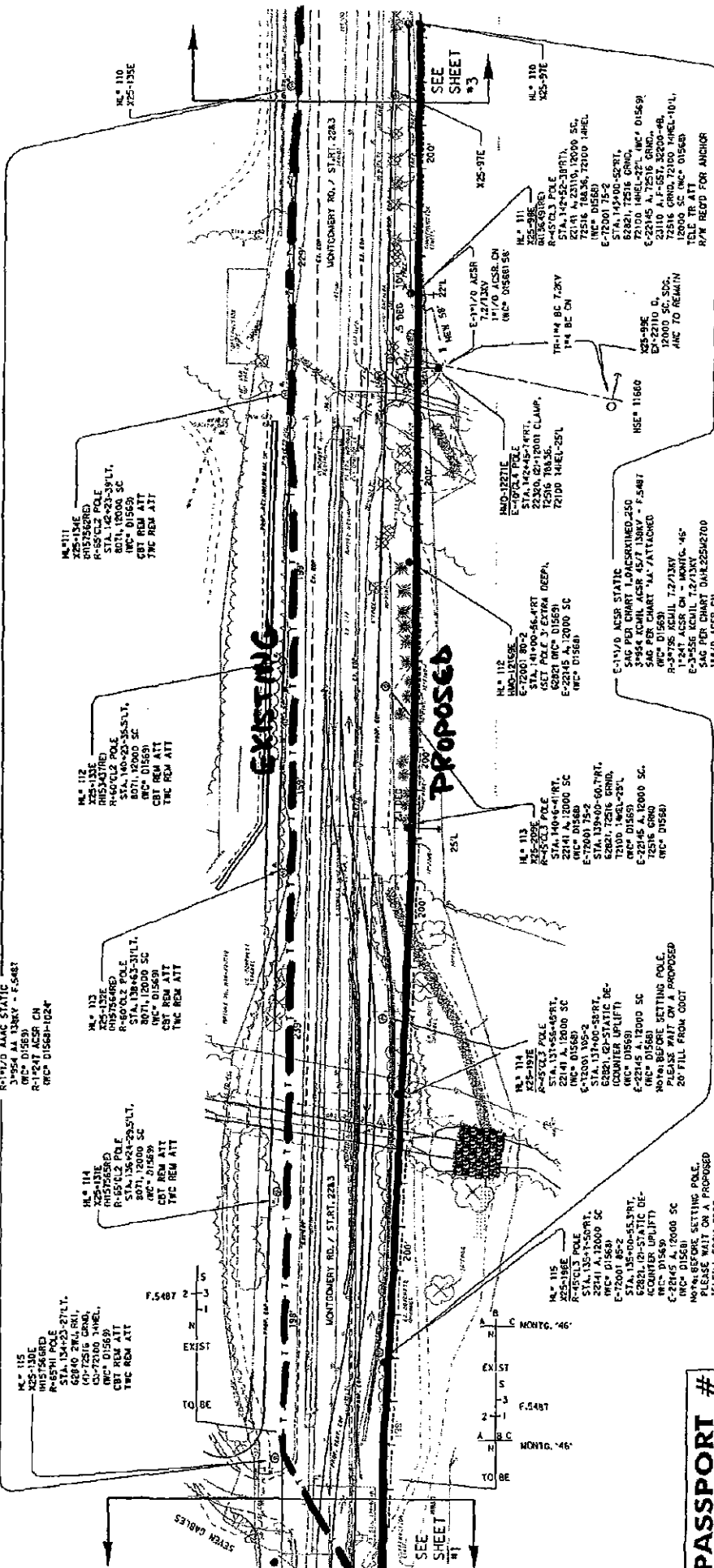

PASSPORT #
 934877 & 935020

LOCATION RI-MONTGOMERY RD. N/O CALUMET WAY / PHASE 4

DATE 10-30-07 CITY/TWP SYMMES TWP. DATE 10-30-07
 CUTOIN DATE 1-01-09

COOT PID# 75880 ORIGINATED FROM

DISTRIBUTION DESIGN EAST									
									
Techn. AARON MIGHT		WSP No.	X25 Y26	J-L Ref.	2007CE202081 2007CE201001N 2007CE201005N	Instal	Work Codes	Labor Hrs.	DRAWING
Tel. 237-3574		Tool Dist.	H-37 (8500)	R/R Req'd.	YES	Remove	D156CROLG - DIST.	2689	934877-4 & 935020-4 REVISION INFO
Eng. MIKE KOEHLER		Proj. No.		Permit	YES - ODOT	Instal	D156CROLG - TRANS	1319	
				Trim Trans.	YES	Remove	D156CROLG - TRANS	1694	
				Dist Equip. Req'd.	NO	Expense	D156BDDML - DIST	768	
Add'l by:		Eng. Resp. Ctr.	ID6					315	
*Const., Resp. Center		*Add, Constr. Resp. Ctr			*Contractor	800 - DIST. 500 - TRANS.	D1569TOML - TRANS	70	
502 - BRECON							JTON - OAKLEY	167	Personnel Notes/Report system change when required

RI-MONTGOMERY RD. N/O CALUMET WAY / PHASE 4

LOCATION: RI-MONTGOMERY RD. N/O CALUMET WAY / PHASE 4
 DATE: 10-30-07
 CITY/TWP: SYMMES TWP.
 CUTOIN DATE: 1-01-09

REVISION: ☒ DUK-CH ☒ MONTGOMERY '42' TWENTY MILE '41'
☒ DUK-KY ☒ FEEDER MONTGOMERY '46' F. 5487
☒ DUK-IN ☒ PURPOSE RELOCATE OVERHEAD & UNDERGROUND ELECTRIC FOR ROAD IMPROVEMENT

NO.	DATE	REVISION
1	10-30-07	934877-6 & 935020-6
2	10-30-07	934877-6 & 935020-6
3	10-30-07	934877-6 & 935020-6
4	10-30-07	934877-6 & 935020-6

502 - BRECON

502 - BRECON

502 - BRECON

502 - BRECON

502 - BRECON

502 - BRECON

502 - BRECON

502 - BRECON

502 - BRECON

502 - BRECON

502 - BRECON

502 - BRECON

502 - BRECON

502 - BRECON

502 - BRECON

502 - BRECON

502 - BRECON

502 - BRECON

502 - BRECON

502 - BRECON

502 - BRECON

502 - BRECON

502 - BRECON

502 - BRECON

502 - BRECON

502 - BRECON

502 - BRECON

502 - BRECON

502 - BRECON

502 - BRECON

502 - BRECON

502 - BRECON

502 - BRECON

502 - BRECON

502 - BRECON

502 - BRECON

502 - BRECON

502 - BRECON

502 - BRECON

502 - BRECON

502 - BRECON

502 - BRECON

502 - BRECON

502 - BRECON

502 - BRECON

502 - BRECON

502 - BRECON

502 - BRECON

502 - BRECON

502 - BRECON

502 - BRECON

502 - BRECON

502 - BRECON

502 - BRECON

502 - BRECON

DUKE ENERGY

TECH: ALAN WRIGHT

TEL: 287-3674

ENG: MIKE KOEHLER

APPROVED BY: [Signature]

*CONSTR. RESP. CTR

502 - BRECON

502 - BRECON

502 - BRECON

502 - BRECON

502 - BRECON

502 - BRECON

502 - BRECON

502 - BRECON

502 - BRECON

502 - BRECON

502 - BRECON

502 - BRECON

502 - BRECON

502 - BRECON

502 - BRECON

502 - BRECON

502 - BRECON

502 - BRECON

502 - BRECON

502 - BRECON

502 - BRECON

502 - BRECON

502 - BRECON

502 - BRECON

502 - BRECON

502 - BRECON

502 - BRECON

502 - BRECON

502 - BRECON

502 - BRECON

502 - BRECON

502 - BRECON

502 - BRECON

502 - BRECON

502 - BRECON

502 - BRECON

502 - BRECON

502 - BRECON

502 - BRECON

502 - BRECON

502 - BRECON

502 - BRECON

502 - BRECON

502 - BRECON

502 - BRECON

502 - BRECON

502 - BRECON

502 - BRECON

502 - BRECON

502 - BRECON

502 - BRECON

502 - BRECON

502 - BRECON

502 - BRECON

502 - BRECON

502 - BRECON

DISTRIBUTION DESIGN EAST

200702070207 200702070207

200702070207 200702070207

200702070207 200702070207

200702070207 200702070207

200702070207 200702070207

200702070207 200702070207

200702070207 200702070207

200702070207 200702070207

200702070207 200702070207

200702070207 200702070207

200702070207 200702070207

200702070207 200702070207

200702070207 200702070207

200702070207 200702070207

200702070207 200702070207

200702070207 200702070207

200702070207 200702070207

200702070207 200702070207

200702070207 200702070207

200702070207 200702070207

200702070207 200702070207

200702070207 200702070207

200702070207 200702070207

200702070207 200702070207

200702070207 200702070207

200702070207 200702070207

200702070207 200702070207

200702070207 200702070207

200702070207 200702070207

200702070207 200702070207

200702070207 200702070207

200702070207 200702070207

200702070207 200702070207

200702070207 200702070207

200702070207 200702070207

200702070207 200702070207

200702070207 200702070207

200702070207 200702070207

200702070207 200702070207

200702070207 200702070207

200702070207 200702070207

200702070207 200702070207

200702070207 200702070207

200702070207 200702070207

200702070207 200702070207

200702070207 200702070207

200702070207 200702070207

200702070207 200702070207

200702070207 200702070207

200702070207 200702070207

200702070207 200702070207

200702070207 200702070207

200702070207 200702070207

200702070207 200702070207

200702070207 200702070207

200702070207 200702070207

200702070207 200702070207

200702070207 200702070207

200702070207 200702070207

200702070207 200702070207

200702070207 200702070207

WORK CODES

01568CICLG - DIST.

01568CICLG - DIST.

01568CICLG - TRANS.

01568CICLG - TRANS.

01568CICLG - TRANS.

01568CICLG - TRANS.

01568CICLG - TRANS.

01568CICLG - TRANS.

01568CICLG - TRANS.

01568CICLG - TRANS.

01568CICLG - TRANS.

01568CICLG - TRANS.

01568CICLG - TRANS.

01568CICLG - TRANS.

01568CICLG - TRANS.

01568CICLG - TRANS.

01568CICLG - TRANS.

01568CICLG - TRANS.

01568CICLG - TRANS.

01568CICLG - TRANS.

01568CICLG - TRANS.

01568CICLG - TRANS.

01568CICLG - TRANS.

01568CICLG - TRANS.

01568CICLG - TRANS.

01568CICLG - TRANS.

01568CICLG - TRANS.

01568CICLG - TRANS.

01568CICLG - TRANS.

01568CICLG - TRANS.

01568CICLG - TRANS.

01568CICLG - TRANS.

01568CICLG - TRANS.

01568CICLG - TRANS.

01568CICLG - TRANS.

01568CICLG - TRANS.

01568CICLG - TRANS.

01568CICLG - TRANS.

01568CICLG - TRANS.

01568CICLG - TRANS.

01568CICLG - TRANS.

01568CICLG - TRANS.

01568CICLG - TRANS.

01568CICLG - TRANS.

01568CICLG - TRANS.

01568CICLG - TRANS.

01568CICLG - TRANS.

01568CICLG - TRANS.

01568CICLG - TRANS.

01568CICLG - TRANS.

01568CICLG - TRANS.

01568CICLG - TRANS.

01568CICLG - TRANS.

01568CICLG - TRANS.

01568CICLG - TRANS.

01568CICLG - TRANS.

01568CICLG - TRANS.

01568CICLG - TRANS.

01568CICLG - TRANS.

01568CICLG - TRANS.

01568CICLG - TRANS.

CITY/TWP. SYMMES TWP. DATE 10-30-07

CUTIN 1-01-09

DATE _____

-7 & 935020-7

VISION INFO

Completed

When required

R-3477 ACSR
10247 ACSR (1/2000 DISE)

E-3-556 KCWIR
SAG PER CHA

E-1-A/D ACSR
SAC PER CHA

WILLIAM L. BROWN,
DEEP,
SC.

10

20d
20a

04E
21.3 POLE

108*18-24-L1,
1 A. 23130.
RISER, 12000 SC

OD 50-2, POLE CAND.
188-21-43.7'LY

POLE 14 DEEP.
1 A 1200 SC.
0. F-657. 31200 4"

DI558)
TR ATT

ERRORS
2A

U. = 2

TRANS
R-302AL
NEUT C

INSTALL
(35' x 18')

10

⑤

10

SHS

88

②

4 WIRE
20V

TR-3

Sl
MON
21

1100



DUKE ENERGY CORPORATION
139 East Fourth St.
PO Box 960
Cincinnati, OH 45201-0960

December 14, 2007

Natural Resources Management
Room 409A
139 East Fourth Street
Cincinnati, Ohio 45202

Ron Miller, FAICP-Executive Director,
Hamilton County Planning Commission,
County Administration Building – Room 807
138 East Court Street
Cincinnati, OH 45202

Dear Mr. Miller:

RE: Montgomery Road 138kV Transmission Line Relocation Project Phase II

Please find enclosed a copy of a Construction Notice Duke Energy sent to the Ohio Power Siting Board regarding the relocation of a 138,000 volt (138 kV) transmission line located along Montgomery Road between Seven Gables and Union Cemetery Roads in Symmes Township. This project has been requested by ODOT in preparation for widening Montgomery Road. The Duke Energy project will be located entirely within existing road right-of-way.

In accordance with Ohio Administrative Code (OAC) 4906-1-01 Appendix A, we are required to prepare this Construction Notice for the Ohio Power Siting Board and in compliance with OAC 4906-11-02(B), we are hereby providing you with a copy. Please feel free to call me at 287-2379 if you have any questions about this project.

Sincerely,
Duke Energy Ohio

Stephen R. Lane
Environmental Scientist

Enclosure

Cc Eric Minamy, President, Symmes Township Trustees,



DUKE ENERGY CORPORATION
139 East Fourth St.
PO Box 960
Cincinnati, OH 45201-0960

December 14, 2007

Natural Resources Management
Room 409A
139 East Fourth Street
Cincinnati, Ohio 45202

Eric Minamy, President, Symmes Township Trustees,
Symmes Township Administration Offices,
9323 Union Cemetery Road
Loveland, Ohio 45140

Dear Mr. Minamy:

RE: Montgomery Road 138kV Transmission Line Relocation Project Phase II

Please find enclosed a copy of a Construction Notice Duke Energy sent to the Ohio Power Siting Board regarding the relocation of a 138,000 volt (138 kV) transmission line located along Montgomery Road between Seven Gables and Union Cemetery Roads in Symmes Township. This project has been requested by ODOT in preparation for widening Montgomery Road. The Duke Energy project will be located entirely within existing road right-of-way.

In accordance with Ohio Administrative Code (OAC) 4906-1-01 Appendix A, we are required to prepare this Construction Notice for the Ohio Power Siting Board and in compliance with OAC 4906-11-02(B), we are hereby providing you with a copy. Please feel free to call me at 287-2379 if you have any questions about this project.

Sincerely,
Duke Energy Ohio

Stephen R. Lane
Environmental Scientist

Enclosure

Cc Ron Miller, FAICP-Executive Director, Hamilton County Planning Commission