

REQUEST:

Please provide topographic maps that clearly show the following:

- The centerline of the existing 138kV line to be removed including all of the structures to be removed
- The layout of the proposed ODOT project in terms of how it affects the existing line

RESPONSE:

- The centerline of the existing 138kV line to be removed, including all of the structures to be removed, is shown on the topographic map identified as Attachment A, Figure 1, of the Application filed on August 16, 2019.
- Refer to ODOT Layout – Staff-DR-02-003 Attachment 1.

PERSONS RESPONSIBLE: Dustin Giesler, Cori Jansing, and Jacob Dawn

INDEX OF SHEETS:

TITLE SHEET	1 - 2	SUPERELEVATION TABLES	748 - 767
SCHEMATIC PLAN	3 - 5	INTERCHANGE DETAILS	768 - 781
GEOMETRIC PLAN	6 - 13	PAVEMENT ELEVATION DETAILS	782
TYPICAL SECTIONS	14 - 36	DRIVE DETAILS	784
GENERAL NOTES	37 - 48	SUMMIT RD CLRB RAMP DETAILS	785 - 786
MAINTENANCE OF TRAFFIC	52 - 262	DRAINAGE PLANS	787 - 798
GENERAL SUMMARY	263 - 278	STORM SEWER PROFILES	799 - 832
SUB-SUMMARIES AND ESTIMATED COSTS	279 - 320	CULVERT DETAILS	834
PROJECT SITE PLAN	321 - 323	DRAINAGE DETAILS	835 - 839
PLAN AND PROFILE - I.R. 75	324 - 335	GRADING PLANS	840 - 843
PLAN AND PROFILE - RAMP M	336 - 339	RETAINING WALLS	844 - 979
PLAN AND PROFILE - RAMP N	340 - 341	NOISE WALLS	980 - 984
PLAN AND PROFILE - RAMP J	342 - 344	WATER BORN	985 - 988
PLAN AND PROFILE - RAMP K	345 - 346	SAWTOOTH SEWER PROFILES	989 - 1002
PLAN AND PROFILE - RAMP A	347	ROADSIDE BARRIER PLAN	1003 - 1014
PLAN AND PROFILE - RAMP B	348	MISCELLANEOUS DETAILS	1015 - 1017
PLAN AND PROFILE - RAMP C	349 - 350	TRAFFIC CONTROL	1018 - 1084
PLAN AND PROFILE - RAMP D	351 - 353	SIGNAL PLANS	1085 - 1029
PLAN AND PROFILE - RAMP E	354	LIGHTING PLANS	1130 - 1169
PLAN AND PROFILE - S.R. 562	355 - 357	STRUCTURES (20' AND OVER)	
PLAN AND PROFILE - RAMP P	358 - 359	ROADWAY	
PLAN AND PROFILE - RAMP Q	360	HAM-562-0004	1170 - 1227
PLAN AND PROFILE - PROSSER AVE	361	HAM-75-0791	1228 - 1281
PLAN AND PROFILE - TOWNE ST	362 - 363	HAM-75-0823	1282 - 1334
PLAN AND PROFILE - SUMMIT RD	364 - 366	HAM-75-0857	1335 - 1372
PLAN AND PROFILE - PEDESTRIAN PATH	367	HAM-75-0992	1373 - 1389
CROSS SECTION LAYOUT INDEX	368 - 373	RAIL BRIDGE NOTES AND DETAILS	1390 - 1402
CROSS SECTIONS - I.R. 75	374 - 619	RAIL STRUCTURES	
CROSS SECTIONS - RAMP M	620 - 628	HAM-562-0026	1403 - 1459
CROSS SECTIONS - RAMP N	629 - 643	HAM-75-0834	1460 - 1500
CROSS SECTIONS - RAMP J	644 - 664	HAM-PROSR-00.000	1501 - 1515
CROSS SECTIONS - RAMP K	665 - 682	FENCING PLAN	1516 - 1547
CROSS SECTIONS - RAMP A	683 - 688	RIGHT OF WAY PLANS	1548 - 1599
CROSS SECTIONS - RAMP B	689 - 692	RAIL PLANS	1600 - 1716
CROSS SECTIONS - RAMP C	693 - 701	SOIL PROFILES AND STRUCTURE	
CROSS SECTIONS - RAMP D	702 - 714	FOUNDATION EXPLORATION	
CROSS SECTIONS - RAMP E	715 - 718		
CROSS SECTIONS - S.R. 562	719 - 731		
CROSS SECTIONS - RAMP P	732 - 735		
CROSS SECTIONS - RAMP Q	736 - 738		
CROSS SECTIONS - TOWNE ST	739 - 745		
CROSS SECTIONS - CEDAR ST	746 - 747		

11/16/75
 DATE: 11/16/75
 INDEX OF SHEETS

I.R. 75 & S.R. 562 NORWOOD LATERAL PKWY
SCHEMATIC PLAN

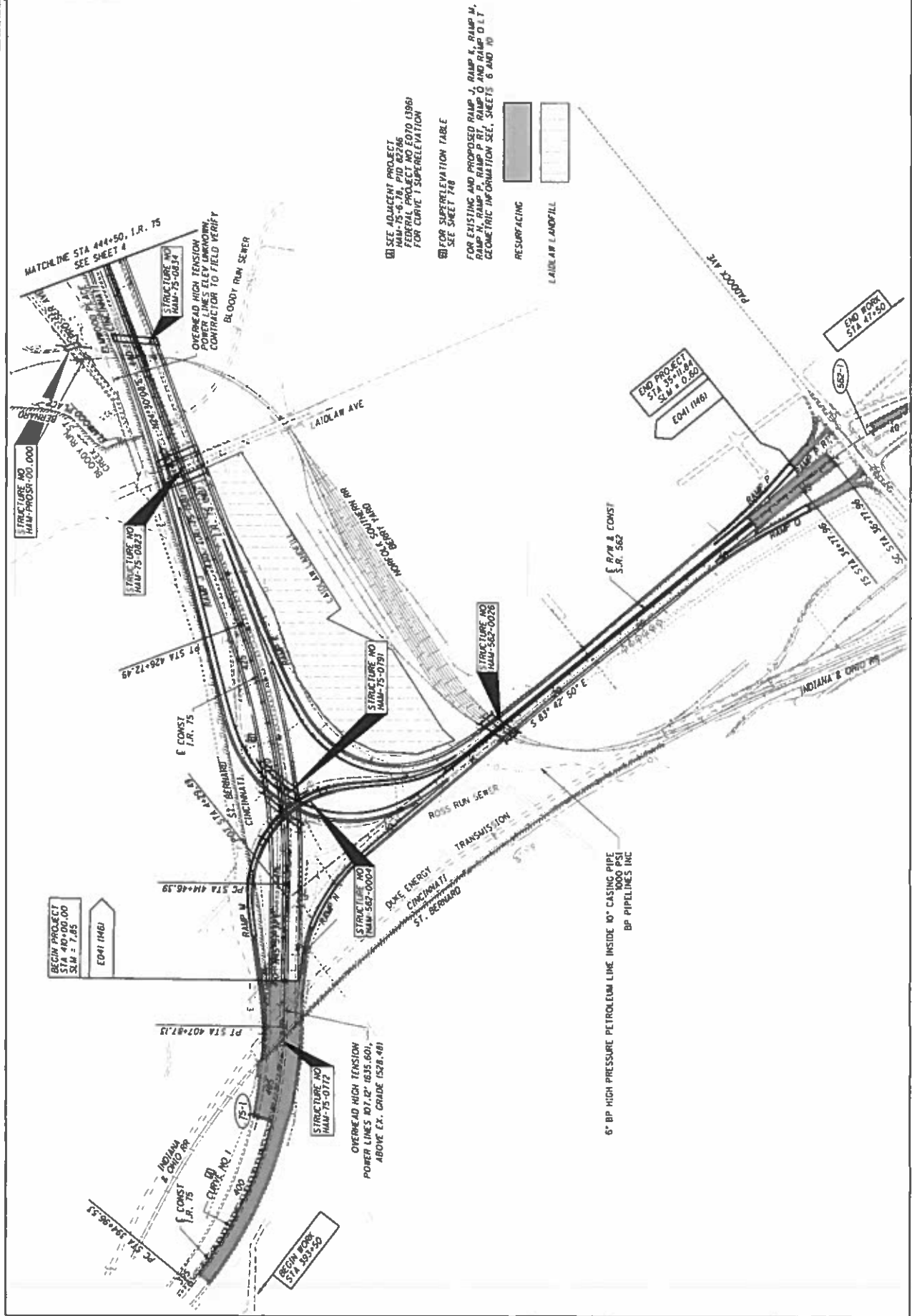

- SEE ADJACENT PROJECT HAM-75-6.78, PID 02286 FEDERAL PROJECT NO E070 (396) FOR CURVE 7 SUPERELEVATION
- FOR SUPERELEVATION TABLE SEE SHEET 748
- FOR EXISTING AND PROPOSED RAMP J, RAMP K, RAMP M, RAMP N, RAMP P, RAMP R, RAMP Q AND RAMP O L.T. GEOMETRIC INFORMATION SEE SHEETS 6 AND 70



BEGIN PROJECT STA 410+00.00 SC.M = 7.285 E041 (146)

6" BP HIGH PRESSURE PETROLEUM LINE INSIDE 10" CASING PIPE 1000 PSI BP PIPELINES INC

1:20100903\0001\HAM\7585\road\lay\sheet17585\7585schematic.dgn 6/17/2016 5:26:33 PM

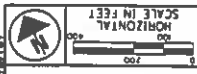

SCHMATIC PLAN I.R. 75

HAM-75-7.85

4
1115

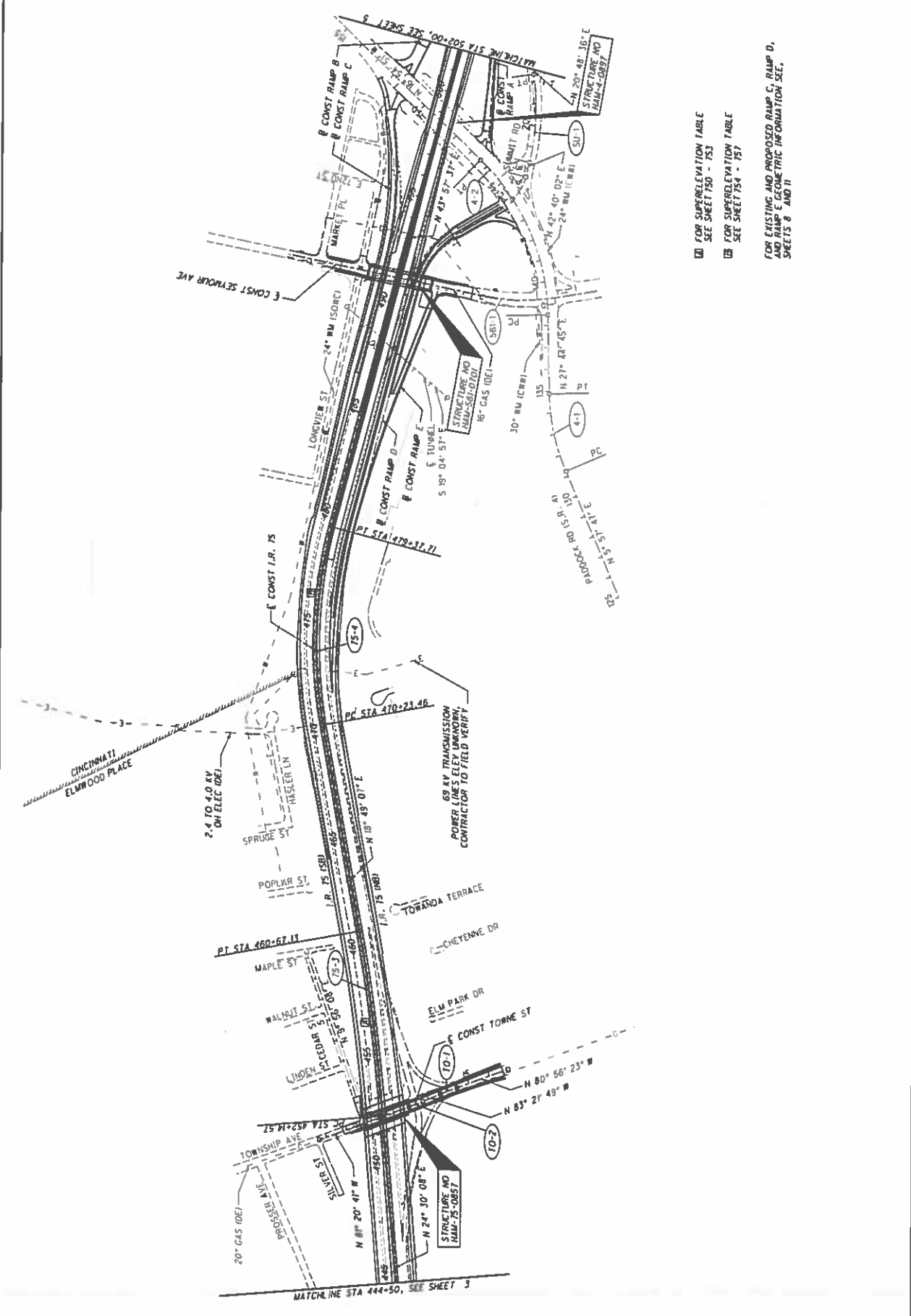

[A] FOR SUPERELEVATION TABLE
 SEE SHEET 750 - 753
 [B] FOR SUPERELEVATION TABLE
 SEE SHEET 754 - 757

FOR EXISTING AND PROPOSED RAMP C, RAMP D,
 AND RAMP E GEOMETRIC INFORMATION SEE
 SHEETS 8 AND 11

PRINTED AND PLOTTED BY: [unreadable]
 DATE: 6/1/2016 3:26:34 PM

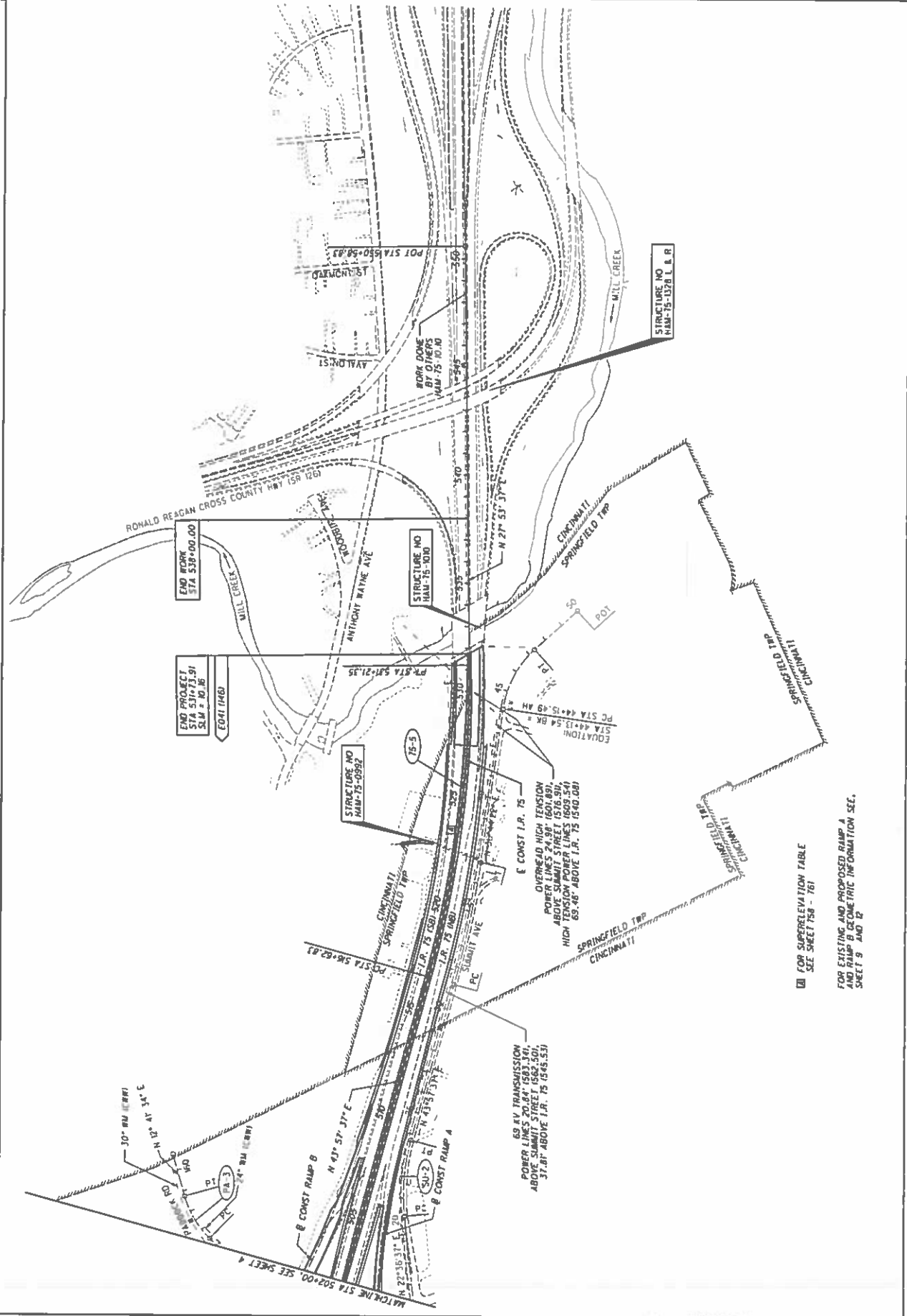

TOP SURVELEVATION TABLE

 SEE SHEET 750 - 761

FOR EXISTING AND PROPOSED RAMP A

 AND RAMP B GEOMETRIC INFORMATION SEE

 SHEET 9 AND 12