

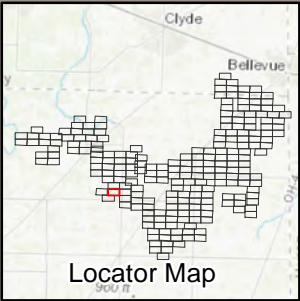

Turbine Location	Field Delineated Pond
Survey	Proposed Collection Line
Upland Datapoint	Proposed Access Road -
Wetland Datapoint	Proposed Access Road - Public
Field Delineated Wetland	ODNR Wetland
Delineated Wetland, Outside Current Survey Area	NWI Wetland
Field Delineated Stream/Ditch	Local Road
Delineated Waterbody, Outside Current Survey Area	State Road
	US Highway



Wetland and Waterbody Maps  
(Sheet 164 of 226)

Republic Wind Project  
Seneca and Sandusky Counties, OH



121 Continental Drive, Suite 308  
Newark, DE 19713 USA  
Phone (+1) 302-395-1919 Fax (+1) 302-395-1920  
[www.cardno.com](http://www.cardno.com)



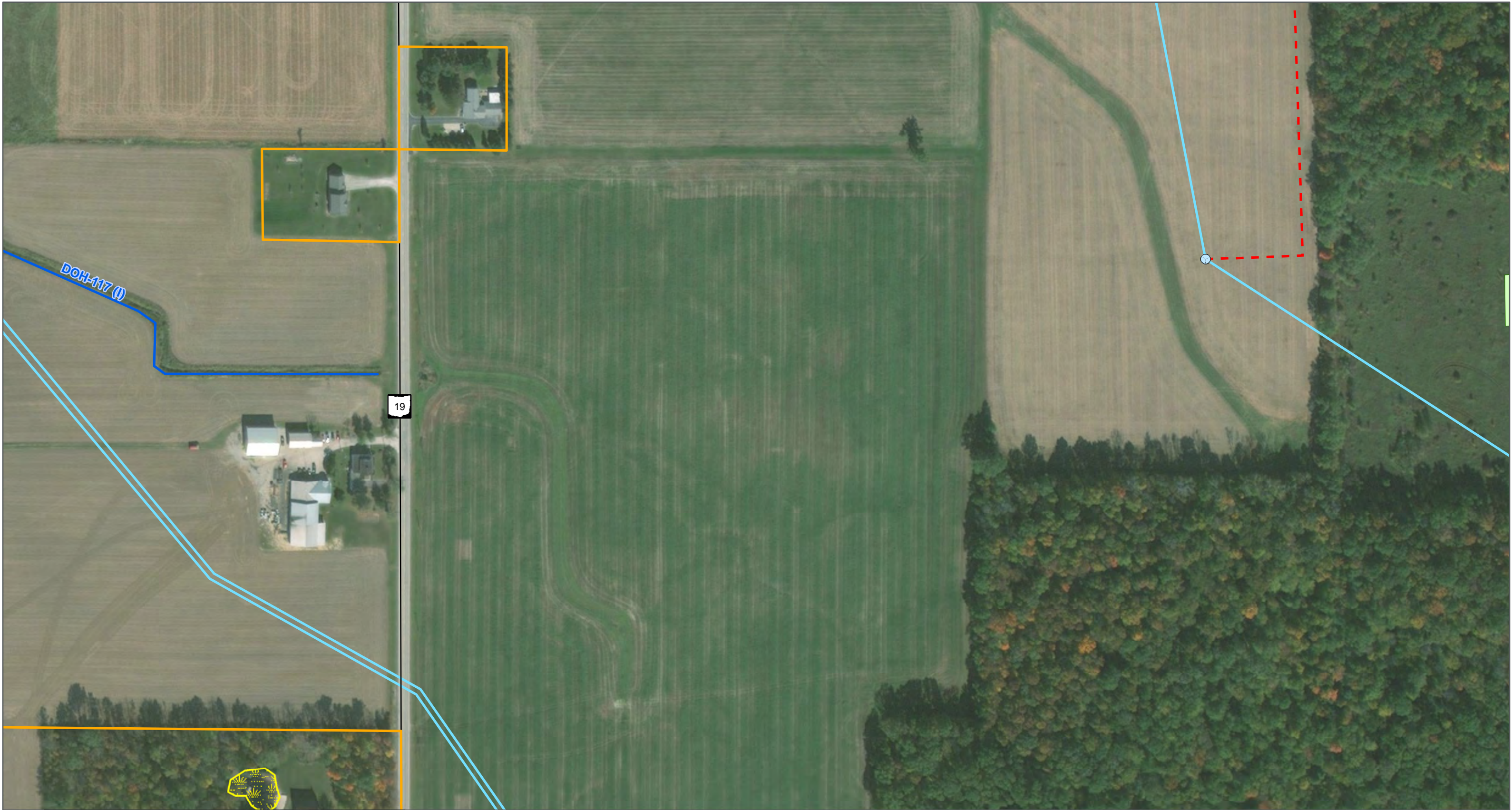

- Turbine Location
- Survey
- Upland Datapoint
- Wetland Datapoint
- Field Delineated Wetland
- Delineated Wetland, Outside Current Survey Area
- Field Delineated Stream/Ditch
- Delineated Waterbody, Outside Current Survey Area
- Field Delineated Pond
- Proposed Collection Line
- Proposed Access Road -
- Proposed Access Road - Public
- ODNR Wetland
- NW1 Wetland
- Local Road
- State Road
- US Highway

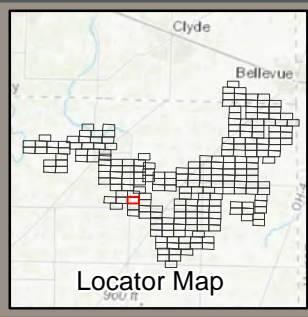

# Wetland and Waterbody Maps (Sheet 165 of 226)

Republic Wind Project  
Seneca and Sandusky Counties, OH



121 Continental Drive, Suite 308  
Newark, DE 19713 USA  
Phone (+1) 302-395-1919 Fax (+1) 302-395-1920  
[www.cardno.com](http://www.cardno.com)



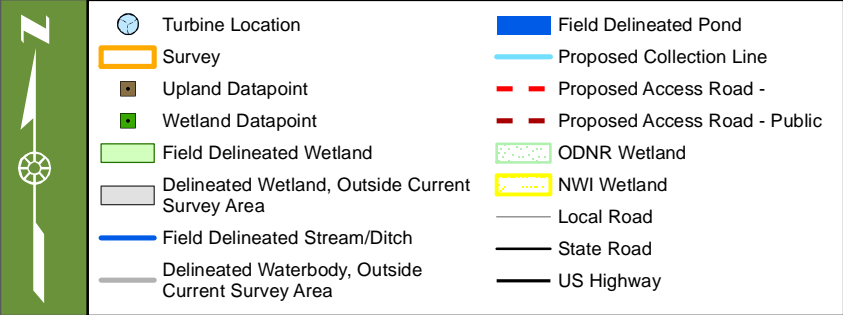
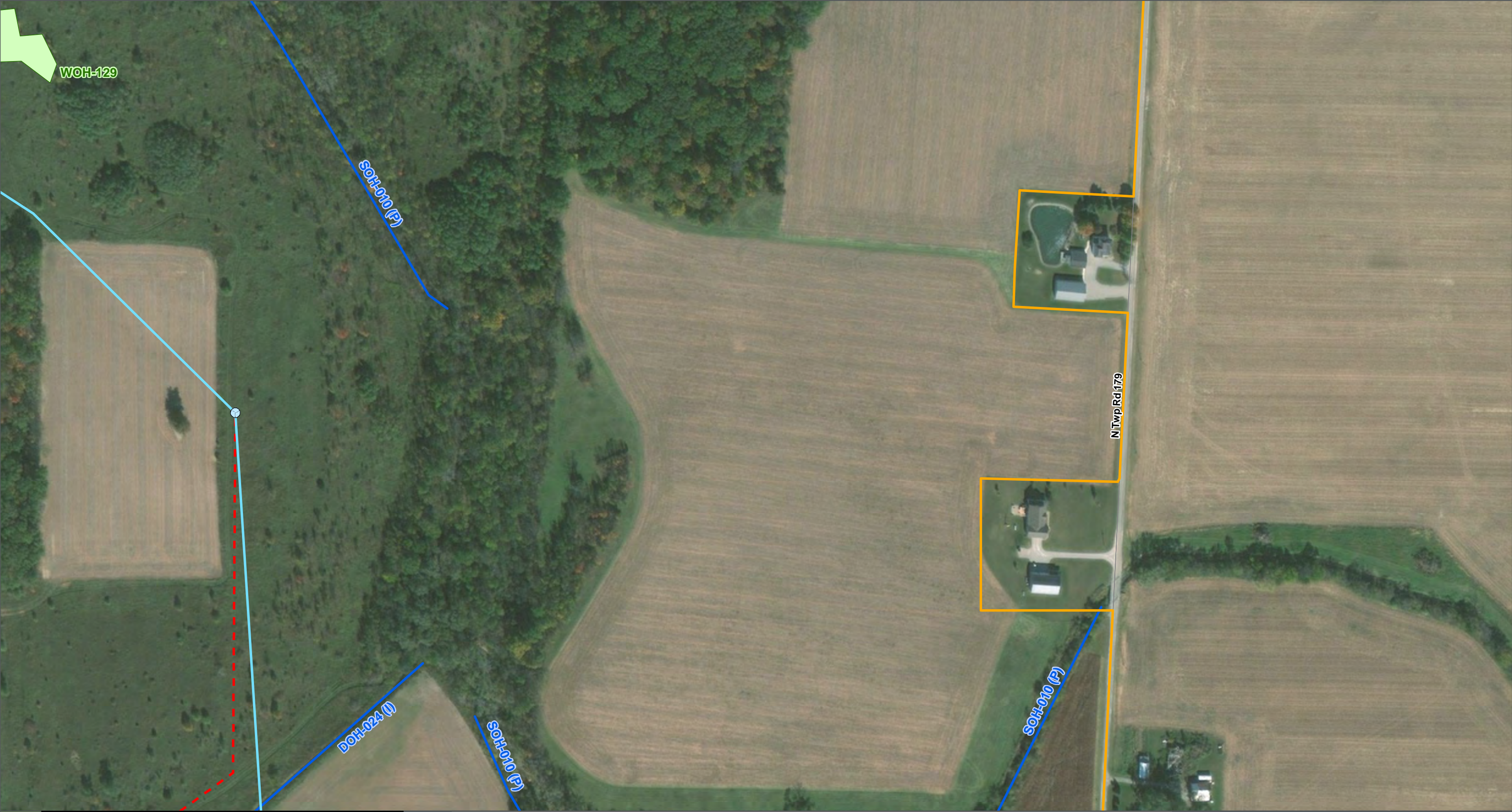

# Wetland and Waterbody Maps (Sheet 166 of 226)

Republic Wind Project  
Seneca and Sandusky Counties, OH



121 Continental Drive, Suite 308  
Newark, DE 19713 USA  
Phone (+1) 302-395-1919 Fax (+1) 302-395-1920  
[www.cardno.com](http://www.cardno.com)







 Turbine Location	 Field Delineated Pond
 Survey	 Proposed Collection Line
 Upland Datapoint	 Proposed Access Road -
 Wetland Datapoint	 Proposed Access Road - Public
 Field Delineated Wetland	 ODNR Wetland
 Delineated Wetland, Outside Current Survey Area	 NWI Wetland
 Field Delineated Stream/Ditch	 Local Road
 Delineated Waterbody, Outside Current Survey Area	 State Road
	 US Highway



# Wetland and Waterbody Maps (Sheet 167 of 226)

Republic Wind Project  
Seneca and Sandusky Counties, OH



121 Continental Drive, Suite 308  
Newark, DE 19713 USA  
Phone (+1) 302-395-1919 Fax (+1) 302-395-1920  
[www.cardno.com](http://www.cardno.com)







 Turbine Location	 Field Delineated Pond
 Survey	 Proposed Collection Line
 Upland Datapoint	 Proposed Access Road - Private
 Wetland Datapoint	 Proposed Access Road - Public
 Field Delineated Wetland	 ODNR Wetland
 Delineated Wetland, Outside Current Survey Area	 NWI Wetland
 Field Delineated Stream/Ditch	 Local Road
 Delineated Waterbody, Outside Current Survey Area	 State Road
	 US Highway



# Wetland and Waterbody Maps (Sheet 168 of 226)

Republic Wind Project  
Seneca and Sandusky Counties, OH



121 Continental Drive, Suite 308  
Newark, DE 19713 USA  
Phone (+1) 302-395-1919 Fax (+1) 302-395-1920  
[www.cardno.com](http://www.cardno.com)



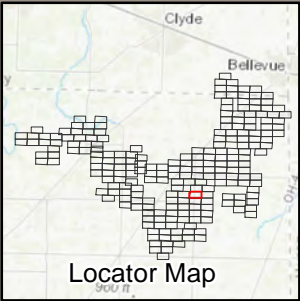
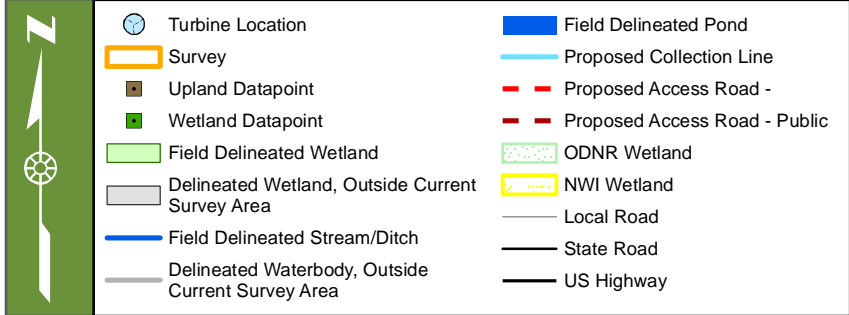

# Wetland and Waterbody Maps (Sheet 169 of 226)

Republic Wind Project  
Seneca and Sandusky Counties, OH



121 Continental Drive, Suite 308  
Newark, DE 19713 USA  
Phone (+1) 302-395-1919 Fax (+1) 302-395-1920  
[www.cardno.com](http://www.cardno.com)





Turbine Location	Field Delineated Pond
Survey	Proposed Collection Line
Upland Datapoint	Proposed Access Road -
Wetland Datapoint	Proposed Access Road - Public
Field Delineated Wetland	ODNR Wetland
Delineated Wetland, Outside Current Survey Area	NWI Wetland
Field Delineated Stream/Ditch	Local Road
Delineated Waterbody, Outside Current Survey Area	State Road
	US Highway



Wetland and Waterbody Maps  
(Sheet 170 of 226)

Republic Wind Project  
Seneca and Sandusky Counties, OH



121 Continental Drive, Suite 308  
Newark, DE 19713 USA  
Phone (+1) 302-395-1919 Fax (+1) 302-395-1920  
[www.cardno.com](http://www.cardno.com)





Turbine Location	Field Delineated Pond
Survey	Proposed Collection Line
Upland Datapoint	Proposed Access Road -
Wetland Datapoint	Proposed Access Road - Public
Field Delineated Wetland	ODNR Wetland
Delineated Wetland, Outside Current Survey Area	NWI Wetland
Field Delineated Stream/Ditch	Local Road
Delineated Waterbody, Outside Current Survey Area	State Road
	US Highway

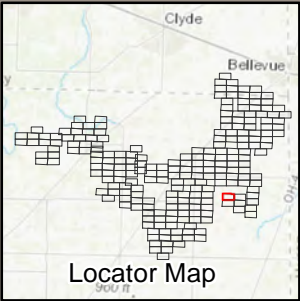

# Wetland and Waterbody Maps (Sheet 171 of 226)

Republic Wind Project  
Seneca and Sandusky Counties, OH



121 Continental Drive, Suite 308  
Newark, DE 19713 USA  
Phone (+1) 302-395-1919 Fax (+1) 302-395-1920  
[www.cardno.com](http://www.cardno.com)





Turbine Location	Field Delineated Pond
Survey	Proposed Collection Line
Upland Datapoint	Proposed Access Road -
Wetland Datapoint	Proposed Access Road - Public
Field Delineated Wetland	ODNR Wetland
Delineated Wetland, Outside Current Survey Area	NWI Wetland
Field Delineated Stream/Ditch	Local Road
Delineated Waterbody, Outside Current Survey Area	State Road
	US Highway

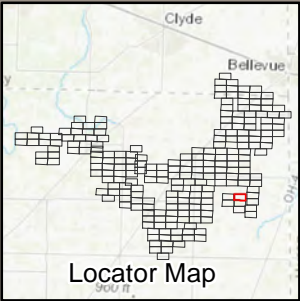

Wetland and Waterbody Maps  
(Sheet 172 of 226)

Republic Wind Project  
Seneca and Sandusky Counties, OH



121 Continental Drive, Suite 308  
Newark, DE 19713 USA  
Phone (+1) 302-395-1919 Fax (+1) 302-395-1920  
[www.cardno.com](http://www.cardno.com)





Turbine Location	Field Delineated Pond
Survey	Proposed Collection Line
Upland Datapoint	Proposed Access Road -
Wetland Datapoint	Proposed Access Road - Public
Field Delineated Wetland	ODNR Wetland
Delineated Wetland, Outside Current Survey Area	NWI Wetland
Field Delineated Stream/Ditch	Local Road
Delineated Waterbody, Outside Current Survey Area	State Road
	US Highway



Wetland and Waterbody Maps  
(Sheet 173 of 226)

Republic Wind Project  
Seneca and Sandusky Counties, OH





121 Continental Drive, Suite 308  
Newark, DE 19713 USA  
Phone (+1) 302-395-1919 Fax (+1) 302-395-1920  
[www.cardno.com](http://www.cardno.com)











 Turbine Location

 Survey

 Upland Datapoint

 Wetland Datapoint

 Field Delineated Wetland

 Delineated Wetland, Outside Current Survey Area

 Field Delineated Stream/Ditch

 Delineated Waterbody, Outside Current Survey Area

 Field Delineated Pond

 Proposed Collection Line

 Proposed Access Road - Private

 Proposed Access Road - Public

 ODNR Wetland

 NWI Wetland

 Local Road

 State Road

 US Highway

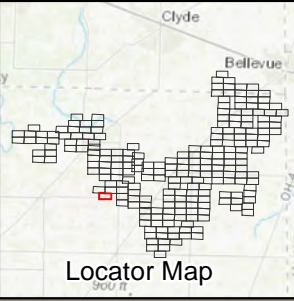

Locator Map

### Wetland and Waterbody Maps

(Sheet 174 of 226)

Republic Wind Project  
Seneca and Sandusky Counties, OH

0

200

400

600

Feet

0

50

100

150

200

Meters



**Cardno**  
Shaping the Future

121 Continental Drive, Suite 308  
Newark, DE 19713 USA  
Phone (+1) 302-395-1919 Fax (+1) 302-395-1920  
[www.cardno.com](http://www.cardno.com)







 Turbine Location	 Field Delineated Pond
 Survey	 Proposed Collection Line
 Upland Datapoint	 Proposed Access Road - Private
 Wetland Datapoint	 Proposed Access Road - Public
 Field Delineated Wetland	 ODNR Wetland
 Delineated Wetland, Outside Current Survey Area	 NWI Wetland
 Field Delineated Stream/Ditch	 Local Road
 Delineated Waterbody, Outside Current Survey Area	 State Road
	 US Highway



# Wetland and Waterbody Maps (Sheet 175 of 226)

Republic Wind Project  
Seneca and Sandusky Counties, OH



121 Continental Drive, Suite 308  
Newark, DE 19713 USA  
Phone (+1) 302-395-1919 Fax (+1) 302-395-1920  
[www.cardno.com](http://www.cardno.com)



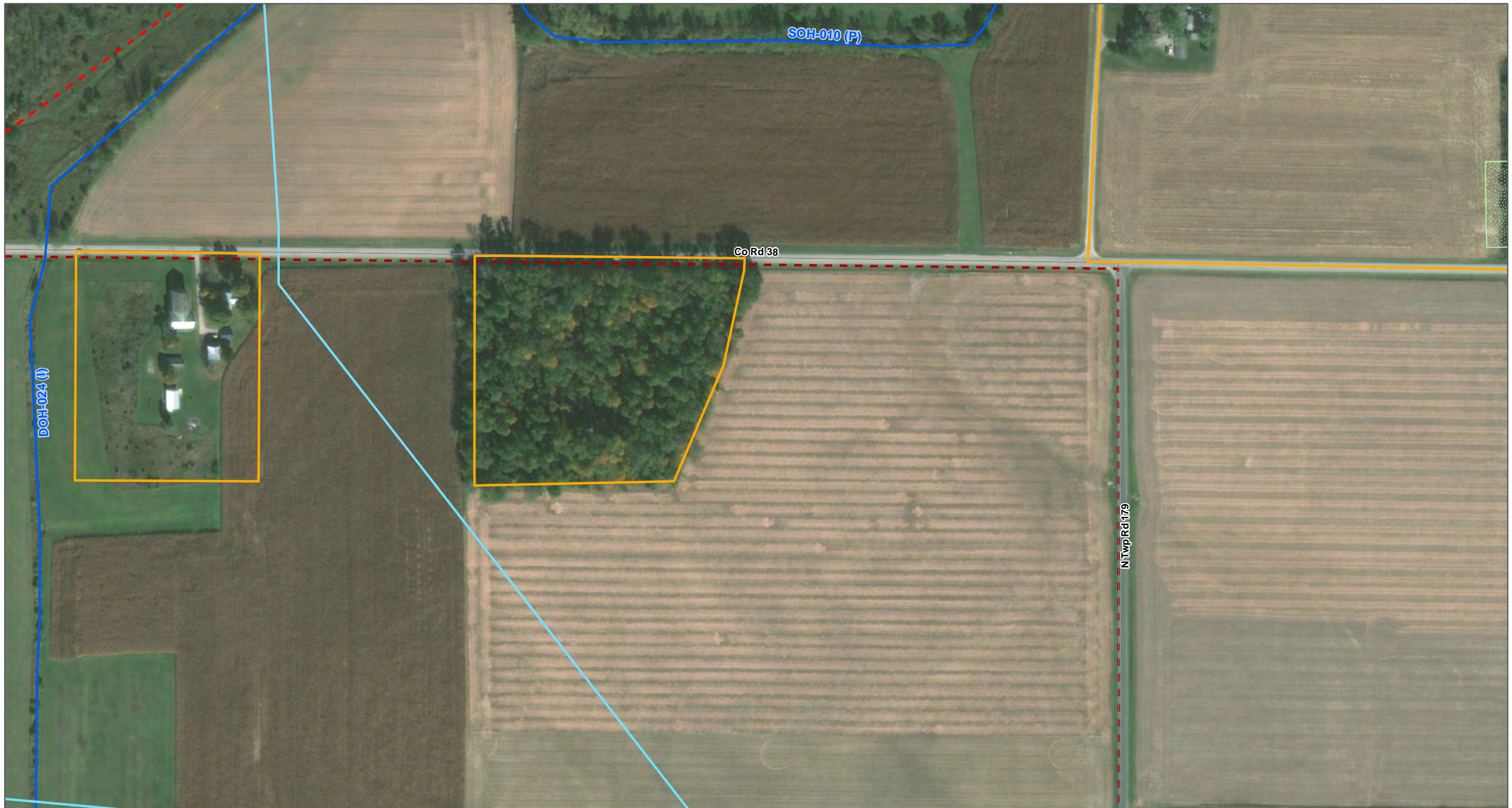

Turbine Location	Field Delineated Pond
Survey	Proposed Collection Line
Upland Datapoint	Proposed Access Road -
Wetland Datapoint	Proposed Access Road - Public
Field Delineated Wetland	ODNR Wetland
Delineated Wetland, Outside Current Survey Area	NWI Wetland
Field Delineated Stream/Ditch	Local Road
Delineated Waterbody, Outside Current Survey Area	State Road
	US Highway

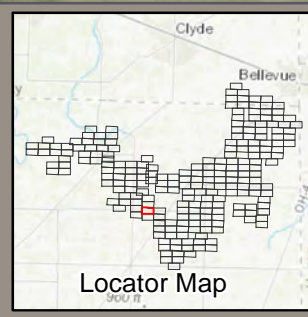

## Wetland and Waterbody Maps (Sheet 176 of 226)

Republic Wind Project  
Seneca and Sandusky Counties, OH



121 Continental Drive, Suite 308  
Newark, DE 19713 USA  
Phone (+1) 302-395-1919 Fax (+1) 302-395-1920  
[www.cardno.com](http://www.cardno.com)





Turbine Location	Field Delineated Pond
Survey	Proposed Collection Line
Upland Datapoint	Proposed Access Road -
Wetland Datapoint	Proposed Access Road - Public
Field Delineated Wetland	ODNR Wetland
Delineated Wetland, Outside Current Survey Area	NWI Wetland
Field Delineated Stream/Ditch	Local Road
Delineated Waterbody, Outside Current Survey Area	State Road
	US Highway

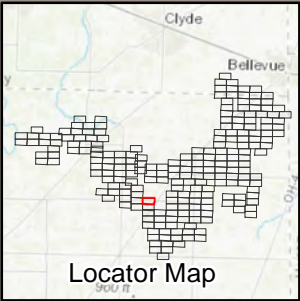

Wetland and Waterbody Maps  
(Sheet 177 of 226)

Republic Wind Project  
Seneca and Sandusky Counties, OH



121 Continental Drive, Suite 308  
Newark, DE 19713 USA  
Phone (+1) 302-395-1919 Fax (+1) 302-395-1920  
[www.cardno.com](http://www.cardno.com)





Turbine Location	Field Delineated Pond
Survey	Proposed Collection Line
Upland Datapoint	Proposed Access Road -
Wetland Datapoint	Proposed Access Road - Public
Field Delineated Wetland	ODNR Wetland
Delineated Wetland, Outside Current Survey Area	NWI Wetland
Field Delineated Stream/Ditch	Local Road
Delineated Waterbody, Outside Current Survey Area	State Road
	US Highway



Wetland and Waterbody Maps  
(Sheet 178 of 226)

Republic Wind Project  
Seneca and Sandusky Counties, OH



121 Continental Drive, Suite 308  
Newark, DE 19713 USA  
Phone (+1) 302-395-1919 Fax (+1) 302-395-1920  
[www.cardno.com](http://www.cardno.com)





Turbine Location	Field Delineated Pond
Survey	Proposed Collection Line
Upland Datapoint	Proposed Access Road -
Wetland Datapoint	Proposed Access Road - Public
Field Delineated Wetland	ODNR Wetland
Delineated Wetland, Outside Current Survey Area	NWI Wetland
Field Delineated Stream/Ditch	Local Road
Delineated Waterbody, Outside Current Survey Area	State Road
	US Highway



Wetland and Waterbody Maps  
(Sheet 179 of 226)

Republic Wind Project  
Seneca and Sandusky Counties, OH



121 Continental Drive, Suite 308  
Newark, DE 19713 USA  
Phone (+1) 302-395-1919 Fax (+1) 302-395-1920  
[www.cardno.com](http://www.cardno.com)



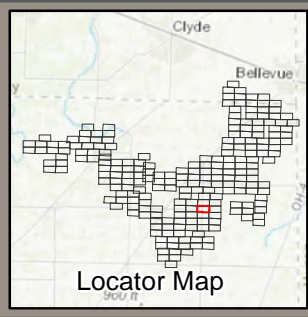
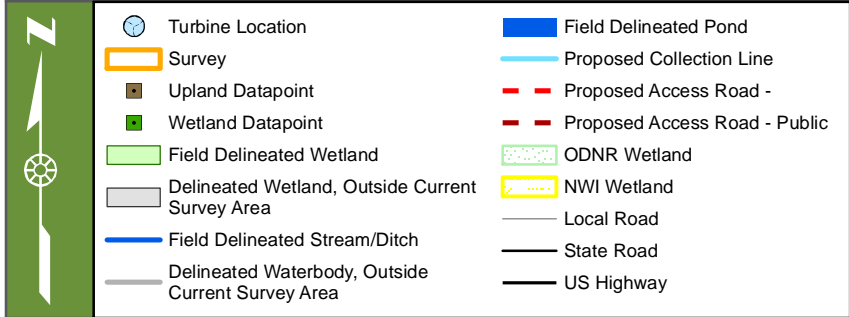

## Wetland and Waterbody Maps (Sheet 180 of 226)

Republic Wind Project  
Seneca and Sandusky Counties, OH



121 Continental Drive, Suite 308  
Newark, DE 19713 USA  
Phone (+1) 302-395-1919 Fax (+1) 302-395-1920  
[www.cardno.com](http://www.cardno.com)





Turbine Location	Field Delineated Pond
Survey	Proposed Collection Line
Upland Datapoint	Proposed Access Road -
Wetland Datapoint	Proposed Access Road - Public
Field Delineated Wetland	ODNR Wetland
Delineated Wetland, Outside Current Survey Area	NWI Wetland
Field Delineated Stream/Ditch	Local Road
Delineated Waterbody, Outside Current Survey Area	State Road
	US Highway



Wetland and Waterbody Maps  
(Sheet 181 of 226)

Republic Wind Project  
Seneca and Sandusky Counties, OH



121 Continental Drive, Suite 308  
Newark, DE 19713 USA  
Phone (+1) 302-395-1919 Fax (+1) 302-395-1920  
[www.cardno.com](http://www.cardno.com)





Turbine Location	Field Delineated Pond
Survey	Proposed Collection Line
Upland Datapoint	Proposed Access Road -
Wetland Datapoint	Proposed Access Road - Public
Field Delineated Wetland	ODNR Wetland
Delineated Wetland, Outside Current Survey Area	NWI Wetland
Field Delineated Stream/Ditch	Local Road
Delineated Waterbody, Outside Current Survey Area	State Road
	US Highway

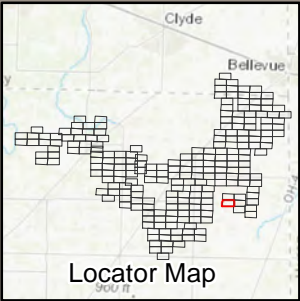

Wetland and Waterbody Maps  
(Sheet 182 of 226)

Republic Wind Project  
Seneca and Sandusky Counties, OH



121 Continental Drive, Suite 308  
Newark, DE 19713 USA  
Phone (+1) 302-395-1919 Fax (+1) 302-395-1920  
[www.cardno.com](http://www.cardno.com)











Turbine Location	Field Delineated Pond
Survey	Proposed Collection Line
Upland Datapoint	Proposed Access Road -
Wetland Datapoint	Proposed Access Road - Public
Field Delineated Wetland	ODNR Wetland
Delineated Wetland, Outside Current Survey Area	NWI Wetland
Field Delineated Stream/Ditch	Local Road
Delineated Waterbody, Outside Current Survey Area	State Road
	US Highway



Wetland and Waterbody Maps  
(Sheet 184 of 226)

Republic Wind Project  
Seneca and Sandusky Counties, OH



121 Continental Drive, Suite 308  
Newark, DE 19713 USA  
Phone (+1) 302-395-1919 Fax (+1) 302-395-1920  
[www.cardno.com](http://www.cardno.com)







Turbine Location	Field Delineated Pond
Survey	Proposed Collection Line
Upland Datapoint	Proposed Access Road -
Wetland Datapoint	Proposed Access Road - Public
Field Delineated Wetland	ODNR Wetland
Delineated Wetland, Outside Current Survey Area	NWI Wetland
Field Delineated Stream/Ditch	Local Road
Delineated Waterbody, Outside Current Survey Area	State Road
	US Highway



# Wetland and Waterbody Maps (Sheet 185 of 226)

Republic Wind Project  
Seneca and Sandusky Counties, OH



121 Continental Drive, Suite 308  
Newark, DE 19713 USA  
Phone (+1) 302-395-1919 Fax (+1) 302-395-1920  
[www.cardno.com](http://www.cardno.com)



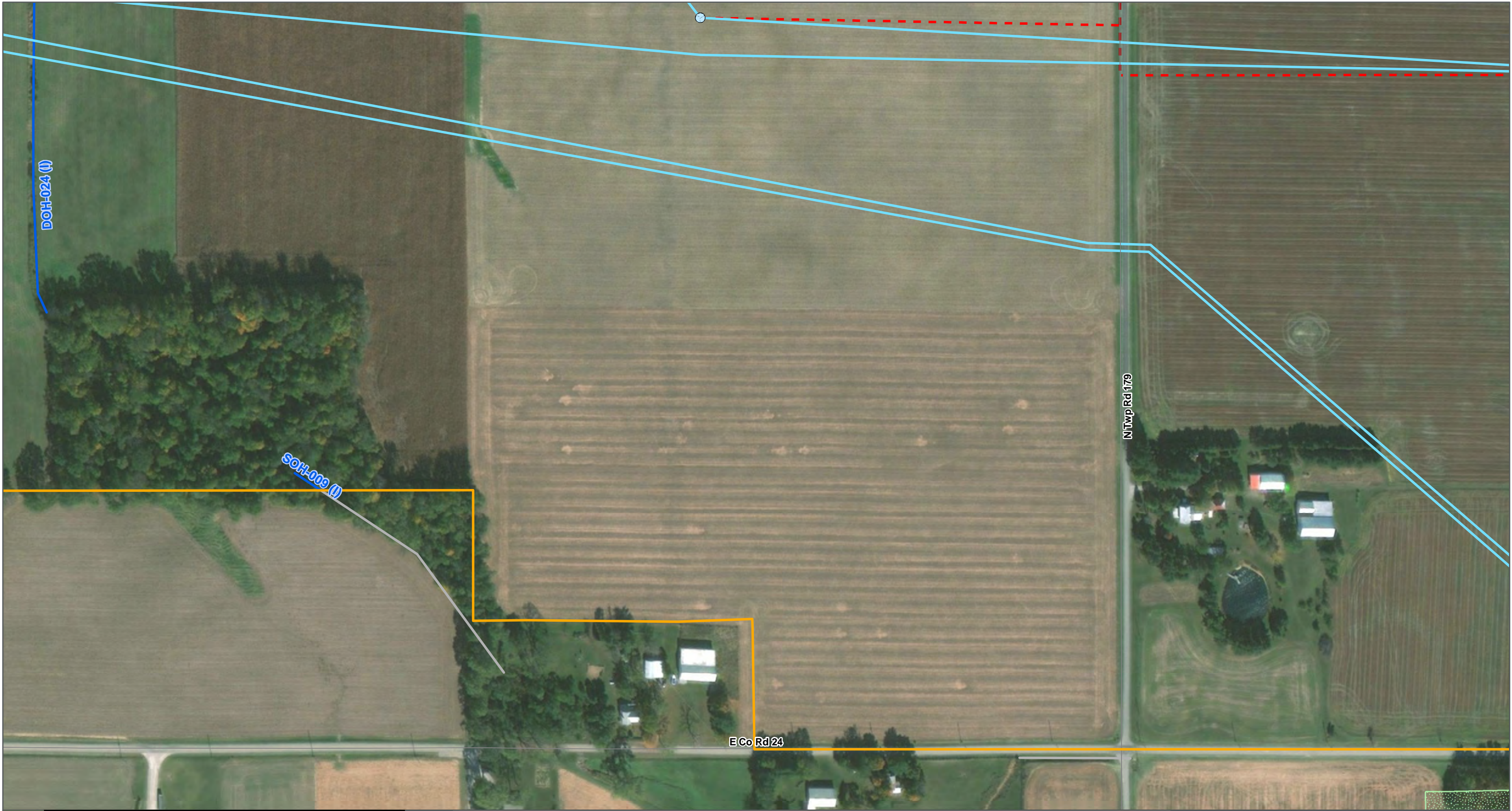

Turbine Location	Field Delineated Pond
Survey	Proposed Collection Line
Upland Datapoint	Proposed Access Road -
Wetland Datapoint	Proposed Access Road - Public
Field Delineated Wetland	ODNR Wetland
Delineated Wetland, Outside Current Survey Area	NWI Wetland
Field Delineated Stream/Ditch	Local Road
Delineated Waterbody, Outside Current Survey Area	State Road
	US Highway



# Wetland and Waterbody Maps (Sheet 186 of 226)

Republic Wind Project  
Seneca and Sandusky Counties, OH



121 Continental Drive, Suite 308  
Newark, DE 19713 USA  
Phone (+1) 302-395-1919 Fax (+1) 302-395-1920  
[www.cardno.com](http://www.cardno.com)



**This foregoing document was electronically filed with the Public Utilities**

**Commission of Ohio Docketing Information System on**

**2/2/2018 2:21:01 PM**

**in**

**Case No(s). 17-2295-EL-BGN**

Summary: Application Exhibit F Appendix H - Part 8 of 14 electronically filed by Teresa Orahod on behalf of Sally W. Bloomfield