

Memo

To: Docketing Division
From: Jill Henry, Rail Specialist, Rail Division
Cc: PUCO Legal Department
Date: 6/12/17

Re: PUCO Case No. 17-1425-RR-FED- In the Matter of a Request for an Upgrade to the Active Warning Devices at the Cleveland Commercial Railroad Crossing, E. 116th Street DOT#262-420C, in Cuyahoga County, Ohio.

On October 31, 2016, the Ohio Rail Development Commission (ORDC) authorized funding for Norfolk Southern Railway to install new lights and gates and a crossing surface at E. 116th Street DOT#262-420C, in Cuyahoga County, Ohio. The crossing was surveyed on July 20, 2016 and found to warrant the upgrades. The electric utility provider for this crossing is Cleveland Municipal Power.

The project will be paid for with federal funds and is actual cost. The plans and estimates for the project in the amount of \$327,216.00 have been approved. Construction may commence at once. **Staff requests a Finding & Order with completion of the project in nine months.** Staff requests that the following language be incorporated in the Finding & Order:

It is expected that all work necessary for FHWA acceptance of the warning devices will be completed by the in-service due date and that the railroad will be responsible for this work. This work includes, but is not limited to:

- Any ancillary work to make the warning devices function as designed and visible to the roadway user, and
- MUTCD compliance, including minor roadway work if necessary.

Please serve the following parties of record:

Cleveland Commercial Railroad
Mr. Michael J. Kole
President
29930 Pettibone Road
Glenwillow, Ohio 44319

Ohio Rail Development Commission
Cathy Stout
Safety Manager
1980 West Broad Street
Mail Stop #3140
Columbus, Ohio 43223

City of Cleveland
Division of Traffic Engineering
601 Lakeside
Cleveland, Ohio 44114

Cleveland Municipal Power
1300 Lakeside Avenue
Cleveland, Ohio 44114

**OHIO RAIL DEVELOPMENT COMMISSION
INTER-OFFICE COMMUNICATION**

TO: Randall Schumacher, Supervisor, Rail Division, PUCO
FROM: Cathy Stout, Manager, Safety Section, ORDC
BY: James Tucker, Project Manager, ORDC 
SUBJECT: Cuyahoga County, East 116th St, Cleveland Commercial Railroad
DOT#262420C, PID#103919
DATE: April 18, 2017

The Ohio Rail Development Commission (ORDC) established a diagnostic survey at the subject location on July 20, 2016. The Diagnostic Team recommended to upgrade the existing Lights/Gates and to replace the existing surface. Copies of the diagnostic review form and the plan and estimate are attached.

PE has already been provided by the railroad. ORDC approves the site plans and estimates as provided. Please issue a construction-only order for the project outlined above for nine months. This construction authorization is made with the stipulation and understanding that any field work needs prior approval before work begins. This authorization is made with the stipulation and understanding that an approved estimate may contain entries for items or activities that may be cited and found to be ineligible for federal participation during the project audit.

It is expected that all work necessary for FHWA acceptance of the warning devices will be completed by the in-service due date and that the railroad will be responsible for this work. This work includes, but is not limited to:

- Any ancillary work to make warning devices function as designed and visible to the roadway user, and
- MUTCD compliance – including minor roadway work if necessary.

Thank you for your assistance with these matters.

Attachment: Diagnostic Review
Plan & Estimate

c: Jill Henry, PUCO
Susan Arduni, ORDC
ORDC Project Manager (file)



OHIO RAIL DEVELOPMENT COMMISSION

Mail Stop #3140, 1980 West Broad Street, Columbus OH 43223

John R. Kasich, Governor • Mark Policinski, ORDC Chairman

April 17, 2017

Mike Kole
President
Cleveland Commercial Railroad L.L.C.
29930 Pettibone Rd.
Glenwillow, Oh 44319

RE: Cuyahoga County, East 116th, DOT#262420C
PID#103919

Dear Mr. Kole:

The plan and estimate dated March 21, 2017, for the referenced project has been reviewed and is acceptable. CCRL may proceed with the construction of the proposed grade crossing warning system in accordance with the abbreviated plan. This authorization is made with the stipulation and understanding that the approved estimate may contain entries for items or activities that may be cited and found to be ineligible for federal participation during the project audit. Reimbursement of eligible actual cost is limited to \$327,216.00. Additional costs must be approved in writing by the Ohio Rail Development Commission (ORDC) prior to being incurred. Emergency verbal authorizations by ORDC may be permitted and will be confirmed by ORDC in writing within ten (10) business days of the verbal approval.

This authorization is contingent upon CCRL accepting the following instructions:

1. CCRL's project foreman will furnish written notification five (5) working days prior to the date work will start at the project site to James Tucker, ORDC, e-mail james.tucker@dot.ohio.gov, and to the Public Utilities Commission of Ohio at Jill.henry@puc.state.oh.us. CCRL's project foreman will also notify the same of any stops and re-starts of the work activity and of the date work was completed for the project.
2. CCRL will arrange for utilities to be located at the project site by the Ohio Utilities Protection Service (OUPS) prior to any construction activities at the site. Utilities that are not participating members of the service must be contacted directly by CCRL.
3. CCRL's project foremen will notify James Tucker at 614-398-6897 (telephone) or james.tucker@dot.ohio.gov (email) of any changes in the scope of work, cost overruns, material changes, etc. which are not included in the approved plan and estimate and secure approval of same before the work is performed.
4. Open cut of roadways is *not permitted* except in unusual circumstances and must be coordinated with the local highway authority and preapproved by ORDC.



www.rail.ohio.gov

phone: 614.644.0306

IMPROVING RAIL TODAY FOR TOMORROW'S ECONOMY

5. CCRL will furnish two (2) copies of each partial bill to ORDC. Please find the enclosed ODOT Purchase Order to reference when billing.
6. CCRL will furnish two (2) copies of the final all-inclusive bill to ORDC stating the exact dates of starting and completing work, the initial and final dates of construction and location where the accounts may be audited.
7. This installation will include any ancillary work to make the warning devices function as designed and meet MUTCD.

This project is authorized for construction under the master agreement between Ohio Rail Development Commission, Public Utilities Commission of Ohio.

Thank you for your assistance with these matters.

Sincerely,

A handwritten signature in blue ink, appearing to read 'J. Tucker', with a long horizontal flourish extending to the right.

James Tucker
Project Manager

C: Randall Schumacher, Rail Division Supervisor, PUCO
Jill Henry, Rail Division Specialist, PUCO
Susan Arduini, ORDC
ORDC (file)



RAILROAD TRAFFIC CONTROL, INC.

P.O. Box 1479
Globe, AZ 85502

MARCH 21, 2017

678.296.7542

Email: walt.reustle@gmail.com

MR. MIKE KOLE
PRESIDENT
CLEVELAND COMMERCIAL R.R.
thepilot@ameritech.net

SUBJECT: EAST 116 TH. STREET CLEVELAND, OHIO DOT 262420C
REVISED QUOTATION .
INCLUDES REMOVAL OF ADVANCED PREEMPTION &
ADDITION OF ONE WAY SIGNAL FOR HARVARD ST.

SEE ATTACHED 4 SHEETS OF QUOTATION.

SINCERELY,

Walter C. Reustle
WALTER C. REUSTLE
PRESIDENT



SH.1 of 4

FEB. 11, 2017

RAILROAD TRAFFIC CONTROL, INC.

P.O. Box 1479
Globe, AZ 85502

678.296.7542
Email: walt.reustle@gmail.com

SUBJECT

EAST 116 th. ST.
CLEVELAND, OHIO
DOT # 262420C

TO
MR. MIKE KOLE
PRESIDENT
CLEVELAND COMMERCIAL R.R.
7634 BOND STREET
GLENWILLOW, OHIO 44139
thepilot@ameritech.net

SH.#1 REVISED 2/28/17

REVISION #2 3/21/17
ADDED ONE WAY SIG &
REMOVED ADVANCE APPROACH

ESTIMATED PROJECT COST

PRELIMINARY ENGINEERING	6,000.00
CONSTRUCTION ENGINEERING	6,000.00
SIGNAL MATERIAL	176,000.00
COMMERCIAL MATERIAL	5,092.00
EQUIPMENT RENTAL	8,000.00
MEALS LODGING & TRANSPORTATION	2,500.00
LABOR	30,000.00
CONTINGENCIES	1,000.00
CLERICAL EXPENSE	2,409.00
CONSTRUCTION EQUIPMENT, TOOLS, TRAILER, TRUCK	3,000.00
TRAFFIC CONTROL & FLAGGING	5,071.00
STONE & FILL	710.00
REMOVE , SALVAGE & STORE EXISTING SIGNAL SYSTEM	3,000.00
A.C. POWER INSTALLATION	6,000.00
INSULATED JOINT MATERIAL & INSTALLATION	4,500.00
TOTAL -----	259,282.00

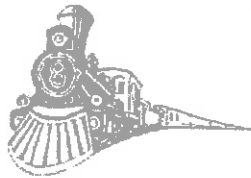

SH. 2 of 4

RAILROAD TRAFFIC CONTROL, INC.

P.O. Box 1479
Globe, AZ 85502

678.296.7542
Email: walt.reustle@gmail.com

2/11/17

CLEVELAND COMMERCIAL R.R.
EAST 116TH STREET
CLEVELAND, OHIO
DOT # 262420C

COMMERCIAL MATERIAL

<u>UNITS</u>	<u>MATERIAL</u>	<u>PRICE</u>
5000 FT.	WIRE STRANDED # 6	2,500.00
500 FT.	BOND STRAND	667.00
100 FT.	# 6 BARE COPPER WIRE	44.00
300 FT.	CONDUIT 3" SCH. 40	405.00
100 FT.	CONDUIT 1½ " SCH. 40	54.00
12	CONDUIT SWEEP ELL 3"	56.00
4	CONDUIT SWEEP ELL 1½	5.00
200 FT.	MARKER RED TAPE	9.00
8	GROUND ROD WITH WELD CLAMP	65.00
1 MISC .	CONDUIT MATERIALS	35.00
235 WELD	TRACK CIRCUIT WELD KIT	485.00
500 FT	BOND STRAND FOR BONDS	667.00
1 MISC.	RAIL BOND EQPT.	100.00
TOTAL -----		5,092.00

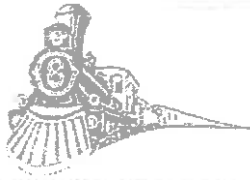

SH. 3 of 4

RAILROAD TRAFFIC CONTROL, INC.

P.O. Box 1479
Globe, AZ 85502

REVISED 3/21/17

678.296.7542
Email: walt.reustle@gmail.com

CLEVELAND COMMERCIAL R.R.

"116 TH STREET

CLEVELAND OHIO

SIGNAL MATERIAL

UNITS

- | | | |
|----|--|-----|
| 2 | CANTILEVER-GATE COMBINATION WITH 30' CANT. ARM | FM |
| | STD. OFFSET GATE ADAPTER | FM |
| | UNDER CANTILEVER ADJUSTABLE WIND BRACKET | FM |
| | RODENT GUARD | FM |
| | 1 EA. 2WAY LED FLASHER ON TIP/20"background | WCH |
| | 2 EA. 1WAY LED FLASHER ON CANT. ARM & MAST | WCH |
| | 2 EA. X-BUCK SIGN | |
| | 1 EA. GATE MECH. WITH GATE SAVER (SPRING TYPE) | WCH |
| | MECHANSIM TO BE 3593-B DIAGRAM 38-0045-400 | |
| | OBLONG COUNTER WEIGHT, WITH ALUMINUM ARMS. | |
| | GATE ARM TO BE EASY GATE 38' WITH LOW PROFILE | |
| | LIGHTS WITH TIP LIGHT DIODE (easy gate #9298-0910) | |
| | GATE TO HAVE VERTICAL STRIPE | |
| 11 | JUNCTION BOX MOUNTED ON MAIN MAST | WCH |
| | 1 ELECTRONIC BELL | WCH |
| | 1 CONCRETE PRE-CAST FOUNDATION FOR SINGLE | |
| | MAST CANTILEVER SIGNAL (DIXIE) | DIX |
| | 1 ENS SIGN WITH STAND OFF BRACKET | |
| | (SEE NOTE) | |
| 1 | HOUSE 4'X 6' WITH HEATER, A.C. BREAKER PANEL, POWER OFF FM | FM |
| | LIGHTS ON EACH END, ADJUSTABLE STEEL LEGS, INSULATED, | |
| | EXHAUST FAN WITH CONTINUAL USAGE STAMINA, A.C. OUTLETS, | |
| | BATTERY RACK, FLOOR MAT, SHELF ON ONE SIDE & end. | |
| | TERMINAL BOARD WITH PLUG IN EQUIPMENT SPACE ON TOP. | |
| | CONTROL EQUIPMENT CAN BE PLACED ON MOUNTING RACK OR | |
| | MOUNTED ON 3/4" PLYWOOD PANEL (PAINTED WITH FIRE | |
| | PROOF PAINT) OR MOUNTED ON OPEN RACK. | |
| | ALL WIRING TO BE # 10 STRANDED 36STR. WITH TAG | |
| | ON EACH END. (TAG TO HAVE TO & FROM & WIRE NAME.) | |
| | HIGH QUALITY WIRING METHODS MUST BE USED. | |

NOTE

CANTILEVER "A" TO HAVE EXTRA SET OF ONE WAY LIGHTS
FOR HARVARD ST.



SH. 4 of 4

RAILROAD TRAFFIC CONTROL, INC.

P.O. Box 1479
Globe, AZ 85502

REVISED 3/21/17

678.296.7542

Email: walt.reustle@gmail.com

CLEVELAND COMMERCIAL R.R.

"116 TH STREET

CLEVELAND OHIO

SIGNAL MATERIAL

UNIT

SIGNAL MATERIAL

1	SCX-1 CONTROL UNIT CONFIGURATION "A"	800-087051-007	ALSTOM
1	VLG VITAL LOGIC GATE UNIT	250948-020	"
1	RELAY BASE KIT	251071-010	"
2	XLC CROSSING LIGHT CONTROL	250991-000	"
2	XLC CROSSING LIGHT CONTROL BASE	251071-100	"
1	VRD VITAL RELAY DRIVER	250651-000	"
2	LAPG LIGHTNING ARRESTER PANEL		"
5	RELAY-PLUG-IN 6 F-B 500 OHM		PATCO
5	PLUG BOARD FOR 500 OHM RELAY		"
5	SET OF CONTACTS FOR RELAYS WITH # 10 BARREL		"
6	AGA -1 LIGHTNING ARRESTER	202216-001	ALSTOM
6	LIGHTNING ARRESTER BLOCK 3 TERM.	200089-000	"
3	AGE-1 EQUALIZER	202217-000	"
3	TERMINAL BUSS STRAP	023839-5	"
6	TERMINAL 12 SINGLE ROW	250084-112	"
3	DIODE TRACK PAT-X-M10TD		PATCO
70	TEST LINK WITH GOLD NUT	024620-1X	SAFE
6	BATTERY 4V235		ULRICH
2	BATTERY CHARGER 20EC12		RLY. EQPT.
1	GFD-3 GROUND FAULT DETECTOR	800-081-006-001	ALSTOM
1	EMERGENCY CONTROL BOX WITH SWITCH		FM
1	COPPER GROUND PLATE 4"X6" X1/8"		FM
2	JUNCTION BOX (HAND HOLE) 2'X2'		
8	PADLOCKS		

TOTAL SIGNAL MATERIAL SHEETS # 3 & 4 ----- 176,000.00

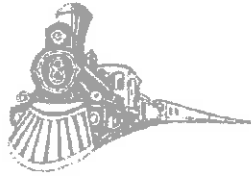

RAILROAD TRAFFIC CONTROL, INC.

P.O. Box 1479
Globe, AZ 85502

678.296.7542

Email: walt.reustle@gmail.com

MR. MIKE KOLE
PRESIDENT
CLEVELAND COMMERCIAL R.R.
thepilot@ameritech.net

MARCH 13, 2017

SUBJECT: EAST 116 TH. STREET CLEVELAND OHIO DOT 262420C
REVISED PLANS - REMOVED APPROACH PREEMPTION
& INSERTED SIMULTANEOUS PREEMPTION ON PLANS.

SEE ATTACHED 14 SHEETS.

SINCERELY,

WALTER C. REUSTLE
PRESIDENT

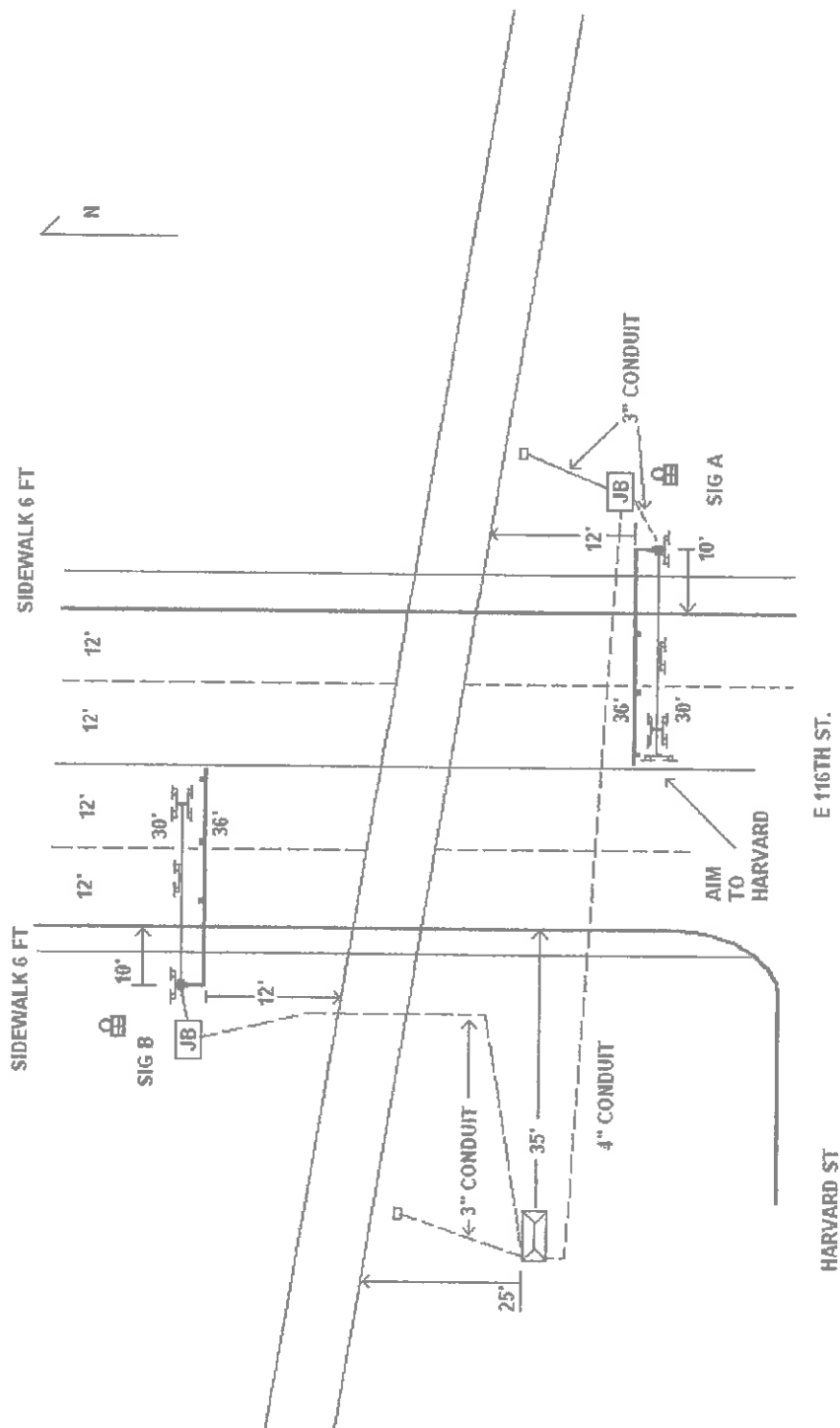

CLEVELAND COMMERCIAL R.R.
EAST 116TH STREET DOT 262420C

SITE PLAN

REV

DWG COMPUTER

DATE 2/18/17

SHEET 1 OF 14



Railroad Traffic Control Inc. 678-296-7542

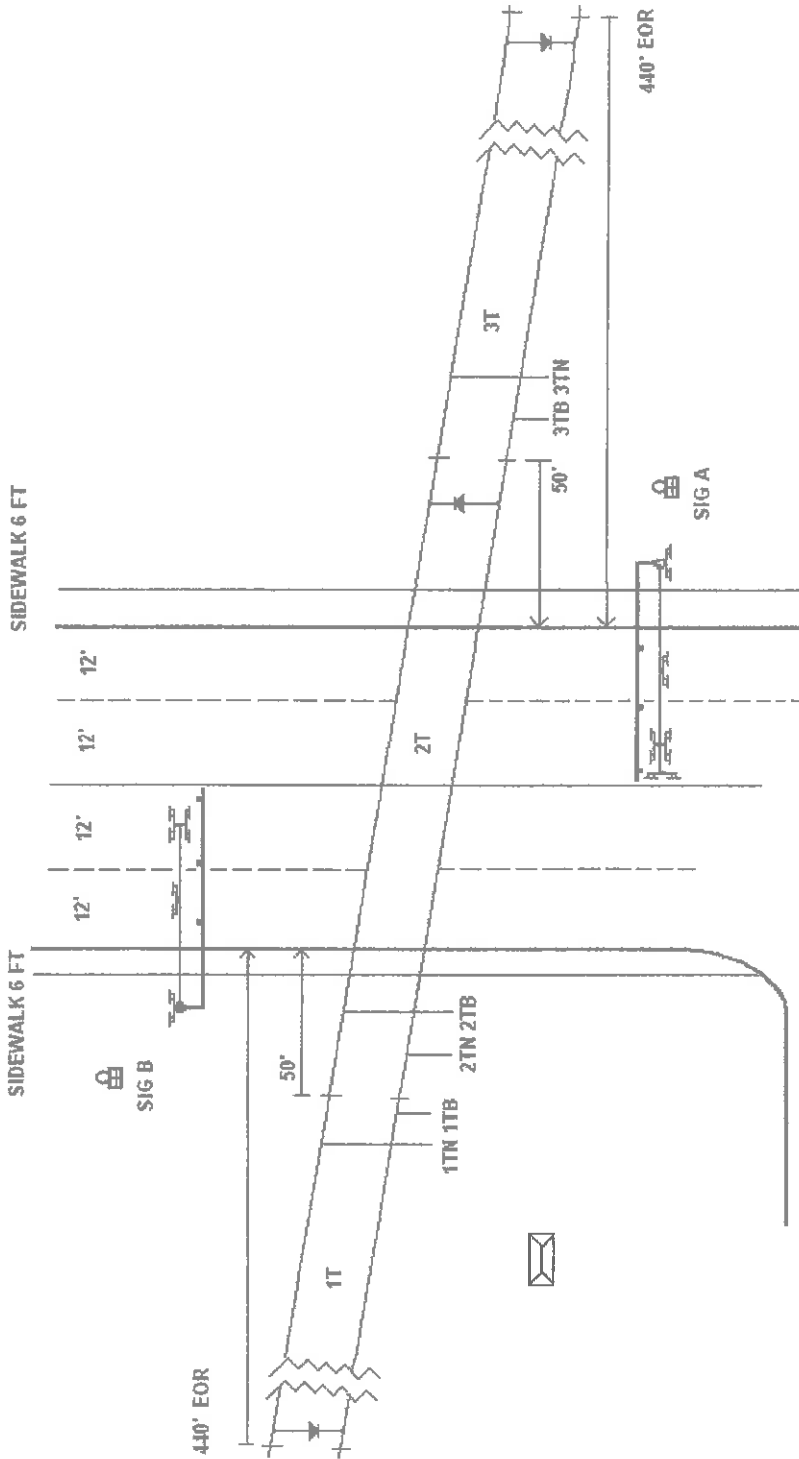

HARVARD ST

WARNING TIME	20 SEC
EQUIP RESPONSE TIME	1 SEC
BUFFER TIME	9 SEC
TOTAL APPROACH TIME	30 SEC
MAXIMUM 10MPH FT PER SEC	14.6
APPROACH DISTANCE	440 FT

CLEVELAND COMMERCIAL R.R. EAST 116TH STREET DOT 262420C			
TRACK PLAN			
REV	3/10/17	DATE	2/18/17
DWG	COMPUTER	SHEET	2 OF 14

TRAFFIC INTERCONNECT RAILROAD

SEE SHEET 4

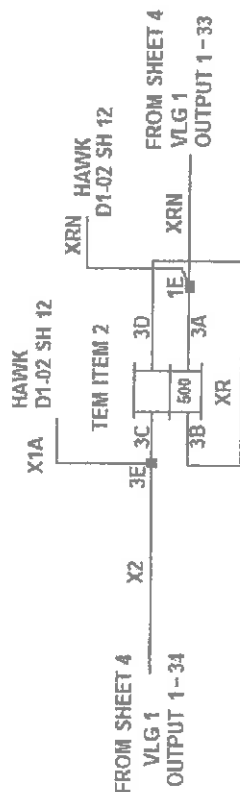

2TR (ISLAND) RELAY COIL SEE SHEET 3
GATE DOWN RELAY (GDR) COIL SEE SHEET 4
GATE UP RELAY (GPR) COIL SEE SHEET 4

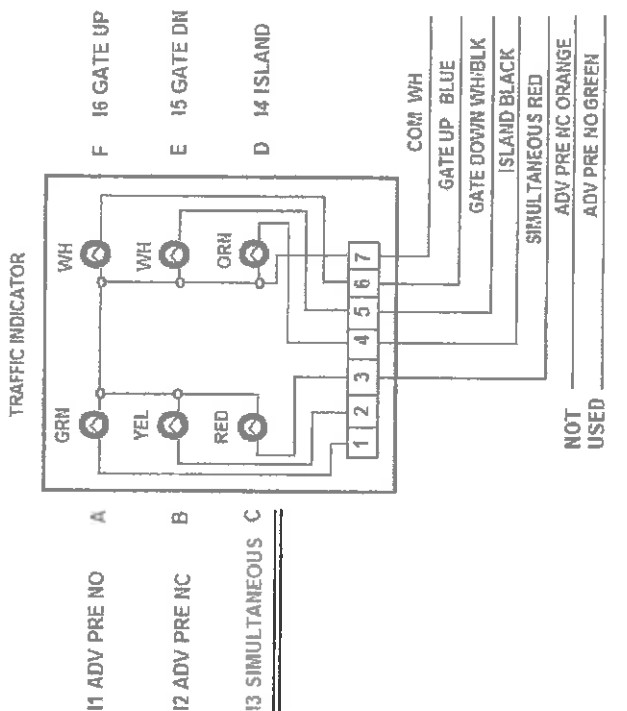

CLEVELAND COMMERCIAL R.R. EAST 116TH STREET DOT 262420C	
REV 3/10/17	DATE 2/18/17
DWG COMPUTER	SHEET 5 OF 14

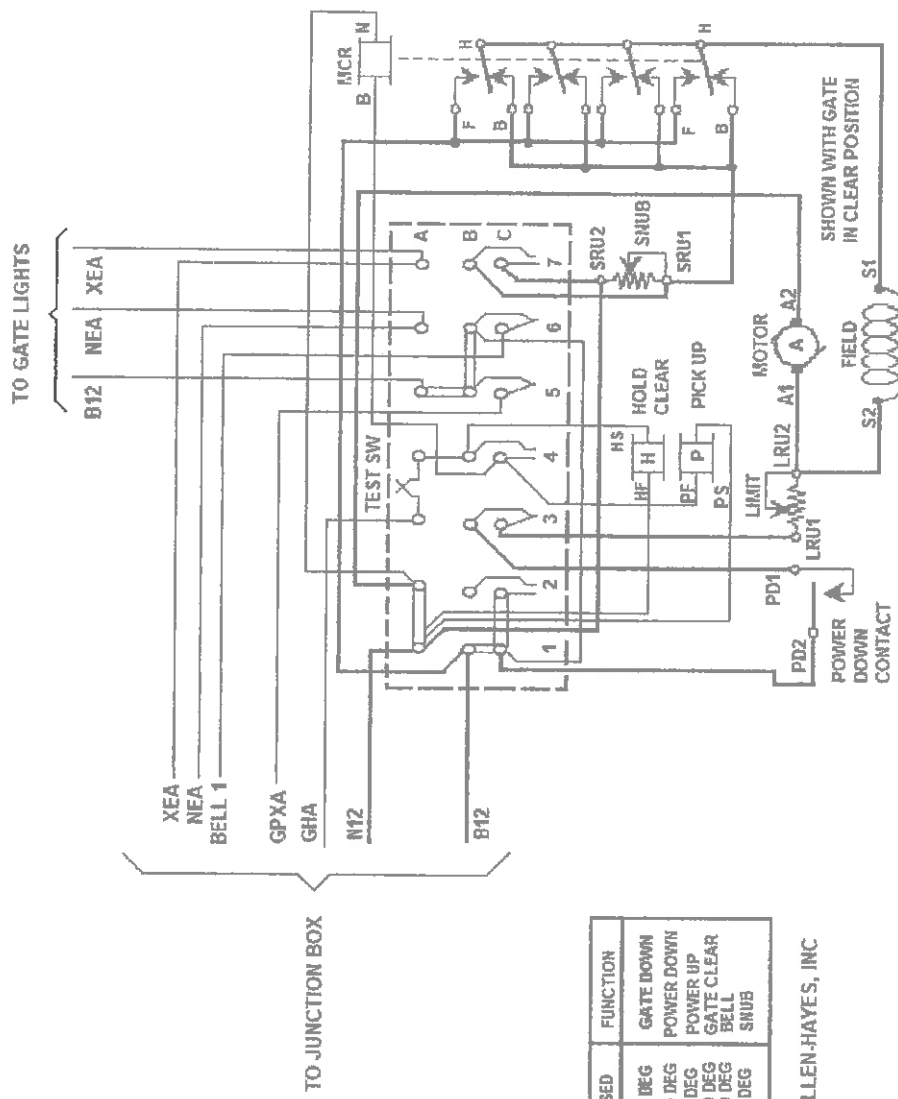

CONTACT	CLOSED	FUNCTION
2	6 - 10 DEG	GATE DOWN
3	45 - 90 DEG	POWER DOWN
4	0 - 86 DEG	POWER UP
5	82 - 90 DEG	GATE CLEAR
6	10 - 90 DEG	BELL
7	0 - 10 DEG	SNUB

WESTERN-CULLEN-HAYES, INC

3593E

CLEVELAND COMMERCIAL R.R. EAST 116TH STREET DOT 262420C GATE A		
REV	DATE 2/18/17	SHEET 6 OF 14
DWG	COMPUTER	

SIGNAL A JUNCTION BOX

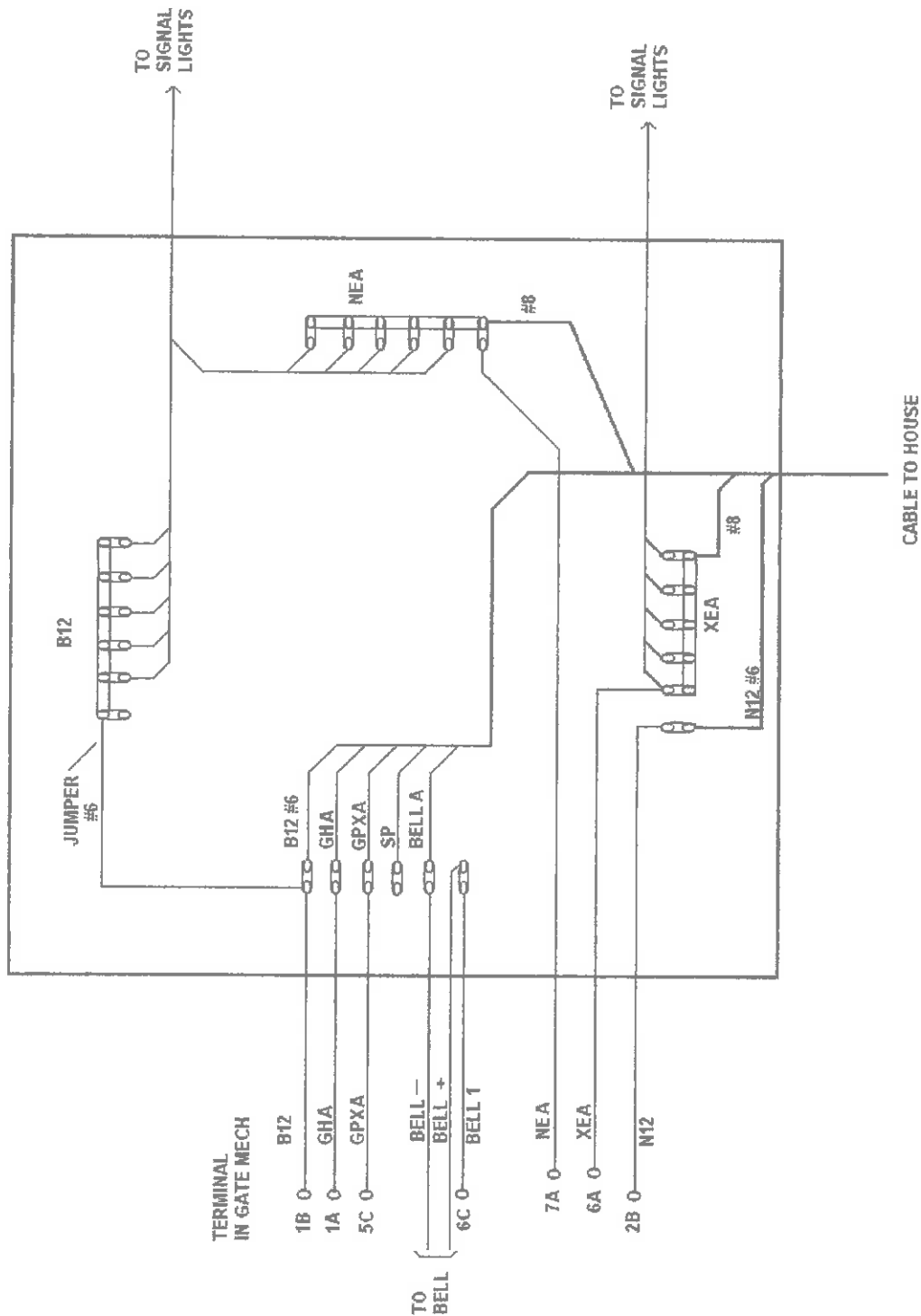

CLEVELAND COMMERCIAL R.R. EAST 116TH STREET DOT 262420C SIGNAL A JUNCTION BOX		
REV		
DWG	COMPUTER	DATE 2/18/17
		SHEET 7 OF 14

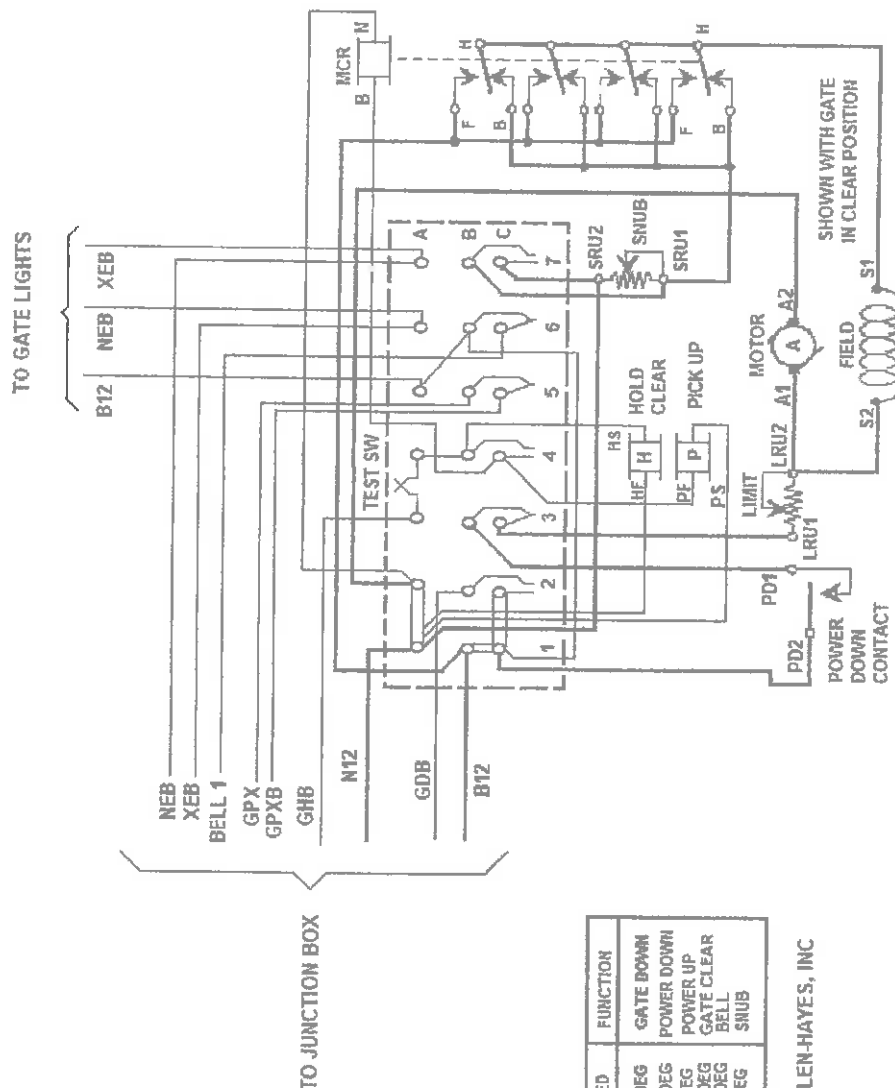

CONTACT	CLOSED	FUNCTION
2	8 - 10 DEG	GATE DOWN
3	45 - 90 DEG	POWER DOWN
4	0 - 86 DEG	POWER UP
5	82 - 90 DEG	GATE CLEAR
6	10 - 90 DEG	BELL
7	0 - 10 DEG	SNUB

WESTERN-CULLEN-HAYES, INC

3593E

CLEVELAND COMMERCIAL R.R. EAST 116TH STREET DOT 262420C		
REV	GATE B	
DWG COMPUTER	DATE 2/18/17	SHEET 8 OF 14

SIGNAL B JUNCTION BOX

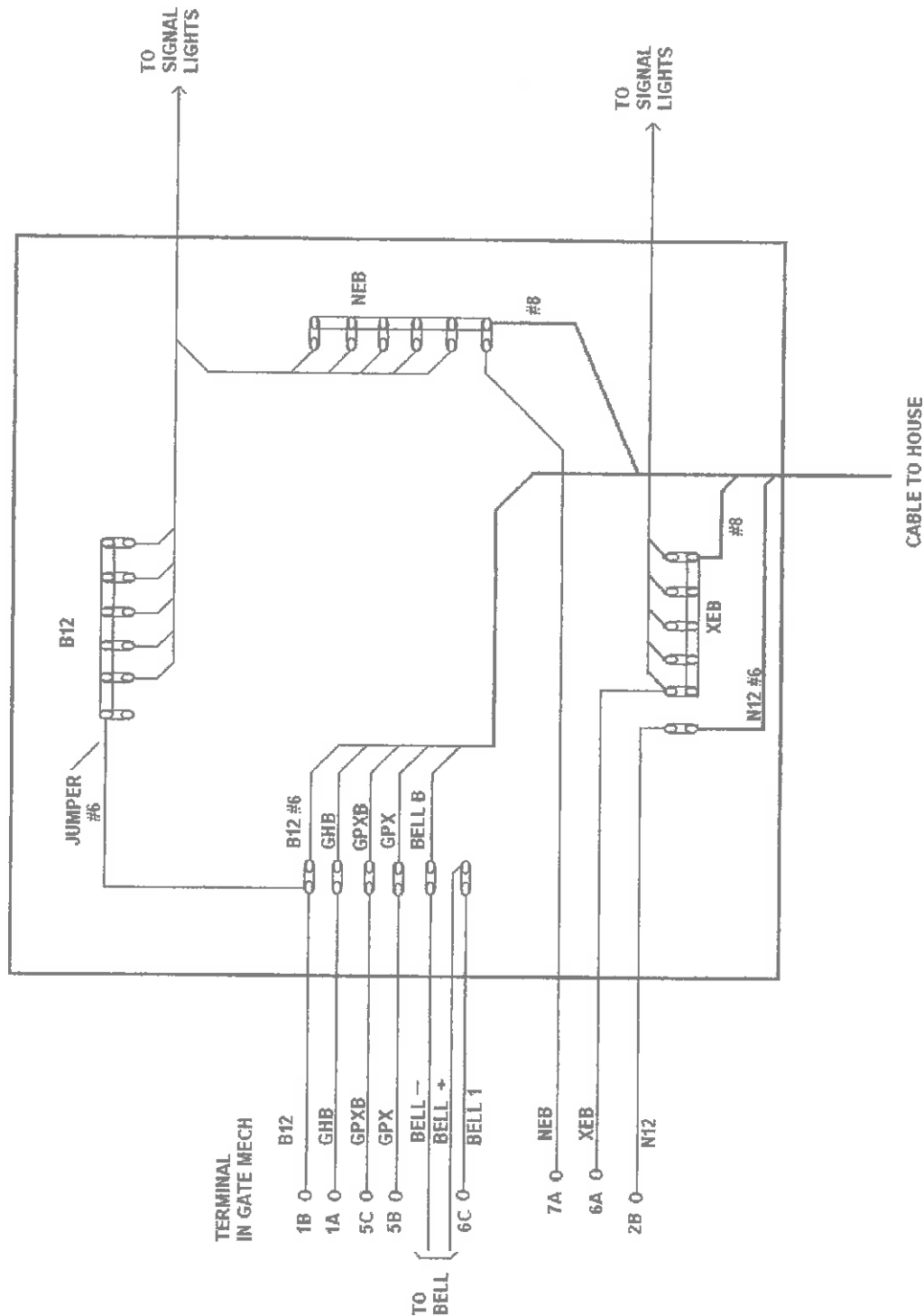

CLEVELAND COMMERCIAL R.R. EAST 116TH STREET DOT 262420C		
REV	SIGNAL B JUNCTION BOX	DATE 2/18/17
DWG COMPUTER		SHEET 9 OF 14

CANTILEVER A

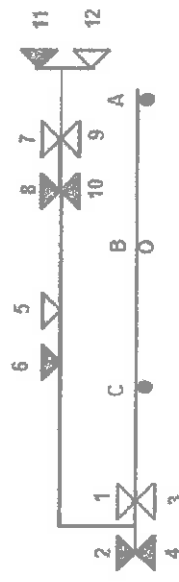
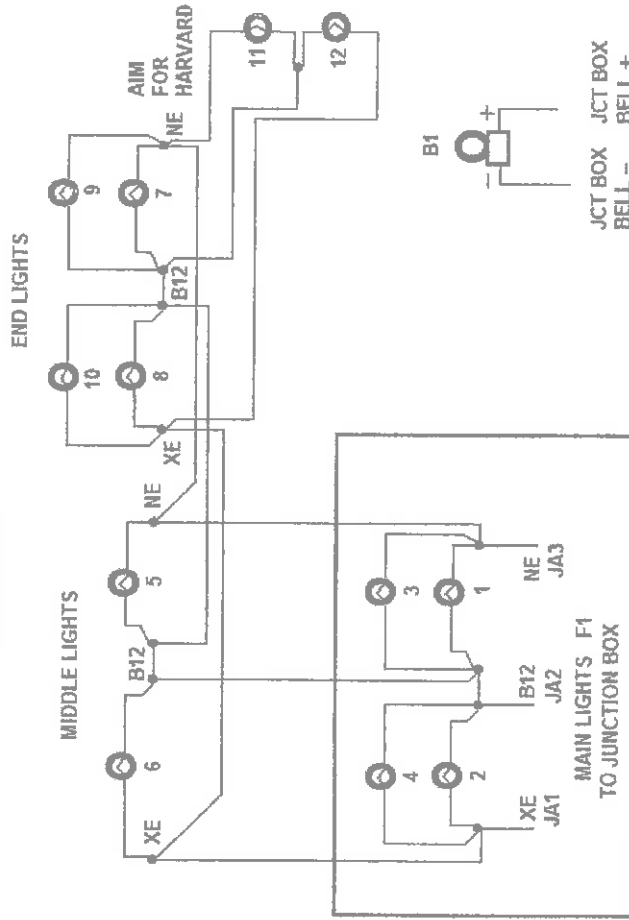

CANTILEVER B

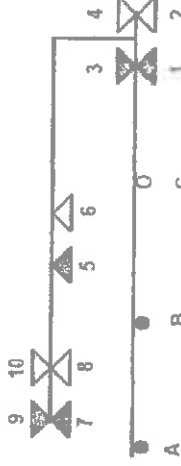
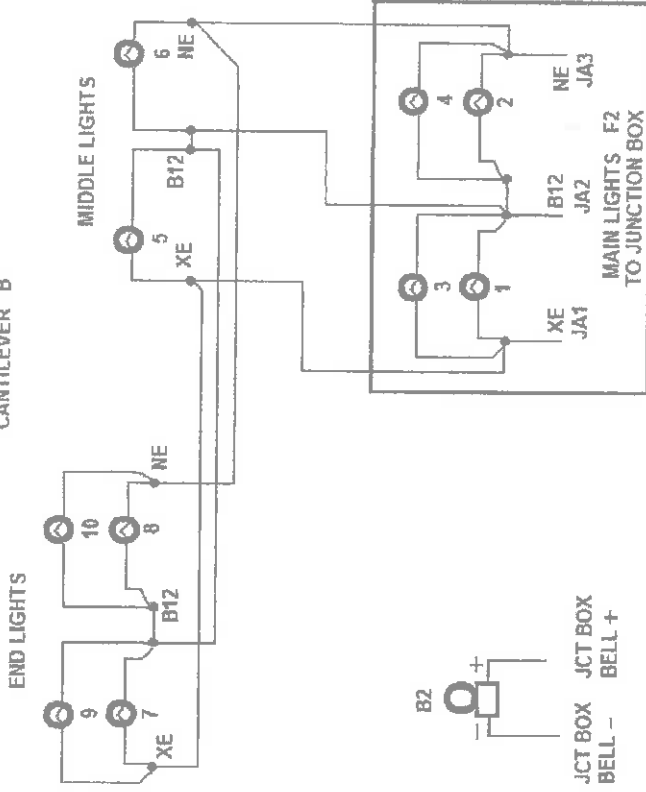

GATE MECH
TERMINALS

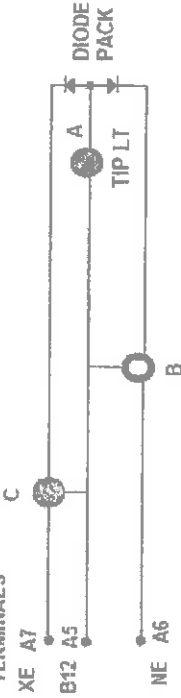

CLEVELAND COMMERCIAL R.R. EAST 116TH STREET DOT 262420C LIGHTS		
REV	DATE	SHEET 10 OF 14
DWG	COMPUTER	

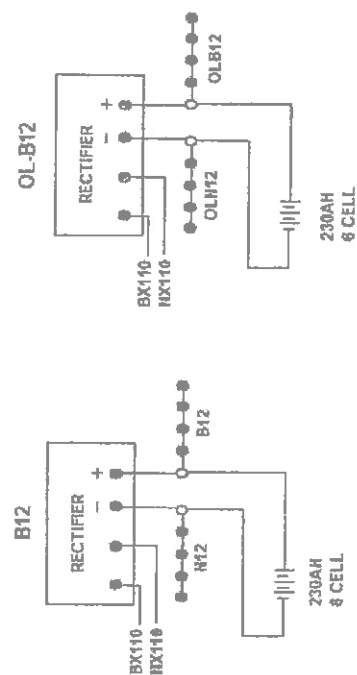
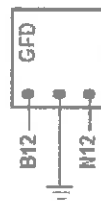

POWER

DWG COMPUTER	DATE 2/18/17	SHEET 11 OF 14
--------------	--------------	----------------

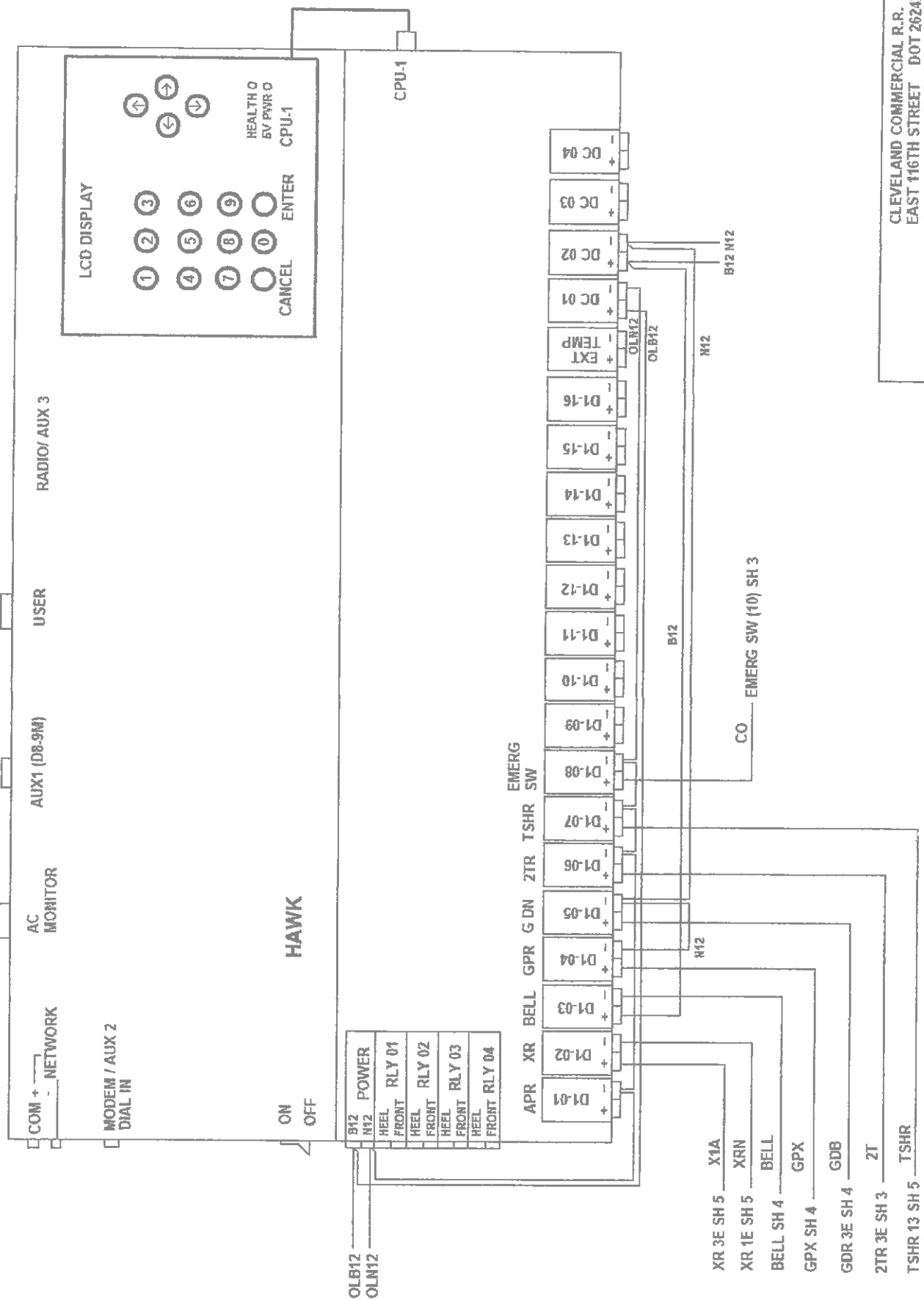

CLEVELAND COMMERCIAL R.R. EAST 116TH STREET DOT 262420C HAWK UNIT		
REV 3/10/17	DWG COMPUTER	DATE 2/18/17
		SHEET 12 OF 14

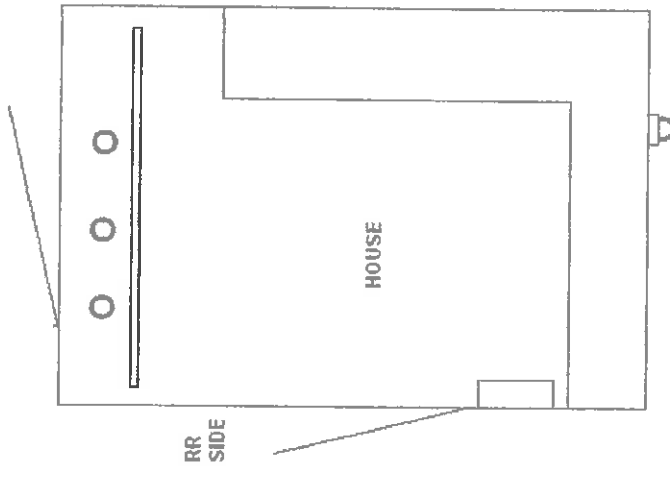
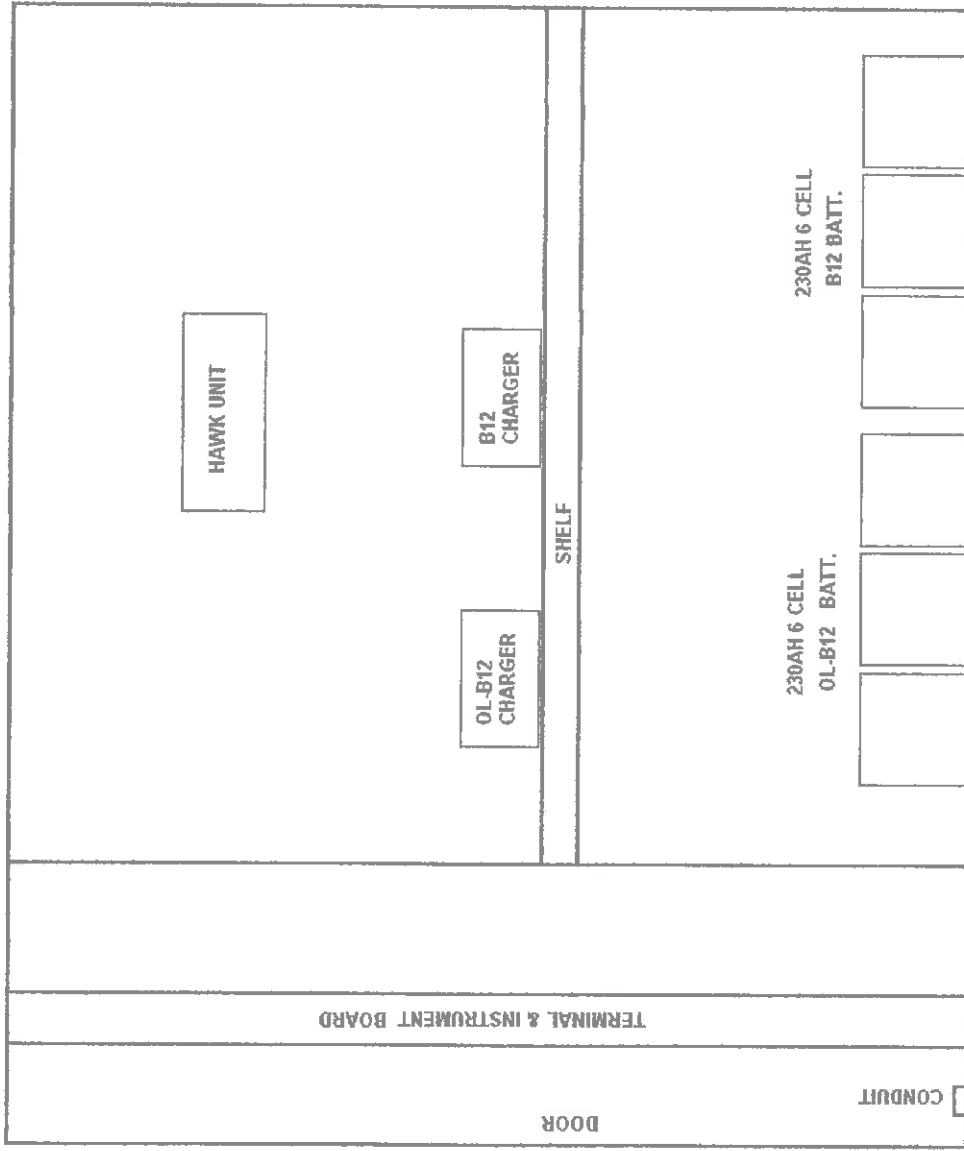

CLEVELAND COMMERCIAL R.R. EAST 116TH STREET DOT 262420C POWER WALL			
REV	COMPUTER	DATE	2/18/17
DWG	13 OF 14	SHEET	

		VLG1	XLCA	XLCB	XR	TSHR	GDR	GPR	ZTR (ISLR)	
--	--	------	------	------	----	------	-----	-----	---------------	--

SCX-1

OLB12

OLN12

B12

N12

1TB 1TN 2TB 2TN 3TB 3TN

☐ ☐ ☐ ☐ ☐ ☐

VRD

GFD

SIGNAL SYSTEM
ARRESTERS

TRAFFIC LIGHT
ARRESTERS

CLEVELAND COMMERCIAL R.R. EAST 116TH STREET DOT 262420C CONTROL BOARD			REV 3/10/17	DWG COMPUTER	DATE 2/18/17	SHEET 14 OF 14
---	--	--	-------------	--------------	--------------	----------------

Wintrow Construction Corp.

673 Norton Ave. Barberton, Ohio 44203

Tele: (330) 753-2983

3/3/2017

CCR

7634 Bond St.

Glenwillow, Ohio 44139

Attn: Mike Kole Phone: 440-227-3780 Email: thepilot@ameritech.com

Wintrow Const. Corp. will provide all supervision, labor, equipment, and materials for described work below

Replace rail and surface at E 116th

Provide detour, signage, and close road

Sawcut Asphalt

Remove existing crossing surface and track structure and dispose of offsite

Prepare subgrade

Reconstruct track utilizing new 136 RE rail, bars, tie plates, crossties, bolts, spikes and ballast

Install full timber crossing surface (new) 72TF

Install 20 new approach ties immediately off each end of crossing

Surface track approaches

Replace sidewalks as outlined

Install asphalt approaches

Total: \$67,934

Contingencies/Notes

Sales Taxes Not included in Quotation

No Warranty or Guarantees are apart of this proposal

Railroad Protective Liability Insurance is not included.

No pavement markings are included

Prevailing wage rates are not included

Any Flagman costs, straight or premium costs are NOT included

Payment: Net 30 Days. Late payment charge of 1 1/2% (18% annum) will be charged on all past due balances.

We are not responsible for repair or relocation of Under Ground Utilities

Weather conditions prevail and may affect the construction schedule.

Track must be free of rail cars and rail traffic.

ONE Mobilization is included in the quotation.

All work is at straight time labor rates unless specified otherwise in the quotation

Engineering and plans by others.



OHIO RAIL DEVELOPMENT COMMISSION

Mail Stop #3140, 1980 West Broad Street, Columbus OH 43223

John R. Kasich, Governor • Mark Policinski, ORDC Chairman

October 31, 2016

Michael J. Kole
President
Cleveland Commercial Railroad, L.L.C.
29930 Pettibone Road
Glenwillow, Oh 44319

RE: Grade Crossing Warning Device Improvements
Cuyahoga County, East 116th Street, DOT#262420C, PID#103919.

Dear Mr. Kole:

A diagnostic review was held at the above grade crossing on July 20, 2016. The crossing has been recommended for the installation of lights and gates, a new Surface and the addition of Simultaneous Preemption.

CCRL is authorized to proceed with the site plans and cost estimates (PE) or bid package for this project. This authorization is made with the stipulation and understanding that any field work needs prior approval before work begins. This authorization is made with the stipulation and understanding that an approved estimate may contain entries for items or activities that may be cited and found to be ineligible for federal participation during the project audit.

The diagnostic review form is attached. Please note any recommendations (page 5), if any, made by the team with regard to requirements for this location. Any minor roadway work necessary for MUTCD compliance should be incorporated into the PE and such costs will flow through the railroad reimbursement process.

The Project Manager for this project is James Tucker. James can be reached at (614) 398-6897, or james.tucker@dot.ohio.gov, if you have any questions.

Sincerely,

Project Manager

C: Randall Schumacher, Supervisor, Rail Division, PUCO
Jill Henry, Grade Crossing Planner, PUCO
Susan Arduini, ORDC
ORDC (file)

Attachment: 1 (diagnostic review form)



www.rail.ohio.gov

phone: 614.644.0306

IMPROVING RAIL TODAY FOR TOMORROW'S ECONOMY



Diagnostic Review Team Survey

Reason for Survey:

(e.g. formula, accident, constituent, etc.)

Date: 7/20/2016

Location Data

Street or Road Name:

E. 116th Street

Route/Road Number

(i.e. Twp., Co., SR or US)

US DOT No.:

262420C

County:

CUY

Township:

City:

(In or Near)

City of Cleveland

Railroad
Name:

Cleveland Commercial Railroad

Railroad
Division:

Mahoning

Branch/Line
Name:

Randall Sec.

Nearest RR

Timetable Station:

RR Milepost:

7.30

On-Site Review Team

(Include: Name - Organization - Phone Number - Email)

1. JAMES TUCKER ORDC 614-398-6897 James.Tucker@dot.ohio.gov
2. DEAN WILSON RTC 330-612-2146 DEANCHRISWILSON@YAHOO.COM
3. JEFF FOUGHT RTC 330-612-3017 JAFbi2240@yahoo.com
4. CATHY STOUT ORDC 614 644 0313 Catherine.Stout@dot.ohio.gov
5. BRADY TRAVERS Traffic Eng. 614-3196 REGINALEVIN@RTCITY.CLEVELAND.OH.US
6. BRADY TRAVERS BPL 330 569 8853 Btravers@buckeye.com
7. TRAVIS KALE CCL 440 777 3780 TRKALE@CCLRR.COM
8. KEVIN DUENNEL ODOT ORE 614-728-2400 Kevin.Duenmel@dot.ohio.gov
9. JOHN THREAT ODOT 12 216-584-2106 JOHN.THREAT@DOT.OHIO.GOV
- Nate M920 CCL 216-402-0093 NM920@CCLRR.COM

Existing Traffic Control Devices

Type of Warning Devices	Installed?		Quantity/Comments
Advance Warning Signs (condition?)	<input checked="" type="checkbox"/> Yes	<input type="checkbox"/> No	only 1
'Stop' Signs	<input type="checkbox"/> Yes	<input checked="" type="checkbox"/> No	
'Stop Ahead' Signs	<input type="checkbox"/> Yes	<input checked="" type="checkbox"/> No	
Pavement Markings (condition?)	<input type="checkbox"/> Yes	<input checked="" type="checkbox"/> No	
Crossbucks	<input checked="" type="checkbox"/> Yes	<input type="checkbox"/> No	2 fair
Number of Tracks Signs	<input type="checkbox"/> Yes	<input checked="" type="checkbox"/> No	
Inventory Tags	<input checked="" type="checkbox"/> Yes	<input type="checkbox"/> No	2
Interconnected Highway Traffic Signal	<input type="checkbox"/> Yes	<input checked="" type="checkbox"/> No	
Mast-Mounted Flashing Lights	<input checked="" type="checkbox"/> Yes	<input type="checkbox"/> No	
Cantilever Flashing Lights	<input type="checkbox"/> Yes	<input checked="" type="checkbox"/> No	Number: Length:
Side Lights	<input checked="" type="checkbox"/> Yes	<input type="checkbox"/> No	Harvard
Automatic Gates	<input checked="" type="checkbox"/> Yes	<input type="checkbox"/> No	Number: Length:
Bells	<input checked="" type="checkbox"/> Yes	<input type="checkbox"/> No	Number: 2
Sidewalk Gate Arms	<input type="checkbox"/> Yes	<input checked="" type="checkbox"/> No	
'No Turn' Signs	<input type="checkbox"/> Yes	<input checked="" type="checkbox"/> No	
Illumination	<input checked="" type="checkbox"/> Yes	<input type="checkbox"/> No	
Is crossing flagged by train crew?	<input type="checkbox"/> Yes	<input checked="" type="checkbox"/> No	
Other	<input type="checkbox"/> Yes	<input type="checkbox"/> No	

Safety Data (Obtain crash reports, if possible, prior to review)

	Initial Information (from database)	Revised
Number & dates of crashes in previous 5 years	0	
Hazard Ranking	1406	Date Run: 6/9/2016

Railroad Data

Railroad Characteristics	Initial Information (from database)	Revised
Total trains per day	2	
< 1 per day		
Day thru trains	1	
Night thru trains	1	
Daytime switching movements		
Nighttime switching movements		
Total number of tracks	1	
Number of main tracks	1	
Number of other tracks		
Maximum train speed	10	
Typical train speed	10	
Amtrak		

If non-gated crossing, is clearing sight distance adequate in all quadrants? (See Table I) ☐ Yes ☒ No

If multiple tracks, can two trains occupy crossing at the same time? ☐ Yes ☒ No

Can one train block the motorists' view of another train at crossing? ☐ Yes (Explain below) ☒ No

Can one or more tracks be eliminated through the crossing? ☐ Yes ☒ No

Are there other track(s) crossing this same roadway within 100 ft of this crossing? ☐ Yes ☒ No

If yes, Crossing DOT #(if different) _____

If yes, distance _____ (take measurement between track centerlines at closest point along roadway)

Roadway Data

Local Highway Authority: City of Cleveland

Roadway Characteristics	Initial Information (from database)	Revised
Average daily traffic	18,571 (2006)	
Highway paved	<input checked="" type="checkbox"/> Yes <input type="checkbox"/> No	<input type="checkbox"/> Yes <input type="checkbox"/> No
Roadway Surface: <input checked="" type="checkbox"/> Blacktop <input type="checkbox"/> Gravel <input type="checkbox"/> Concrete <input type="checkbox"/> Other _____		
Roadway width: 44 ft.		
Number of highway lanes	4	
Urban or Rural	Urban	
Vehicle Speed: 25 MPH		
School Bus Operation: <input type="checkbox"/> No <input checked="" type="checkbox"/> Yes _____ Amount		
Hazardous Materials Trucks: <input type="checkbox"/> No <input checked="" type="checkbox"/> Yes .03 Amount		
Shoulders: <input checked="" type="checkbox"/> No <input type="checkbox"/> Yes		
Is the shoulder surfaced? <input checked="" type="checkbox"/> No <input type="checkbox"/> Yes		
Is there existing guardrail along roadway in crossing vicinity? <input checked="" type="checkbox"/> No <input type="checkbox"/> Yes		
Is stopping site distance adequate? (See Table 2) <input checked="" type="checkbox"/> Yes <input type="checkbox"/> No If no, deficient approach(es) _____		

Quadrant <u>NW</u> Curb and Gutter: <input checked="" type="checkbox"/> Functional (Curb height = 4" or more) <input type="checkbox"/> Non-functional (Curb height = Less than 4") <input type="checkbox"/> None	Quadrant <u>SE</u> Curb and Gutter: <input checked="" type="checkbox"/> Functional (Curb height = 4" or more) <input type="checkbox"/> Non-functional (Curb height = Less than 4") <input type="checkbox"/> None
Pedestrians: <input type="checkbox"/> No <input checked="" type="checkbox"/> Yes	
Is sidewalk present? <input type="checkbox"/> No <input checked="" type="checkbox"/> Yes	
Is there a nearby intersection that could cause queuing over the crossing? <input type="checkbox"/> No <input checked="" type="checkbox"/> Yes If yes, Distance _____ Is this intersection signalized? <input type="checkbox"/> No <input checked="" type="checkbox"/> Yes Are the signals currently interconnected with the existing crossing warning devices? <input checked="" type="checkbox"/> No <input type="checkbox"/> Yes Is there a 'Do not Stop on Track' sign? <input checked="" type="checkbox"/> No <input type="checkbox"/> Yes	
Is a roadway improvement project (e.g. widening, turn lanes, nearby new or upgraded traffic signal, sidewalk) planned at or near this location in the foreseeable future? <input checked="" type="checkbox"/> No <input type="checkbox"/> Yes If yes, Improvement type _____ Lead Agency _____ Timeline/completion - _____	
Is it the consensus of the Diagnostic Review Team that this is a potential closure project? <input checked="" type="checkbox"/> No <input type="checkbox"/> Yes Explain reasons: _____	
Type of Development	
<input type="checkbox"/> Open Space <input checked="" type="checkbox"/> Industrial <input checked="" type="checkbox"/> Residential	<input type="checkbox"/> Institutional <input checked="" type="checkbox"/> Commercial Location of nearby schools: <u>City of Cleveland</u> <u>1/2 mile North</u>
Utility Information	
Is commercial power available? <input type="checkbox"/> No <input checked="" type="checkbox"/> Yes Utility Provider (Company Name) <u>CEP / CEI</u> Phone Number _____ Nearest Available Power Source <u>@ crossing</u>	
What other utilities are present? (add locations to sketch) <input checked="" type="checkbox"/> Gas <input checked="" type="checkbox"/> Cable <input checked="" type="checkbox"/> Telephone <input checked="" type="checkbox"/> Fiber Optic Cable <input type="checkbox"/> Petroleum <input checked="" type="checkbox"/> Water <input checked="" type="checkbox"/> Sanitary Sewer <input type="checkbox"/> Other _____	
Is(are) there potential utility conflict(s) <input checked="" type="checkbox"/> Yes <input type="checkbox"/> No <input type="checkbox"/> Unknown Comments: _____	

Potential Red Flags / Project Challenges

Traffic Signal Preemption (include traffic signal intersection name and LHA with jurisdiction over traffic signal, if known):

yes Harvard Ave.

Crossing Consolidation or Closure:

N/A

Real Estate or ROW:

N/A

Culverts / Drainage / Ballast Conditions:

west side Ballast in poor shape.

Roadway and/or Sidewalks:

N/A

Circuitry (e.g. reaches out to other crossings, specific needs, etc.):

overhead power lines are interfering with current L/G.

Environmental:

N/A

Other:

Diagnostic Team Recommendations

Quadrants Needed

<input checked="" type="checkbox"/> Install/upgrade active devices	
<input type="checkbox"/> Automatic Flashing Lights (AFLS)	
<input type="checkbox"/> AFLS / Cants	
<input type="checkbox"/> AFLS / Gates	
<input checked="" type="checkbox"/> AFLS / Gates / Cants	TYPE C
<input checked="" type="checkbox"/> Bells / number	↓
<input type="checkbox"/> Upgrade circuitry / type	
<input checked="" type="checkbox"/> Sidelights	STYLE C
<input type="checkbox"/> Guardrail Needed	
<input type="checkbox"/> Install/Replace curb	
<input checked="" type="checkbox"/> Bungalow placement & offset from rail & highway	HARVARD AVE
<input type="checkbox"/> Other (define)	

Both Directions Cant/Gate Combo
Z

Comments: ADVANCE WARNING SIGN for HARVARD AVE. (CITY)
Surface upgrade
upgrade pavement markings (CITY)

<input checked="" type="checkbox"/> Install/upgrade traffic signal preemption	SIMULTANEOUS
<input type="checkbox"/> No improvements needed	
<input type="checkbox"/> Other (define)	

Acknowledgement of Recommendations (each entity represented at the diagnostic must have at least one signature acknowledgement):

[Signature] [Signature] [Signature]
[Signature] [Signature] [Signature]

Field Dimensions

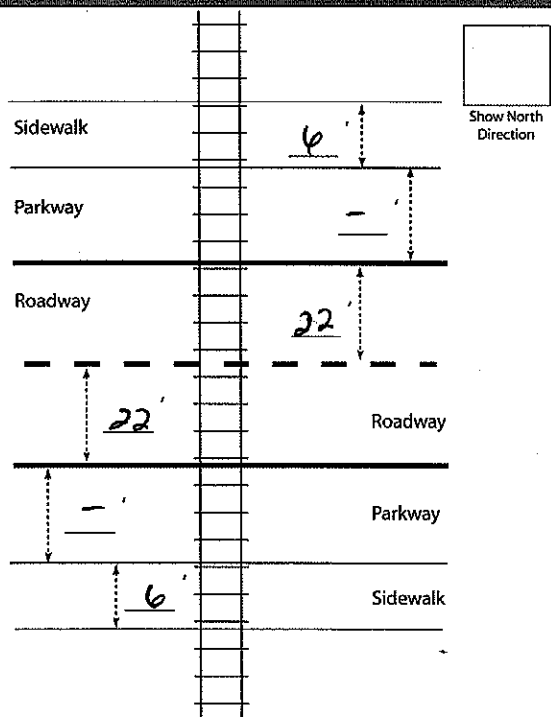

CITY would add
DO NOT STOP ON TRACKS
Sign.

Field Sketch

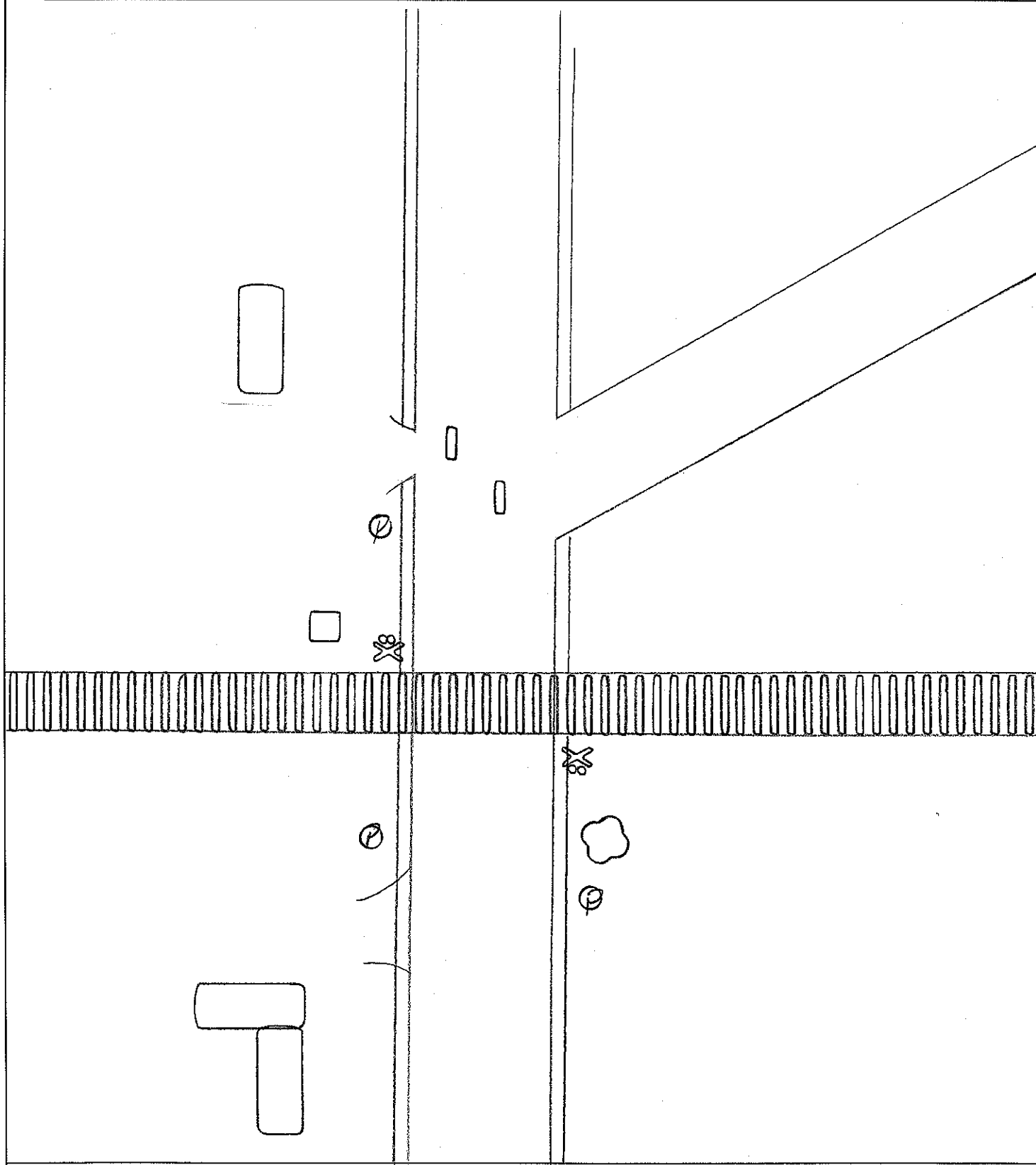

Crossing Angle ☐ 0-29° ☐ 30-59° ☐ 60-90° Measured in _____ Quadrant?

Sketch by: _____

TABLE 1

Clearing Sight Distances

Maximum Authorized Train Speed	Distance (dT) Along Railroad from Crossing (ft)
1 - 10	240
15	360
20	480
25	600
30	720
35	840
40	960
45	1080
50	1200
55	1320
60	1440
65	1560
70	1680
75	1800
80	1920
85	2040
90	2160

Source: R-H Grade Crossing Handbook Table 36 (pp. 132-133)

Notes:

All calculated distances are rounded up to the next higher 5-foot increment.

Distances indicated are for 65-ft double bottom semi-tractor trailers and level single track 90 degree crossings; and may need to be adjusted for multiple tracks, skewed crossings or approaches on grades.

Clearing Sight Distance is to be measured in each vehicle travel direction at non-gated crossings as viewed from a point 25 feet from centerline of nearest track in the center of whichever travel lane is nearest the direction along track being measured.

Table 2

Stopping Sight Distances

Highway Vehicle Speed	Distance (dH) Along Roadway from Crossing (ft)
0	n/a
5	50
10	70
15	105
20	135
25	180
30	225
35	280
40	340
45	410
50	490
55	570
60	660
65	760
70	865

Source: R-H Grade Crossing Handbook Table 36 (pp. 132-133)

Notes:

All calculated distances are rounded up to the next higher 5-foot increment.

Distances indicated are for 65-ft double bottom semi-tractor trailers on dry level pavements.

Stopping Sight Distance is to be measured on each roadway approach to crossing from stop bar.

This foregoing document was electronically filed with the Public Utilities

Commission of Ohio Docketing Information System on

6/12/2017 8:05:07 AM

in

Case No(s). 17-1425-RR-FED

Summary: Application In the Matter of a Request for an Upgrade to the Active Warning Devices at the Cleveland Commercial Railroad Crossing, E. 116th Street DOT#262-420C, in Cuyahoga County, Ohio. electronically filed by Mrs. Jill A Henry on behalf of PUCO/Rail Division