



COLUMBUS | CLEVELAND
CINCINNATI-DAYTON
MARIETTA

BRICKER & ECKLER LLP
100 South Third Street
Columbus, OH 43215-4291
MAIN: 614.227.2300
FAX: 614.227.2390

www.bricker.com
info@bricker.com

Sally W. Bloomfield
614.227.2368
sbloomfield@bricker.com

FILE

November 18, 2016

10

Via Electronic Filing

Ms. Barcy McNeal
Public Utilities Commission of Ohio
Administration/Docketing
180 East Broad Street, 11th Floor
Columbus, OH 43215-3793

Re: Trishe Wind Ohio, LLC, Case No. 13-197-EL-BGN

Dear Ms. McNeal:

The December 16, 2013 Opinion, Order, and Certificate approving Northwest Ohio Wind Energy, LLC's [now known as Trishe Wind Ohio, LLC ("Trishe")] Certificate of Environmental Compatibility and Public Need ("Certificate") and the October 1, 2013 Supplement to Amended Application ("Supplement") established a set of conditions and supplemental commitments as part of the Certificate.

Within this set of conditions and commitments, **Certificate Condition No. 6** requires the following:

At least 30 days prior to the preconstruction conference, the Applicant shall submit to Staff, for review and acceptance, one set of detailed engineering drawings of the so that Staff can determine that the design is in compliance with the terms of the certificate. The layout shall be provided in hard copy and as geographically-referenced electronic data. The design shall include all conditions of the certificate and references at the locations where the Applicant and/or its contractors must adhere to a specific condition in order to comply with the certificate.

In compliance with Condition No. 6, attached for filing is a copy of the final IFC drawings for the planned 2016 construction. If you have any questions please call at the number listed above.

Sincerely,

Sally W. Bloomfield

Attachment

cc: Andrew Conway (w/Attachment)
Grant Zeto (w/Attachment)

RECEIVED-DOCKETING
2016 NOV 18 PM 4:08
PUCO

This is to certify that the images appearing are an accurate and complete reproduction of a case file document delivered in the regular course of business.
Technician AW Date Processed 11/18/16

Civil Construction Plans

Access Roads, Drainage and Erosion Control

for
Northwest Ohio Wind Project
Paulding, Ohio

[illegible]

BASE FILE	FILE NAME	PROVIDER	DATE
THREATS: ABILITY	WIN_CMSI_20090809.msp	WINCISO	10/17/14
ATTN/LOG CONTROL	20090809.msp	WINCISO	10/17/14
TRAC	000-1000-20090809.msp	STATE OF OHIO	04/07/15
ASAC	WINCISO_20090809.msp	WINCISO	04/07/15
REWARDS/SURVEILL	WIN_CMSI_20140515.msp	WINCISO	07/29/15

Sheet List Table	
Sheet Number	Sheet Title
1	Cover
2	Overall Civil Site Plan
3	Construction Details
4	Construction Details
5	Construction Notes
6	Civil Site Plan T-1A, T-1B
7	Civil Site Plan T-1C
8	Civil Site Plan T-2A, T-2B
9	Civil Site Plan T-3A
10	Civil Site Plan T-4A

[illegible]

State Map

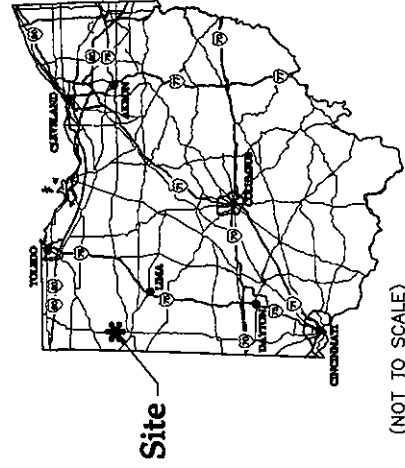

(NOT TO SCALE)

Vicinity Map

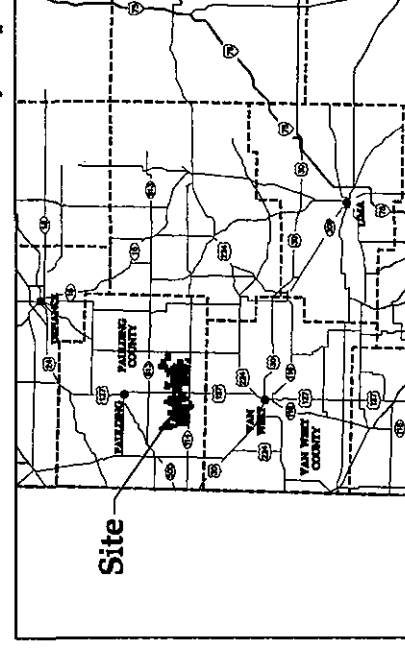

**Northwest
Ohio Wind
Project**
Paulding County, Ohio

Cover

Issued For Construction
Army Date 11/10/2014
Date 11/18/16
Sheet: 1 of 9

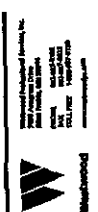

Project Name	Northwest Ohio Wind Project
Client	Starwood Energy Group
Location	Faulkner County, Ohio
Scale	1" = 1000'
North Arrow	
Legend	
Proposed Future Turbine Location	
Proposed Future Turbine Number	
Existing Drainage Way	
Outside Project Boundary	
Project Area (Future Construction)	



Northwest Ohio Wind Project

Faulkner County, Ohio

Overall Civil Site Plan

Issued For Construction
Army Date 10/17/2014
Date 11/18/16
Sheet 2 of 9
000000-000000.dwg

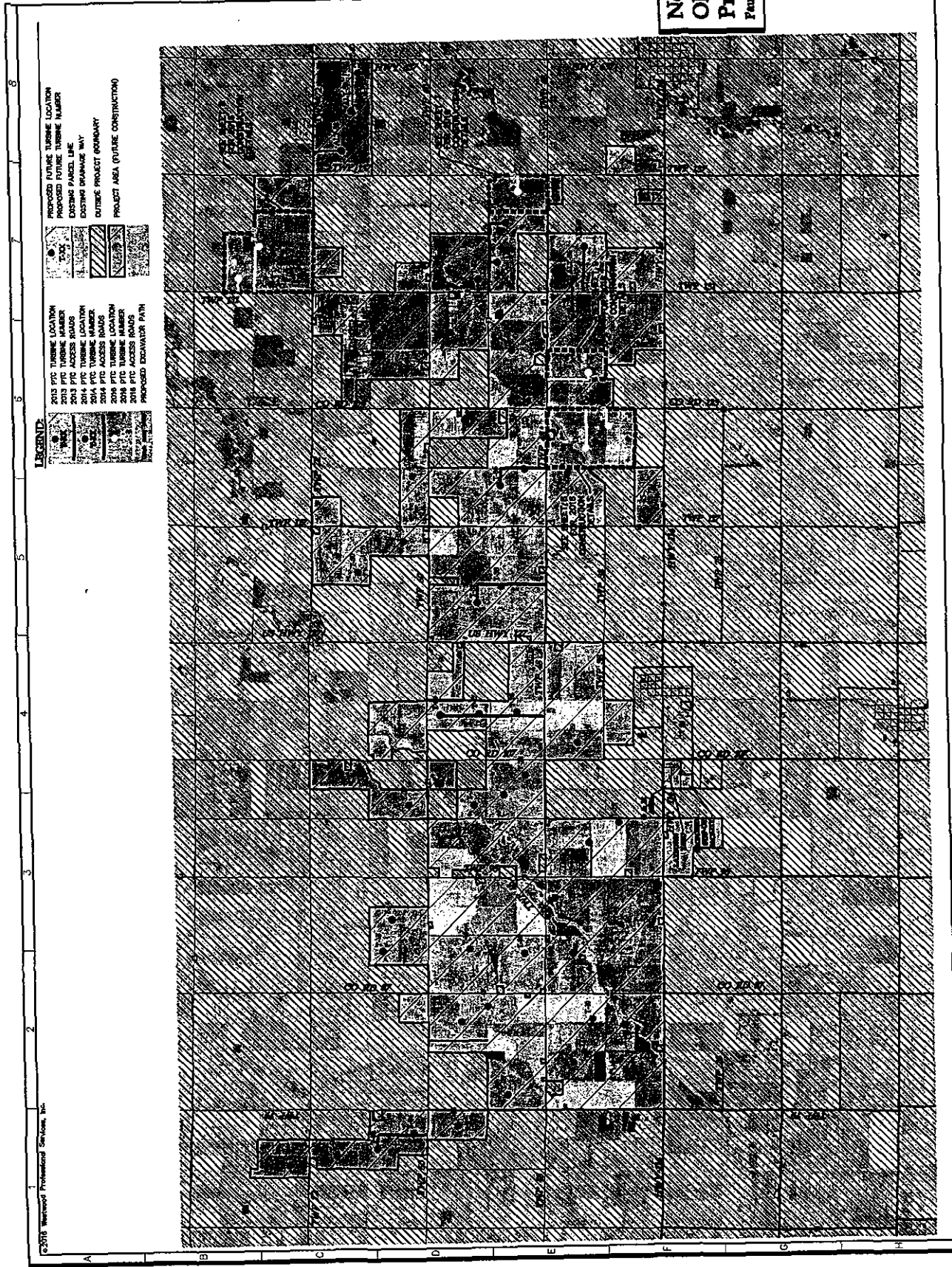

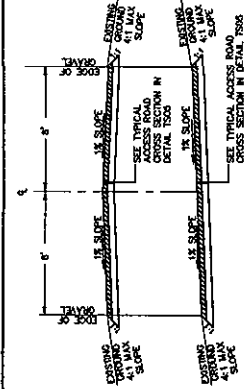

- NOTES:
1. CONTRACTOR SHALL CONSTRUCT CROSS-SLOPE ROAD SECTION WHERE ACCESS ROADS ARE CONSTRUCTED ON A SIDE SLOPE, AND WHERE OTHERWISE NOTED ON PLANS, TO ENSURE THAT ROADS AND SHOULDERS REMAIN WELL DRAINED AT ALL TIMES.
 2. ROADS TO GENERALLY FOLLOW EXISTING CONTOURS EXCEPT IF GRADES EXCEED TURBINE DELIVERY VEHICLE CAPABILITIES, IF THIS OCCURS GENERAL CONTRACTOR MAY PROVIDE ASSIST VEHICLE OR MOVER GRADE.

TYPICAL TURBINE ACCESS ROAD

LEFT ROWS
= 501

ROOM-A

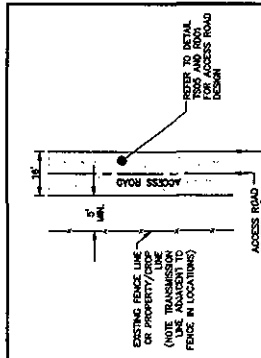

- NOTE: 1. THE ACCESS ROAD MAY NEED TO BE CONSTRUCTED FARTHER FROM THE PROPERTY LINE IF OBSTRUCTIONS NOT IDENTIFIED ON THE PLAN SET ARE ENCOUNTERED. SEE DISCUSSION OF OBSTRUCTIONS, PAGE 20.

	TURBINE ACCESS ROAD ALONG FENCE/PROPERTY/CRIP LINE		LIFT DATE 11/7/03
			DDDM 0004

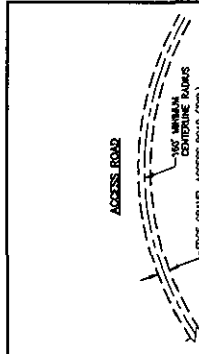

- NOTE:**
1. SOME RADII MAY REQUIRE ADDITIONAL SOIL COMPACTION OR GRAVEL OUTSIDE OF THE WIDTH SHOWN ABOVE TO ACCOMMODATE TRACTORS OR TRAILERS TRAVING OFF THE ACCESS ROAD.

	MINIMUM RADIUS FOR TURNABLE ACCESS ROAD		DATE WHEN PLANS
			BOOK

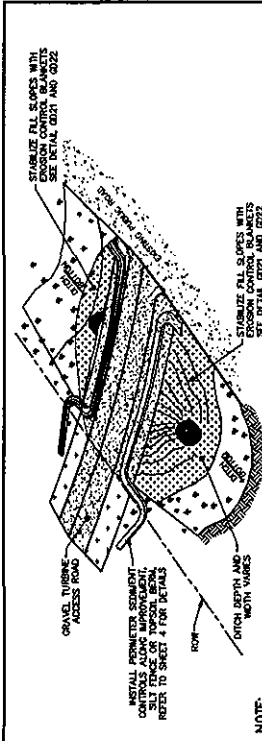

- NOTE:**
1. ENTRANCE SHOULD BE REINFORCED FOR STABILITY AFTER ANY RAINFALL EVENT.
2. MATERIAL THICKNESSES SHOWN ARE MINIMUMS. IT MAY BE NECESSARY TO FIELD AGAINST THICKNESSES TO ACHIEVE SUFFICIENT BEARING CAPACITIES AS ARE NECESSARY FOR ANTICIPATED ROAD USE.
3. ROCK CATCH CRATES MAY BE NECESSARY AT SLOPE AND DRAINAGE AREAS REQUIRING. SEE DETAIL OTHER SHEET.
4. CULVERT INSTALLATION SHALL CONFORM WITH MANUFACTURERS RECOMMENDATION FOR INSTALLATION. CULVERT TO BE SUMPED 2.5' BELOW EXISTING FLOW LINE.
5. RESTORE DISTURBED AREA TO NATIVE CONDITIONS IN ACCORDANCE WITH THE SWPPP.
- WORTH NOTES
- ERSSON CONTROL BLANKETS
SEE DETAIL 0021 AND 0022

	SO. PASCOE DISTURBED AREA TO MONITOR CONTINUED IN PROGRESS, WITH THE STREET.	TURBINE ACCESS ROAD ENTRANCE CULVERT CROSSING	OFF-ROAD SECTION
			RD19-C

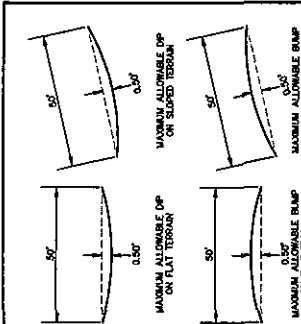

- ON FLAT TERRAIN ON SLOPED TERRAIN

	MAXIMUM DEFLECTION FOR TURBINE ACCESS ROAD	DEFINITIONS 11/1/61
		RD02

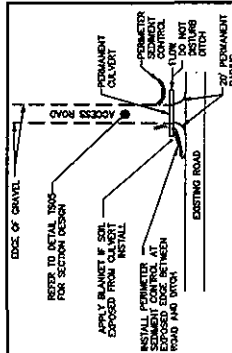

- NOTE:** CULVERTS AND PERIMETER SEDIMENT CONTROL SHALL BE INSTALLED AND MAINTAINED AT INTERSECTIONS WHERE THE ACCESS ROAD IS CROSSING AN EXISTING COUNTY DITCH.

DATE: 10/20/2011
 TIME: 10:00 AM
 BY: [Signature]

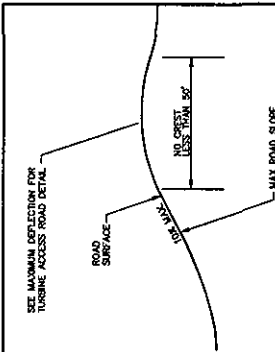

- NOTES:**
1. ROAD SLOPE SHALL NOT EXCEED 10% WITHOUT OWNER APPROVAL

	MAXIMUM VERT. SLOPE FOR TURBINE ACCESS ROAD/CRANE TRAVEL PATH	DATE REVISED 11/4/13
		8003

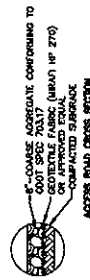

- NOTE.** STRUCTURAL SECTIONS SHOWN ARE THE MINIMUM THICKNESS REQUIREMENTS DURING NORMAL FIELD CONDITIONS. THE SECTIONS MAY NEED TO BE INCREASED BASED ON ACTUAL FIELD CONDITIONS AT THE TIME OF CONSTRUCTION. CONDITIONS INCLUDE BUT ARE NOT LIMITED TO CONSTRUCTION DURING THE FREEZE/THAW CYCLE, UNUSUALLY WET PERIODS, OR IN LOW-WEI AREAS.

	TYPICAL STRUCTURAL CROSS SECTIONS	DATE	10/1/88
		BY	W. W. W.

**Northwest
Ohio Wind
Project**
Paulding County, Ohio

Construction Details

Issued For Construction
Army Date 11/01/2014

Date 11/12/16
Sheet 3 of 9

001050000-000077001-00-0

STANDARD DETAIL

NOTE:

1. INSPECT AND REPAIR FENCE AFTER EACH STORM EVENT AND REMOVE SEDIMENT WHEN ACCUMULATED TO 1/2 THE HEIGHT OF THE FENCE OR MORE.
2. CONTINUE TO MAINTAIN FENCE AND TOP OF FENCE MUST BE MAINTAINED TO TOP OF FENCE.
3. SALT FENCE SHALL BE PLACED ON SLOPE CONTIGUOUS TO MAXIMIZE FENCING EFFICIENCY.
4. ALL ENDS OF THE SALT FENCE SHALL BE WRAPPED UPSTREAM SO THE ELEVATION OF THE BOTTOM OF FENCING IS HIGHER THAN "TURNING HEIGHT".

USE DRAWING: 0012

ROCK CONSTRUCTION ENTRANCE

NOTE:

1. ROCK CONSTRUCTION ENTRANCE SHOULD BE A MINIMUM THICKNESS OF 12" AND BE CONSTRUCTED WITH 12" WIDE ROCK. ROCK ENTRANCE SHOULD BE WRAPPED TO BE EXTENDED ON FLAT SOIL.

USE DRAWING: 0012

WOOD MULCH BERM

NOTE:

1. WOOD MULCH BERM SHALL BE WRAPPED UPSTREAM AS A BARRIER AGAINST JETTING AND SHOULD BE PLACED ALONG SLOPE.
2. WOOD MULCH BERM SHALL BE PLACED ALONG SLOPE.
3. WOOD MULCH BERM SHALL BE PLACED ALONG SLOPE.

USE DRAWING: 0012

TEMPORARY ROCK CHECK DAM

NOTE:

1. ROCK CHECK DAM SHALL BE WRAPPED UPSTREAM AS A BARRIER AGAINST JETTING AND SHOULD BE PLACED ALONG SLOPE.
2. ROCK CHECK DAM SHALL BE PLACED ALONG SLOPE.
3. ROCK CHECK DAM SHALL BE PLACED ALONG SLOPE.

USE DRAWING: 0012

TEMPORARY EXPOSURE BLANKETS

NOTE:

1. BLANKETS TO BE USED TO PROTECT EXPOSED SOIL FROM EROSION AND TO MAINTAIN SOIL MOISTURE.
2. BLANKETS SHALL BE PLACED ALONG SLOPE.
3. BLANKETS SHALL BE PLACED ALONG SLOPE.

USE DRAWING: 0012

TEMPORARY EXPOSURE BLANKETS

NOTE:

1. BLANKETS TO BE USED TO PROTECT EXPOSED SOIL FROM EROSION AND TO MAINTAIN SOIL MOISTURE.
2. BLANKETS SHALL BE PLACED ALONG SLOPE.
3. BLANKETS SHALL BE PLACED ALONG SLOPE.

USE DRAWING: 0012

WOOD MULCH BERM

NOTE:

1. WOOD MULCH BERM SHALL BE WRAPPED UPSTREAM AS A BARRIER AGAINST JETTING AND SHOULD BE PLACED ALONG SLOPE.
2. WOOD MULCH BERM SHALL BE PLACED ALONG SLOPE.
3. WOOD MULCH BERM SHALL BE PLACED ALONG SLOPE.

USE DRAWING: 0012

TEMPORARY ROCK CHECK DAM

NOTE:

1. ROCK CHECK DAM SHALL BE WRAPPED UPSTREAM AS A BARRIER AGAINST JETTING AND SHOULD BE PLACED ALONG SLOPE.
2. ROCK CHECK DAM SHALL BE PLACED ALONG SLOPE.
3. ROCK CHECK DAM SHALL BE PLACED ALONG SLOPE.

USE DRAWING: 0012

TYPICAL FOUNDATION EXCAVATION

NOTE:

1. EXCAVATION SHALL BE WRAPPED UPSTREAM AS A BARRIER AGAINST JETTING AND SHOULD BE PLACED ALONG SLOPE.
2. EXCAVATION SHALL BE PLACED ALONG SLOPE.
3. EXCAVATION SHALL BE PLACED ALONG SLOPE.

USE DRAWING: 0012

TEMPORARY EXPOSURE BLANKETS

NOTE:

1. BLANKETS TO BE USED TO PROTECT EXPOSED SOIL FROM EROSION AND TO MAINTAIN SOIL MOISTURE.
2. BLANKETS SHALL BE PLACED ALONG SLOPE.
3. BLANKETS SHALL BE PLACED ALONG SLOPE.

USE DRAWING: 0012

WOOD MULCH BERM

NOTE:

1. WOOD MULCH BERM SHALL BE WRAPPED UPSTREAM AS A BARRIER AGAINST JETTING AND SHOULD BE PLACED ALONG SLOPE.
2. WOOD MULCH BERM SHALL BE PLACED ALONG SLOPE.
3. WOOD MULCH BERM SHALL BE PLACED ALONG SLOPE.

USE DRAWING: 0012

TEMPORARY ROCK CHECK DAM

NOTE:

1. ROCK CHECK DAM SHALL BE WRAPPED UPSTREAM AS A BARRIER AGAINST JETTING AND SHOULD BE PLACED ALONG SLOPE.
2. ROCK CHECK DAM SHALL BE PLACED ALONG SLOPE.
3. ROCK CHECK DAM SHALL BE PLACED ALONG SLOPE.

USE DRAWING: 0012

Northwest Ohio Wind Project Faulkner County, Ohio

Construction Details

Issued For Construction
 Army Date 11/17/2014
 Date 11/17/16
 Sheet 4 of 9

Northwest Professional Services, Inc.

10000 Northway Drive
 Suite 100
 Columbus, Ohio 43240
 Phone: 614.291.1234
 Fax: 614.291.1235
 Email: info@nwps.com

Northwest

10000 Northway Drive
 Suite 100
 Columbus, Ohio 43240
 Phone: 614.291.1234
 Fax: 614.291.1235
 Email: info@nwps.com

STARWOOD ENERGY GROUP

10000 Northway Drive
 Suite 100
 Columbus, Ohio 43240
 Phone: 614.291.1234
 Fax: 614.291.1235
 Email: info@starwoodenergy.com

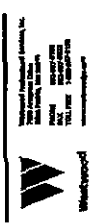

Client:	Starwood Energy Group, Inc.
Project:	Northwest Ohio Wind Project
Location:	Paulding County, Ohio
Scale:	1" = 100'
North Arrow:	
Drawn By:	J. [Name]
Checked By:	[Name]
Approved By:	[Name]
Date:	11/19/16
Sheet:	6 OF 9



Northwest Ohio Wind Project

Paulding County, Ohio
Civil Site Plan T-46,
T-49

Issued For Construction
Army Date 11/17/2014
Date 11/19/16
Sheet 6 OF 9
C:\Users\jgiblin\OneDrive\Documents\Northwest Ohio Wind Project\T-46, T-49\T-46, T-49.dwg

LEGEND	TURBINE LOCATION
[Symbol]	TURBINE NUMBER
[Symbol]	PROPOSED ACCESS ROAD
[Symbol]	PROPOSED EXCAVATOR PATH
[Symbol]	PROPOSED DISTURBANCE LIMITS
[Symbol]	PROPOSED EROSION/SEDIMENT CONTROL
[Symbol]	EXISTING OVERHEAD POWER
[Symbol]	EXISTING OIL/GAS PIPELINE
[Symbol]	EXISTING 1" CONTIGUOUS
[Symbol]	EXISTING 2" CONTIGUOUS
[Symbol]	DELINEATED WETLAND
[Symbol]	EXISTING ROAD
[Symbol]	OUT OF PROJECT BOUNDARY
[Symbol]	FEMA FLOODPLAIN BOUNDARY
[Symbol]	PROPOSED CULVERT

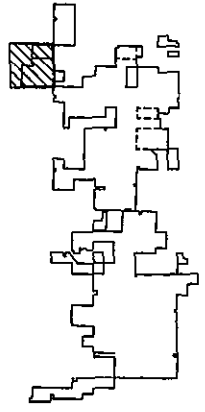

KEY MAP

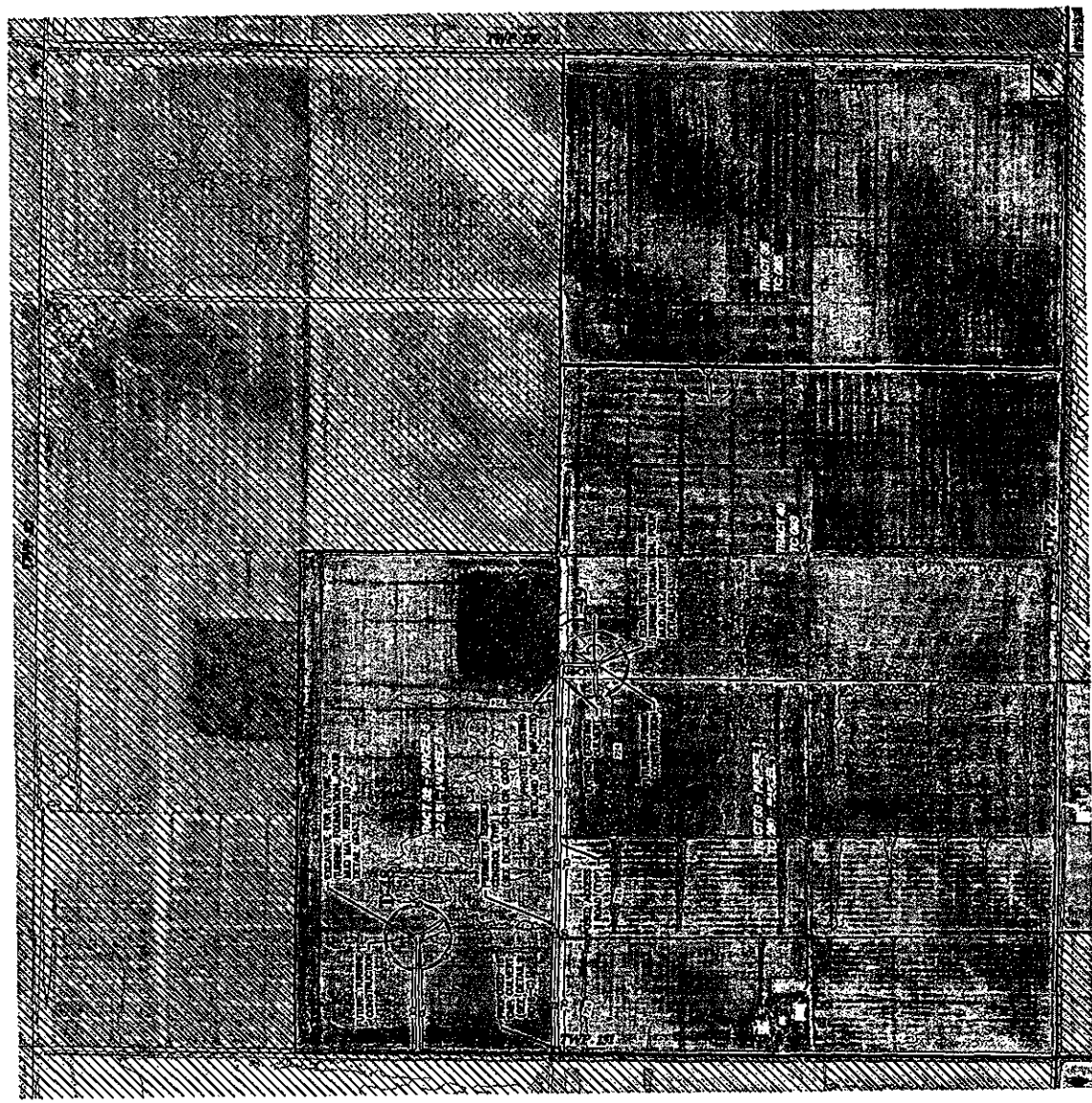

[illegible]

**Northwest
Ohio Wind
Project**
Paulding County, Ohio

Cell Site Plan T-39,
T-40

Issued For Construction
Army Date 11/11/2014
Date 11/12/16
Sheet 8 of 9

00000000-00000000

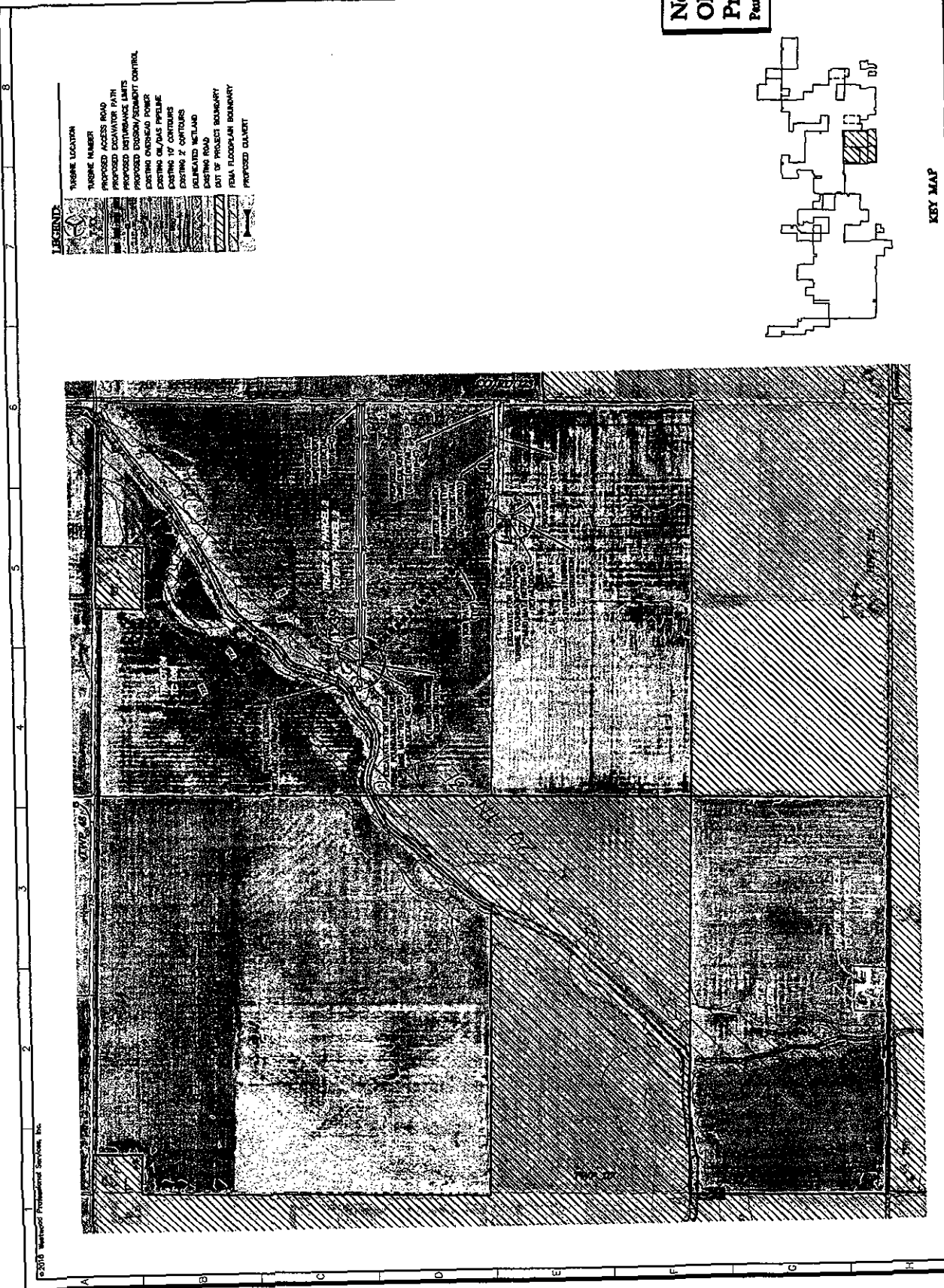

KEY MAP

[illegible]

**Northwest
Ohio Wind
Project**
Paulding County, Ohio

Yard Site Plan T-46

Issued For Construction
Army Date 11/11/2014
Date 11/18/16
Sheet 9 OF 9

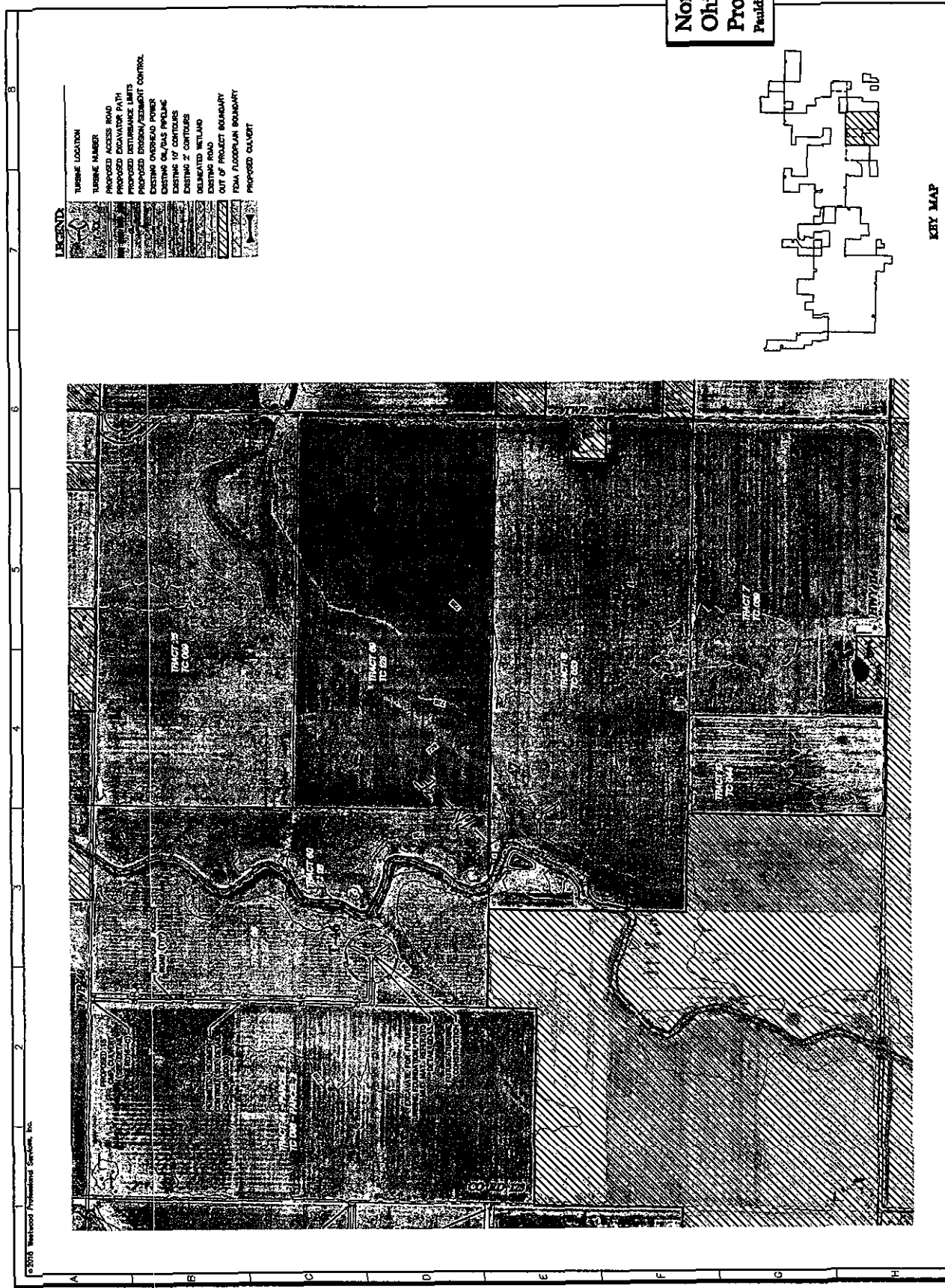

LEGEND:

- | TURBINE LOCATION | TURBINE NUMBER | PROPOSED ACCESS ROAD | PROPOSED EXCAVATION PATH | PROPOSED DISTURBANCE LIMITS | PROPOSED EROSION/SEALMENT CONTROL |
|------------------|----------------|----------------------|--------------------------|-----------------------------|-----------------------------------|
| | 1 | | | | |
| | 2 | | | | |
| | 3 | | | | |
| | 4 | | | | |
| | 5 | | | | |
| | 6 | | | | |
| | 7 | | | | |
| | 8 | | | | |
| | 9 | | | | |
| | 10 | | | | |
| | 11 | | | | |
| | 12 | | | | |
| | 13 | | | | |
| | 14 | | | | |
| | 15 | | | | |
| | 16 | | | | |
| | 17 | | | | |
| | 18 | | | | |
| | 19 | | | | |
| | 20 | | | | |
| | 21 | | | | |
| | 22 | | | | |
| | 23 | | | | |
| | 24 | | | | |
| | 25 | | | | |
| | 26 | | | | |
| | 27 | | | | |
| | 28 | | | | |
| | 29 | | | | |
| | 30 | | | | |
| | 31 | | | | |
| | 32 | | | | |
| | 33 | | | | |
| | 34 | | | | |
| | 35 | | | | |
| | 36 | | | | |
| | 37 | | | | |
| | 38 | | | | |
| | 39 | | | | |

KEY MAP