

RECEIVED-DOCKETING DIV

2016 JUN 14 PM 1:26

**Public Utilities
Commission of Ohio**

PUCO

Memo

To: Docketing Division
From: George Martin, Grade Crossing Planner, Rail Division
Re: In the matter of the authorization of the Wheeling & Lake Erie Railway to install an active grade warning device in Summit County
Date: June 14, 2016

The Ohio Rail Development Commission (ORDC) has authorized funding for the Wheeling & Lake Erie Railway (WE) to install mast-mounted flashing lights and roadway gates at Summit County, near Tallmadge, Southeast Ave/SR 532, DOT# 472648G. The crossing was surveyed on October 15, 2015, and was found to warrant the upgrade. The electric utility provider at the crossing is Ohio Edison.

The project will be paid for with federal funds, and is actual cost. The plan and estimate for the project in the amount of \$202,968.11 has been approved. Construction may commence at once. Staff requests a Finding & Order with completion of the project within 9 months and that the following language be incorporated in the Finding & Order:

It is expected that all work necessary for FHWA acceptance of the warning devices will be completed by the in-service due date and that the railroad will be responsible for this work. This work includes, but is not limited to:

Any ancillary work to make the warning devices function as designed and visible to the roadway user, and

MUTCD compliance, including minor roadway work if necessary.

A suggested case coding and heading would be:

PUCO Case No. 16- *1377* -RR-FED: In the matter of the authorization of the Wheeling & Lake Erie Railway to install an active grade crossing warning device in Summit County

C: Legal Department

Please serve the following parties of record

Ms Cathy Stout

Ohio Rail Development Commission

1980 West Broad St, Mailstop #3140

Columbus, Oh 43223

Mr Tim Andrews

Wheeling & Lake Erie Railway

100 East First St

Brewster, Oh 44613

Mr Bryan Esler, Director of Public Service

City Hall

46 North Ave

Tallmadge, Oh 44278

Ohio Edison

**OHIO RAIL DEVELOPMENT COMMISSION
INTER-OFFICE COMMUNICATION**

TO: Randall Schumacher, Rail Division, PUCO
FROM: Cathy Stout, Manager, Safety Section, ORDC
BY: James Tucker, Project Manager, ORDC J.T.
SUBJECT: Summit County, SR 532, Southeast Ave. DOT 472648G
Wheeling & Lake Erie, PID 101954
DATE: June 13, 2016

The Public Utilities Commission of Ohio (PUCO) established a diagnostic survey at the subject location on October 15, 2015. The Ohio Rail Development Commission (ORDC) attended the review. The Diagnostic Team recommended the improvement of warning devices to flashing lights and roadway gates. Copies of the diagnostic review form and the plan and estimate are attached.

PE has already been provided by the railroad. ORDC approves the site plans and estimates as provided. Please issue a construction-only order for the project outlined above. This construction authorization is made with the stipulation and understanding that any field work needs prior approval before the work begins. This authorization is made with the stipulation and understanding that an approved estimate may contain entries for items or activities that may be cited and found to be ineligible for federal participation during the project audit.

It is expected that all work necessary for FHWA acceptance of the warning devices will be completed by the in-service due date and that the railroad will be responsible for this work. This work includes, but is not limited to:

- any ancillary work to make warning devices function as designed and visible to the roadway user, and
- MUTCD compliance – including minor roadway work if necessary.

Thank you for your assistance with these matters.

Attachment: Diagnostic Review
Plan & Estimate

c: George Martin, PUCO
ORDC Project Manager (file)



OHIO RAIL DEVELOPMENT COMMISSION

Mail Stop #3140, 1980 West Broad Street, Columbus OH 43223

John R. Kasich, Governor • Mark Policinski, ORDC Chairman

June 13, 2016

Mr. Tim Andrews
Wheeling & Lake Erie Railway
100 East First Street
Brewster, Ohio 44613

RE: Summit County, SR 532/Southeast Ave.
DOT 472648G, PID# 101954

Dear Mr. Andrews:

The plan and estimate dated February 24, 2016, for the referenced project has been reviewed and is acceptable. WLE may proceed with the construction of the proposed grade crossing warning system in accordance with the abbreviated plan. This authorization is made with the stipulation and understanding that the approved estimate may contain entries for items or activities that may be cited and found to be ineligible for federal participation during the project audit. Reimbursement of eligible actual cost is limited to \$202,968.11. Additional costs must be approved in writing by the Ohio Rail Development Commission (ORDC) prior to being incurred. Emergency verbal authorizations by ORDC may be permitted and will be confirmed by ORDC in writing within ten (10) business days of the verbal approval.

This authorization is contingent upon WLE accepting the following instructions:

1. WLE's project foreman will furnish written notification five (5) working days prior to the date work will start at the project site to James Tucker, ORDC, email James.tucker@dot.state.oh.us and to the Public Utilities Commission of Ohio at George.martin@puc.state.oh.us. WLE's project foreman will also notify the same of any stops and re-starts of the work activity and of the date work was completed for the project.
2. WLE will arrange for utilities to be located at the project site by the Ohio Utilities Protection Service (OUPS) prior to any construction activities at the site. Utilities that are not participating members of the service must be contacted directly by WLE.
3. WLE's project foremen will notify James Tucker at James.tucker@dot.state.oh.us (email) of any changes in the scope of work, cost overruns, material changes, etc. which are not included in the approved plan and estimate and secure approval of same before the work is performed.
4. Open cut of roadways is not permitted except in unusual circumstances and must be coordinated with the local highway authority and preapproved by ORDC.
5. WLE will furnish two (2) copies of each partial bill to ORDC. Please find the enclosed ODOT Purchase Order to reference when billing.



www.rail.ohio.gov

phone: 614.644.0306

IMPROVING RAIL TODAY FOR TOMORROW'S ECONOMY

6. WLE will furnish two (2) copies of the final all-inclusive bill to ORDC stating the exact dates of starting and completing work, the initial and final dates of construction and location where the accounts may be audited.
7. This installation will include any ancillary work to make the warning devices function as designed and meet MUTCD.

Thank you for your assistance with these matters.

Sincerely,

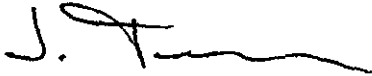
A handwritten signature in black ink, appearing to read 'J. Tucker', with a long horizontal flourish extending to the right.

James Tucker
Project Manager

C: Randall Schumacher, Rail Division Supervisor, PUCO
George Martin, Grade Crossing Planner, PUCO
Susan Arduini, ORDC
ORDC (file)



Diagnostic Review Team Survey

Reason for Survey: Formula
(e.g. formula, accident, constituent, etc.)

Date: 10-15-15

Location Data

Street or Road Name: Southeast Ave			
Route/Road Number (i.e. Twp., Co., SR or US) SR 532-3.13		US DOT No.: 472648G	
County: SUM	Township:	City: (In or Near)	City of Tallmadge
Railroad Name: Wheeling & Lake Erie RR	Railroad Division: WLE System	Branch/Line Name:	Main
Nearest RR Timetable Station:		RR Milepost: 38.66	

On-Site Review Team

(Include: Name - Organization - Phone Number - Email)

1. James Tucker 614-398-6897 ORDC
2. Randy Johr 330-495-3810 PUCO
3. George MARTIN PUCO 614-752-9107
4. Bryan Esler 330-633-0854 Tallmadge
5. Brian Honaker 330-786-4813 ODOT D-4
6. Tim Andrews 330-417-5541 WLE
- 7.
- 8.
- 9.

Existing Traffic Control Devices

Type of Warning Devices	Installed?		Quantity/Comments
Advance Warning Signs (condition?)	<input checked="" type="checkbox"/> Yes	<input type="checkbox"/> No	
'Stop' Signs	<input type="checkbox"/> Yes	<input checked="" type="checkbox"/> No	
'Stop Ahead' Signs	<input type="checkbox"/> Yes	<input checked="" type="checkbox"/> No	
Pavement Markings (condition?)	<input checked="" type="checkbox"/> Yes	<input type="checkbox"/> No	
Crossbucks	<input checked="" type="checkbox"/> Yes	<input type="checkbox"/> No	2
Number of Tracks Signs	<input type="checkbox"/> Yes	<input checked="" type="checkbox"/> No	
Inventory Tags	<input checked="" type="checkbox"/> Yes	<input type="checkbox"/> No	
Interconnected Highway Traffic Signal	<input type="checkbox"/> Yes	<input checked="" type="checkbox"/> No	
Mast-Mounted Flashing Lights	<input checked="" type="checkbox"/> Yes	<input type="checkbox"/> No	
Cantilever Flashing Lights	<input type="checkbox"/> Yes	<input checked="" type="checkbox"/> No	Number: Length:
Side Lights	<input type="checkbox"/> Yes	<input checked="" type="checkbox"/> No	
Automatic Gates	<input type="checkbox"/> Yes	<input checked="" type="checkbox"/> No	Number: Length:
Bells	<input checked="" type="checkbox"/> Yes	<input type="checkbox"/> No	Number: 1
Sidewalk Gate Arms	<input type="checkbox"/> Yes	<input checked="" type="checkbox"/> No	
'No Turn' Signs	<input type="checkbox"/> Yes	<input checked="" type="checkbox"/> No	
Illumination	<input checked="" type="checkbox"/> Yes	<input type="checkbox"/> No	
Is crossing flagged by train crew?	<input type="checkbox"/> Yes	<input checked="" type="checkbox"/> No	
Other	<input type="checkbox"/> Yes	<input type="checkbox"/> No	

Safety Data (Obtain crash reports, if possible, prior to review)

	Initial Information (from database)	Revised
Number & dates of crashes in previous 5 years	0 (11/24/94)	
Hazard Ranking	1137 Date Run: 8/18/15	

Railroad Data

Railroad Characteristics	Initial Information (from database)	Revised
Total trains per day	6	
< 1 per day		
Day thru trains	4	
Night thru trains	2	
Daytime switching movements		
Nighttime switching movements		
Total number of tracks	1	
Number of main tracks	1	
Number of other tracks		
Maximum train speed	30	25
Typical train speed	30	25
Amtrak		

If non-gated crossing, is clearing sight distance adequate in all quadrants? (See Table 1) ☐ Yes ☒ No

If multiple tracks, can two trains occupy crossing at the same time? ☐ Yes ☒ No

Can one train block the motorists' view of another train at crossing? ☐ Yes (Explain below) ☒ No

Can one or more tracks be eliminated through the crossing? ☐ Yes ☒ No

Are there other track(s) crossing this same roadway within 100 ft of this crossing? ☐ Yes ☒ No

If yes, Crossing DOT # (if different) _____

If yes, distance _____ (take measurement between track centerlines at closest point along roadway)

Roadway Data

Local Highway Authority: State of Ohio/City of Tallmadge

Roadway Characteristics	Initial Information (from database)	Revised
Average daily traffic	8066 (2012)	8320 10-8-15 COUNT
Highway paved	<input checked="" type="checkbox"/> Yes <input type="checkbox"/> No	<input type="checkbox"/> Yes <input type="checkbox"/> No
Roadway Surface: <input checked="" type="checkbox"/> Blacktop <input type="checkbox"/> Gravel <input type="checkbox"/> Concrete <input type="checkbox"/> Other _____		
Roadway width: 24 ft.		
Number of highway lanes	2	
Urban or Rural	Urban	
Vehicle Speed: 35 MPH		
School Bus Operation: <input type="checkbox"/> No <input checked="" type="checkbox"/> Yes 5 Amount		
Hazardous Materials Trucks: <input type="checkbox"/> No <input checked="" type="checkbox"/> Yes 04 Amount		
Shoulders: <input type="checkbox"/> No <input checked="" type="checkbox"/> Yes		
Is the shoulder surfaced? <input checked="" type="checkbox"/> No <input type="checkbox"/> Yes		
Is there existing guardrail along roadway in crossing vicinity? <input type="checkbox"/> No <input checked="" type="checkbox"/> Yes		
Is stopping site distance adequate? (See Table 2) <input checked="" type="checkbox"/> Yes <input type="checkbox"/> No If no, deficient approach(es) _____		

Quadrant <u>NW</u> Curb and Gutter: <input type="checkbox"/> Functional (Curb height = 4" or more) <input type="checkbox"/> Non-functional (Curb height = Less than 4") <input checked="" type="checkbox"/> None	Quadrant <u>SE</u> Curb and Gutter: <input type="checkbox"/> Functional (Curb height = 4" or more) <input type="checkbox"/> Non-functional (Curb height = Less than 4") <input checked="" type="checkbox"/> None
Pedestrians: <input checked="" type="checkbox"/> No <input type="checkbox"/> Yes	
Is sidewalk present? <input checked="" type="checkbox"/> No <input type="checkbox"/> Yes	
Is there a nearby intersection that could cause queuing over the crossing? <input checked="" type="checkbox"/> No <input type="checkbox"/> Yes If yes, Distance _____	
Is this intersection signalized? <input type="checkbox"/> No <input type="checkbox"/> Yes	
Are the signals currently interconnected with the existing crossing warning devices? <input checked="" type="checkbox"/> No <input type="checkbox"/> Yes	
Is there a 'Do not Stop on Track' sign? <input checked="" type="checkbox"/> No <input type="checkbox"/> Yes	
Is a roadway improvement project (e.g. widening, turn lanes, nearby new or upgraded traffic signal, sidewalk) planned at or near this location in the foreseeable future? <input checked="" type="checkbox"/> No <input type="checkbox"/> Yes If yes, Improvement type _____ Lead Agency _____ Timeline/completion - _____	
Is it the consensus of the Diagnostic Review Team that this is a potential closure project? <input checked="" type="checkbox"/> No <input type="checkbox"/> Yes Explain reasons: _____	

Type of Development

<input type="checkbox"/> Open Space <input type="checkbox"/> Industrial <input checked="" type="checkbox"/> Residential	<input type="checkbox"/> Institutional <input checked="" type="checkbox"/> Commercial	Location of nearby schools: <div style="font-size: 2em; text-align: center;">N/A</div>
---	--	---

Utility Information

Is commercial power available? ☐ No ☒ Yes

Utility Provider (Company Name) Ohio Edison Phone Number _____

Nearest Available Power Source Power Already @ Sign

What other utilities are present? (add locations to sketch)

<input checked="" type="checkbox"/> Gas	<input type="checkbox"/> Cable	<input type="checkbox"/> Telephone	<input checked="" type="checkbox"/> Fiber Optic Cable
<input type="checkbox"/> Petroleum	<input type="checkbox"/> Water	<input type="checkbox"/> Sanitary Sewer	
<input type="checkbox"/> Other _____			

Is(are) there potential utility conflict(s) ☒ Yes ☐ No ☐ Unknown

Comments:

underground fiber optic and gas issues w/ the SW/NE QUADS.

Potential Red Flags / Project Challenges

Traffic Signal Preemption (include traffic signal intersection name and LHA with jurisdiction over traffic signal, if known):

N/A

Crossing Consolidation or Closure:

N/A

Real Estate or ROW:

Row issue in S.W Quad for House placement

Culverts / Drainage / Ballast Conditions:

N/A

Roadway and/or Sidewalks:

N/A

Circuitry (e.g. reaches out to other crossings, specific needs, etc.):

~~N/A~~ Siding circuits on west side

Environmental:

N/A

Other:

Diagnostic Team Recommendations

	Quadrants Needed
<input checked="" type="checkbox"/> Install/upgrade active devices	
<input type="checkbox"/> Automatic Flashing Lights (AFLS)	
<input type="checkbox"/> AFLS / Cants	
<input checked="" type="checkbox"/> AFLS / Gates	SW / NE Quad.
<input type="checkbox"/> AFLS / Gates / Cants	
<input checked="" type="checkbox"/> Bells / number	1
<input type="checkbox"/> Upgrade circuitry / type	
<input type="checkbox"/> Sidelights	
<input type="checkbox"/> Guardrail Needed	
<input type="checkbox"/> Install/Replace curb	
<input checked="" type="checkbox"/> Bungalow placement & offset from rail & highway	SW Quad
<input type="checkbox"/> Other (define)	

Comments:

- ☐ Install/upgrade traffic signal preemption
☐ No improvements needed
☐ Other (define)

Acknowledgement of Recommendations (each entity represented at the diagnostic must have at least one signature acknowledgement):

Cam
 TSA
 Kang John
 Brian Honaker
 J. T.
 Bryan C.

Field Dimensions

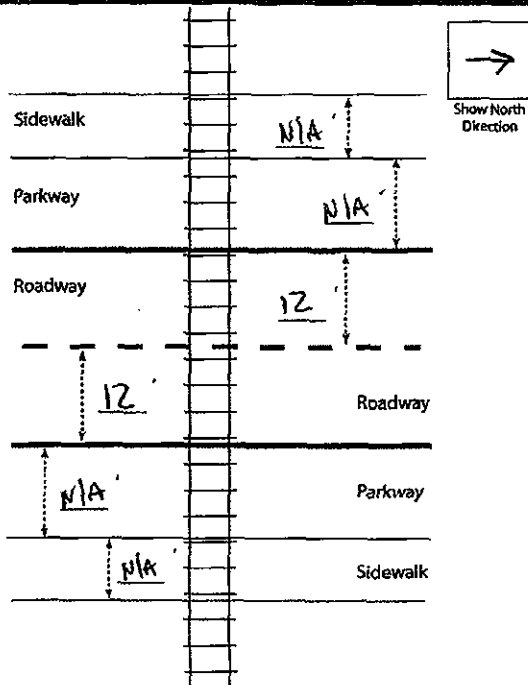

Southeast Ave.

Field Sketch

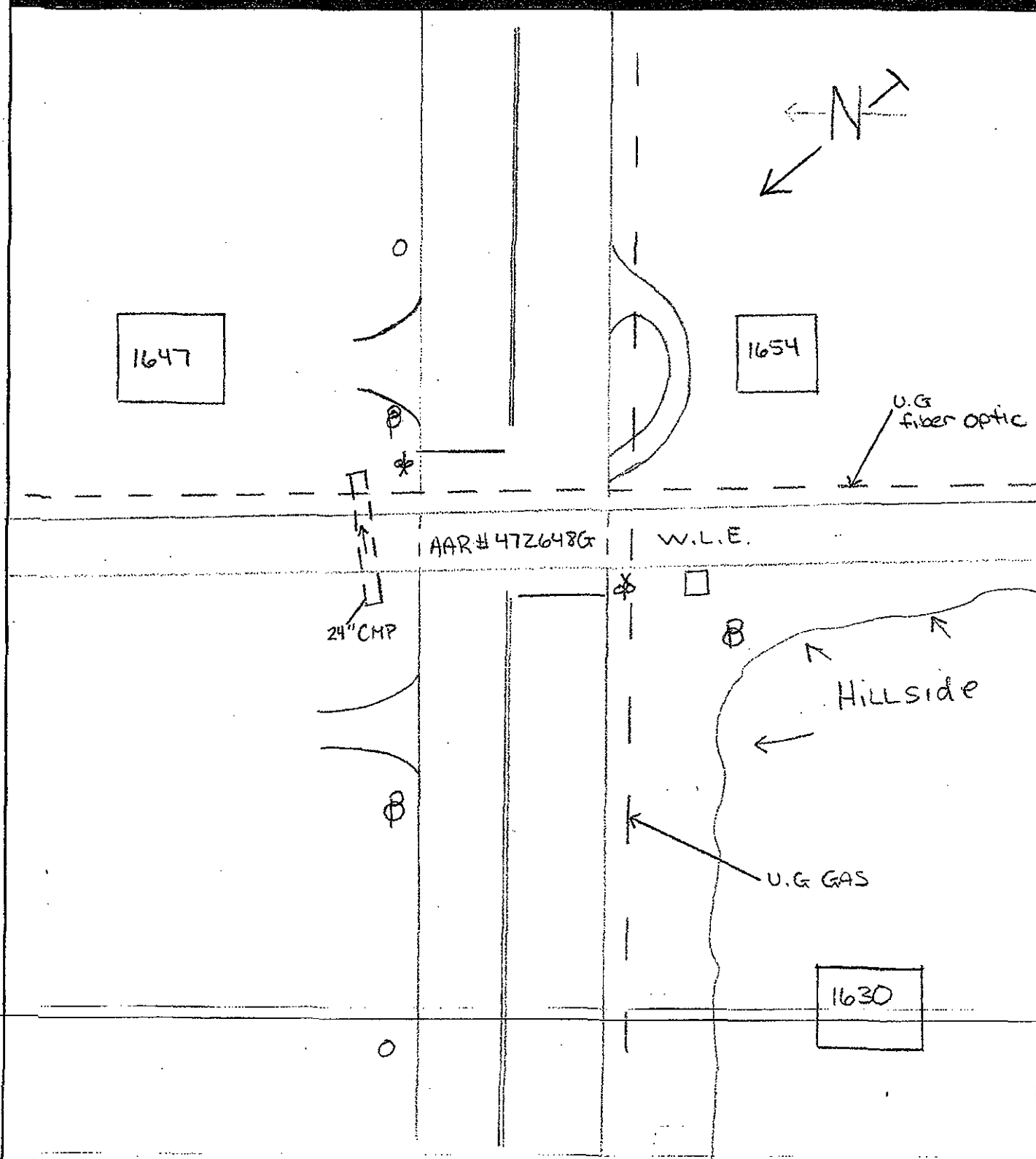

Crossing Angle ☐ 0-29° ☐ 30-59° ☐ 60-90° Measured in _____ Quadrant?

Sketch by: _____

TABLE 1

Clearing Sight Distances

Maximum Authorized Train Speed	Distance (dT) Along Railroad from Crossing (ft)
1 - 10	240
15	360
20	480
25	600
30	720
35	840
40	960
45	1080
50	1200
55	1320
60	1440
65	1560
70	1680
75	1800
80	1920
85	2040
90	2160

Source: R-H Grade Crossing Handbook Table 36 (pp. 132-133)

Notes:

All calculated distances are rounded up to the next higher 5-foot increment.

Distances indicated are for 65-ft double bottom semi-tractor trailers and level single track 90 degree crossings; and may need to be adjusted for multiple tracks, skewed crossings or approaches on grades.

Clearing Sight Distance is to be measured in each vehicle travel direction at non-gated crossings as viewed from a point 25 feet from centerline of nearest track in the center of whichever travel lane is nearest the direction along track being measured.

Table 2

Stopping Sight Distances

Highway Vehicle Speed	Distance (dH) Along Roadway from Crossing (ft)
0	n/a
5	50
10	70
15	105
20	135
25	180
30	225
35	280
40	340
45	410
50	490
55	570
60	660
65	760
70	865

Source: R-H Grade Crossing Handbook Table 36 (pp. 132-133)

Notes:

All calculated distances are rounded up to the next higher 5-foot increment.

Distances indicated are for 65-ft double bottom semi-tractor trailers on dry level pavements.

Stopping Sight Distance is to be measured on each roadway approach to crossing from stop bar.