

***The Public Utilities Commission of Ohio***  
**TELECOMMUNICATIONS FILING FORM**

(Effective: 01/20/2011)

This form is intended to be used with most types of required filings. It provides check boxes with rule references for the most common types of filings. It does not replace or supersede Commission rules in any way.

In the Matter of the Application of AT&T Ohio )  
To Change an Exchange Area Boundary Between )  
Its Middletown and Monroe Exchanges. )

TRF Docket No. 90-\_\_\_\_\_

Case No. 13 - 1107 - **TP** - ACB

**NOTE: Unless you have reserved a Case #, leave the "Case No" fields BLANK.**

Name of Registrant(s) The Ohio Bell Telephone Company

DBA(s) of Registrant(s) AT&T Ohio

Address of Registrant(s) 150 E. Gay St., Room 4C, Columbus, Ohio 43215

Company Web Address [www.att.com](http://www.att.com)

Regulatory Contact Person(s) Jon F. Kelly

Phone 614-223-7928

Fax 614-223-5955

Regulatory Contact Person's Email Address [jk2961@att.com](mailto:jk2961@att.com)

Contact Person for Annual Report Michael R. Schaedler

Phone 216-822-8307

Address (if different from above) 45 Erieview Plaza, Room 1600, Cleveland, Ohio 44114

Consumer Contact Information Michael R. Schaedler

Phone 216-822-8307

Address (if different from above) 45 Erieview Plaza, Room 1660, Cleveland, Ohio 44114

Motion for protective order included with filing? ☐ Yes ☒ No

Motion for waiver(s) filed affecting this case? ☐ Yes ☒ No [Note: Waivers may toll any automatic timeframe.]

**Notes:**

Section I and II are Pursuant to Chapter [4901:1-6 OAC](#)

Section III – Carrier to Carrier is Pursuant to [4901:1-7](#) OAC, and Wireless is Pursuant to [4901:1-6-24](#) OAC.

Section IV – Attestation

(1) Indicate the Carrier Type and the reason for submitting this form by checking the boxes below.

(2) For requirements for various applications, see the identified section of Ohio Administrative Code Section 4901 and/or the supplemental application form noted.

(3) Information regarding the number of copies required by the Commission may be obtained from the Commission's web site at [www.puco.ohio.gov](http://www.puco.ohio.gov) under the docketing information system section, by calling the docketing division at 614-466-4095, or by visiting the docketing division at the offices of the Commission.

(4) An Incumbent Local Exchange Carrier (ILEC) offering basic local exchange service (BLES) outside its traditional service area should choose CLEC designation when proposing to offer BLES outside its traditional service area or when proposing to make changes to that service.

**All Filings that result in a change to one or more tariff pages require, at a minimum, the following exhibits.**

Exhibit	Description:
A	The tariff pages subject to the proposed change(s) as they exist before the change(s)
B	The Tariff pages subject to the proposed change(s), reflecting the change, with the change(s) marked in the right margin.
C	A short description of the nature of the change(s), the intent of the change(s), and the customers affected.
D	A copy of the notice provided to customers, along with an affidavit that the notice was provided according to the applicable rule(s).

## Section I – Part I - Common Filings

<b>Carrier Type</b> <input type="checkbox"/> <b>Other</b> (explain below)	<input checked="" type="checkbox"/> <b>For Profit ILEC</b>	<input type="checkbox"/> <b>Not For Profit ILEC</b>	<input type="checkbox"/> <b>CLEC</b>
Change terms & conditions of existing BLES	<input type="checkbox"/> ATA <a href="#">1-6-14(H)</a> (Auto 30 days)	<input type="checkbox"/> ATA <a href="#">1-6-14(H)</a> (Auto 30 days)	<input type="checkbox"/> ATA <a href="#">1-6-14(H)</a> (Auto 30 days)
Introduce non-recurring charge, surcharge, or fee to BLES			<input type="checkbox"/> ATA <a href="#">1-6-14(H)</a> (Auto 30 days)
Introduce or Increase Late Payment	<input type="checkbox"/> ATA <a href="#">1-6-14(I)</a> (Auto 30 days)	<input type="checkbox"/> ATA <a href="#">1-6-14(I)</a> (Auto 30 days)	<input type="checkbox"/> ATA <a href="#">1-6-14(I)</a> (Auto 30 days)
Revisions to BLES Cap.	<input type="checkbox"/> ZTA <a href="#">1-6-14(F)</a> (0 day Notice)		
Introduce BLES or expand local service area (calling area)	<input type="checkbox"/> ZTA <a href="#">1-6-14(H)</a> (0 day Notice)	<input type="checkbox"/> ZTA <a href="#">1-6-14(H)</a> (0 day Notice)	<input type="checkbox"/> ZTA <a href="#">1-6-14(H)</a> (0 day Notice)
Notice of no obligation to construct facilities and provide BLES	<input type="checkbox"/> ZTA <a href="#">1-6-27(C)</a> (0 day Notice)	<input type="checkbox"/> ZTA <a href="#">1-6-27(C)</a> (0 day Notice)	
Change BLES Rates	<input type="checkbox"/> TRF <a href="#">1-6-14(F)</a> (0 day Notice)	<input type="checkbox"/> TRF <a href="#">1-6-14(F)(4)</a> (0 day Notice)	<input type="checkbox"/> TRF <a href="#">1-6-14(G)</a> (0 day Notice)
To obtain BLES pricing flexibility	<input type="checkbox"/> BLS <a href="#">1-6-14(C)(1)(c)</a> (Auto 30 days)		
Change in boundary	<input checked="" type="checkbox"/> ACB <a href="#">1-6-32</a> (Auto 14 days)	<input type="checkbox"/> ACB <a href="#">1-6-32</a> (Auto 14 days)	
Expand service operation area			<input type="checkbox"/> TRF <a href="#">1-6-08(G)</a> (0 day)
BLES withdrawal			<input type="checkbox"/> ZTA <a href="#">1-6-25(B)</a> (0 day Notice)
<b>Other*</b> (explain) _____			

## Section I – Part II – Customer Notification Offerings Pursuant to Chapter [4901:1-6-7 OAC](#)

Type of Notice	Direct Mail	Bill Insert	Bill Notation	Electronic Mail
<input type="checkbox"/> 15-day Notice	<input type="checkbox"/>	<input type="checkbox"/>	<input type="checkbox"/>	<input type="checkbox"/>
<input type="checkbox"/> 30-day Notice	<input type="checkbox"/>	<input type="checkbox"/>	<input type="checkbox"/>	<input type="checkbox"/>
<b>Date Notice Sent:</b>				

## Section I – Part III –IOS Offerings Pursuant to Chapter [4901:1-6-22 OAC](#)

IOS	Introduce New	Tariff Change	Price Change	Withdraw
<input type="checkbox"/> IOS	<input type="checkbox"/>	<input type="checkbox"/>	<input type="checkbox"/>	<input type="checkbox"/>

## Section II – Part I – Carrier Certification - Pursuant to Chapter [4901:1-6-08, 09 & 10 OAC](#)

Certification	ILEC (Out of Territory)	CLEC	Carrier's Not Offering BLES	CESTC	CETC
* See Supplemental form	<input type="checkbox"/> ACE <a href="#">1-6-08</a> * (Auto 30- day)	<input type="checkbox"/> ACE <a href="#">1-6-08</a> * (Auto 30 day)	<input type="checkbox"/> ACE <a href="#">1-6-08</a> * (Auto 30 day)	<input type="checkbox"/> ACE <a href="#">1-6-10</a> (Auto 30 day)	<input type="checkbox"/> UNC <a href="#">1-6-09</a> * (Non-Auto)

\*Supplemental Certification forms can be found on the Commission Web Page.

## Section II – Part II – Certificate Status & Procedural

Certificate Status	ILEC	CLEC	Carrier's Not Offering BLES
Abandon all Services		<input type="checkbox"/> ABN <a href="#">1-6-26</a> (Auto 30 days)	<input type="checkbox"/> ABN <a href="#">1-6-26</a> (Auto 30 days)
Change of Official Name *	<input type="checkbox"/> ACN <a href="#">1-6-29(B)</a> (Auto 30 days)	<input type="checkbox"/> ACN <a href="#">1-6-29(B)</a> (Auto 30 days)	<input type="checkbox"/> CIO <a href="#">1-6-29(C)</a> (0 day Notice)
Change in Ownership *	<input type="checkbox"/> ACO <a href="#">1-6-29(E)</a> (Auto 30 days)	<input type="checkbox"/> ACO <a href="#">1-6-29(E)</a> (Auto 30 days)	<input type="checkbox"/> CIO <a href="#">1-6-29(C)</a> (0 day Notice)
Merger *	<input type="checkbox"/> AMT <a href="#">1-6-29(E)</a> (Auto 30 days)	<input type="checkbox"/> AMT <a href="#">1-6-29(E)</a> (Auto 30 days)	<input type="checkbox"/> CIO <a href="#">1-6-29(C)</a> (0 day Notice)
Transfer a Certificate *	<input type="checkbox"/> ATC <a href="#">1-6-29(B)</a> (Auto 30 days)	<input type="checkbox"/> ATC <a href="#">1-6-29(B)</a> (Auto 30 days)	<input type="checkbox"/> CIO <a href="#">1-6-29(C)</a> (0 day Notice)
Transaction for transfer or lease of property, plant or business *	<input type="checkbox"/> ATR <a href="#">1-6-29(B)</a> (Auto 30 days)	<input type="checkbox"/> ATR <a href="#">1-6-29(B)</a> (Auto 30 days)	<input type="checkbox"/> CIO <a href="#">1-6-29(C)</a> (0 day Notice)

\* Other exhibits may be required under the applicable rule(s). ACN, ACO, AMT, ATC, ATR and CIO applications see [the 4901:1-6-29 Filing Requirements on the Commission's Web Page](#) for a complete list of exhibits.

## Section III – Carrier to Carrier (Pursuant to [4901:1-7](#)), and Wireless (Pursuant to [4901:1-6-24](#))

Carrier to Carrier	ILEC	CLEC
Interconnection agreement, or amendment to an approved agreement	<input type="checkbox"/> NAG <a href="#">1-7-07</a> (Auto 90 day)	<input type="checkbox"/> NAG <a href="#">1-7-07</a> (Auto 90 day)
Request for Arbitration	<input type="checkbox"/> ARB <a href="#">1-7-09</a> (Non-Auto)	<input type="checkbox"/> ARB <a href="#">1-7-09</a> (Non-Auto)
Introduce or change c-t-c service tariffs,	<input type="checkbox"/> ATA <a href="#">1-7-14</a> (Auto 30 day)	<input type="checkbox"/> ATA <a href="#">1-7-14</a> (Auto 30 day)
Request rural carrier exemption, rural carrier suspension or modification	<input type="checkbox"/> UNC <a href="#">1-7-04</a> or 05 (Non-Auto)	
Changes in rates, terms & conditions to Pole Attachment, Conduit Occupancy and Rights- of-Way.	<input type="checkbox"/> UNC <a href="#">1-7-23(B)</a> (Non-Auto)	
<b>Wireless Providers</b> See <a href="#">4901:1-6-24</a>	<input type="checkbox"/> RCC [Registration & Change in Operations]	<input type="checkbox"/> NAG [Interconnection Agreement or

#### Section IV. – Attestation

Registrant hereby attests to its compliance with pertinent entries and orders issued by the Commission.

---

**AFFIDAVIT**  
***Compliance with Commission Rules***

I am an officer/agent of the applicant corporation, \_\_\_\_\_, and am authorized to make this statement on its behalf.

(Name)

Please Check ALL that apply:

☐ I attest that these tariffs comply with all applicable rules for the state of Ohio. I understand that tariff notification filings do not imply Commission approval and that the Commission's rules as modified and clarified from time to time, supersede any contradictory provisions in our tariff. We will fully comply with the rules of the state of Ohio and understand that noncompliance can result in various penalties, including the suspension of our certificate to operate within the state of Ohio.

☐ I attest that customer notices accompanying this filing form were sent to affected customers, as specified in Section II, in accordance with Rule 4901:1-6-7, Ohio Administrative Code.

I declare under penalty of perjury that the foregoing is true and correct.

Executed on (Date) \_\_\_\_\_ at (Location) \_\_\_\_\_

\*(Signature and Title) \_\_\_\_\_ (Date) \_\_\_\_\_

- *This affidavit is required for every tariff-affecting filing. It may be signed by counsel or an officer of the applicant, or an authorized agent of the applicant.*

---

**VERIFICATION**

I, Jon F. Kelly, verify that I have utilized the Telecommunications Filing Form for most proceedings provided by the Commission and that all of the information submitted here, and all additional information submitted in connection with this case, is true and correct to the best of my knowledge.

\*(Signature and Title) \_\_\_\_\_ /s/ Jon F. Kelly, General Attorney (Date) May 1, 2013

*\*Verification is required for every filing. It may be signed by counsel or an officer of the applicant, or an authorized agent of the applicant.*

---

***Send your completed Application Form, including all required attachments as well as the required number of copies, to:***

**Public Utilities Commission of Ohio  
Attention: Docketing Division  
180 East Broad Street, Columbus, OH 43215-3793**

***Or***

***Make such filing electronically as directed in Case No 06-900-AU-WVR***

## EXHIBIT C

This application is filed pursuant to section 4901:1-6-32 of the Commission's rules. AT&T Ohio proposes to change the boundary between two of its exchanges, namely the Middletown Exchange and the Monroe Exchange. No other ILEC is involved in this proposed boundary change. The boundary change will move the Monroe Exchange roughly 4,000 feet into the Middletown Exchange, extending then approximately 12,400 feet wide in order to provision service to an undeveloped tract. Presently, there are no customers being served in this tract. Thus, the proposed change does not adversely affect the service being furnished to any existing BLES subscriber. See the attached diagram for a more complete depiction of the proposed boundary change. Further, the Company will work with Staff to ensure the Commission's maps are accurate and accurately reflect this boundary change.

The Company proposes this boundary change to initially accommodate a large commercial customer that will be locating in the tract with service from its Monroe Exchange, which presently has sufficient nearby facilities in place to readily provision the required service. To provision service from the Middletown Exchange would require a costly and time consuming build-out and placement of facilities from the Middletown Central Office. Thus, the public interest would be served by the proposed change.

REVISED  
6-21-71  
7-22-75

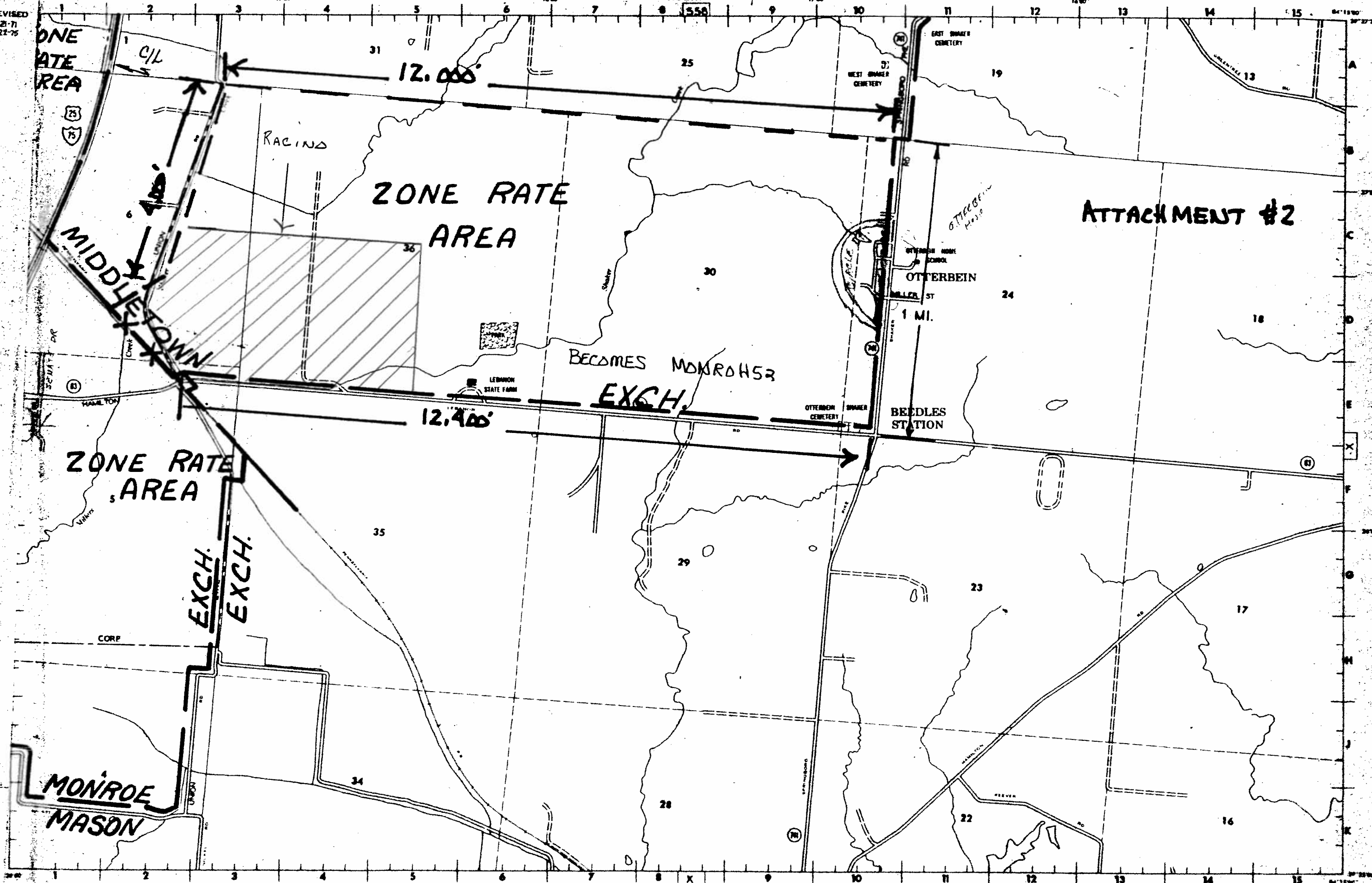

THE OHIO BELL TELEPHONE COMPANY

SHEET 567

**This foregoing document was electronically filed with the Public Utilities**

**Commission of Ohio Docketing Information System on**

**5/1/2013 9:35:19 AM**

**in**

**Case No(s). 13-1107-TP-ACB**

Summary: Application of AT&T Ohio to Change an Exchange Area Boundary Between its Middletown and Monroe Exchanges electronically filed by Jon F Kelly on behalf of AT&T Ohio